



Cedar clad camping pods

Existing Track

Parking for one car per Pod

Trees and planting to provide visual screening between pods

Landscape Specification

SPECIES Grassland
British Seed House Mix Type A24 (Contains 5 species of plant)
Grassed areas are to be prepared and leveled & to receive min 50mm imported topsoil to BS3882 prior to seeding.

Native Meadow
Severn Valley Mix by plantwild.co.uk
Sown over existing grass at 4g/m2

SPECIES Native Hedge
5 plants per linear metre, staggered row:
Malus Sylvestris
Cornus Sanguinea
Sambucus nigra
Acer campestre
Crataegus monogyna
Corylus avellana
Ile aquifolium
Sorbus aucuparia
Betula pendula
Taxus baccata

SPECIES Garden Shrubs
5 plants per linear metre, staggered row:
Berberis Vulgaris
Clematis montana or Clematis Vitablo
Cytisus scoparius
Rosa canina
Viburnum opulus
Hebe albicans
Lonicera periclymenum
Lavandula spp
Mahonia aquifolium
Cotoneaster Coral Beauty

SPECIES Trees
T1 - Birch (Betula pubescens)
T2 - Hazel (Corylus avellana)
T3 - Honeysuckle (Lonicera periclymenum)

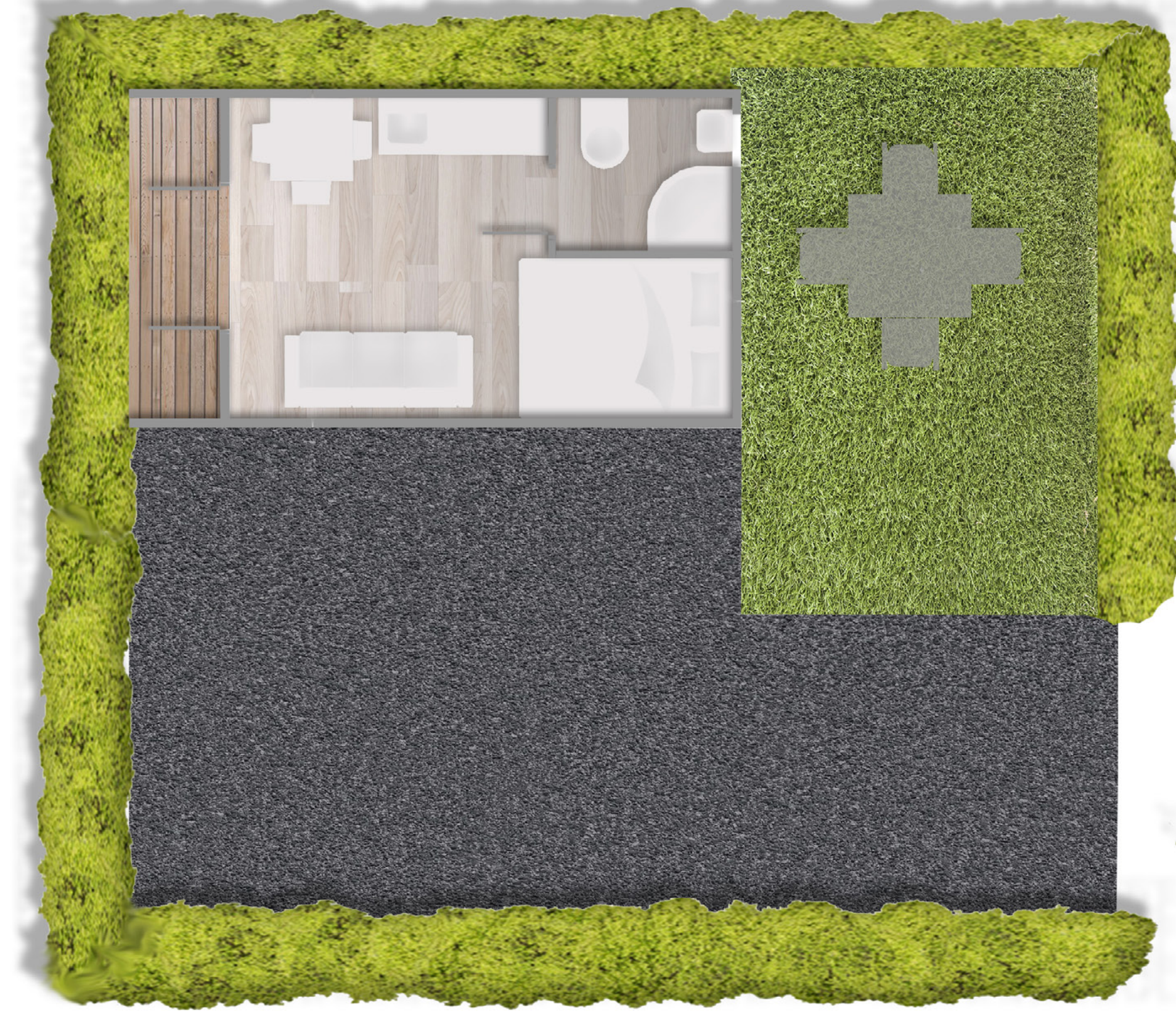

Front Elevation

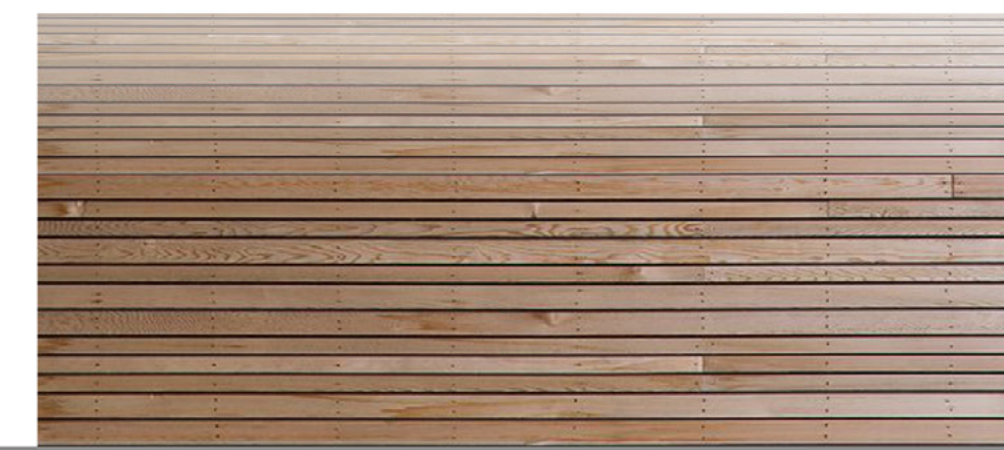

Side Elevation



Rear Elevation



Aluminium Windows and Doors to recessed porch



Internal Timber Clad Camping Pod



Project :- Scramble track, Experience Centre Building, Holiday Lodges and Associated Infrastructure

Drawing Status :- Stage 3a: Planning Drawing Title :- Log Pod Details

Scale :- As Stated Date :- 21.03.19 Drawing No :- T046 3a.1.401 Rev :- B

Rev B - Additional landscape spec and annotations 27.10.21 - GSP
Rev A - Decking Area removed following planning committee 10.12.19 - Ffe

Drawn by :- Ffe Checked :-