

NOTES:
 1. This drawing and its design is the copyright of Cotswold Architects Ltd. and may not be reproduced in any form without their prior consent.
 2. Do not scale off this drawing.
 3. Dimensions to be checked on site.

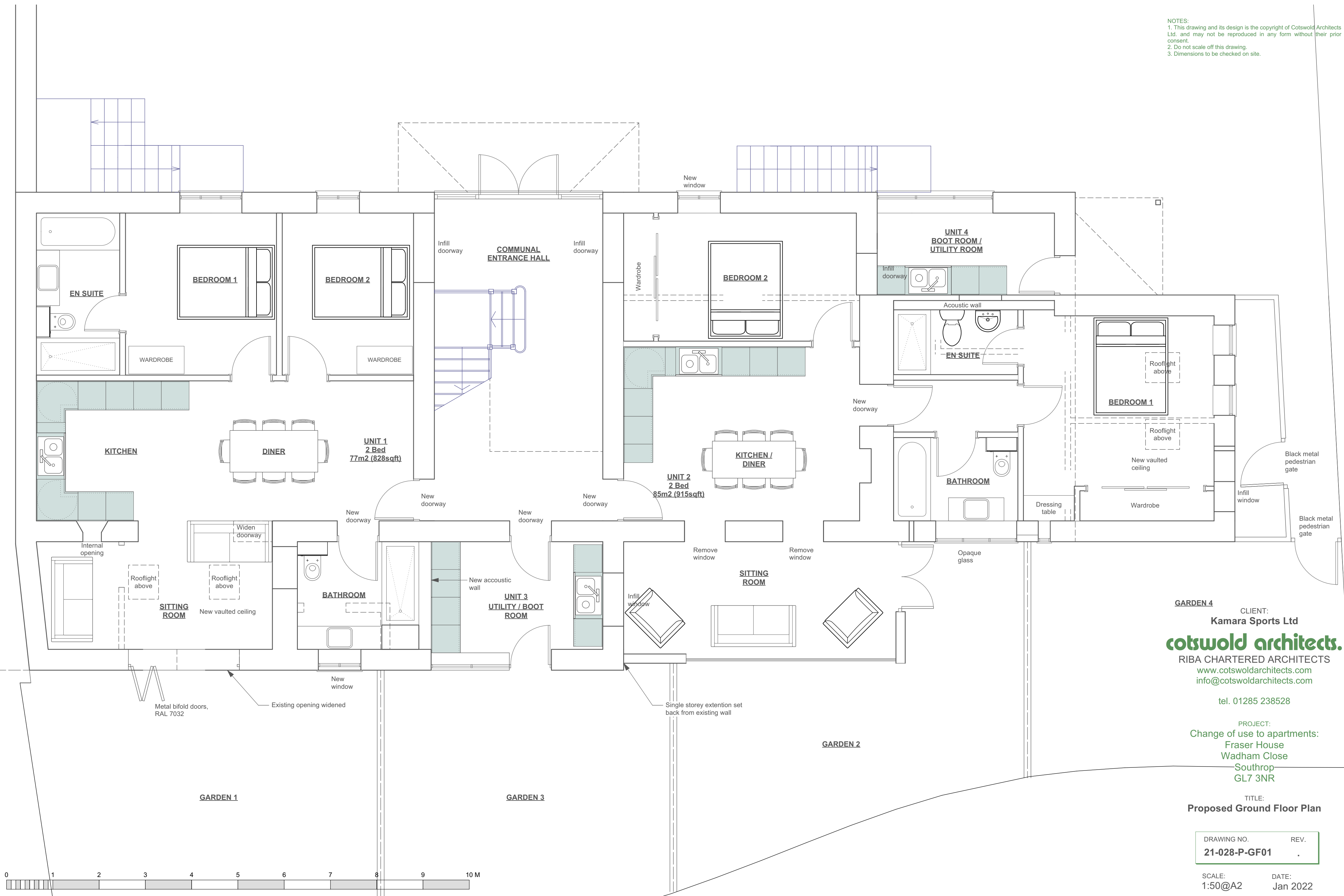

GARDEN 4 CLIENT:
Kamara Sports Ltd
cotswold architects.
 RIBA CHARTERED ARCHITECTS
 www.cotswoldarchitects.com
 info@cotswoldarchitects.com
 tel. 01285 238528

PROJECT:
 Change of use to apartments:
 Fraser House
 Wadham Close
 Southrop
 GL7 3NR

TITLE:
Proposed Ground Floor Plan

DRAWING NO.	REV.
21-028-P-GF01	.

SCALE: 1:50@A2 DATE: Jan 2022