

D07 - Stable door - External Elevation 1:10

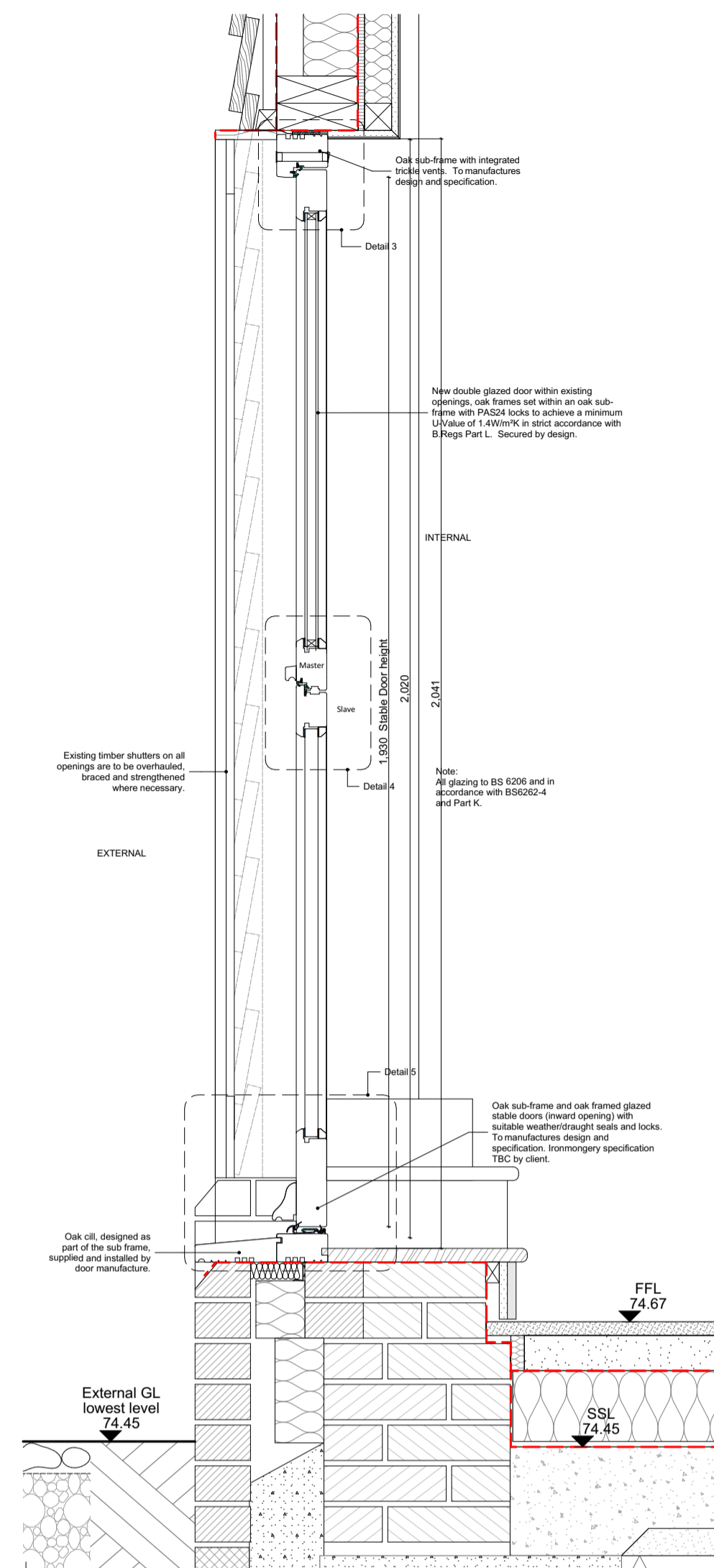

D07 Stable door Section A-A 1:10

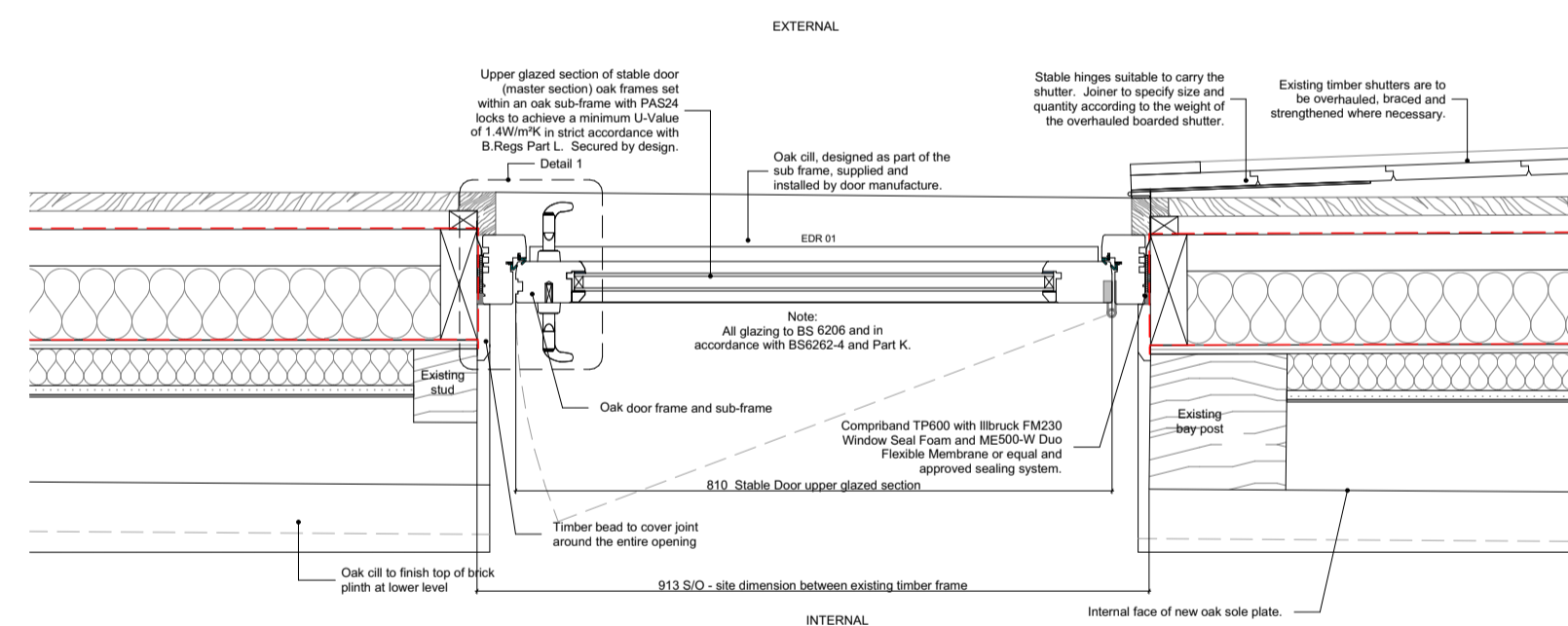

D07 Stable door - Plan through top section B-B 1:10

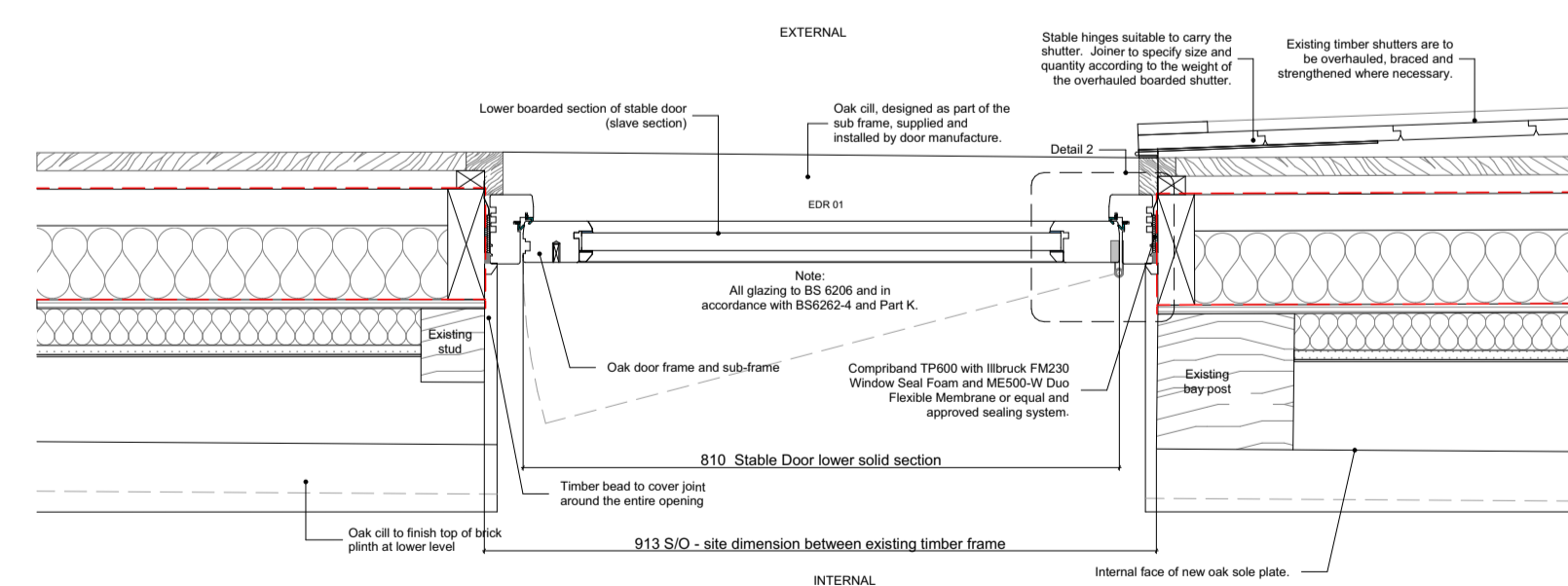

D07 Stable door - Plan through lower section C-C 1:10

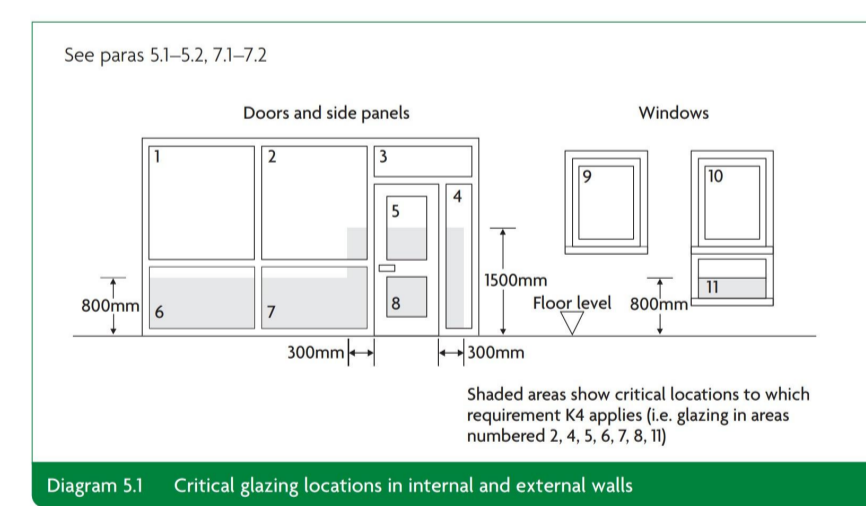
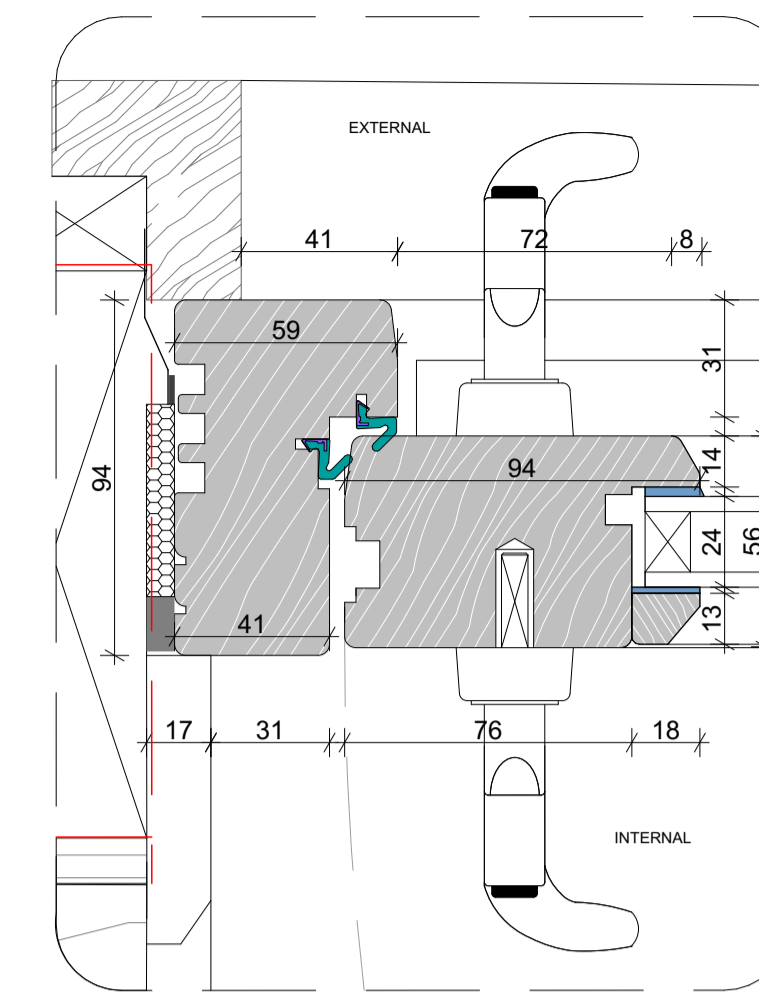

Diagram 51 Critical glazing locations in internal and external walls

Park K glass

General Notes

- All dimensions shown are in MM.
- Do not measure from this drawing.
- All dimensions should be checked on site prior to manufacture.
- All window and door details are to be read in conjunction with the window and door schedules for sizes and all existing openings site measured before any joinery is manufactured.
- These drawings should always be read in conjunction with the Structural Engineers drawings.
- No internal alterations, including the cutting or alteration of any ties beam, collar, purlin, brace, windbrace, principal rafter or other structural timber, nor any insertion of partitions, walls, floors or ceiling other than proposed, shall take place at any time other than in accordance with the prior written consent of the local planning authority.
- All glazed windows and doors are to meet the current buildings Regulations values of 1.4W/m²K or better in accordance with Part L1A.
- All windows and doors are to have trickle vents in accordance with Building Regulations Part F (specified by window manufacture) set within the timber sub-frame.
- All windows and doors are to be secured by design.
- All windows are to have PAS 24 locks.
- All sub-frames, casements, doors, and fixed window frames are to be constructed using joinery grade oak unless otherwise specified.
- Window and door manufactures are to specify suitable weatherseals for all opening casements and doors.
- All new windows, doors and fixed glazing is to be fitted square and not to follow the undulations of the historic frame, therefore please note that packing may be required over the existing frame where it is not vertical.
- The Sections and elevations detailed on this drawing are for door EDR 01. Please note that Sub-frame, casement, door and fixed glazing details are to be applied to all new windows, doors and fixed glazing within existing door openings on the main barn.
- All existing openings with existing timber boarded doors/shutters are to be retained where possible, these include EDR 01, FFV 23, FFV 24 and FFV 25. These are to be carefully removed and safely stored. When required they are to be overhauled allowing to suitably strengthened and braced, stripped back and treated ready to be rehung and fixed back in the open position.
- Joiners overhauling these shutters are to size the bracket (stable) hinges according to the size and weight of them if required.



Detail 1 1:2

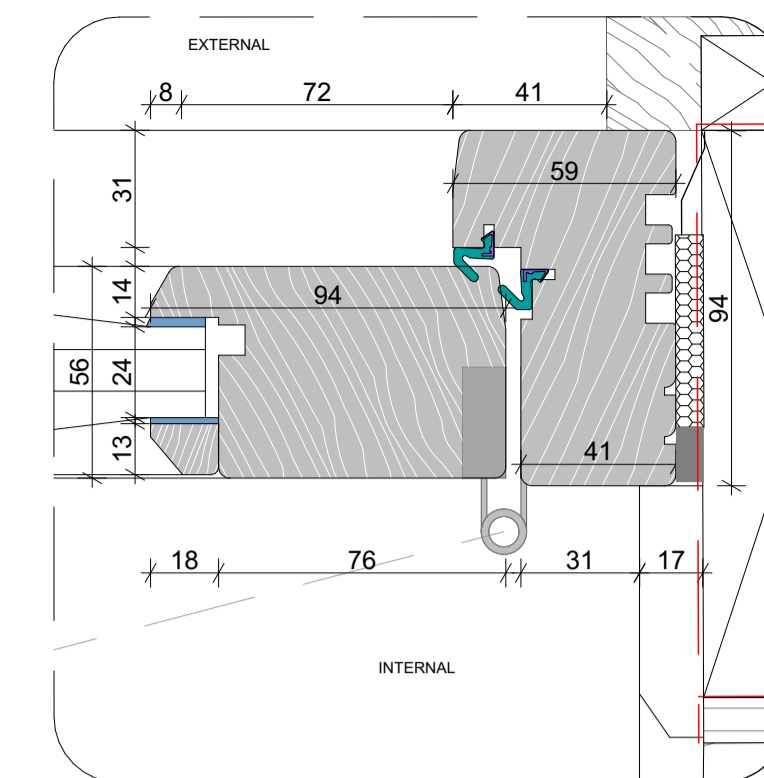

Detail 2 1:2

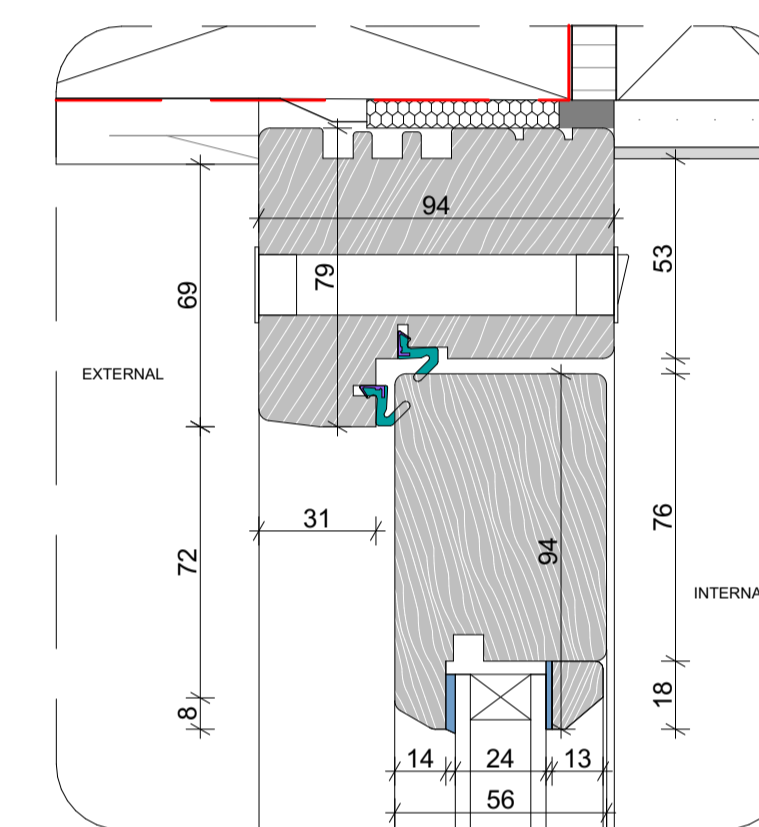

Detail 3 1:2

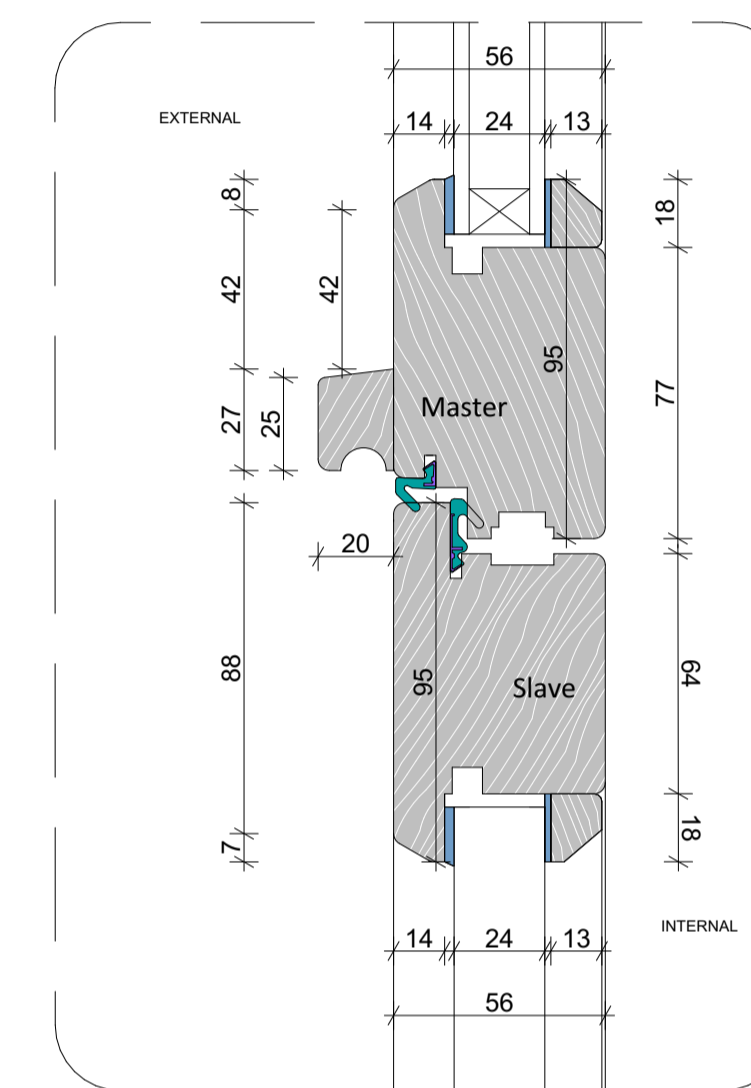

Detail 4 1:2

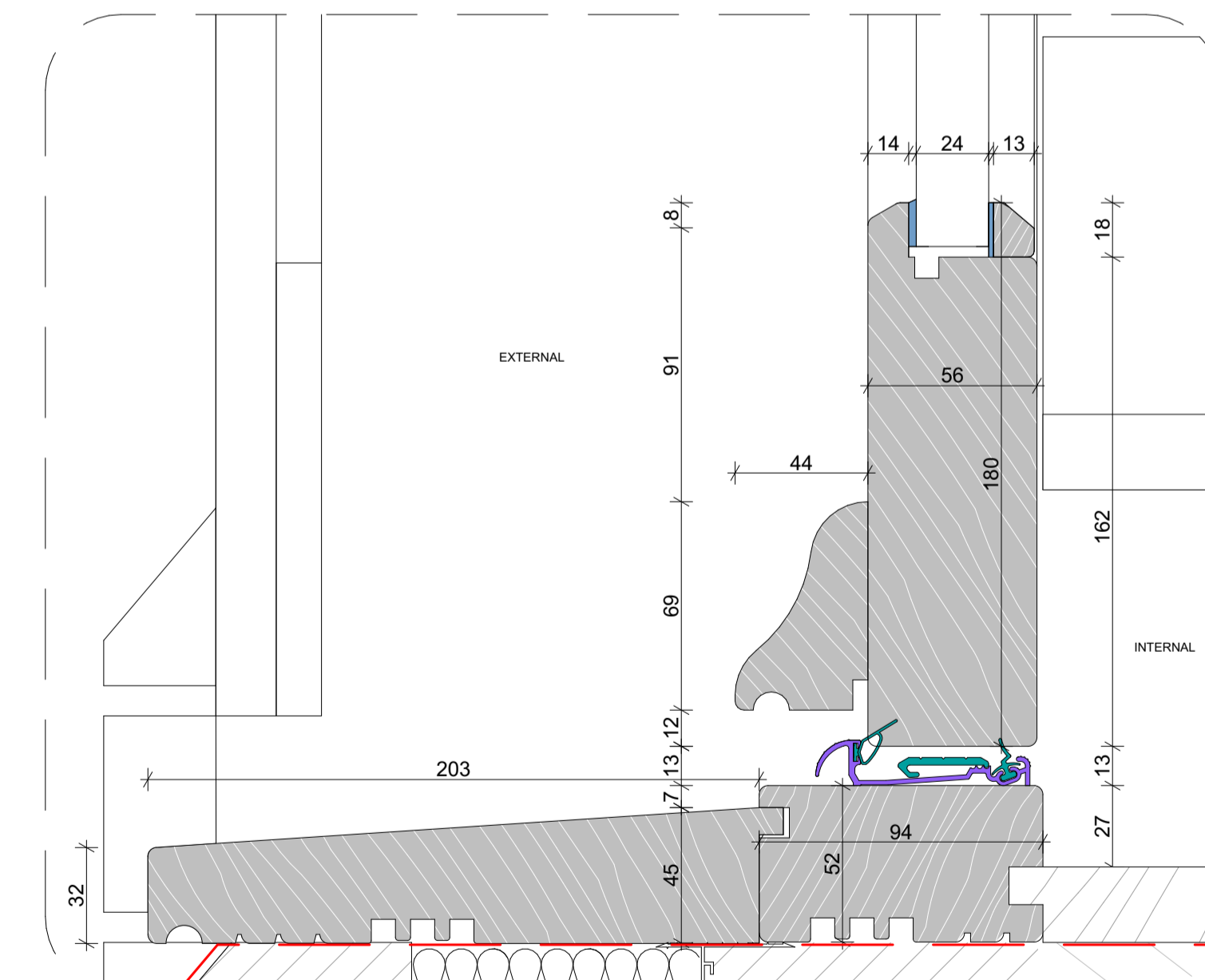

Detail 5 1:2

Drawing Numbers

- SK Sketch Scheme
- P Planning
- A-0 General
- A-1 Plans
- A-2 Elevations
- A-3 Sections
- A-4 Large scale
- A-5 Details
- A-6 Schedules
- A-7 Interior design

Drawing Status

- Comment
- Information
- Sketch
- Planning
- Tender
- Building Regulations
- Construction
- As Built

This drawing must not be used for construction or installation purposes unless stated. Do not scale from this drawing except for planning and building regulations. All dimensions must be verified on site and confirmed in writing by the CA (or the Party responsible for coordination of the documents) before completing shop drawings and setting out the work, notwithstanding that a Drawing is issued for Construction. All setting out dimensions, grid lines, eastings, northings and levels are to be verified and confirmed in writing by the CA (or the Party responsible for coordination of the documents) before construction, notwithstanding that a Drawing is issued for Construction. This drawing is to be read in conjunction with other drawings, the technical specification and associated schedules prepared by Stedman Blower.

Rev.	CHD	Description	Date

This drawing is to be read in conjunction with other architectural and engineering drawings associated with this project by other parties.

Client

Candida Baker

Job Title

Dickhurst Farm
Petworth Road
Chiddingfold
Surrey
GU27 3BG

Copyright on this drawing is held by Stedman Blower

STEDMAN BLOWER

18 0 5
6 The Square
Liphook GU50
74H

01428 581 800
info@stedmanblower.uk
www.stedmanblower.uk

Drawing Title

Stable Door Details

Drawing Status	Technician
TENDER DRAFT	NS & JS
SD	
Original Size	Date
A1	Dec 2018
Drawing Number	Revision
5528-BC-A-505	