

A Existing Block Plan/ Roof Plan
1:200

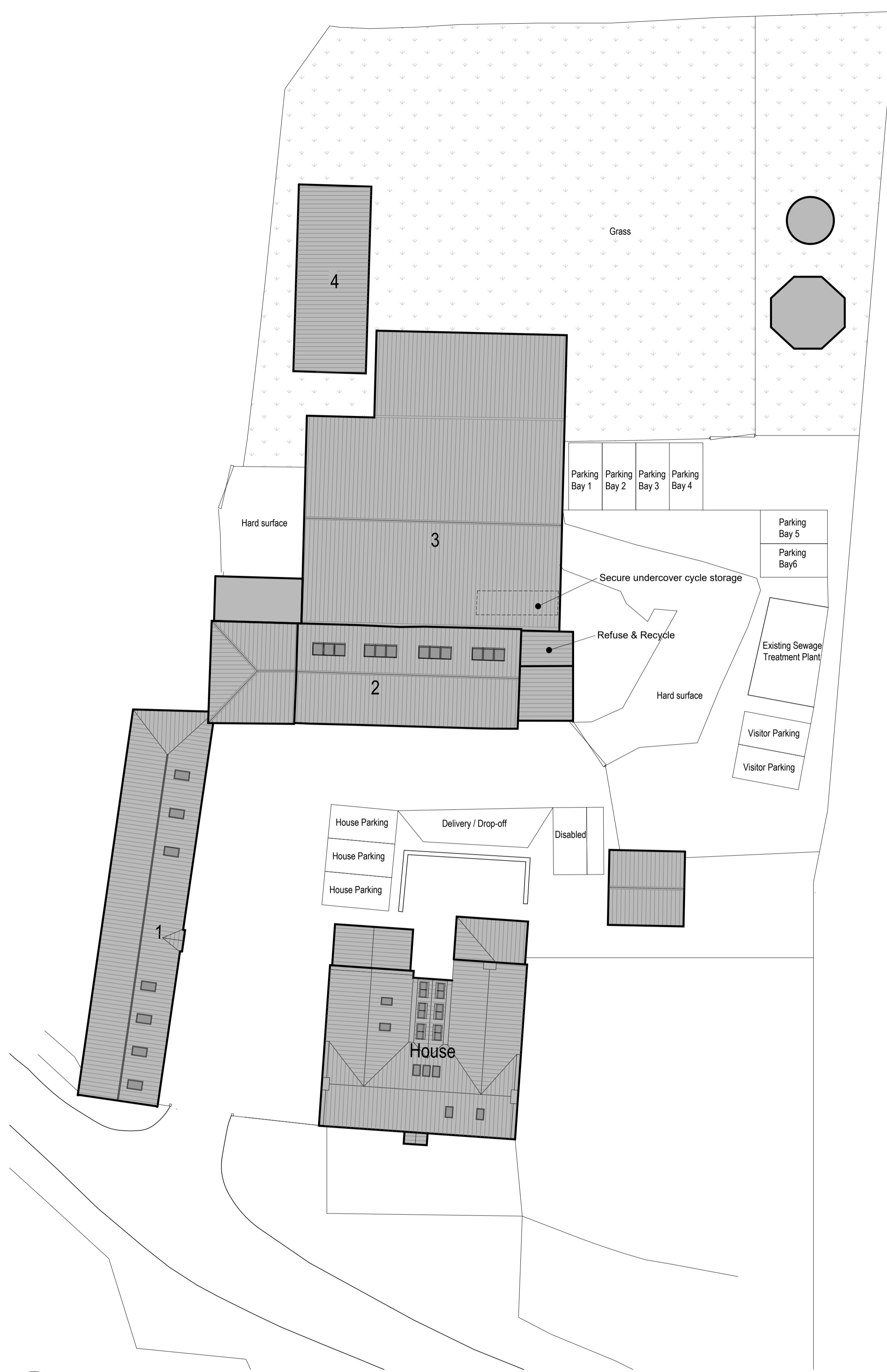

B Proposed Block Plan/Roof Plan
1:200

- Key:**
- House - Luggs Farm, residential dwelling
 - 1 - Long Barn, ancillary residential use converted under S.18/1695/FUL
 - 2 - Two-storey barn (application building)
 - 3 - Agricultural barn with low level block walls and timber cladding.
 - 4 - Agricultural open sided barn

P03	DW	ISO	16.01.2022	External work updates
P02	DW	ISO	16.01.2022	Drafting updates
P01	LI	ISO	06.01.2022	Final Issue
Rev	Drn	CHK	Date	Amendment
3		S4		For Stage Approval

view **View Architects**
 19A St Mary Street, Thornbury, Bristol, BS35 2AB
 01454 418 966
 admin@viewarchitects.com

Project Name
Luggs Farm, Phase 3

Document Title
Existing and Proposed Block Plan/ Roof Plan

Date	Scale	View Reference
06.01.2022	1:200 (A1)	2126

Document Reference	Revision
2119-VAL-XX-XX-DR-A-1901	P03