

Notes:
NOT FOR CONSTRUCTION: design is intended for workstage noted below.
 Further input/completion of design is required by specialist contractors and/or appointed lead designers prior to commencing works on site.
 Do not measure from the drawings. All dimensions to be confirmed prior to ordering and installation.
 For any discrepancies in the drawings the contractor is to inform the Architect.
 All drawings to be read in conjunction with the Specification, Structural Engineer's and other consultants' drawings.
 Contractor to visit site to become aware of any site conditions.

Health and Safety Information
 (L = latent risk C = construction phase risk)

Revision	Dr	Chk	Date	Comments

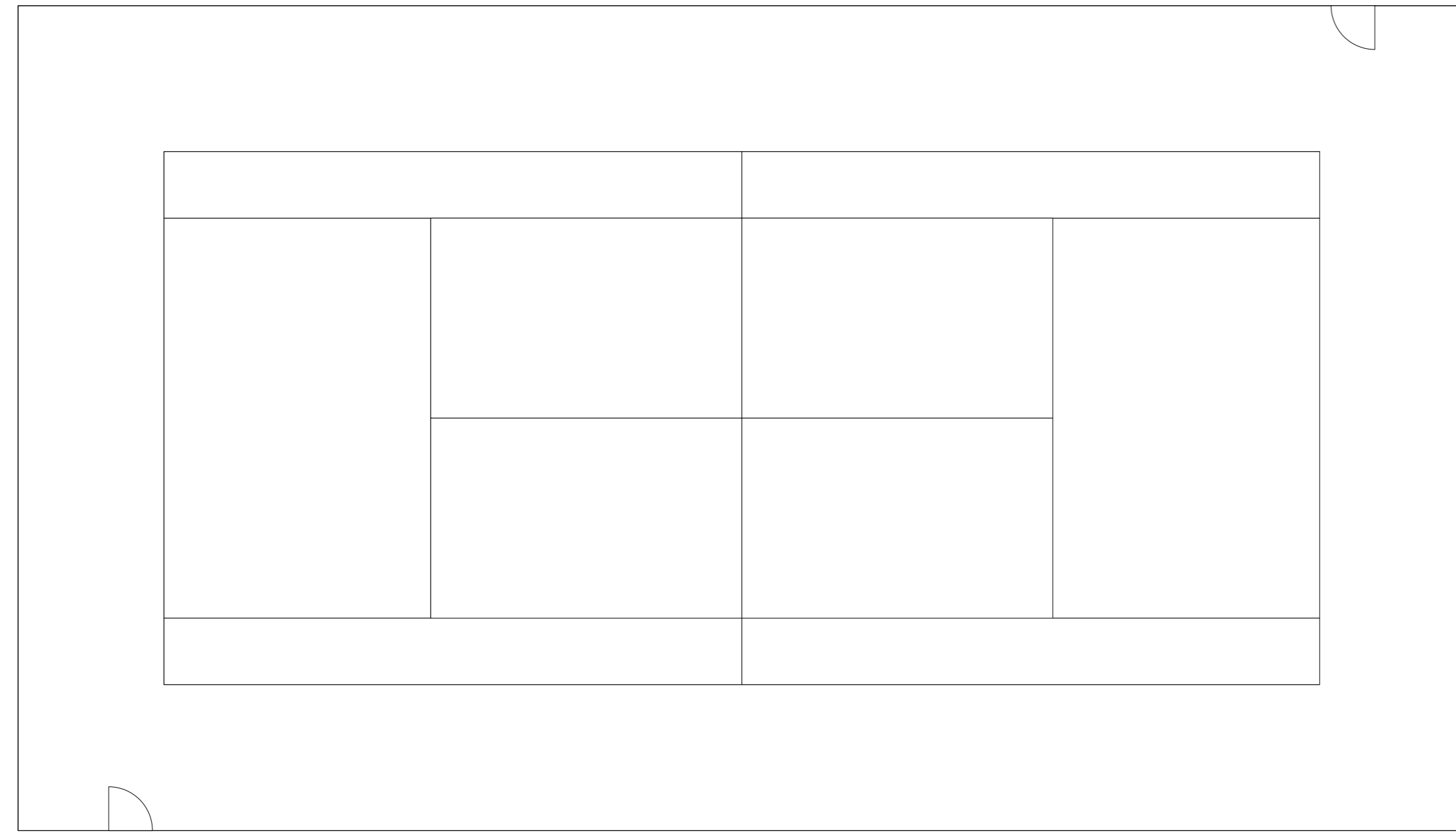

PROPOSED TENNIS COURT

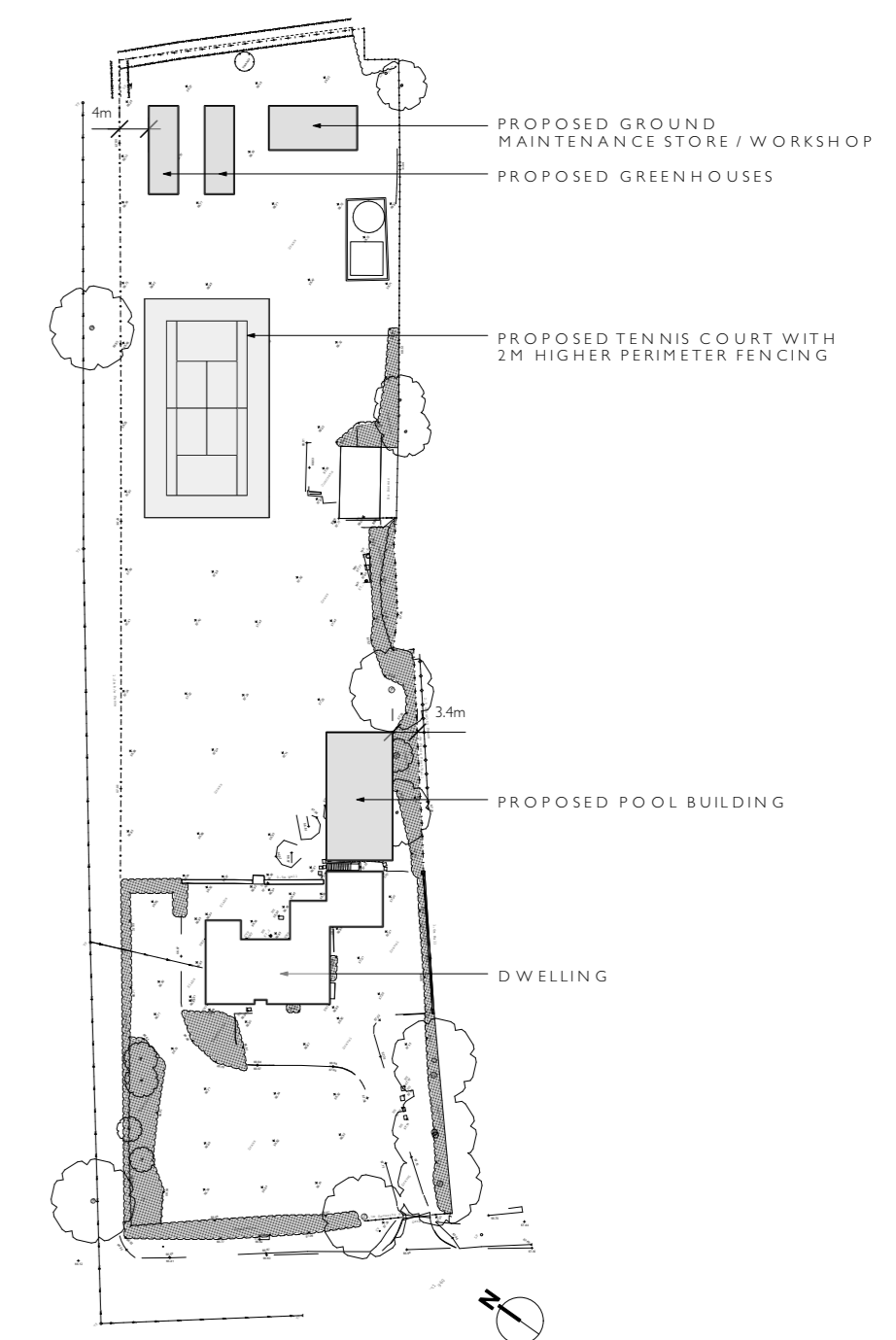
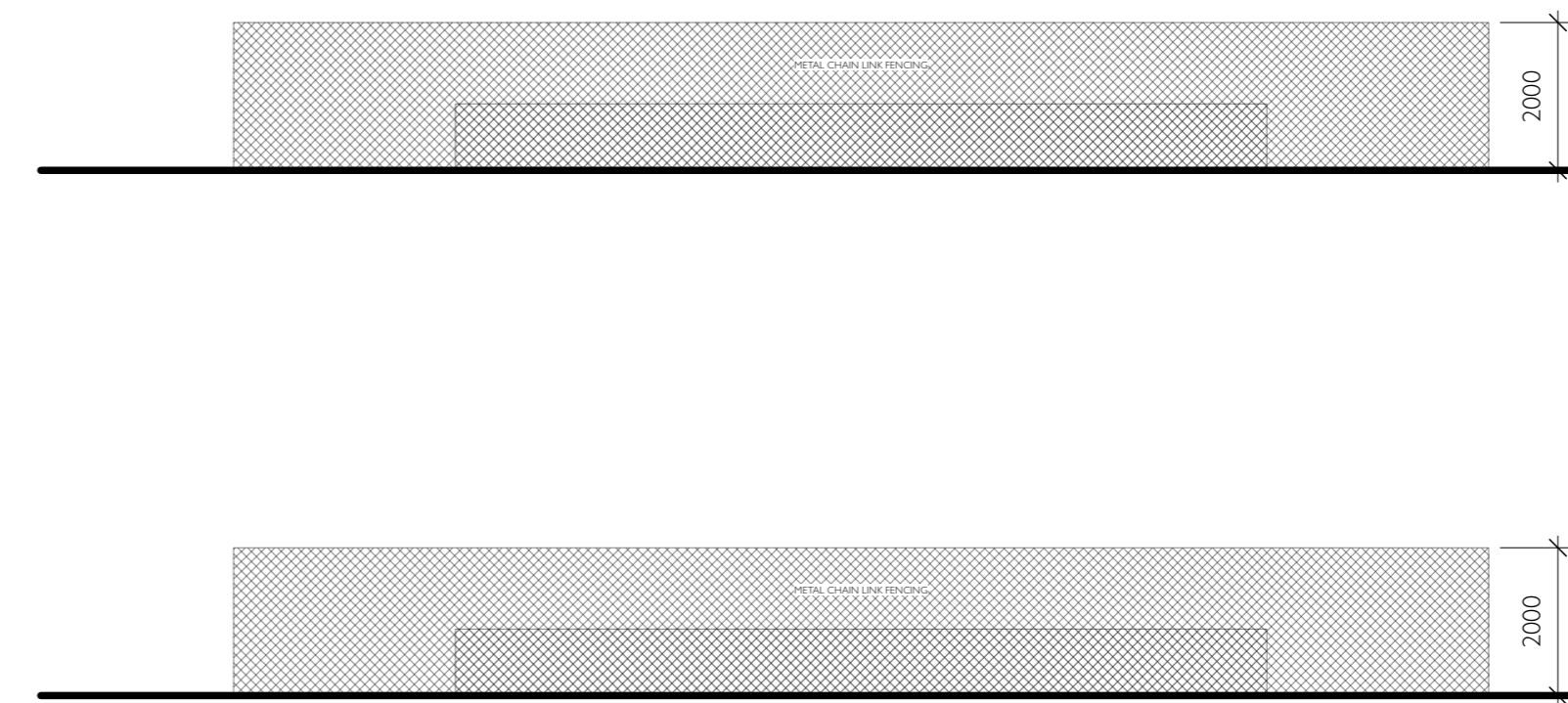
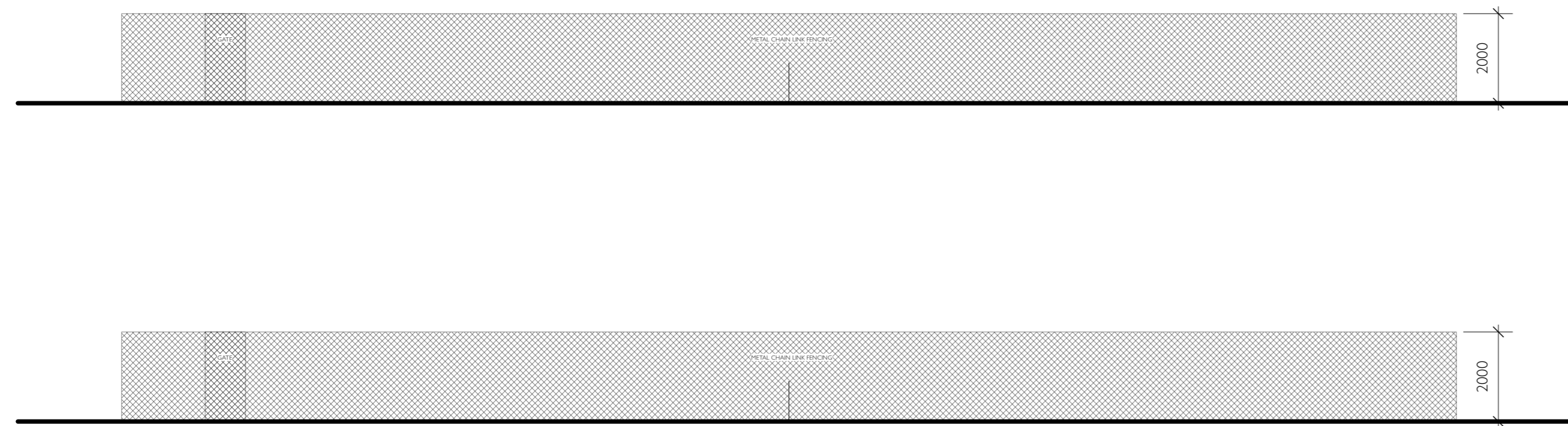

KEY PLAN (1:1000)

STUDIO SPICER ARCHITECTS
 7 Mansell Street, Stratford upon Avon
 Warwickshire, CV37 6NR
 01789 293452
 www.studiospicer.co.uk

Client
Mr & Mrs Barnes
 Project
The Swans
 Address
**Sandy Lane,
 Blackdown, Leamington Spa
 CV32 6RD**

Drawing title
Proposed Plans & Elevations

Scale
1:100 @ A1 Date
21/10/2021 Drawn by
PB Checked by
EG

CAD File
507 The Swans - PD Planning R3.vwx CAD format
Vectorworks

Proj. No Dwg. No Rev
507_AR_130_003

Copyright of material Studio Spicer Limited