

DATE
13.01.20

PROJECT
BELSAY AWAKES WOODLAND PLAY MATERIALS R5

FOR
ENGLISH HERITAGE

STUDIO HARDIE

+44 (0)1273 473924
INFO@STUDIOHARDIE.COM

MATERIALS FOR WOODLAND PLAY AREA:

ALL PLAY EQUIPMENT DESIGNED, CONSTRUCTED, INSTALLED AND MAINTAINED IN ACCORDANCE WITH EUROPEAN STANDARDS BS EN1176 AND BS EN 1177.

THE STRUCTURES WILL BE CONSTRUCTED FROM NATURAL MATERIALS AND APPROPRIATE TRADITIONAL MANUFACTURE TECHNIQUES. ANY HARDWEARING COMPONENTS WILL BE MADE FROM STAINLESS STEEL/ GALVANISED STEEL OR ALUMINIUM SUCH AS, PIVOTS, BEARINGS AND RIGGING TERMINATIONS.

STRUCTURES ARE DESIGNED TO REQUIRE LOW MAINTENANCE.

SELECTION OF NATURAL/ SITE ONE MATERIALS:

SITE WON BOULDERS, CUT STONE AND TREE TRUNKS
WOODLAND WILDFLOWERS & BULBS
HAZEL HEDGING

TIMBER:

APPROPRIATE TIMBER SELECTION WILL TAKE PLACE PRIOR TO CONSTRUCTION, GRADING OF TIMBER WILL ELIMINATE ANY FAULTY TIMBER WHERE EXCESS CRACKING OR SPLINTERING WILL OCCUR
ROBINIA TIMBER FOR LARGE STRUCTURAL ELEMENTS OF BESPOKE EQUIPMENT
GOOD STANDARD GREEN AND AIR DRIED OAK, CHESTNUT, DOUGLAS FIR AND LARCH FOR SMALLER ELEMENTS.

CLADDING

STRUCTURAL TIMBER GRADED TO C16 OR C24 AND PEFCM OR FSC® APPROVED.
ALL TIMBERS AND SURFACES TO BE CHECKED FOR SPLINTERS OR PROBLEMATIC DEFECTS.
ALL TIMBER WILL BE OF SUFFICIENT SIZE TO WITHSTAND EXCESSIVE USE AND WEATHERING ISSUES.

TIMBER FINISH:

SAWN, SANDBLASTED OR PLANED FINISH ON ALL STRUCTURAL TIMBERS.
NO TREATMENT IS REQUIRED ON OAK, DOUGLAS FIR OR LARCH. THE TIMBERS WILL GRADUALLY TURN SILVERY GREY. ANY SENSITIVE PARTS OF THE STRUCTURES WILL BE PRESERVED USING CHILD AND ENVIRONMENTALLY SUITABLE FINISH, (LOW MAINTENANCE.)
STRUCTURES ARE DESIGNED TO ALLOW ANY MOISTURE OR RAINWATER TO BE SHED THROUGH VENTILATION GAPS AND WEEP HOLES.

TIMBER DECKING:

AIR-DRIED OAK DECKING 6MM GAPS, REED PROFILED FOR GRIP, ROUNDED/ CHAMFERED EDGES. FIXED WITH COUNTERSUNK SS SCREWS.

FIXINGS:

STAINLESS STEEL SCREWS AND BOLTS OR TIMBER PLUGGED TIMBERLOK FIXING
ALL STRUCTURAL TIMBER POSTS FOOT PLATES TO BE HOT DIPPED GALVANIZED STEEL, BOLTS CHEMICALLY FIXED TO SUBMERGED COMPETENT ROCK OR CONCRETE PADS.

ROPE AND RIGGING:

NATURAL HEMP APPEARANCE POLYPROPYLENE 3 STRAND SYNTHETIC HEMP AND 16MM BRAIDED NYLON STEEL REINFORCED ROPE WITH ALUMINIUM FERRULES OR SPLICED WITH STAINLESS STEEL THIMBLES AND STAINLESS STEEL SOCKET PINNED SHACKLES SECURED WITH STAINLESS STEEL OR HOT DIPPED GALVANISED EYE BOLTS.
SMALLER APERTURE SAFETY NETS TO BE KNOTTED CONSTRUCTION.

SLIDES:

SLIDES MANUFACTURED FROM UN-POLISHED STAINLESS STEEL.

SAFETY SURFACING:

GRASS MATTING COMPLYING TO EN1177 (FULLY ACCESSIBLE)
RESIN BONDED RUBBER PLAY MULCH COMPLYING TO EN1177 (FULLY ACCESSIBLE)
PLAY BARK TO EN1177

PATH SURFACING

GRAVEL (FULLY ACCESSIBLE)

RUBBER BOUND MULCH: PROVIDES A POROUS ACCREDITED SOLUTION THAT IS SENSITIVE IN APPEARANCE TO THE WOODLAND ENVIRONMENT AND FULLY ACCESSIBLE.

PLAY BARK

GRASS MATTING WILL BE USED WHERE HIGH WEAR AREAS ARE ANTICIPATED AND WILL ALSO PROVIDE SAFETY SURFACING AROUND PLAY EQUIPMENT SITUATED WITHIN GRASS.

FOUNDATIONS:

STRUCTURES HAVE BEEN DESIGNED AND SET OUT TO REQUIRE MINIMAL FOUNDATIONS. FOUNDATIONS WILL NOT INTERFERE WITH ANY TREES ROOT SYSTEM AND MICRO POSITIONING OF EQUIPMENT WILL BE DEPENDANT ON TREE ROOT POSITIONS. CONCRETE PADS WILL BE SUBMERGED BELOW FINISHED GROUND LEVEL AND COVERED WITH SOIL OR MOT AND RESIN BONDED RUBBER MULCH. STEEL FLITCH PLATES WILL BE BOLTED AND CHEMICALLY FIXED TO EXISTING COMPETENT ROCK OR SMALL CONCRETE PADS. TIMBER PLAY EQUIPMENT WILL BE BOLTED TO STEEL FLITCH PLATES USING M12 STAINLESS STEEL ROD, WASHERS AND NYLOCK NUTS TO BE COUNTERSUNK INTO TIMBER AND TIMBER PLUGGED WHERE IN PREDOMINATE POSITIONS.

RIGHT - OAK MIMICKING STONE

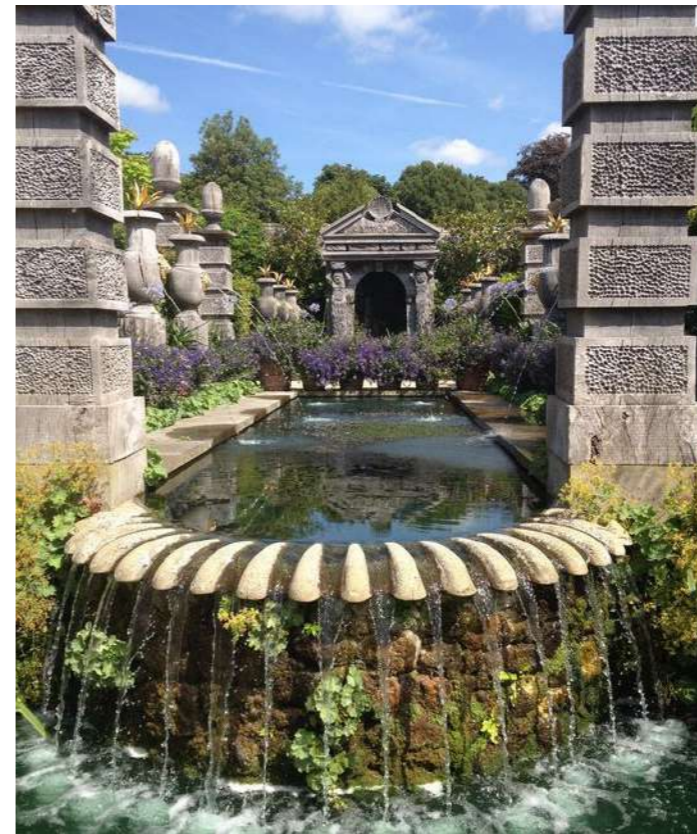

ABOVE - FORMAL TIMBER COLUMNS

Formal timber

BELOW - OAK BEAMS WITH SIMPLE
MOULDINGS TURNING SILVER GREY
WITH TIME



RIGHT - FORMAL OAK STRUCTURES
MIMICKING STONE



LEFT - ROUGH TIMBER STRUCTURE
FOR ROOT HOUSES

RIGHT -SYNTHETIC HEMP ROPE AND NETTING



LEFT - SMALL SLIDE AND RAMP

Rigging and slides

BELOW - STAINLESS STEEL HELICAL SLIDE



ABOVE - CHESTNUT BALUSTERS



LEFT - TIMBER FRAME AND BASKET SWING

Timber

MATERIALS OAK, LARCH, WEATHERED OAK, ROBINIA

DATE
13.01.20

NO.
BELSAY AWAKES WOODLAND PLAY MATERIALS R5



DATE
13.01.20

NO.
BELSAY AWAKES WOODLAND PLAY MATERIALS R5

RIGHT - ABSTRACT SHELTERS



LEFT - ROBINIA POSTS

Wildman's area timbers

BELOW - LONG RANDOM SHINGLES
FOR WILDMAN'S PODS



ABOVE - ROBINIA POSTS



RIGHT - RANDOM SHINGLES FOR
WILDMAN'S PODS



LEFT - CHESTNUT BALUSTERS

RIGHT - ABSTRACT SHELTERS



LEFT - SAFETY GRASS MATTING

safety surfacing

BELOW - RESIN BONDED RUBBER PLAY MULCH



ABOVE - GRASS SLOPES



RIGHT - PLAY BARK



LEFT - RESIN BONDED RUBBER PLAY MULCH

natural site won play elements

RIGHT - SIMPLE NATURAL PLAY DETAILS



BELOW FALLEN TREES AS CLIMBING FRAME



ABOVE - LARGE TRUNKS



RIGHT - LARGE TREE TRUNKS



LEFT - FALLEN TREES/ WILDMAN'S SECRETS

Tame to wild entrance

RIGHT - ROUGH SAWN GREEN OAK
MIMICKING STONE



MATERIALS
FACARD: UNFINISHED ROUGH SAWN GREEN OAK,
LEFT TO WHEATHER TURNING SILVERY GREY.

NETTING: HEMP COLOURED COMBINATION ROPE
WITH ALUMINIUM CONNECTIONS.

STONE: SITE WON INDIGEONOUS STONE BOTH
ASHLAR AND ROUGH BOULDERS.

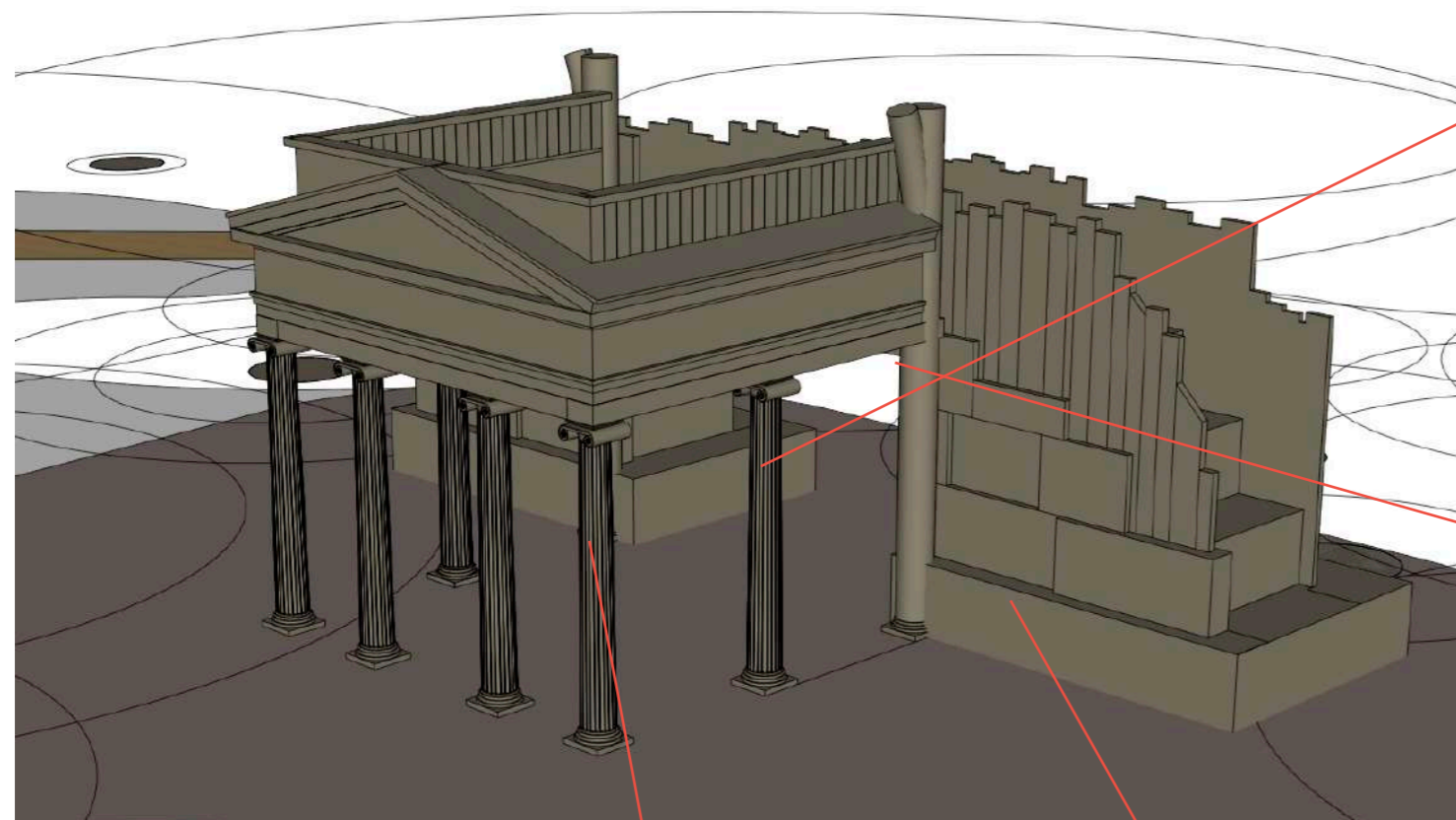

ABOVE - FEELING OF RUSTIC TUNNEL



RIGHT - FORMAL ROUGH SAWN
GREEN OAK STRUCTURES MIMICKING
STONE

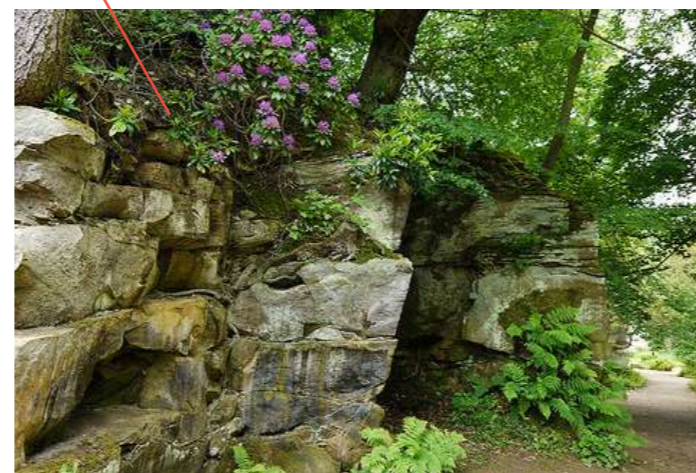

LEFT - LOWER SECTION FORMED WITH
ROUGH STONE BOULDERS

Middleton's plant collection

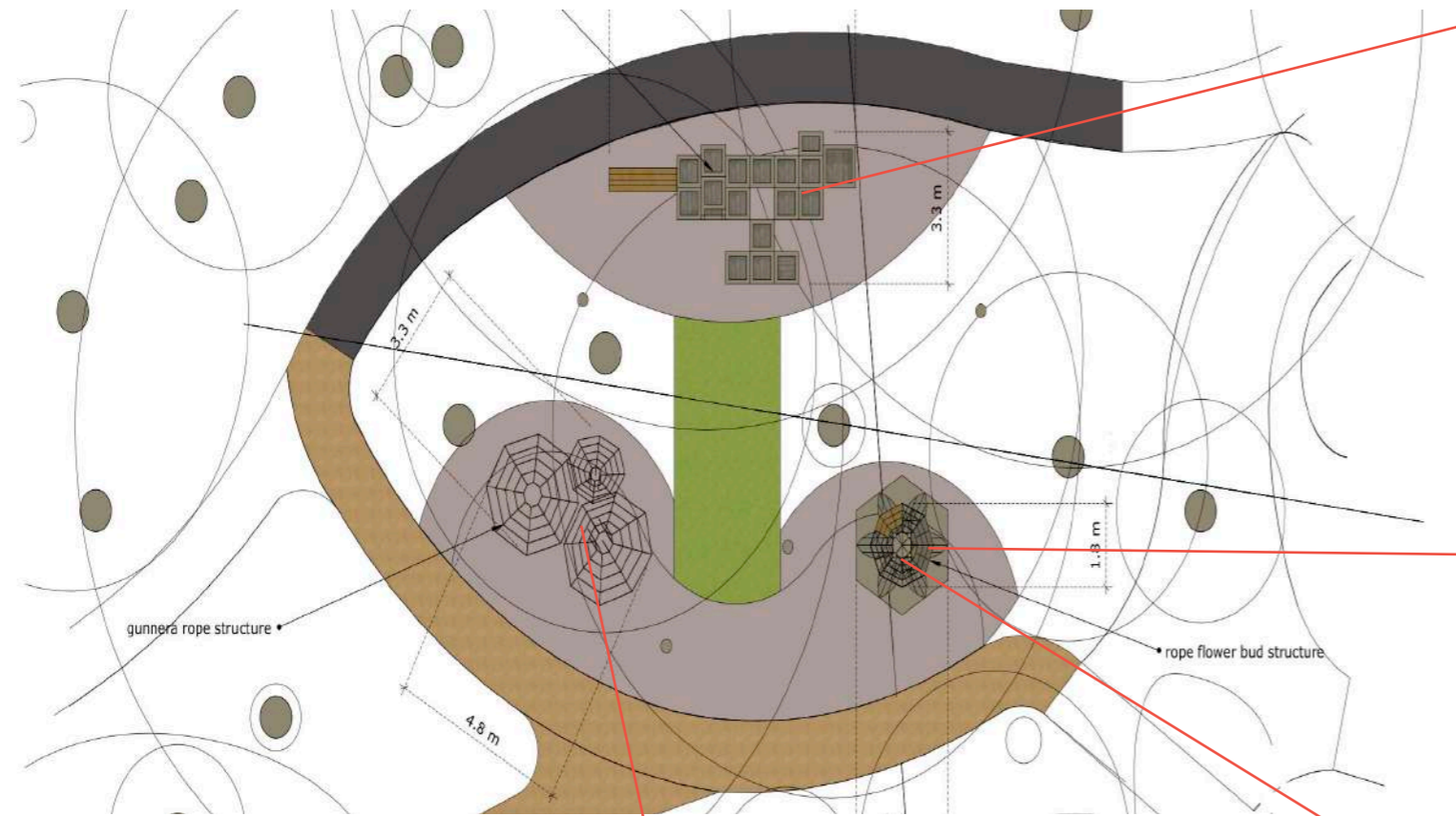

MATERIALS
PACKING CRATES: UNFINISHED ROUGH SAWN DOUGLAS FIR AND OAK LEFT TO NATURALLY WEATHER TURNING SILVERY GREY

NETTING: GREEN COLOURED COMBINATION ROPE WITH ALUMINIUM CONNECTIONS.

LEFT - CRATES MADE FROM ROUGH SAWN OAK AND LARCH



LEFT - SYNTHETIC HEMP COLORED STEEL COR ROPE WITH ALUMINIUM CONNECTORS

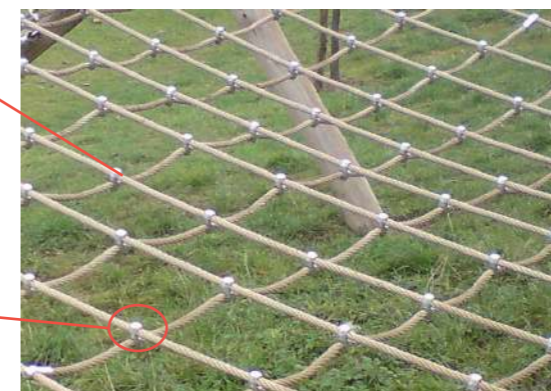

LEFT - HEMP COLORED COMBINATION ROPE WITH ALUMINIUM CONNECTORS.



GREEN COLORED SYNTHETIC COMBINATION ROPE

Root house

RIGHT - TRADITIONAL JOINERY IN
ROUGH SAWN UNFINISHED GREEN
OAK



MATERIALS
WALL CLADDING: HIT AND MISS UNFINISHED
ROUGH SAWN GREEN OAK, TOP BOARDS WANED
EDGED AND LEFT TO WEATHER TURNING SILVERY
GREY.

ROOF: UNFINISHED WANED EDGED ROUGH SAWN
STACKED LARCH BLOCKS LEFT TO WEATHER
TURNING SILVERY GREY.

DOOR ARCH: ROUGHSAWN UNFINISHED GREEN
OAK FRAME

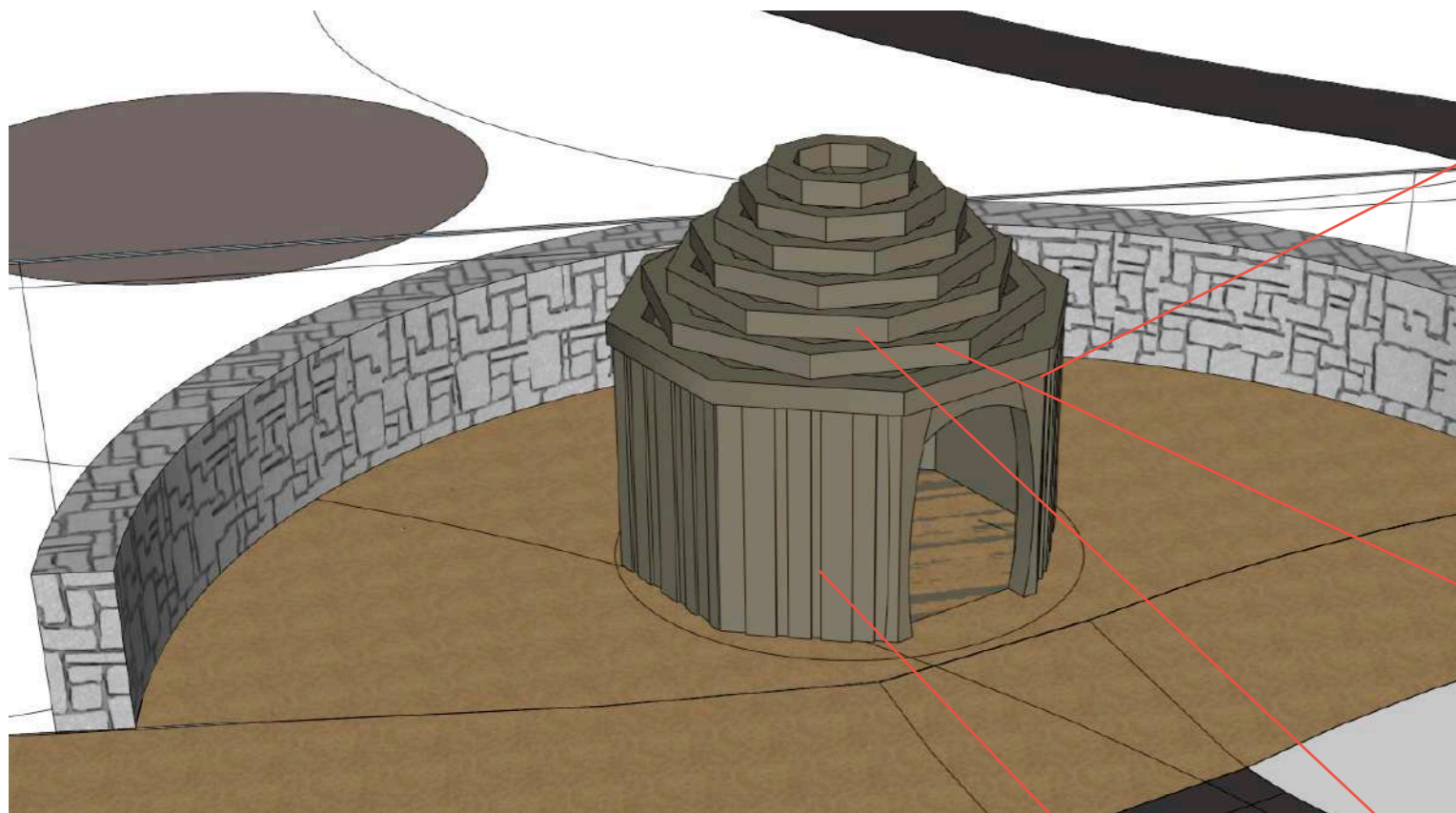

LEFT - EXAMPLE OF LARCH ROUGH
TIMBER TIMBER,

RIGHT - ROUGH SAWN WANED
EDGED UNFINISHED GREEN OAK
CLADDING



LEFT - EXAMPLE OF WANED EDGED
ROUGH STACKED TIMBER,



LEFT - GENERAL FEEL OF ROUGH
TIMBER STRUCTURE FOR ROOT
HOUSE,

DATE
13.01.20

NO.
BELSAY AWAKES WOODLAND PLAY MATERIALS R5

Little wild one's play area

RIGHT - OAK WALKWAY BENCHES
ROUGH SAWN
UNFINISHED GREEN OAK



MATERIALS
PACKING CRATES: UNFINISHED ROUGH SAWN DOUGLAS FIR AND OAK BOARDS, LEFT TO NATURALLY WEATHER TURNING SILVERY GREY.

BENCHES: UNFINISHED ROUGH SAWN GREEN OAK, LEFT TO WHEATHER TURNING SILVERY GREY.

WILDMANS POD: UNFINISHED ROUGH SAWN OAK SHINGLES LEFT TO WHEATHER TURNING SILVERY GREY. FLOOR AND RAMP IN UNFINISHED REEDED OAK DECKING.

POSTS ROBINIA IN THE ROUND. SLIDE STAINLESS STEEL.

SWINGS: UNFINISHED ROUGH SAWN GREEN ROUGH SAWN OAK WITH HEMP COLOURED COMINATION ROPE BASKET.

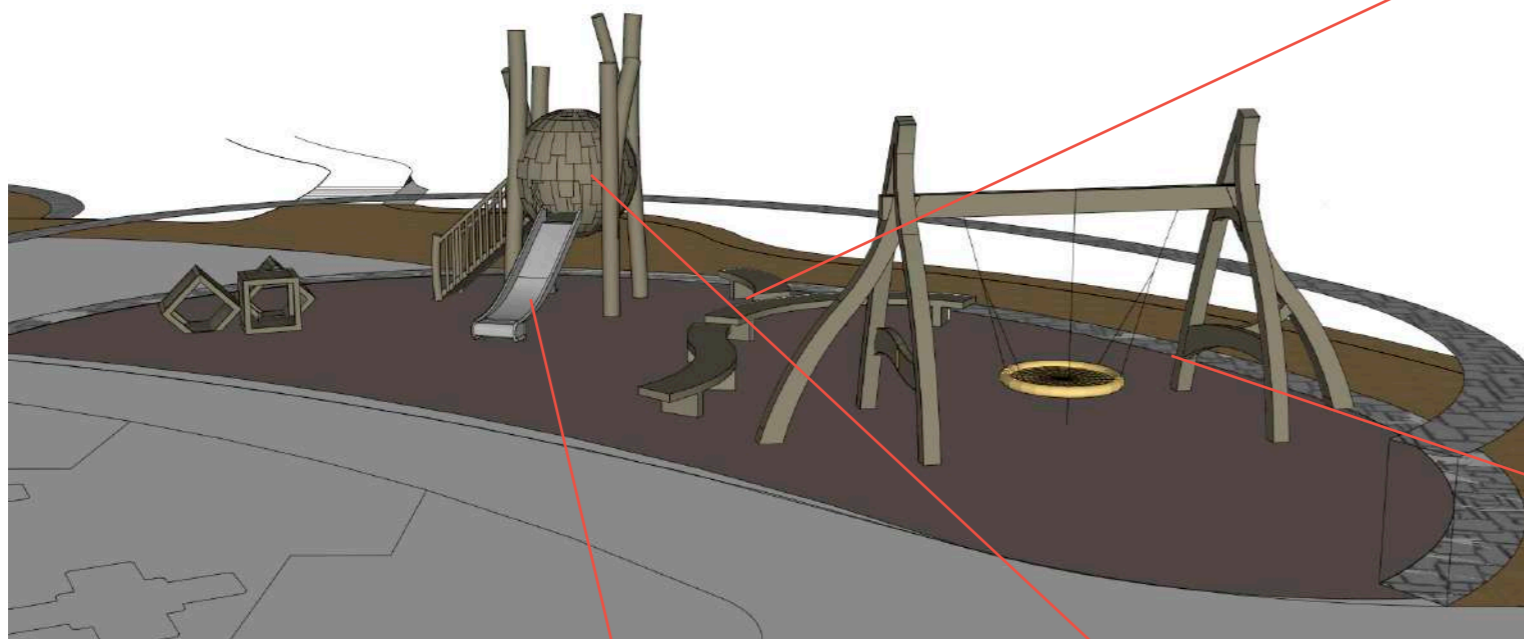

ABOVE - HEMP COLOURED SYNTHETIC BASKET SWING WITH UNFINISHED ROUGH SAWN GREEN OAK FRAME



RIGHT - STAINLESS STEEL SLIDE AND ANY FRAMED ELEMENTS IN ROUGH SAWN UNFINISHED GREEN OAK



LEFT - ROUGH OAK SHINGLES FOR POD CLADDING, UNFINISHED LEFT TO SILVER.

+44 (0)1273 473924
INFO@STUDIOHARDIE.COM

Wildman's lookout slide

BELOW - OAK BEAMS WITH SIMPLE MOULDINGS TURNING SILVER GREY WITH TIME

RIGHT - STAINLESS STEEL SLIDE TO BE CLAD IN ROUGHSAWN UNFINISHED GREEN OAK

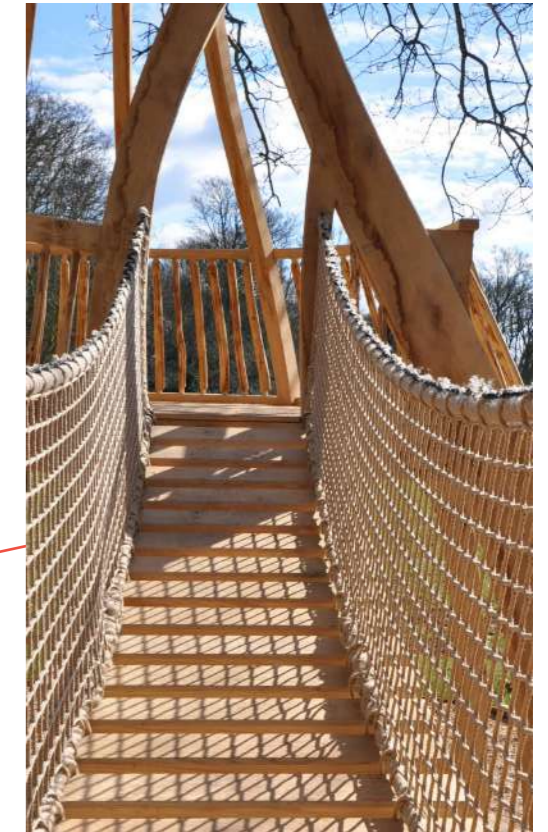
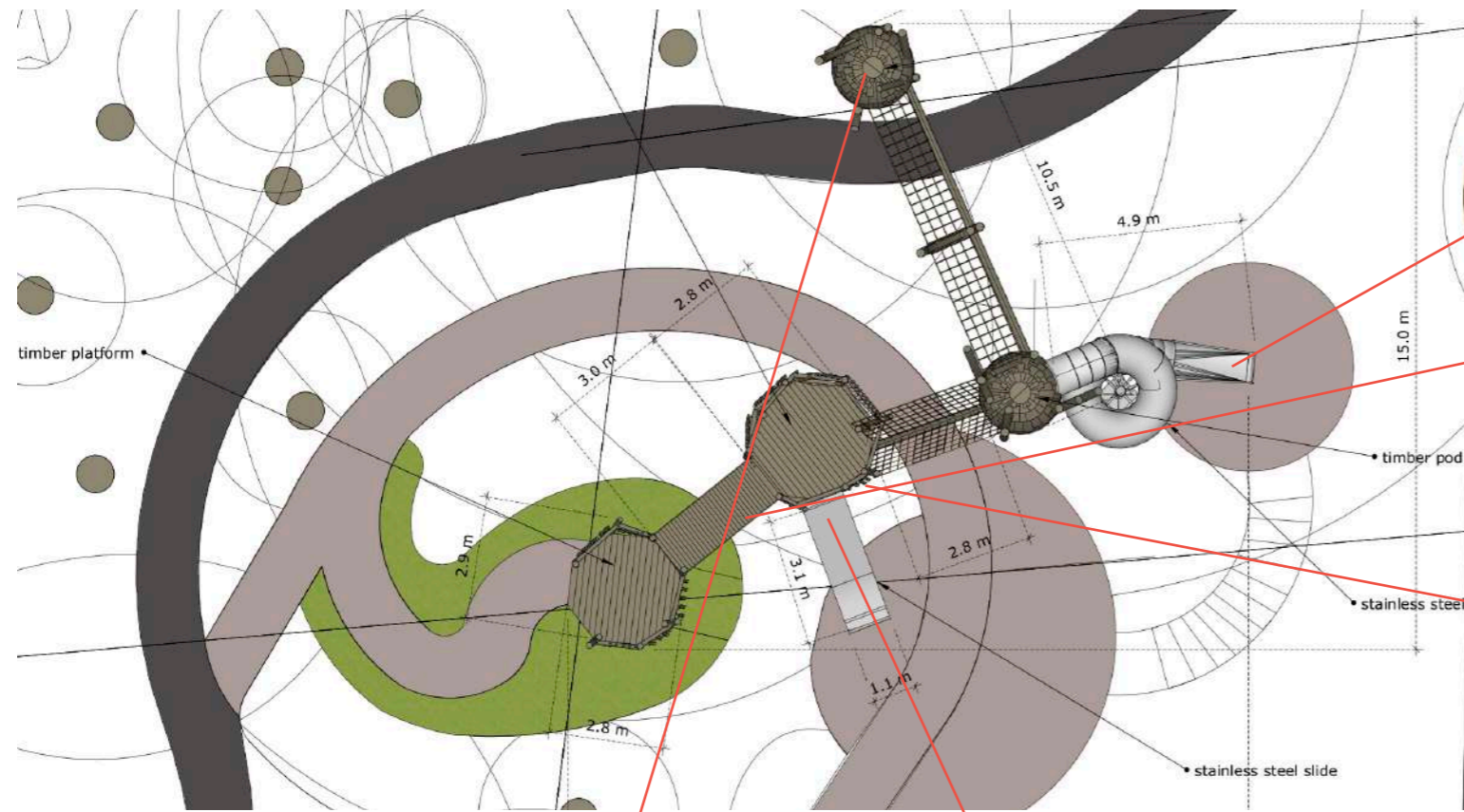

ABOVE - WOBBLE BRIDGE WITH HELP COLOURED SYTHETIC SAFETY NETTING AND OAK TREADS



ABOVE - COPPICED CHESTNUT BALUSTERS WITH OAK DECKING AND FRAME.

MATERIAL-
DECKING: PLANED OAK WITH REEDED FINISH

BALUSTERS: PEELED GREEN CHESTNUT IN THE ROUND

PODS: INTERNAL STEEL FRAME CLAD IN UNFINISH ROUGH SAWN GREEN OAK SHINGLES.

POSTS: DE BARKED ROBINIA IN THE ROUND

NETTING: NATURAL HEMP COLOURED COMBINATION ROPE AND HEMP COLOURED SYTHETIC SAFETY NETTING.

ALL OTHER TIMBERS IN ROUGH SAWN GREEN OAK.

FITCHES: HOT DIPPED GALVANISED STEEL



RIGHT - ROUGH OAK SHINGLED STRUCTURE



LEFT - STAINLESS STEEL SLIDE WOBBLE BRIDGE IN ROUGH SAWN GREEN OAK AND SYTHETIC HEMP COLOURED NETTING

Wilman's lookout slide covering.

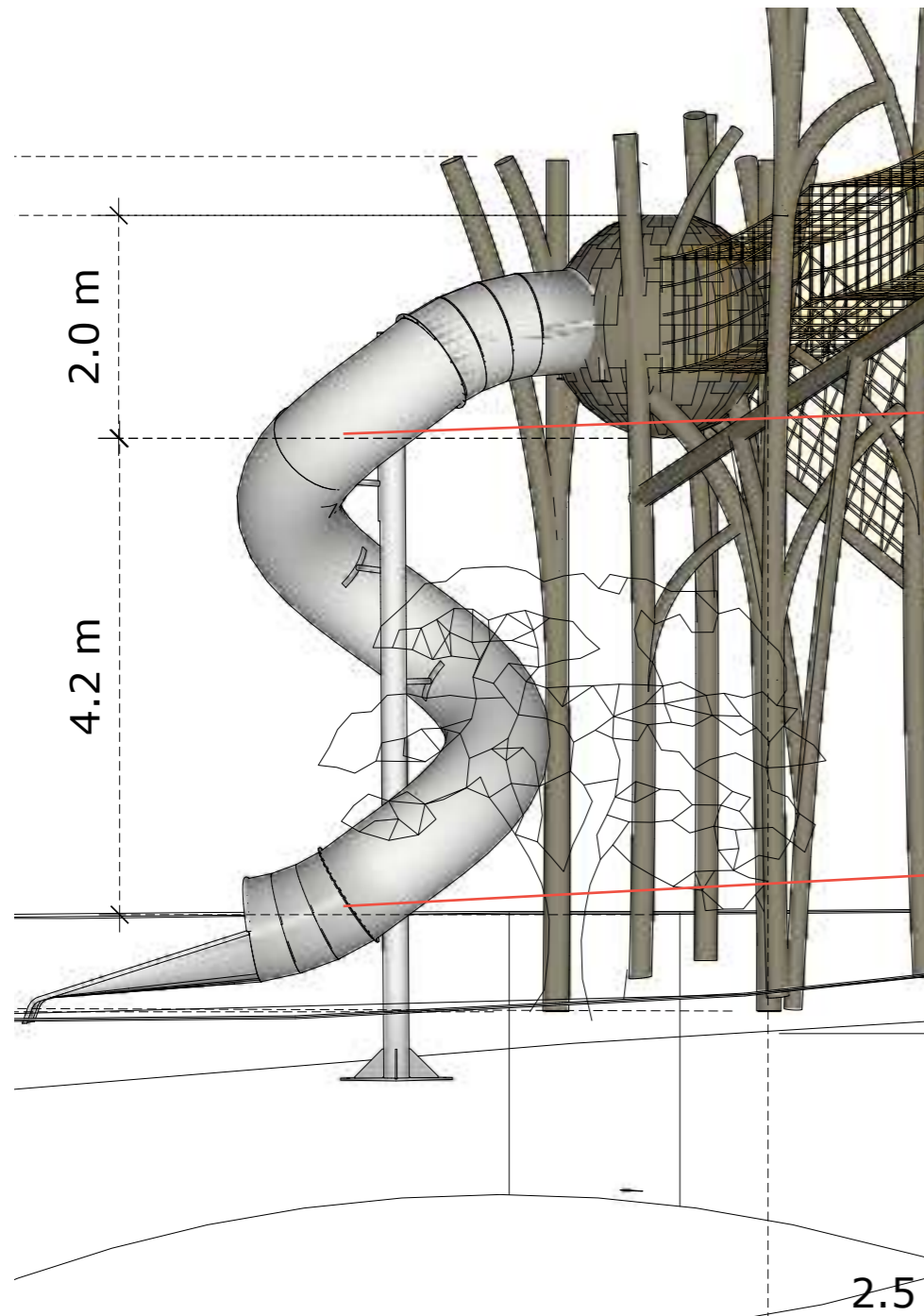

ABOVE - SLIDE CLAD INTERMITTANTLY
IN ROUGH SAWN UNTREATED GREEN
OAK AND ROBINIA IN THE ROUND.
BASE: VERTICAL TIMBER POSTS TO
DISCOURAGE CLIMBING CONSTRUCTED
FROM GREEN OAK AND VERTICAL
ROBINIA IN THE ROUND

MATERIAL-
SLIDE: STAINLESS STEEL
UPPER SECTIONS: CLAD IN ROBINIA
IN THE ROUND AND ROUGH SAWN
UNFINISHED GREEN OAK.

Wilman's lookout slide covering.



ABOVE - ROUGH SAWN UNTREATED GREEN OAK RANDOM LENGTHS AND WIDTHS.



ABOVE - ROBINIA IN THE ROUND FOR UPPER AND BASE SECTION.



ABOVE - ROBINIA IN THE ROUND FOR UPPER AND BASE SECTION.

MATERIAL-
SLIDE: STAINLESS STEEL
UPPER SECTIONS: CLAD IN ROBINIA
IN THE ROUND AND ROUGH SAWN
UNFINISHED GREEN OAK.