

NOTES:

01 Form 920mm wide opening through external wall. Install Robeslee Type C concrete lintol with min.150mm end bearing on 300mm x 150mm x 100mm concrete padstones to external leaf. Install 3 ply 195mm x 45mm Grade C16 timber lintol with min. 135mm end bearing on 3No timber cripple studs to timber frame inner leaf.

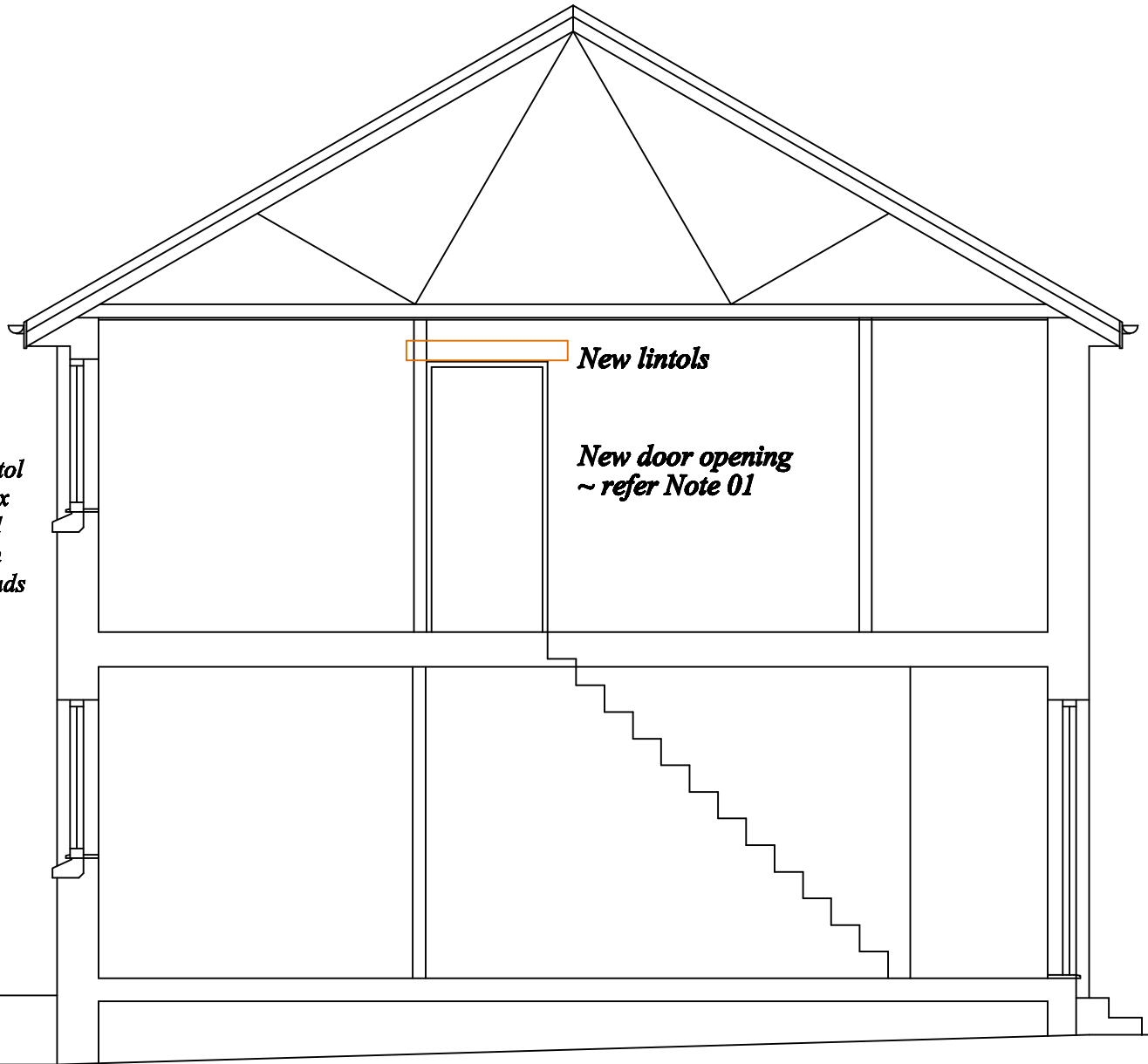

EXISTING SECTION

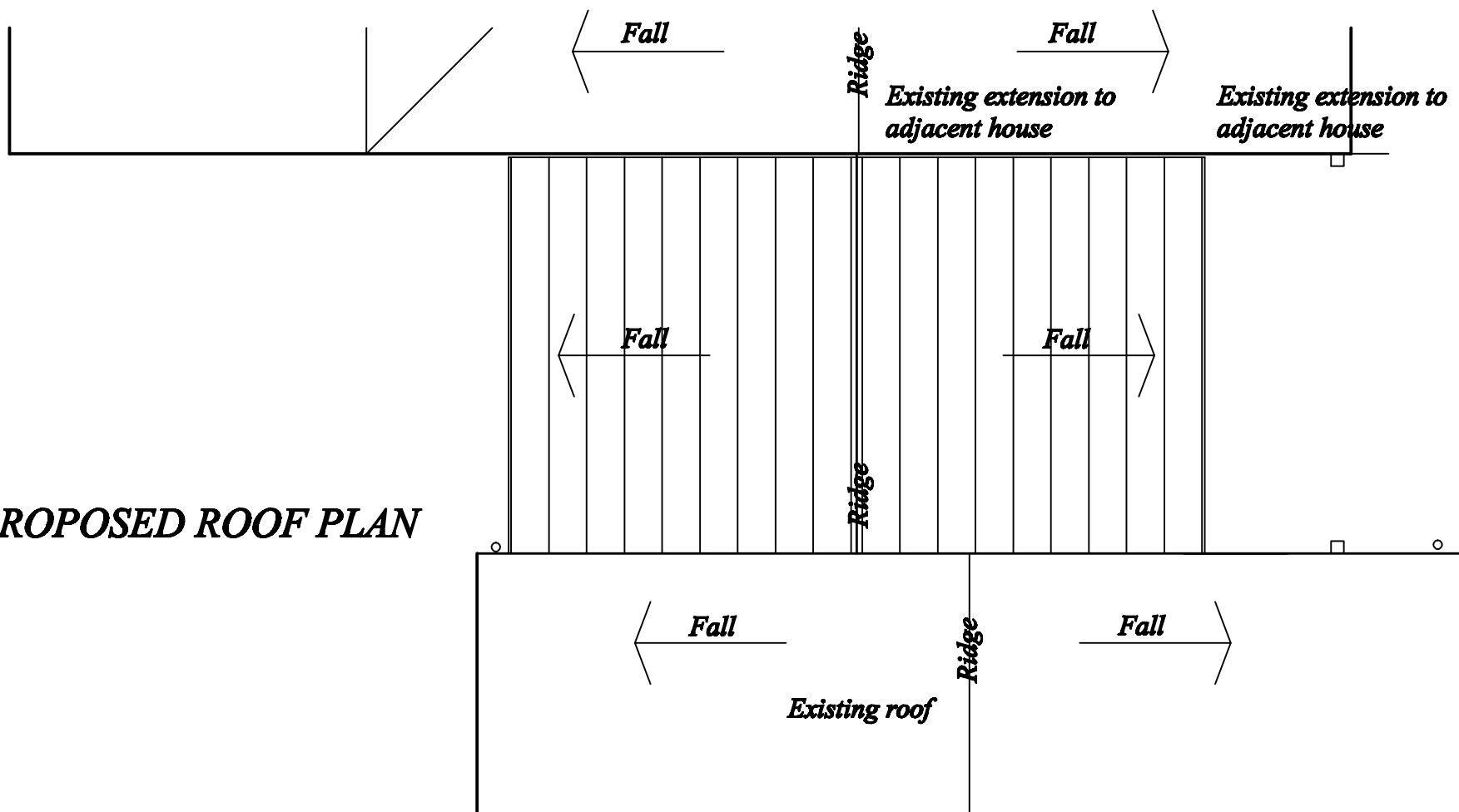

PROPOSED ROOF PLAN

<p>ARCHITECT</p> <p>II X II</p> <p>0740 ~ 100 ~ 2052</p>	<p>Project: 15 MACALLUM GARDENS ~ BELLSHILL</p>	<p>Date</p>	<p>Scale</p>	<p>Drg. No.</p>	
	<p>Title: EXISTING SECTION + PROPOSED ROOF PLAN</p>	<p>August 2021</p>	<p>1:50</p>	<p>08</p>	<p>21</p>
				<p>13</p>	