

PLANNING

Planning and Building Regulations Design Consultants
Architectural Technologists
Local Authorities Planning Agent Group Member
Local Authorities Building Control Partner Member
Planning Portal Professional Status
Landmark and Promag Member
Planning Appeal Consultants

www.cadmonkies.co.uk
cadmonkies@btconnect.com
01280 - 70 44 44



Head Office : The Boatouse, 19 Westminster Croft,
BRACKLEY, Northants, NN13 7ED
London Offices : Studio A2, Headcorn Road,
Thornton Heath, London, CR7 6JQ
Cadmonkies, Studio A2 Castle Yard,
Richmond, LONDON, TW10 5TF

CLIENT:
Mr P Welsh

ADDRESS:
445 Tachbrook Road
LEAMINGTON SPA, CV31 3DQ

CONTACT:
Ms D Pickard

SITE:
445 Tachbrook Road
LEAMINGTON SPA
CV31 3DQ

SCHEME:
Proposed Single Part Two Storey Rear
/ Side Extensions, Carport with
Associated Internal / External Works.

DRAWING TITLE:
Location, Block and Site
Plan

DATE: March 2022
DRAWN: david berloius

SCALE: 1:1250, 1:500
1:200
REV: 3 @

DRAWING No:

P/22/026/001



Site Plan 1:200



Block Plan 1:500

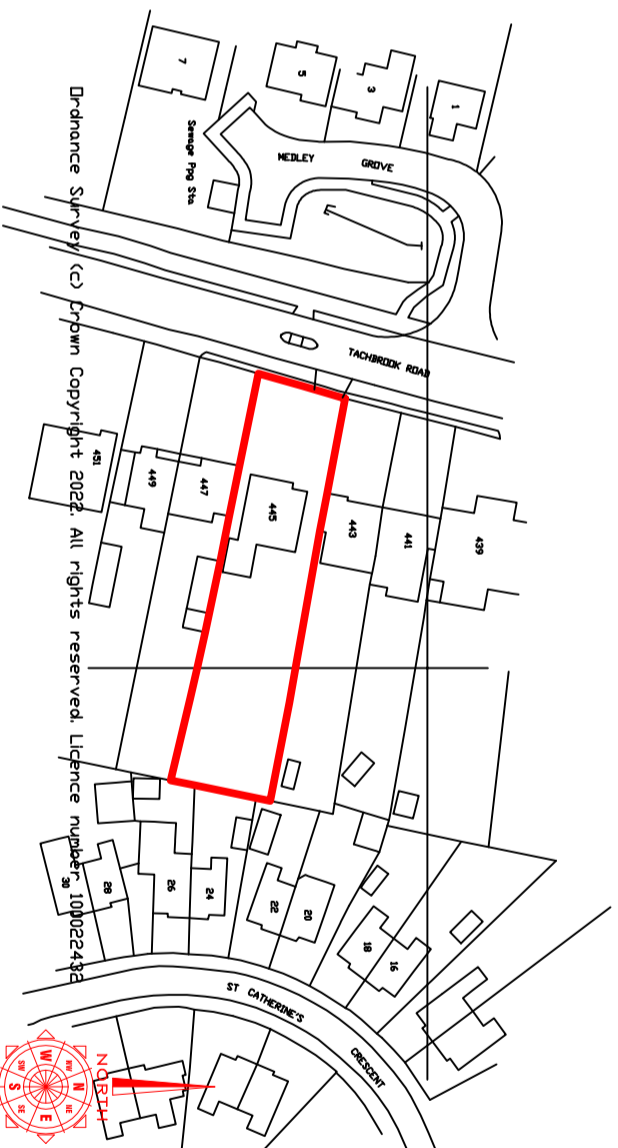

Existing Location Plan 1:1250

Dr-dance Survey (c) Crown Copyright 2022. All rights reserved. Licence number: 100022432

