

GENERAL NOTES

All dimensions to be verified on site, prior to work commencing and any discrepancies reported to the design team immediately. Figured dims. only to be adhered to.

DO NOT SCALE OFF THIS DRAWING. IF IN DOUBT ASK!

All works to be carried out in accordance with the relevant Building Regulations and the relevant British Standards and code of practice.

All materials and fittings to be supplied and fixed strictly in accordance with the manufacturer's printed instructions, specification and details.

Thermal bridging to be limited as much as possible. Limit air infiltration by sealing junctions at floors, walls, ceilings and at door, window and roof space openings and service penetrations.

All electrical work to be carried out in strict accordance with the relevant Building Regulations. The latest IEE regulations and to the local electrical board requirements. Existing electrical installation to be modified to accommodate all new works.

Final locations of all points and fittings to be agreed with client prior to fitting.

All services passing through floor construction to be fire stopped and damped with appropriate collars to provide 1 hour fire protection.

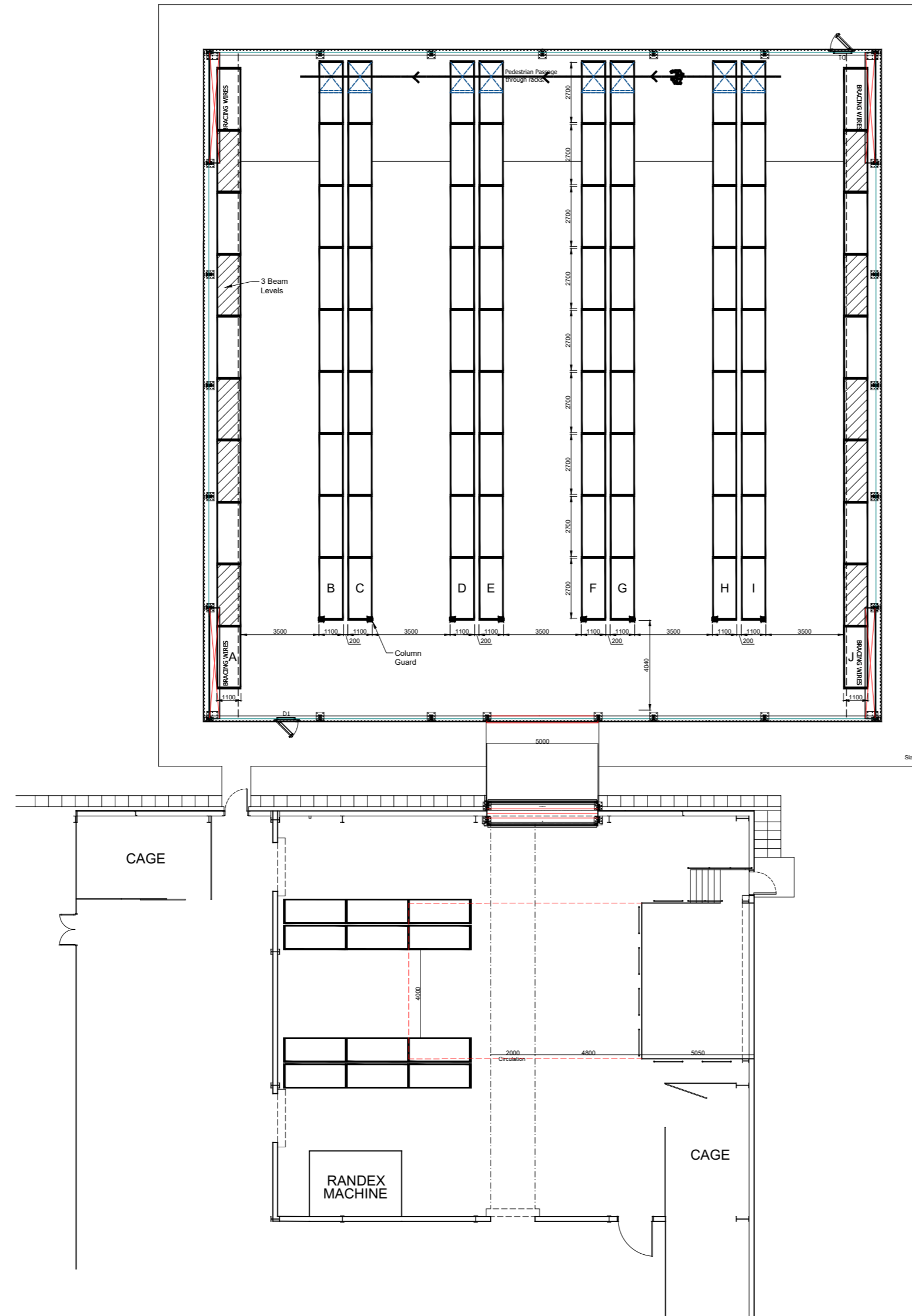

Revision	Description	Date

PLANNING

Principal Copy / Copy of Principal Copy
 Signed *Wellwood Leslie* For Wellwood Leslie Architects Date

All works to be in accordance with the Building Regulations & Local Bye Laws.
 All dimensions to be checked by Contractors on site prior to construction.
 All new drainage to be laid to the satisfaction of the Drainage Inspector.
 All electrical works to be in accordance with current IEE Regulations.
DO NOT SCALE



29 Eagle Street,
 Craighall Business Park,
 Glasgow, G4 9XA
 t: 0141 353 2040 e: admin@wellwoodleslie.com

Client
 Yaskawa Electric (UK) Limited

Project
 Yaskawa Temporary Building
 1 Hunt Hill Road
 Cumbernauld
 Glasgow
 G68 9LF

Drawing Title
 Proposed Racking Layout

Drawn GB	Checked KM	date	App. date
Scale 1:200	Date 25/02/22	Original sheet size A2	Rev

Job No. 2272	Dwg No. G(01)06	Rev
------------------------	---------------------------	-----

© The contents of this drawing remain the intellectual property of WellwoodLeslie Architects.

Proposed Racking Layout
 1:200

