

ABBOTSFORD HOUSE & MEWS PLAN

Shared gated entrance from New Street to:

- Abbotsford House
- Abbotsford Mews

Allocated parking for both House & Mews properties

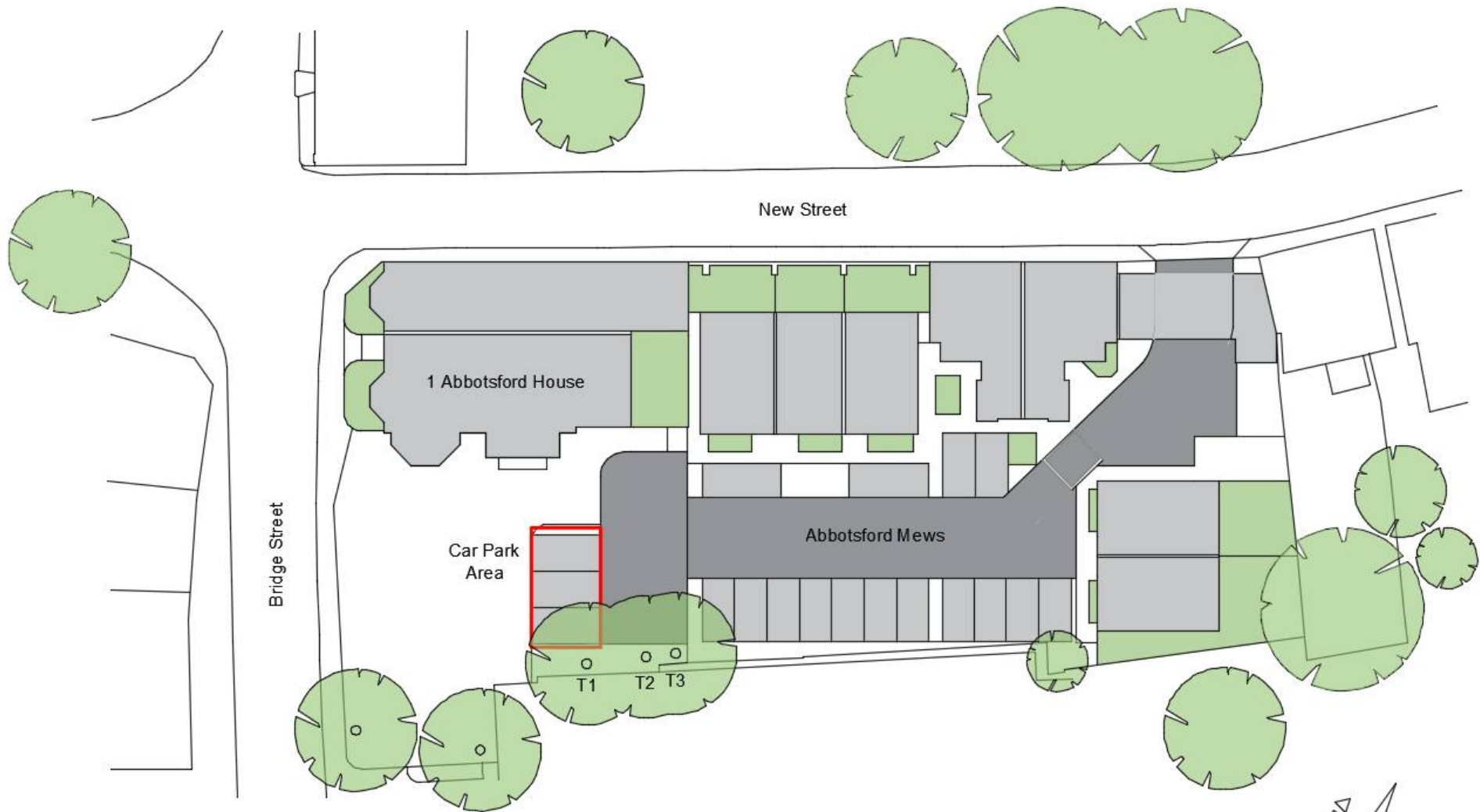

1 ABBOTSFORD HOUSE PLAN

Proposed car parking cover is not visible from street level outside of the development.

The carport is only directly visible from Abbotsford House and partially from Mews properties, as hidden behind a high wall into garden of 1 Abbotsford House, and then a further 2.5m+ wall onto Bridge Street

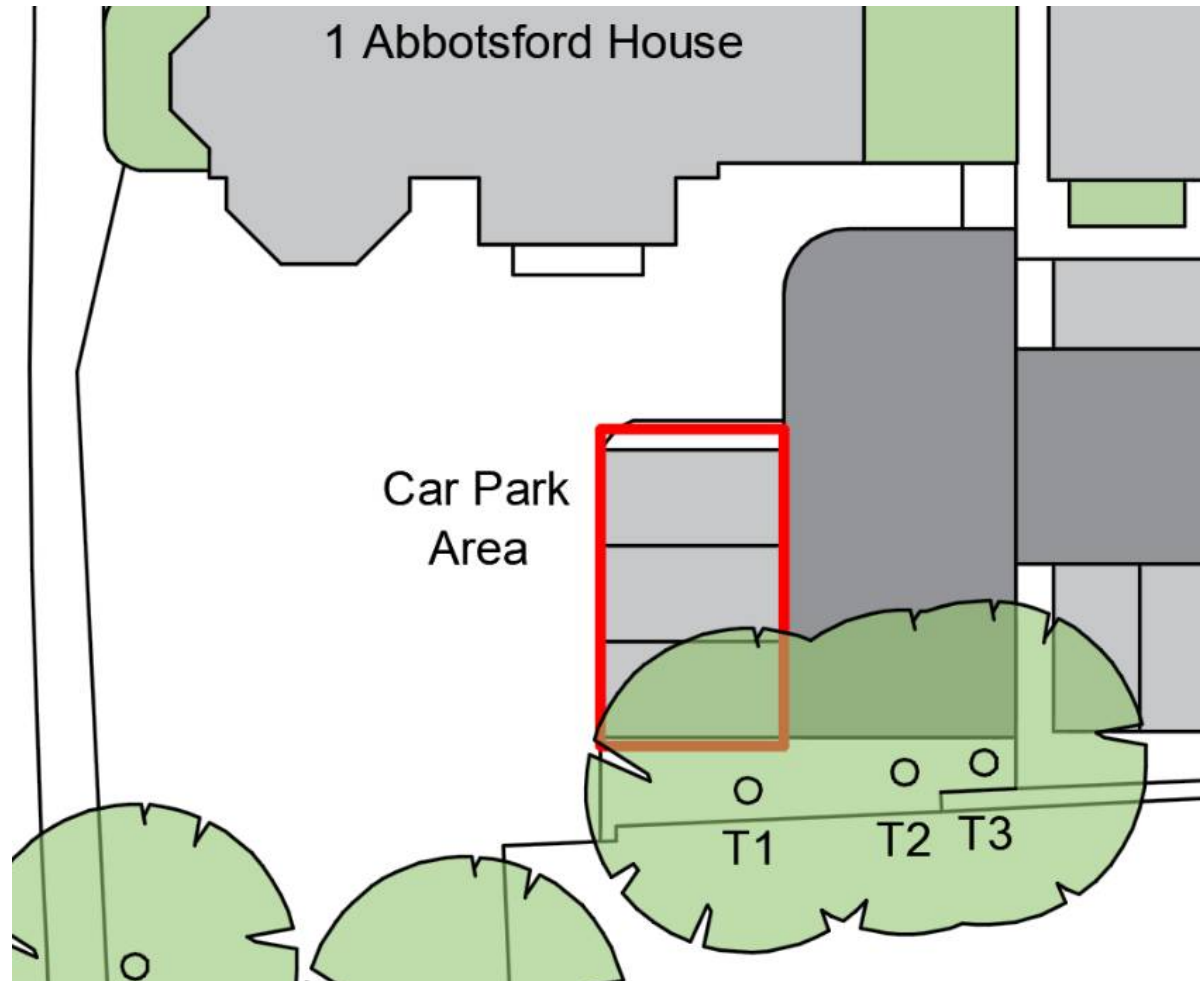

ABBOTSFORD PHOTOS

Photos stitched together to give view of surroundings.



ABBOTSFORD PHOTOS II

Photos showing views from car parking area.

South (facing car parking area and trees)



East (facing Abbotsford Mews)



North (facing Abbotsford House & Mews)



West (facing parking area and garden wall of 1 Abbotsford House)