

OPERATION AND MAINTENANCE REQUIREMENTS FOR ATTENUATION STORAGE TANKS		
MAINTENANCE SCHEDULE	REQUIRED ACTION	TYPICAL FREQUENCY
REGULAR MAINTENANCE	INSPECT & IDENTIFY ANY AREAS THAT ARE NOT OPERATING CORRECTLY. IF REQUIRED, TAKE REMEDIAL ACTION	MONTHLY FOR 3 MONTHS THEN ANNUALLY
	REMOVE DEBRIS FROM THE CATCHMENT SURFACE (WHERE IT MAY CAUSE RISK TO PERFORMANCE)	MONTHLY
	REMOVE SEDIMENT FROM PRE-TREATMENT ROAD GULLIES & SILT TRAP MANHOLE	MONTHLY FOR 3 MONTHS THEN ANNUALLY OR AS REQUIRED
REMEDIAL ACTIONS	REPAIR/REHABILITATE INLETS, OUTLETS, OVERFLOWS & VENTS	AS REQUIRED
MONITORING	INSPECT/CHECK ALL INLETS, OUTLETS, VENTS & OVERFLOWS TO ENSURE THAT THEY ARE IN GOOD CONDITION & OPERATING AS DESIGNED	ANNUALLY
	CCTV SURVEY INSIDE OF TANK FOR SEDIMENT BUILD-UP & REMOVE IF NECESSARY	AFTER CONSTRUCTION, 1 YEAR, & THEN EVERY 5 YEARS OR AS REQUIRED

KEY:

- SW000 CL: IL: 1500, Xmm @ 1:X SURFACE WATER MH & DRAINAGE RUN
- FW000 CL: IL: 1500, Xmm @ 1:X FOUL WATER MH & DRAINAGE RUN
- CW000 CL: IL: XX0, Xmm @ 1:X COMBINED WATER MH & DRAINAGE RUN
- EX SW CL: IL: XX0, Xmm @ 1:X EXISTING SURFACE WATER MH & DRAINAGE RUN
- EX CW CL: IL: 1500, Xmm @ 1:X EXISTING COMBINED WATER MH & DRAINAGE RUN
- SW CL: IL: FLOW CONTROL MANHOLE
- HYDROBRAKE: FLOOD ROUTE
- EXISTING SW CHANNEL DRAIN
- EXISTING SURFACE CHANNEL DRAIN
- SURFACE GULLY
- SURFACE RODDING EYE
- RAINWATER PIPE
- SOIL VENT PIPE
- FLOOD ROUTE FOR STORM EVENTS IN EXCESS OF 1 IN 100 YEARS + 40% CLIMATE CHANGE
- PROPOSED BANKING
- PROPOSED LEVELS
- PROPOSED GRADIENTS
- EXISTING BOUNDARY LEVELS
- RETAINING WALL

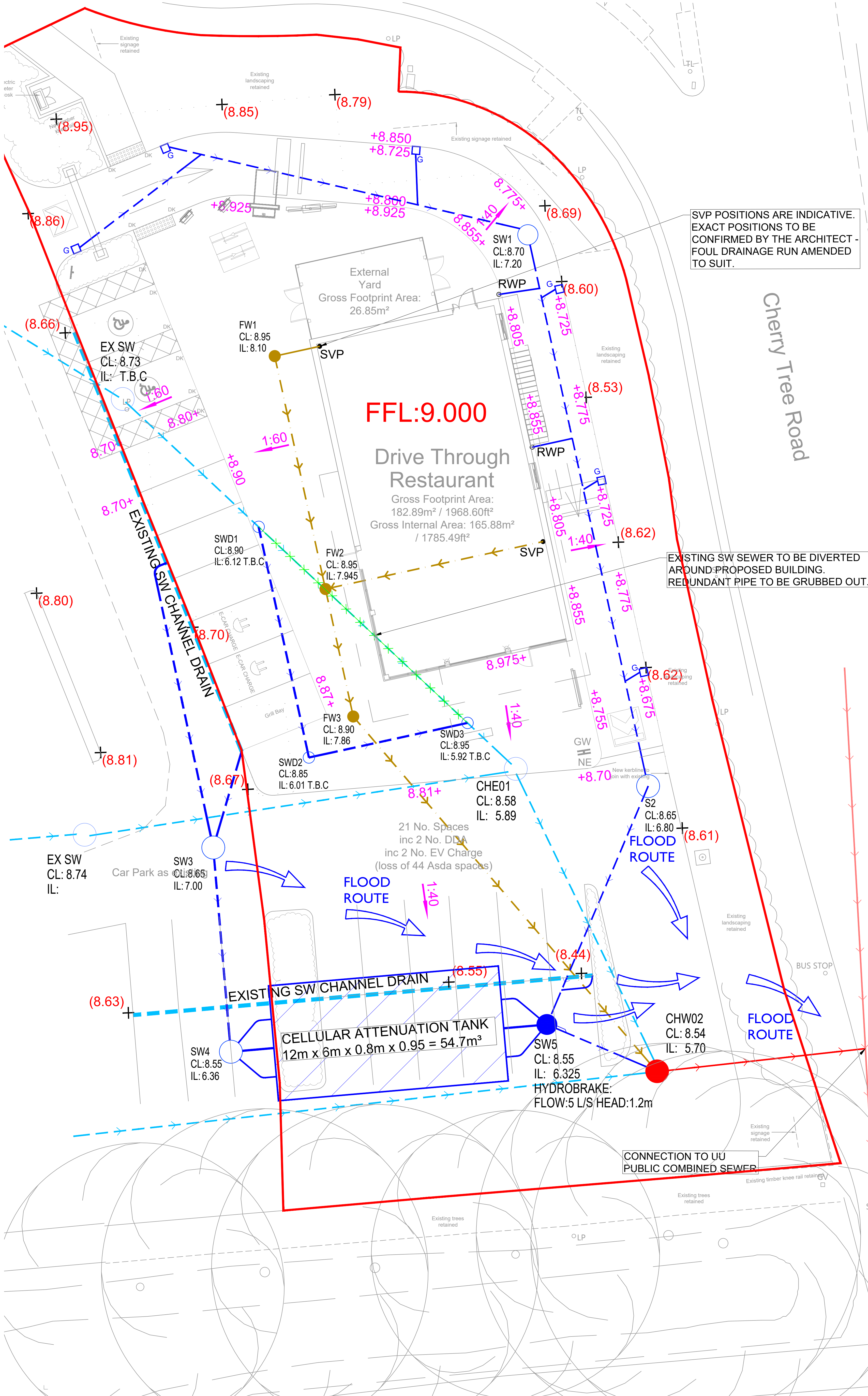

CDM NOTES

SEWER CONNECTION IN HIGHWAY. TEMPORARY LANE CLOSURE REQUIRED

- ACCESS AND EGRESS TO THE SITE OFF A BUSY CAR PARK.
- EXISTING SERVICES IDENTIFIED ON SITE.
- ADEQUATE MEASURES REQUIRED TO CONTROL NOISE, DUST, FUMES AND VIBRATION.
- POTENTIAL GROUND INSTABILITY IN DEEP EXCAVATIONS.

REV.	DATE	REVISION	BY	CHK.
-	-	FIRST ISSUE	PH	NB
A	27.01.22	UPDATED TO SUIT LATEST ARCHITECT'S LAYOUT DRAWING 1834-15.	PH	NB

Euro Garages Ltd

Proposed Drive Thru Coffee Shop
Asda Cherry Tree Road, Blackpool

Drainage Layout Plan

Goodson Associates
Tel: +44 (0)113 369 7925
Fax: -
Email: leeds@goodsons.com
Web: www.goodsons.com

Consulting Civil, Structural & Transportation Engineers
Fountain House, 4 South Parade,
Leeds, LS1 5QX
Also at Aberdeen, Edinburgh and Glasgow.

PLANNING

DATE CREATED: June.2021	SCALE: 1:100 @ A1
CONTRACT No: P14995	DRAWING No: 500
REV: A	