

POST BASE DETAIL

1:5

*Recommended Timber posts fixed to concrete base using Simpson Strong tie PBH Heavy duty Elevated Post base (or similar) sized and fixed in accordance manufacturers instructions
Trusses / Wall plates, Rafters / Purlins / Post/ struts all in Oak*

- ⇒Scaling plans is not recommended.
- ⇒Existing Dimensions taken without intrusive survey and may therefore vary from those shown.
- ⇒All dimensions verified on site before commencement.
- ⇒Existing dimensions will be from finished surface whilst new dimensions before plaster.
- ⇒Plans and Construction notes to be read in conjunction with Structural engineers calculations.
- ⇒The information provided is for obtaining of Planning and Building Regulation approval— further details may be needed during construction.
- ⇒Inspection of material used, build methods and quality is not the responsibility of Malcolm Clark Associates

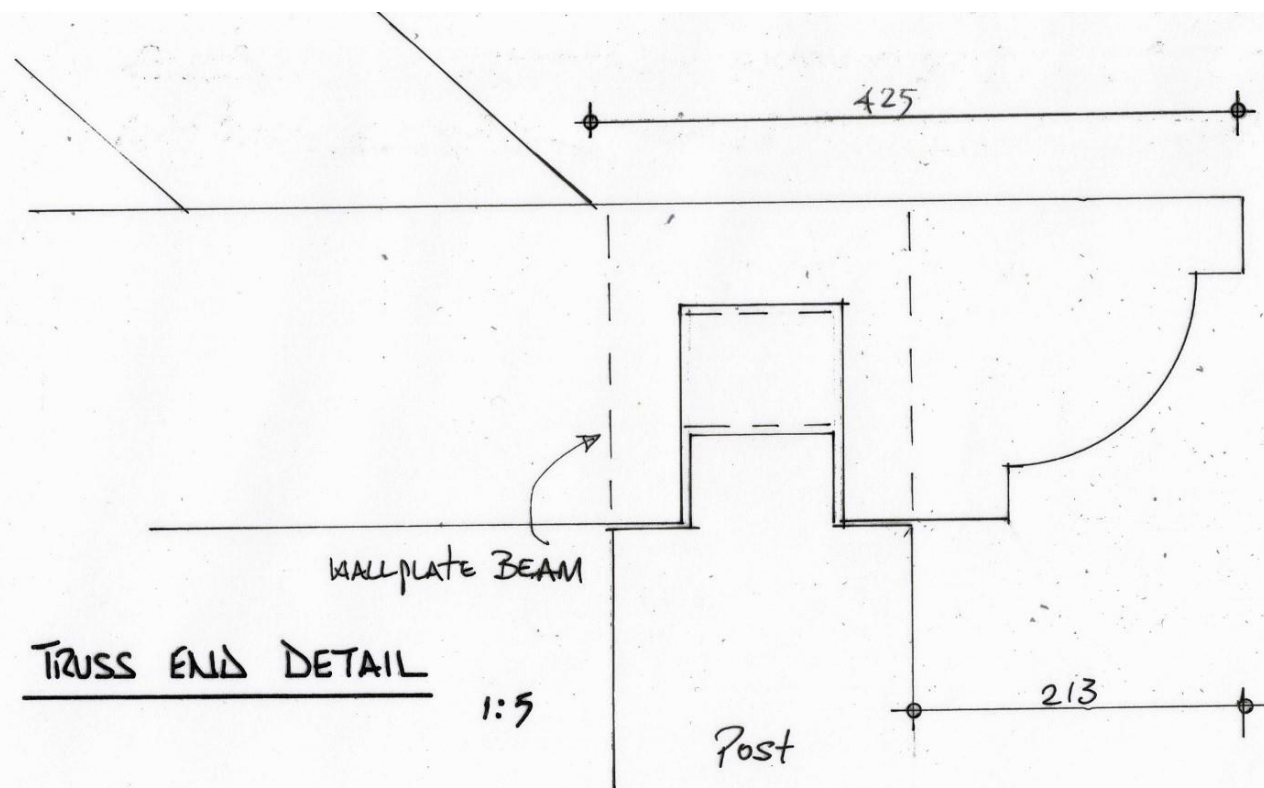

TRUSS END DETAIL

1:5

**The Bull Pens,
Kennel Lane,
Doddington, Lincoln.
LN6 4RX**

Dwg No: **AC** DETAILS
Scale: **AS SHOWN**

Malcolm Clark Associates
+44 (0)1427 667151
+44 (0)7802 832984
mcassociates2@gmail.com