

TANZ TAKING HEAD OFFICE, NO 19 JP PROPERTY

SITE BOUNDARY LINE

1800MM BLOCKWORK WALL WITH 1800MM FENCE ABOVE

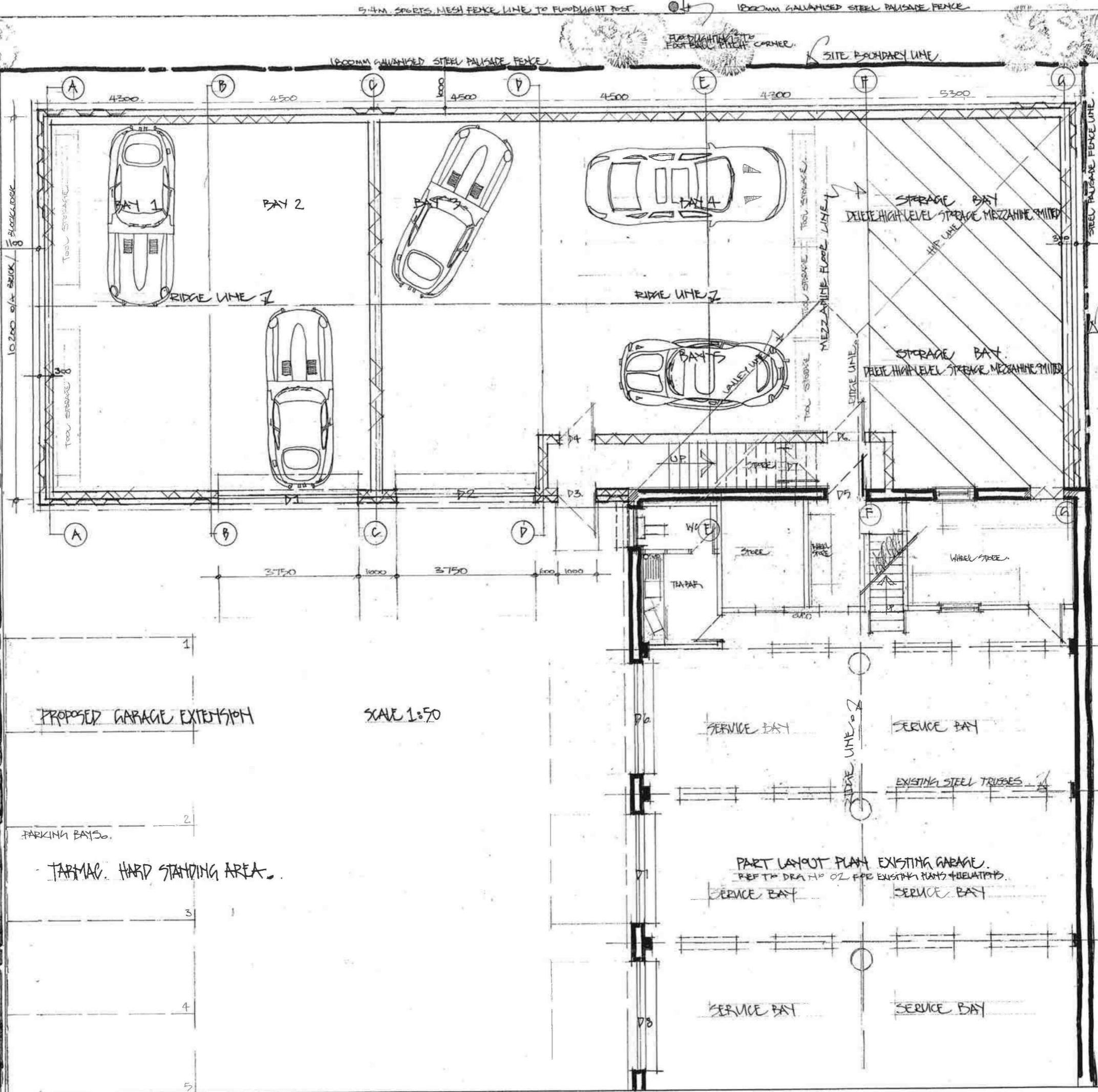

PROPOSED GARAGE EXTENSION

SCALE 1:50

PARKING BAYS

TARMAC HARD STANDING AREA

SERVICE BAY

SERVICE BAY

EXISTING STEEL TRUSSES

PART LAYOUT PLAN EXISTING GARAGE
REF TO DRA HP 02 FOR EXISTING PARTS RELATIONS

SERVICE BAY

SERVICE BAY

SERVICE BAY

SERVICE BAY

NOTES.
 CONTRACTOR TO CHECK ALL DIMENSIONS ON SITE PRIOR TO ORDERING MATERIALS OR COMMENCING WORKS.
 CAREFULLY BREAK OUT EXISTING CONCRETE SLAB BUS WASH AND ASSOCIATED DEBRIS AND REMOVE FROM SITE TO SUITABLE TIP.
 NEW GUTTERS STEEL FOXGUTTER SECTION SUPPORTED AT 600MM C/S TO DROP HOZIEL & 100MM DRAINPIPE WHERE SHOWN WITH DRAINAGE LAYOUT.
 PITCH ROOF DETAILS
 PROFILE SHEET ROOFING PANELS INSTALLED ON PURLIN BAILS ON STEEL TRUSSES ON GRID LINES AT SHOWN C/S A/C & B/C (A-G) @ A, 27,400 ±- E HEIGHT TO EAVES OF EXISTING GARAGE 4240MM NEW EAVES HEIGHT TO TIE INTO EXISTING. REFER TO SECTION.
 FORM NEW CLASSIC CAR LOWER STORAGE AREAS (BAYS) WITHOUT MEZZANINE FLOOR ACCESS HATCHED AREA NEW DELETED. ACCESS VIA EXISTING STAIR LANDING. NOTE EXISTING STAIR TO BE FULLY ENCLOSED IN BLOCKWORK TO FIRE EXIT DOORWAY D4 AS SHOWN OVER.
 BAY 1+2 AREA = 82.45m²
 BAY 3/4/5 + STORAGE = 179.5m²
 UPPER STORAGE = 51m² (MITED)

REVISION	DATE
A. EXIST GARAGE DETAIL ADDED	FEB 2022
4.9 MIT MEZZANINE FLOOR	
DRG TITLE: PROPOSED LAYOUT PLAN	

CLIENT: MCMI UAH
 BRADHURST ESTATE
 119A NEWHUT ROAD
 MOTHERWELL
 ML1 3ST.

SITE ADDRESS
 BRADHURST INDUSTRIAL ESTATE
 119A NEWHUT ROAD
 MOTHERWELL
 ML1 3ST.

RAHDESIGN
 THE WICKETS
 52 FORTROSE STREET
 GLASGOW G11 5LP.
 RAHDESIGN@GMAIL.COM
 SCALE 1:870 (DRG HP 01A)
 DATE JAN 2022.

THESE ARE THE PLANS PREPARED FOR THE APPLICATION FOR PLANNING & BUILDING WARRANT APPROVAL
 SIGNED: _____
 DATED: _____

WOODHEAD & MCGAUGH

SITE BOUNDARY LINE

SITE BOUNDARY LINE

1800MM GALVANISED STEEL PALISADE FENCE

1800MM GALVANISED STEEL PALISADE FENCE

5.4M SPORTS MESH FENCE LINE TO FLOODLIGHT POST

FLOODLIGHTS TO FOOTBALL PITCH CORNER