

This copy has been made by or with the authority of Midlothian Council pursuant to Section 47 of the Designs and Patents Act 1988. Unless that Act provides a relevant exception to copyright, the copy must not be copied without the prior permission of the copyright owner.

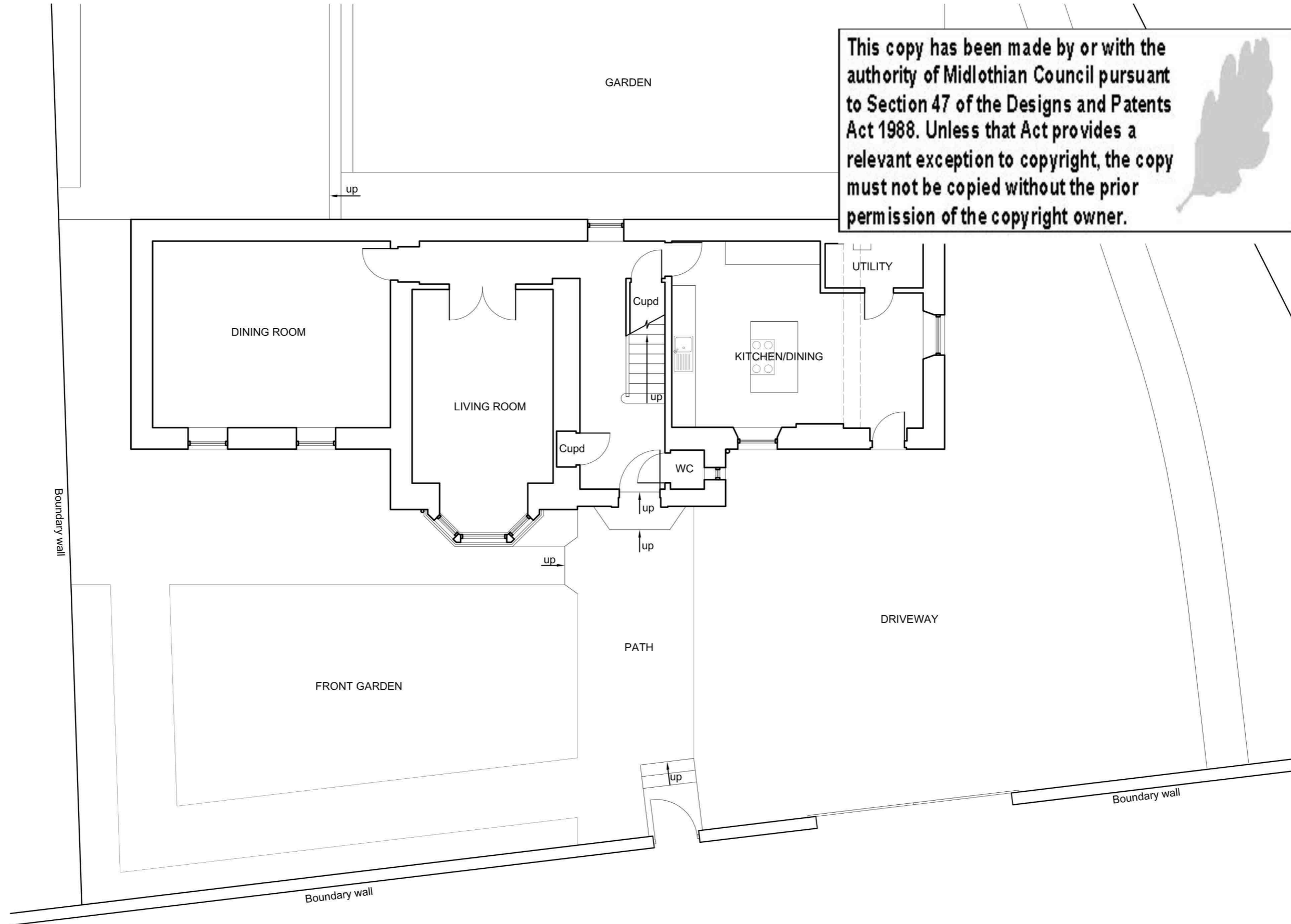

EXISTING GROUND FLOOR PLAN 1:100

<p>Kyla Martin BDes (Hons) Architectural Services Ltd Registered in Scotland. Company number SC589048. 97 Newington Road, Edinburgh, EH9 1QW Tel: 0131 629 0060 Email: admin@kylamartinarchitecturalservices.co.uk Web: www.kylamartinarchitecturalservices.co.uk</p>	<p>SERVICES OFFERED: FREE CONSULTATION SKETCH PROPOSALS PLANNING APPLICATIONS LISTED BUILDING APPLICATIONS BUILDING WARRANT APPLICATIONS AMENDMENT TO WARRANT APPLICATIONS DEED PLANS LIQUOR LICENSING DRAWINGS</p>	<p>THIS DRAWING WAS PREPARED TO OBTAIN BUILDING CONTROL AND/OR PLANNING PERMISSION AND CAN ONLY BE USED AS A WORKING DRAWING WITH PERMISSION FROM KYLA MARTIN. THIS DRAWING IS NOT TO BE REPRODUCED WITHOUT PERMISSION.</p> <p>CONTRACTOR NOT TO DEVIATE FROM THE APPROVED DRAWING WITHOUT INFORMING KYLA MARTIN.</p> <p>ALL SIZES AND DIMENSIONS TO BE VERIFIED.</p>	DRAWING TITLE: Existing ground floor plan				REV:	DATE:	DETAILS:
			JOB TITLE: 37 Polton Road, Lasswade, Midlothian, EH18 1AF				CLIENT: Filomena & Giancarlo Crolla		
		DRAWING NO: 1089 10		DATE: 04.10.2021	STATUS: PL, LB & BW	SCALE: 1:100 @ A3			