

designmanagementpartnership
 8 Trade Street, Cardiff, CF10 5DF
 T +44(0)29 2064 4829
 F +44(0)29 2064 4831
 E mail@designmanagementpartnership.com

no	rev	date	description	no	rev	date	description
1				1			

code	DA1	drawn		date	09/09/17	status	Planning	zone	16.011	rev	-
title	Existing Plan										
client	Cat & Fiddle Exeter For St Austell Brewery										
drawn	Cat & Fiddle										
check	Exeter										
date	09/09/17										
status	Planning										
zone	16.011										
drawn	Cat & Fiddle										
check	Exeter										
date	09/09/17										
status	Planning										
zone	16.011										
drawn	Cat & Fiddle										
check	Exeter										
date	09/09/17										
status	Planning										
zone	16.011										

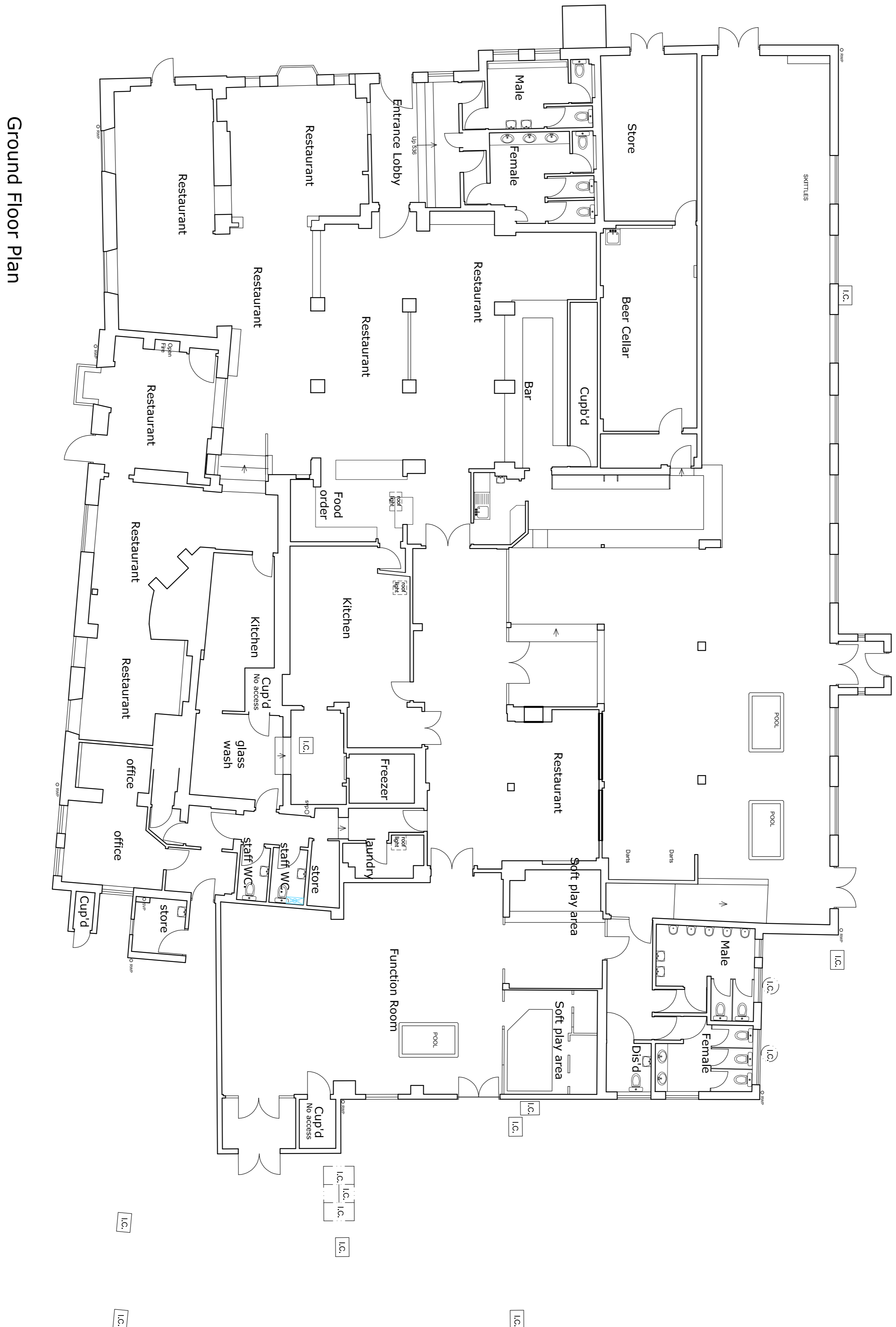

Ground Floor Plan

Figured dimensions to be used in preference to scaled dimensions.
 All dimensions to be provided by the contractor before commencing work and any
 discrepancies to be noted on the drawings.
 The drawings are the property of designmanagementpartnership.
 Copyright is reserved by them and the drawing is to be used on the condition that the
 copies, reproductions, modifications or applications to any use, printed or otherwise, without
 their written consent are prohibited. designmanagementpartnership