

SIDE ELEVATION

CONCRETE INTERLOCKING ROOF TILES ON 25x25mm BATTENS ON MONARDELY BREATHER MEMBRANE ON PRE-ENGINEERED GANGNAIL ROOF TRUSSES AT 600MM CENTRES TO CP 112 SPIKED TO WALLPLATE (TRUSSES TO BE DESIGNED IN ACCORDANCE WITH BS 5268 PART 1950).

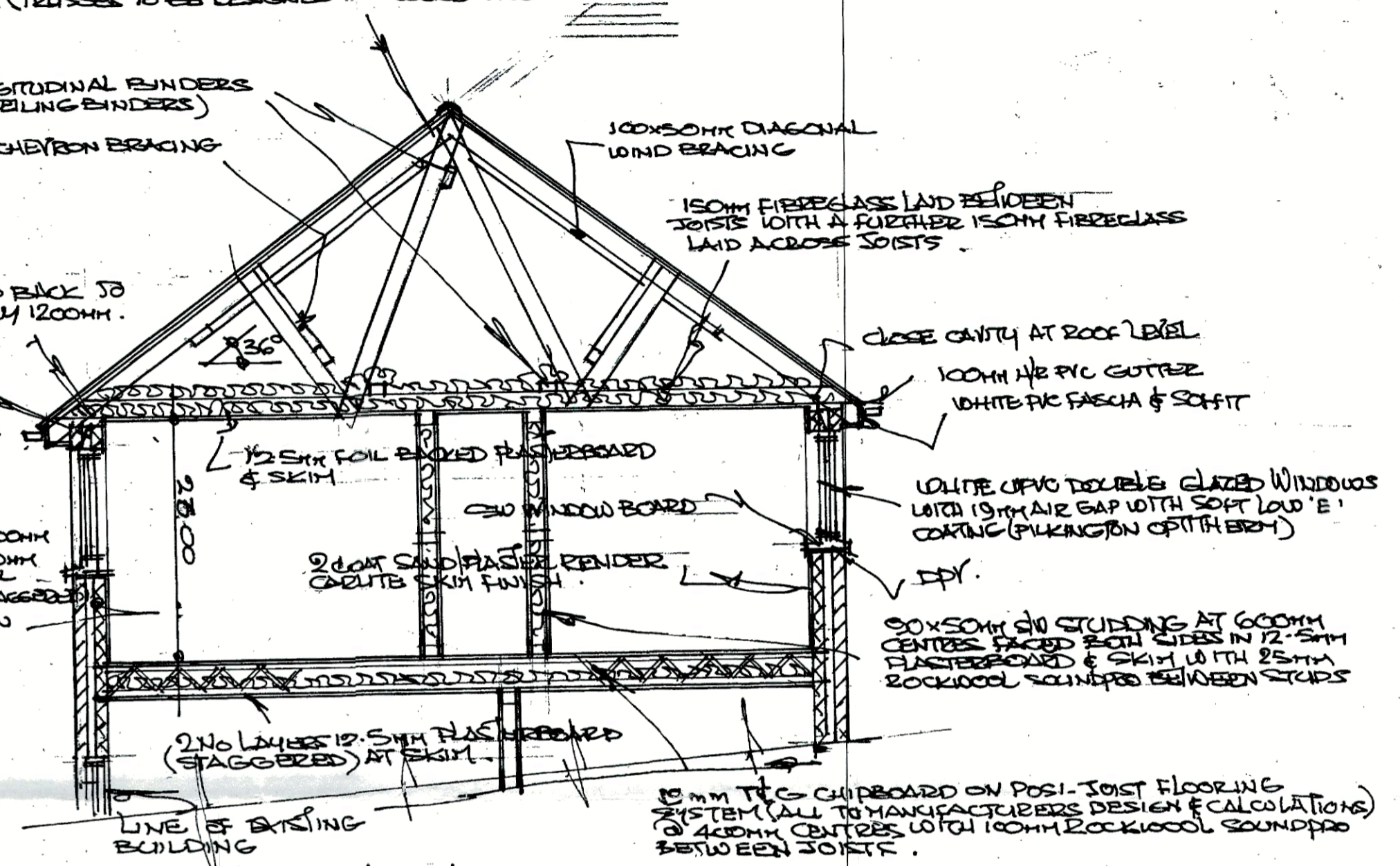

typical section

NOTES.
 ALL WINDOWS TO HABITABLE ROOMS TO HAVE OPENING LIGHTS SUITABLE FOR MEANS OF ESCAPE TRICKLE VENTS TO ACHIEVE 800mm² TO ALL HABITABLE ROOMS.
 ALL NEW ELECTRICAL WORK TO BE DESIGNED, TESTED & INSTALLED IN ACCORDANCE WITH (SEE REGULATIONS) AND BE FITTED WITH ENERGY EFFICIENT FITTINGS.
 ALL SMOKE ALARMS TO BE INTERLINKED & SELF-CONTAINED & INSTALLED IN ACCORDANCE WITH APPROVED DOCUMENT B1 (ADE) & BS 5889-6 BE MAINS POWERED & BE FITTED WITH SUITABLE BATTERY BACKUP.
 HEATING SYSTEM TO BE ELECTRIC RADIAITORS (FITTED IN ACCORDANCE WITH MANUFACTURERS INSTRUCTIONS) WHERE ANY PENETRATION THROUGH FIRE RESISTANT (COMPARTMENT) FLOOR OR WALL ENSURE HOLE IS SEALED WITH INTUMESCENT COLLAR.

ELEVATION & SECTION AS PROPOSED FOR 1a.1b. RUSPIGGE ROAD, CINDERFORD, GLOS. GL14.3AN.

FEBRUARY 2022

SCALE 1:50

3004 / 3

SHEET 2 of 2.

Post Room
 F.O.D.D.C
 31 MAR 2022