

Plan View

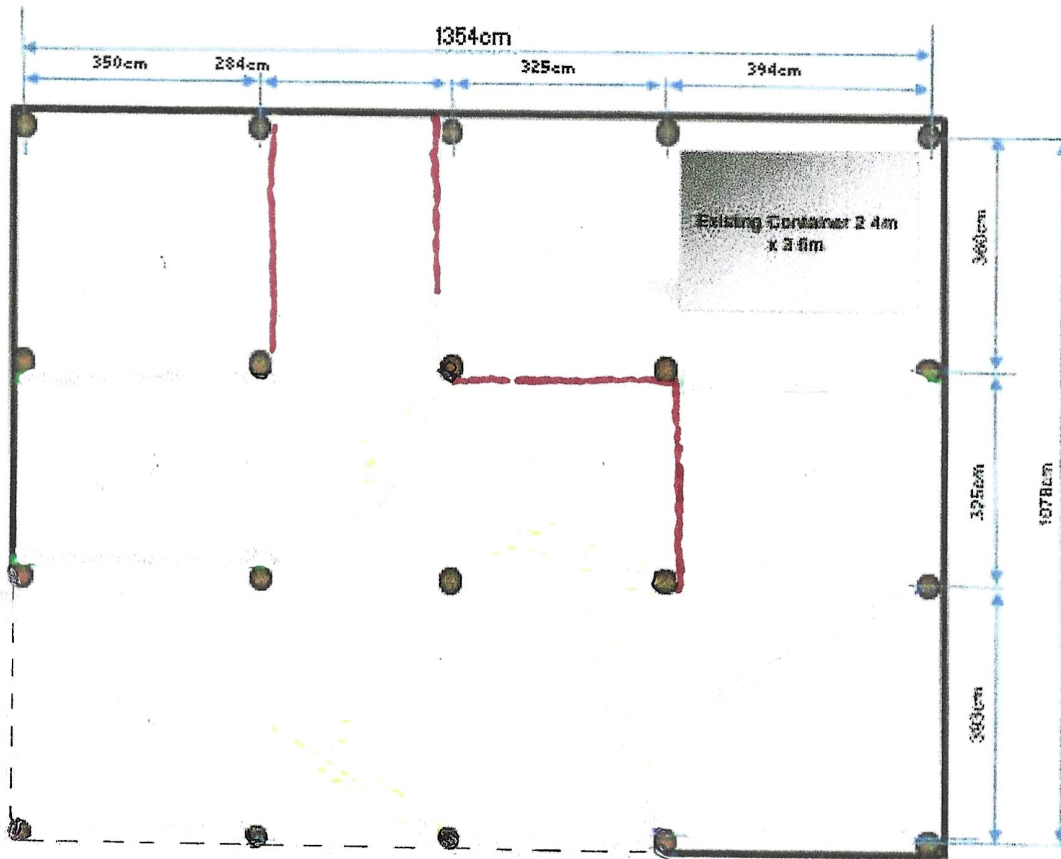

- Existing 200mm wooden pole ●
- Existing wooden wall — (red dashed line)
- Existing metal cladding — (black solid line)

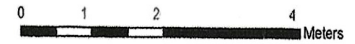

Project: Sarah Simmons Acorn Fields, Crabbswood Lane, SO41 6ER	Drawing Title: Existing basin floor plan	Rev:	Date:	Details:	Scale: 1 : 100
					Drawing No.: RSH/1