

This drawing must not be scaled.  
 Discrepancies are to be reported to the  
 Architect immediately. All dimensions  
 are approximate and are to be checked  
 on site. All information to be subject to  
 site surveys. This drawing, or any  
 portion of it must not be reproduced  
 without prior consent from the  
 Architect.  
 © Joseph Boniface Architects Ltd

**KING GEORGE AVENUE**

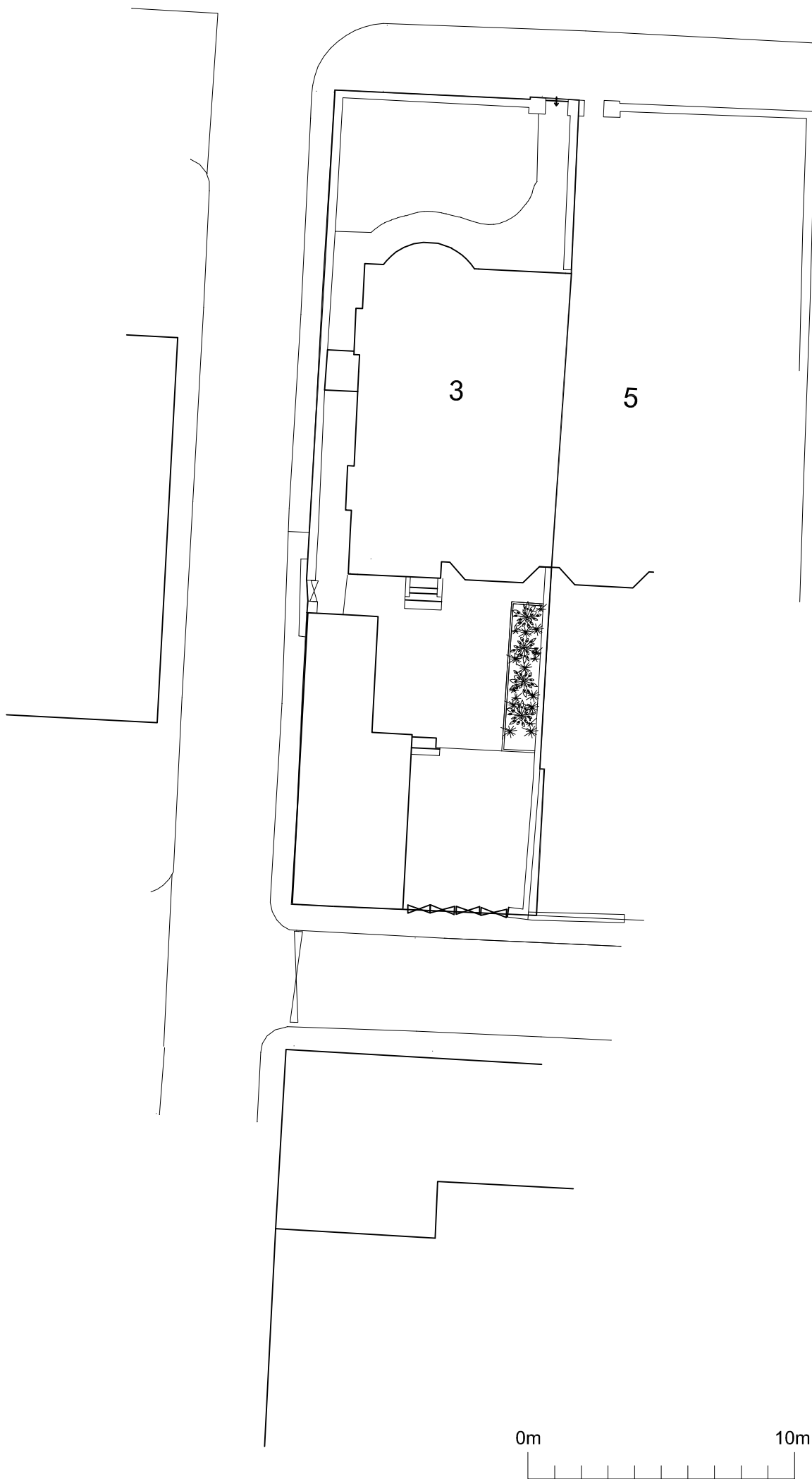

Rev.	Amendment	Date	By / Chk
\	- Initial issue.	14/04/22	JB/AC

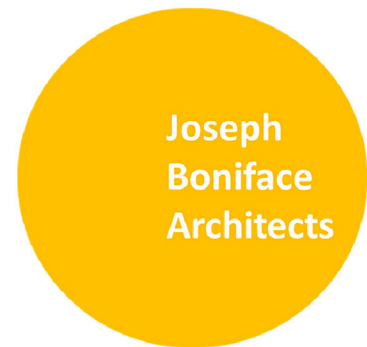

Joseph Boniface Architects Ltd  
 01253 280 485  
 bonifacearchitects.co.uk  
 office@bonifacearchitects.co.uk  
 62 Counce Street, Blackpool, FY1 3LA.

Project  
**3 King George Avenue  
 Blackpool  
 FY2 9SN**

Client  
**Simon Morris**

Drawing Title  
**Existing Site Plan**

Status  
**PLANNING**

Scale  
**1:200 @ A3**

Drawn By <b>JB</b>	Date <b>14/04/2022</b>
-----------------------	---------------------------

Drawing Number <b>JBA538-PL-013</b>	Revision <b>/</b>
--	----------------------