

Key:  
— Boundary

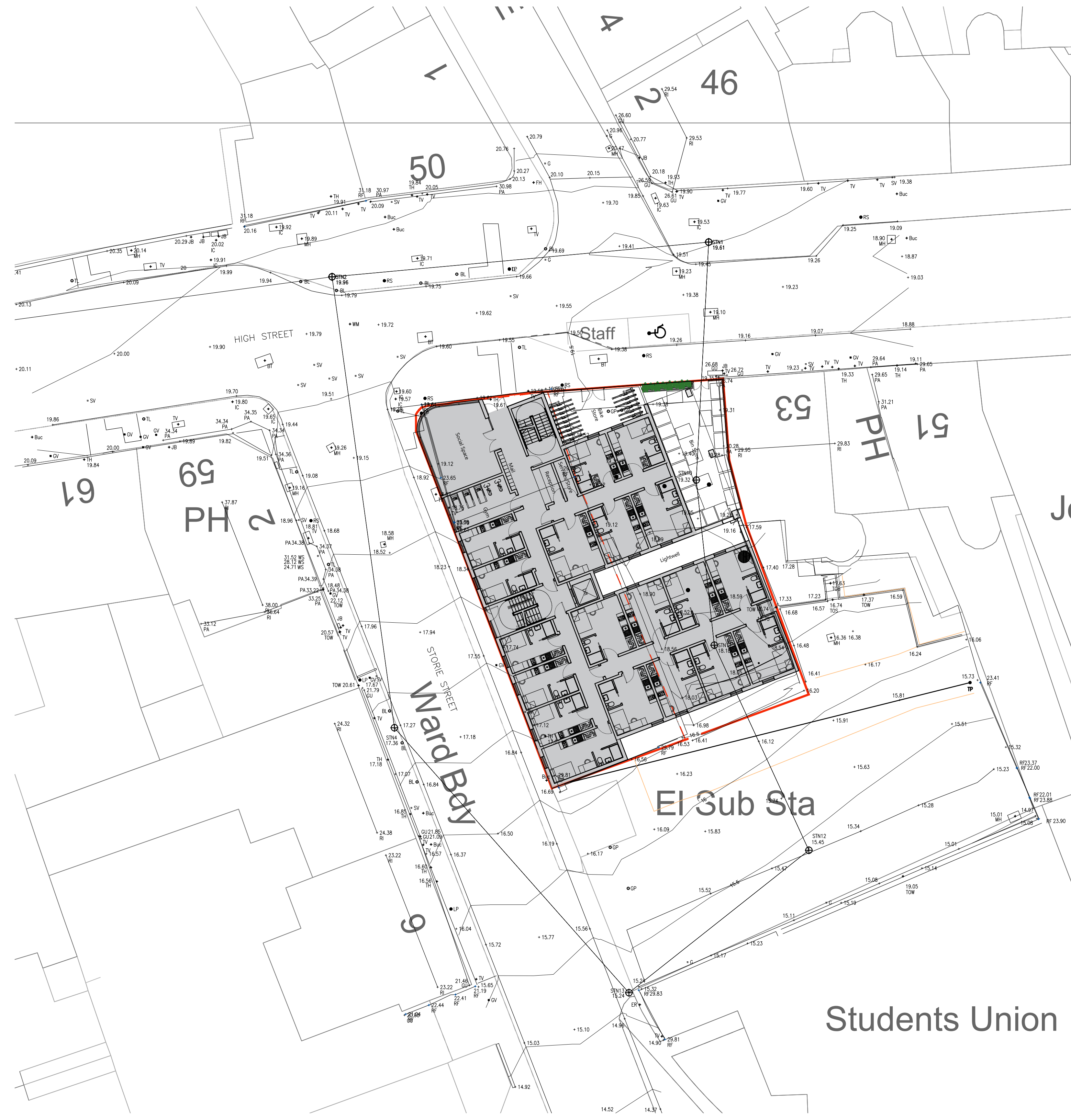

Proposed Site Plan  
Scale 1:200 on A1

Rev	Description	Date
Rev A	For Planning	30/03/22



Client: T100 Ltd  
Project: Proposed Student Residence  
55 - 57 High Street  
Paisley

Title: Proposed Site Plan

DWG no: 3618-PL(190)001 Date: 28/03/22

Drawn by: TS Checked by: Scale: 1:200

tinto.co.uk  
Mill House  
Grandholm Crescent  
Bridge of Don  
Aberdeen, AB22 8BB  
+44 (0) 1224 821 670



Copyright of TINTO Architecture Ltd  
Reg in Scotland No. SC263811  
This drawing must not be copied and  
any alterations should be brought to  
the attention of TINTO immediately.