

SITE LOCATION, BLOCK & SITE PLANS

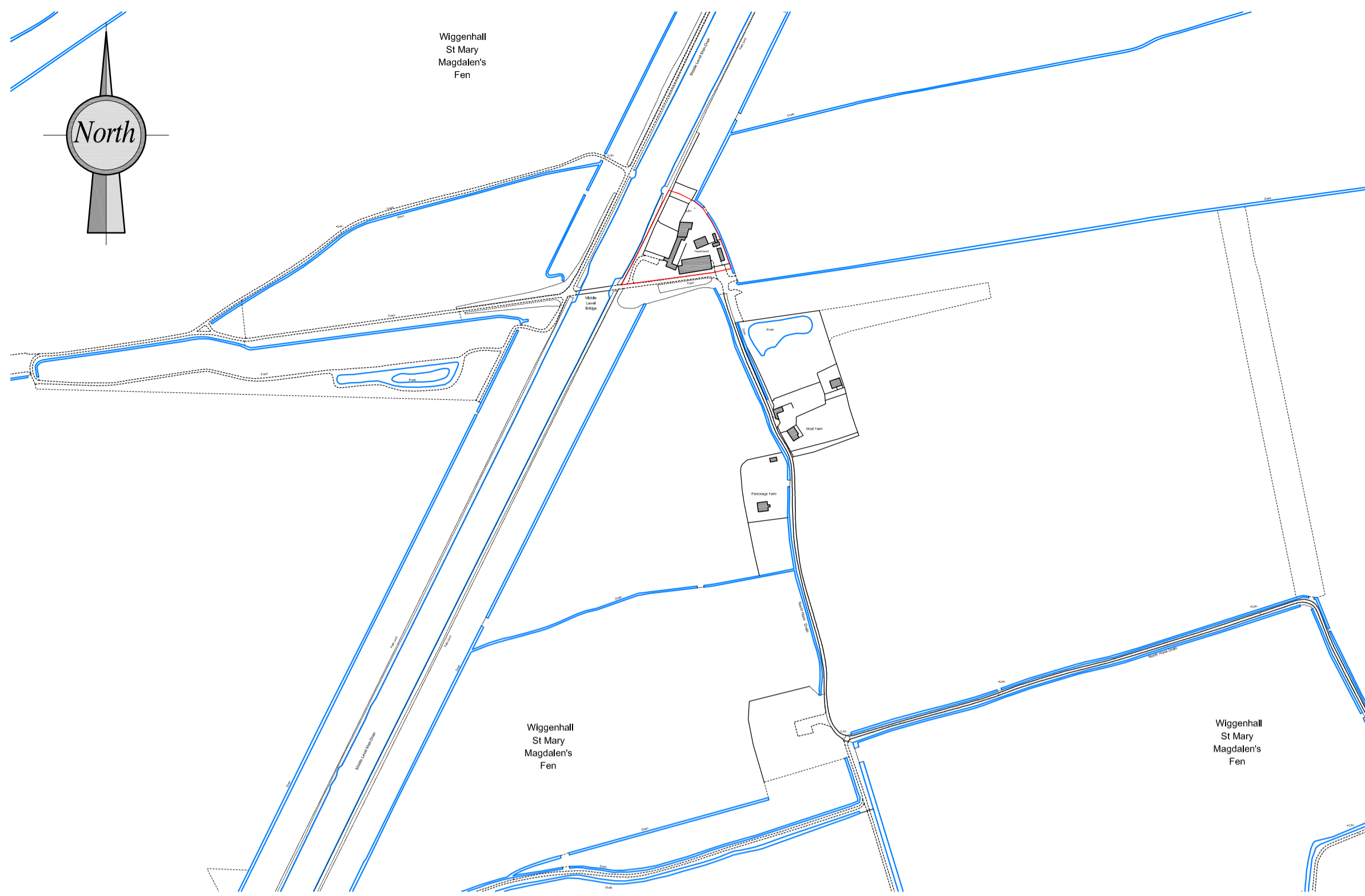

EXPLORER MAP
SCALE 1:5000

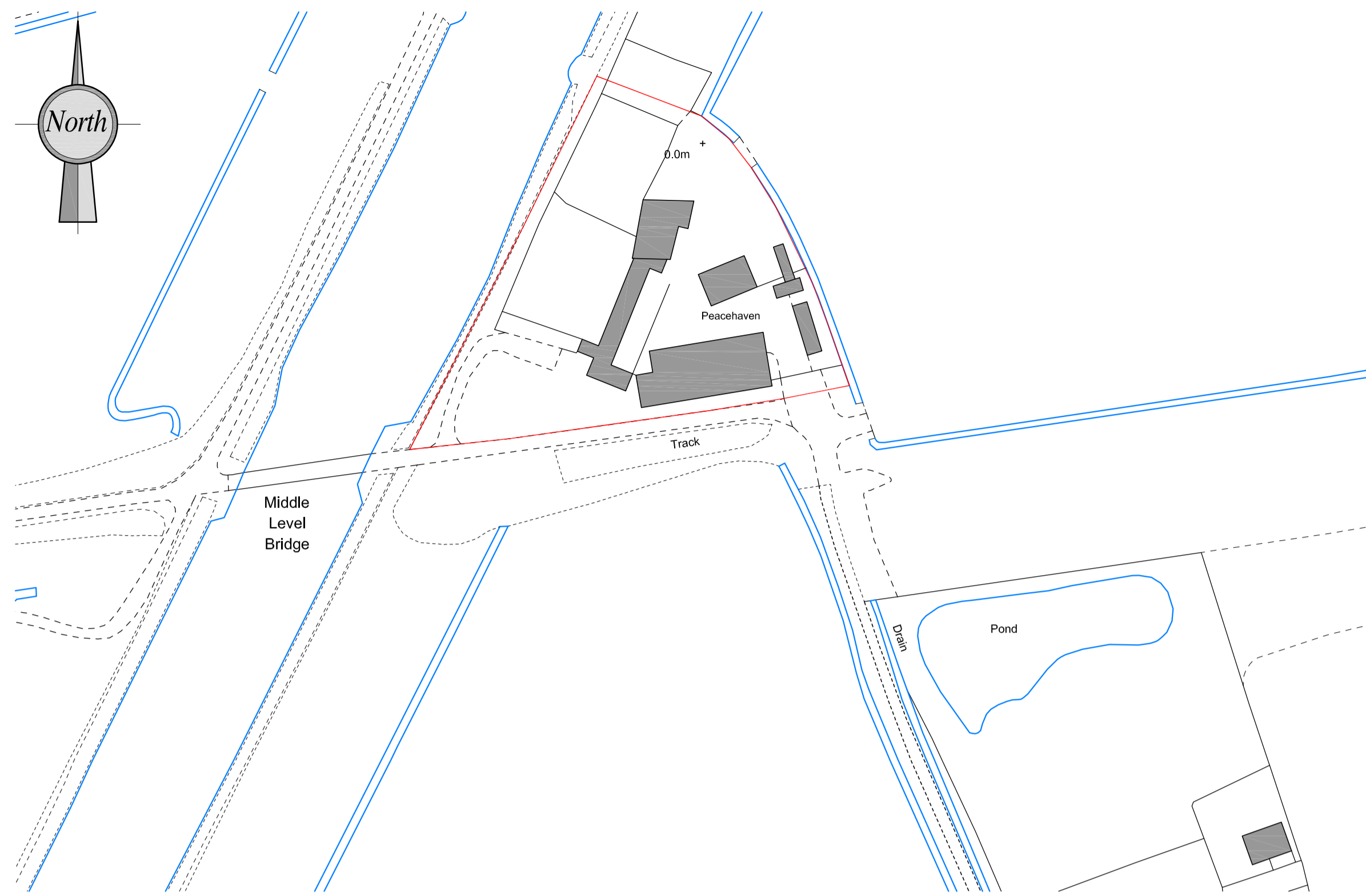

LOCATION PLAN
SCALE 1:1250

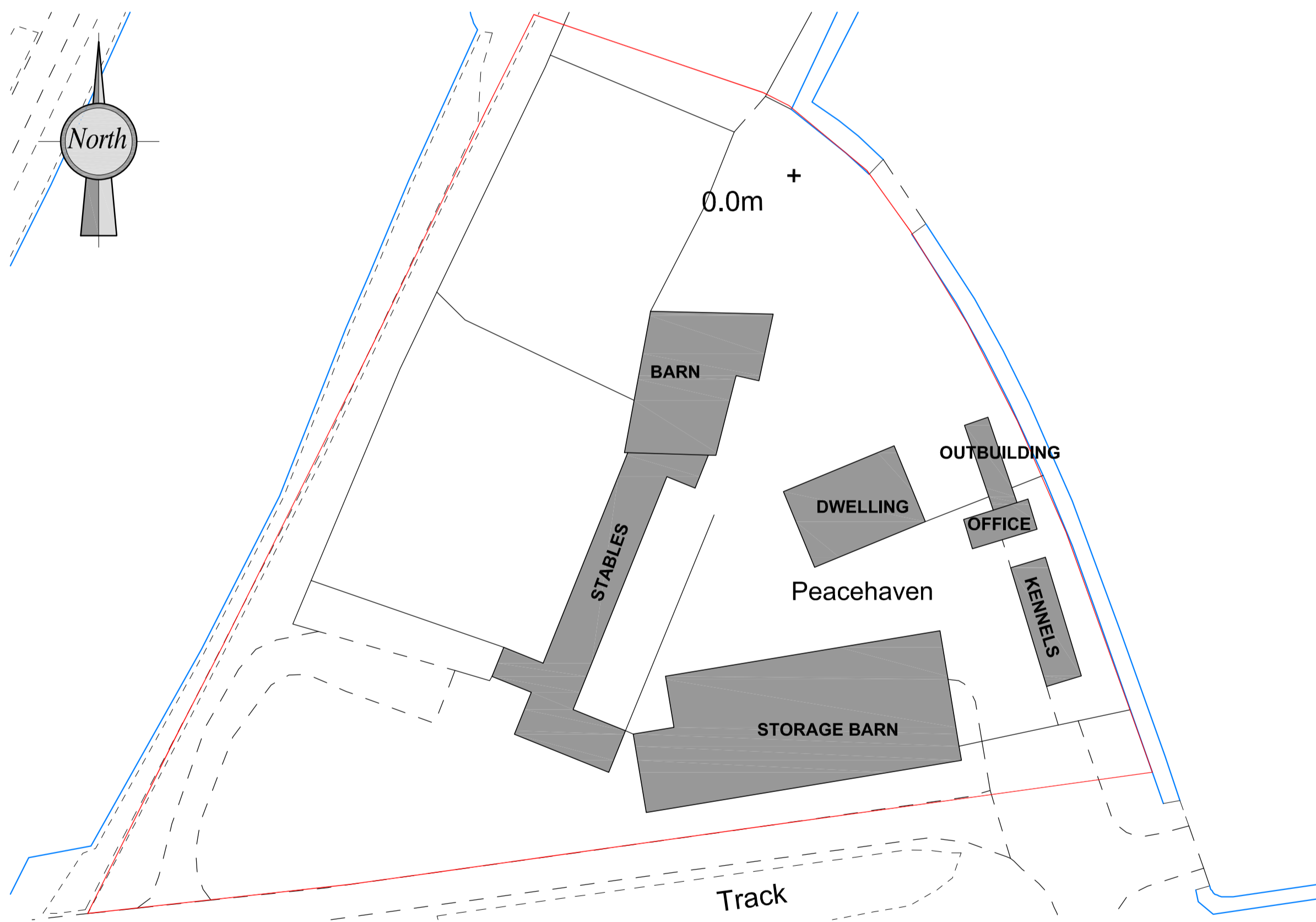

BLOCK PLAN
SCALE 1:500

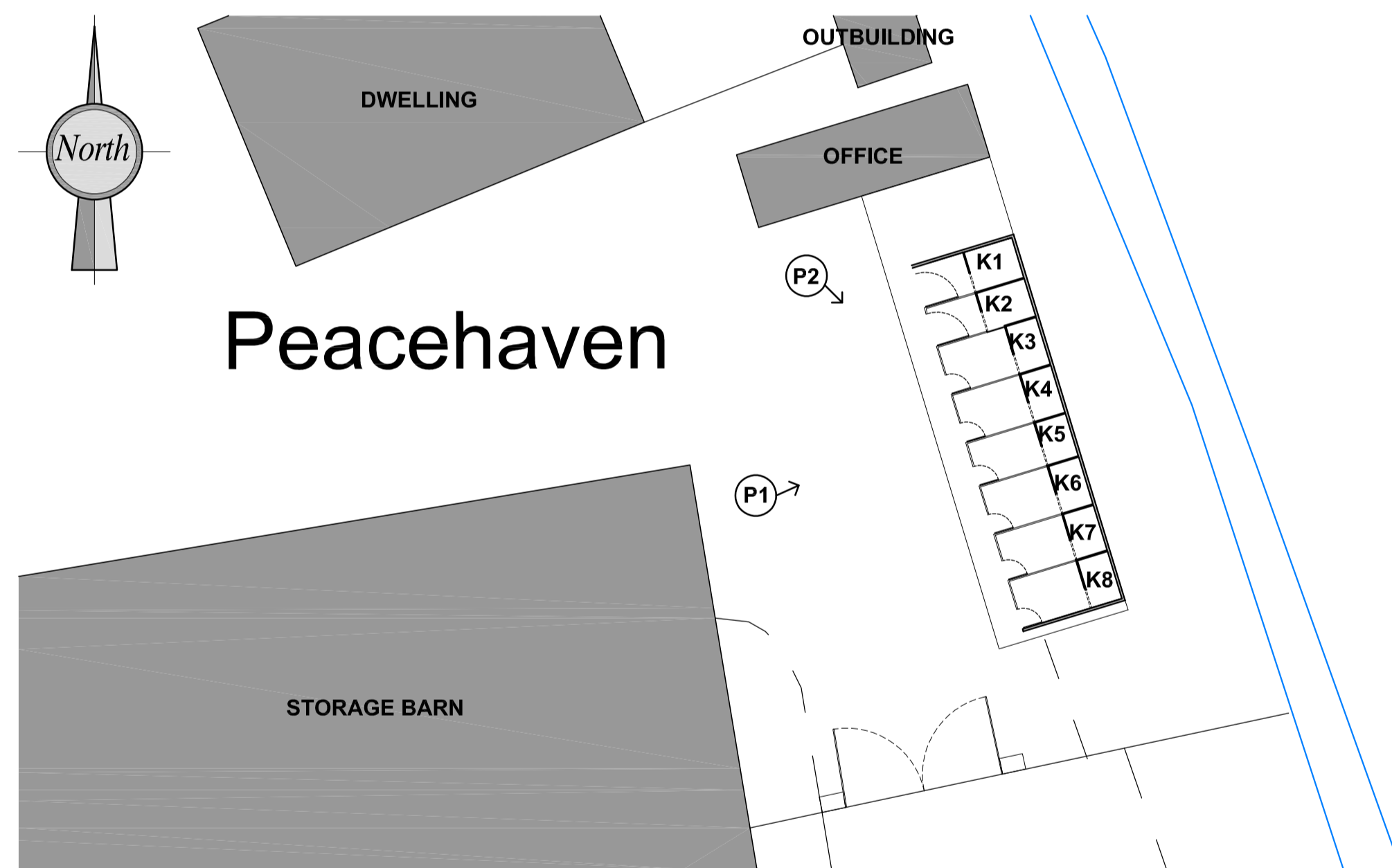

SITE PLAN (AS EXISTING & PROPOSED)
SCALE 1:200

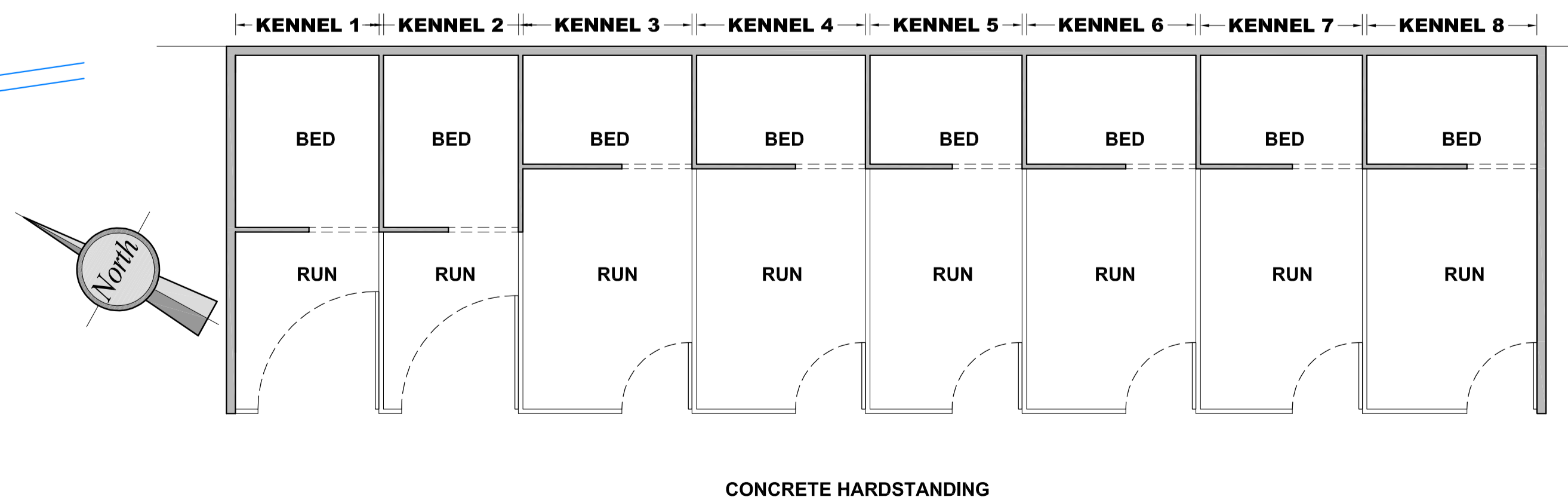

KENNEL PLANS (AS EXISTING & PROPOSED)
SCALE 1:50

NOTES:

The details depicted on this drawing are the copyright of 'REEVE Design Ltd' and may not be reproduced without permission. This drawing must not be re-issued, loaned or copied without the consent of the originator. Errors omissions and discrepancies should be reported to the originator immediately.

All dimensions to be checked before site or off-site fabrication by the Contractor, his Sub-contractor or Supplier.

Structure, structural members & geotechnical investigations are to be carried out & approved by the appointed Structural Engineer. Any deviations to these elements are to be reported to the appointed consultant immediately.

IF IN DOUBT ASK !



PICTURE 'P1'
(AS EXISTING & PROPOSED)



PICTURE 'P2'
(AS EXISTING & PROPOSED)



BUILDING DESIGN CONSULTANTS

Project :
Change of use for breeding of dogs at Peace Haven, Fen Road, Magdalen, Kings Lynn, Norfolk, PE34 3DD

Client : Mr Dean Taylor
Issue Date : 06/01/2022

Title :
SITE LOCATION, BLOCK AND SITE PLAN

Revision Details :
Viewport title amended to add 'as existing and proposed'.

Drawing number : **2118.01** rev : **A**

For and on behalf of 'REEVE Design Ltd'
The Nest, 32 Mill Road, Magdalen, King's Lynn, Norfolk, PE34 3BZ
T: 07464 945103 | W: www.reevedesign.co.uk
Registered in England No. 11744392 paper size: **A1**

This line measures 200mm in length when printed correctly