

**PLAN OF NEW WORKSHOP AS PROPOSED**

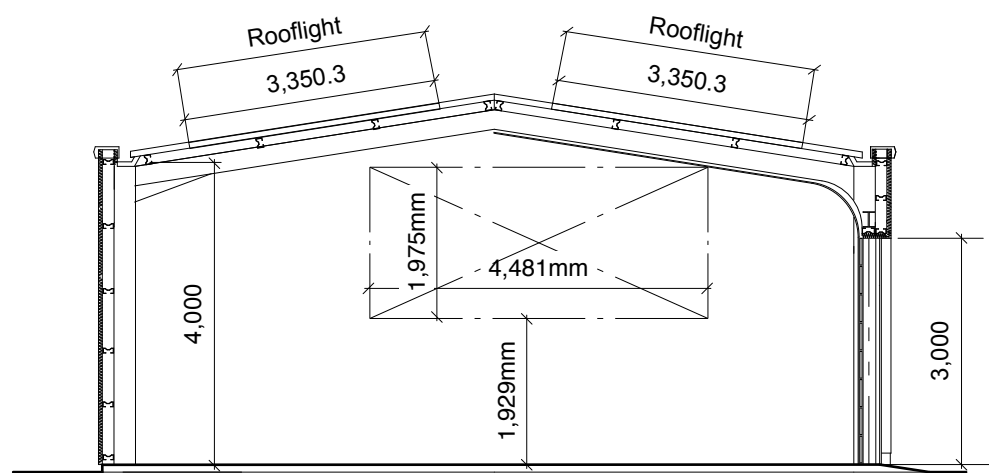

**CROSS SECTION NEW WORKSHOP AS PROPOSED**



THIS DRAWING AND THE ACCOMPANYING DRAWINGS ARE THE DRAWINGS/ TRUE COPY OF THE DRAWINGS REFERRED TO IN THE APPLICATION TO NORTH LANARKSHIRE COUNCIL FOR PLANNING PERMISSION / BUILDING WARRANT DATED .....

SIGNED ON BEHALF OF W LIVINGSTONE LTD .....

**OUTLINE SPECIFICATION**

**Kingspan or similar profile steel insulated sheeting panels** with translucent roof light panels, all on patent zed purlins at centres to suit sheeting on steel portal frame, complete with all necessary bracings  
 Design of primary & secondary steelwork will be by specialist contractor, substructure design by Structural Engineer

**OUTER WALLS**  
 Kingspan or similar profile steel insulated panels on zed purlins at centres to suit sheeting on steel portal frames at 5m centres (steelwork design to be checked by Structural Engineer)

**PARTITIONS**  
 Internal toilet partition will be loadbearing timber frame capable of supporting water storage tank over, capacity to be confirmed.

**CEILINGS**  
 Ceiling to toilet area will be of timber joists at 450mm centres (joist size to be confirmed) ; Internal lining of 12.5 mm screw-fixed plasterboard with taped & filled joints. 22mm T. & G. flooring to top of joists. 22mm timber fascia to finish.

**HEATING**  
 Heating TBC - electrically-powered warm air heating (Powmatic or similar)  
 Services to be provided will include

Cold water supply, hot water supply, single and three phase electricity supply, Soil, Waste Water & Surface water drainage, possible telephone & data connection points.

**FLOOR**  
 Floor construction will be 250mm concrete on Kingspan insulation on 'visqueen' heavy gauge D.P.M. on 150mm well consolidated type 1 hardcore, blinded with sand.

**FOUNDATIONS**  
 All concrete foundations will be to the design of The Structural Engineer

**DOORS**  
 4 No. at 3.0m wide X 3.5m high insulated industrial, electrically operated overhead doors no viewing panels required.

2 No. steel-faced personnel doors, approx 900mm wide X 2100mm high, internal panic bars to be fitted 1.5 pairs of hinges per door

rev.	amendment	by	date
B	Bay doors and structure amended to client requirements	AP	21.03.22
A	Layout amended to client requirements	AP	

**Parchitect Ltd**  
 a: 49 Main Street, Bothwell, Lanarkshire, G71 8ER  
 t: 01698 85 4740 m: 07549 164 171  
 e: alan@parchitect.co.uk

client  
**W. LIVINGSTONE LTD.**  
 client's ref  
 project  
**PROPOSED NEW WORKSHOP  
 34 NEW EDINBURGH ROAD,  
 UDDINGSTON, G71 6BS**  
 drawing

**General arrangement drawings  
 AS PROPOSED  
 Sheet 1 of 2**

scale: 1:100	drawn AP	checked AP
page size A3	Feb '22	Feb '22
job ref	drawing num	rev
177	AL(0)004	B

