

General Notes

Scale from this drawing for planning purposes only.

Contractors are to check all dimensions on site prior to any construction work beginning.

This drawing, and all others associated with it, remain the property of King Architecture & Design and are not to be reproduced or amended without the written consent of King Architecture & Design.

Unauthorised use for any purpose is prohibited.

All work undertaken in collaboration with this drawing is to be undertaken to conform to current building regulations and all current building legislation, if divergencies from statutory requirements are shown on the drawings then these should be reported to King Architecture & Design immediately.

39 Alresford Road
Winchester
SO23 0HG

W: www.kingarchitectureanddesign.co.uk
E: admin@kingarchitectureanddesign.co.uk
T: 079 5574 2966

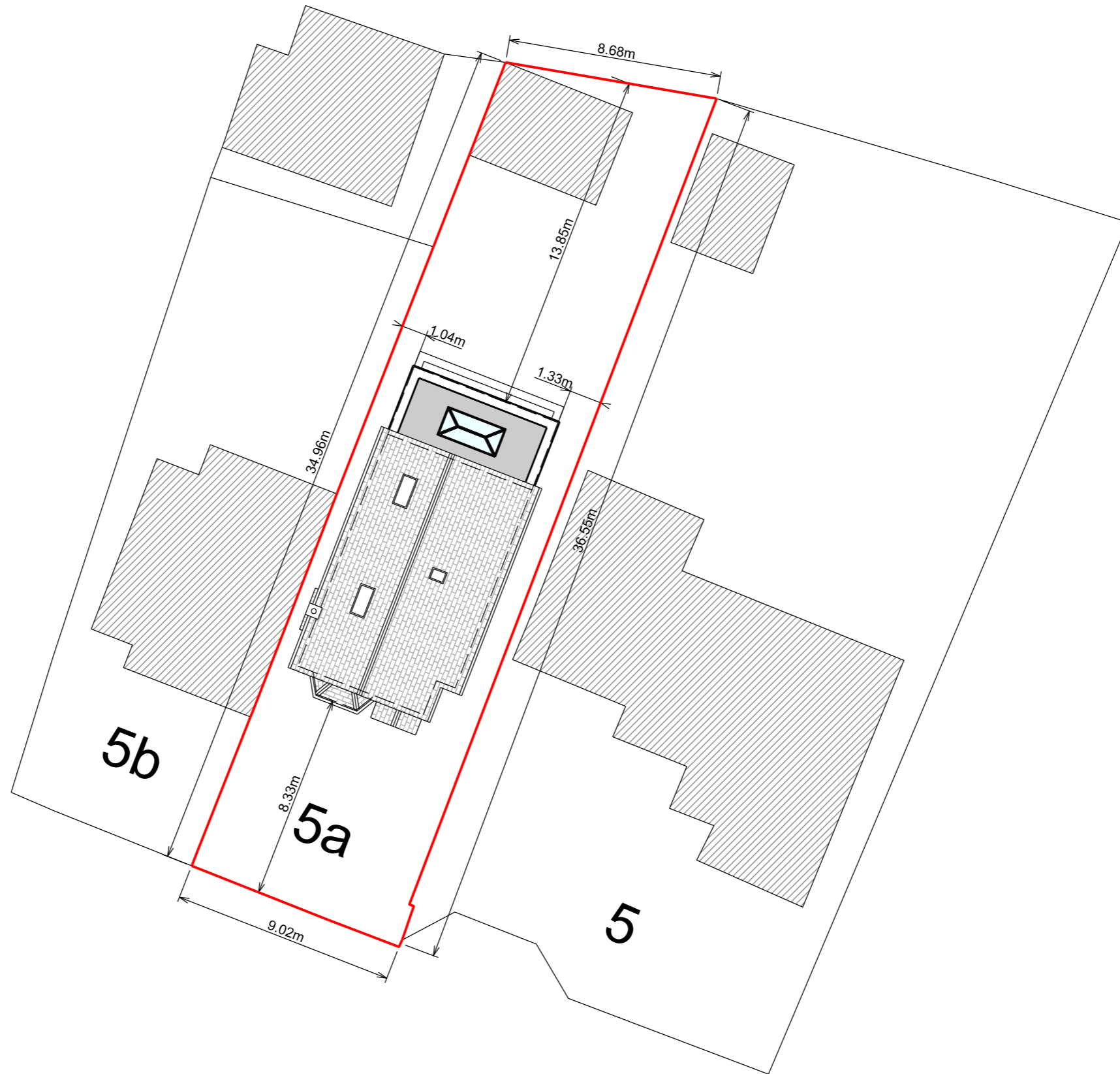

Page Size

A3

Scale

1:200

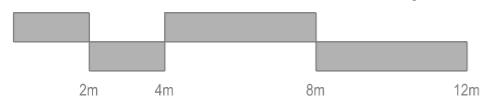

Orientation



B	20/04/2022	Loft floor plan added
A	19/04/2022	First floor plan and front elevation added

Rev Date Description

Project Address	Client
5A The Custards, Lyndhurst, SO43 7AP	Hannah & James Chalk
	Local Authority
	New Forest District Council

Project Status	Drawing Description
Planning	Proposed Site Plan

Project No.	Drawing No.
078	P - 100

Date	Revision
19/04/2022	B