

Existing Block Plan [1:500]

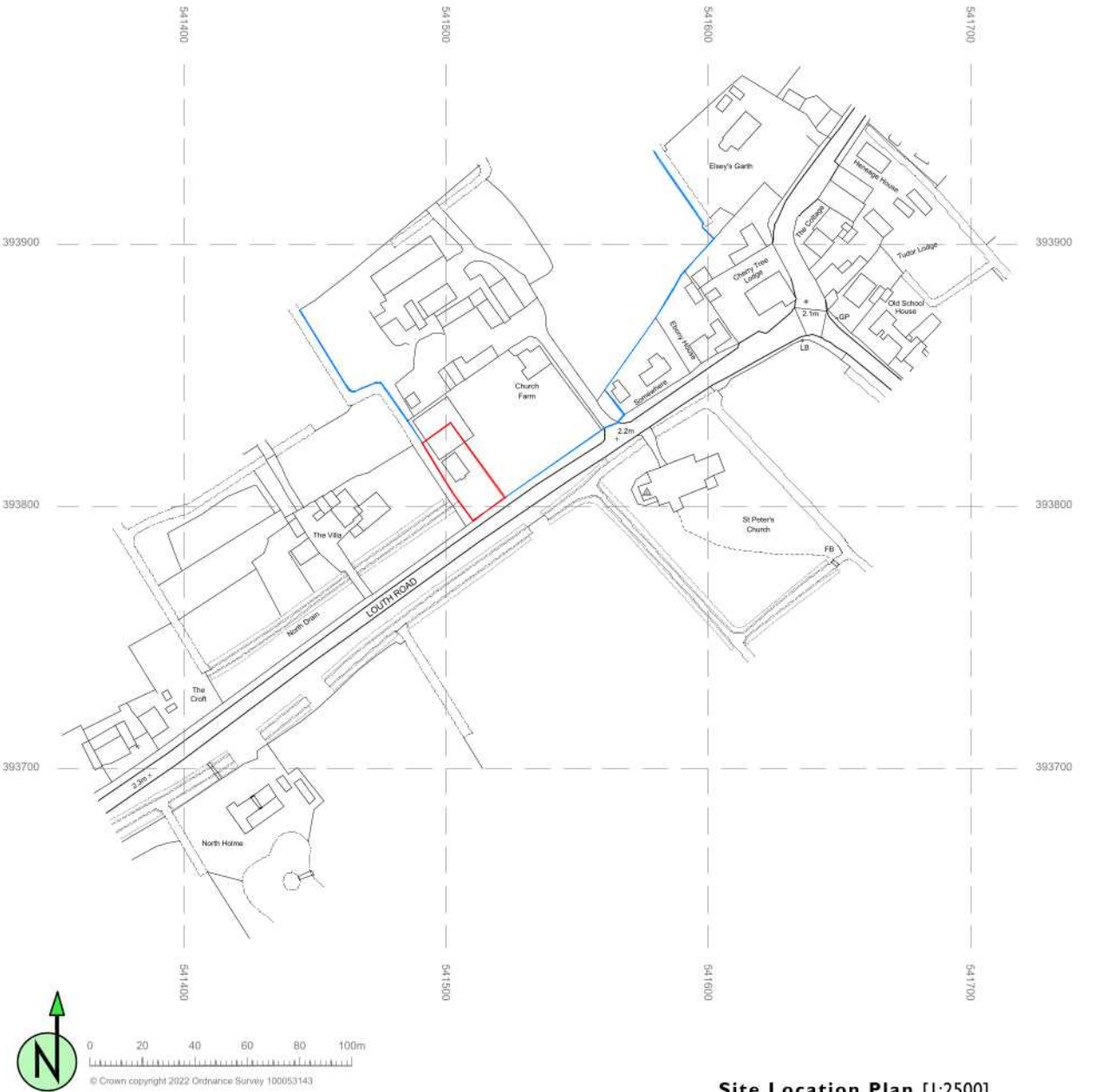

Site Location Plan [1:2500]



T: 07368 911052
 mc@andrewcloverplanninganddesign.co.uk
 www.andrewcloverplanninganddesign.co.uk

Project	Proposed Dwelling	
Location	Church Farm, Louth Road, South Somercotes	
Drawing Title	Existing Site Plans	
Status	Planning Application	
Date	23.04.2022	
Scale	1:2500 & 1:500 @ A3	
Drawing No.	14221-01	Rev

This drawing is for illustrative purposes and for planning approval only. It should not be used for construction and therefore risk identification under the Construction (Design & Management) Regulations has not been carried out.
 This drawing is the property of Andrew Clover Planning and Design Ltd and must not be reproduced without prior written consent.
 Do not scale from this drawing, use printed dimensions only.