



This drawing is to be read in conjunction with the schedule of works and is to remain the sole property of Westwood Energy Ltd.

This scheme includes both AC and DC supplies, as such it should only be worked upon by qualified and knowledgeable contractors.

info@thewestwoodgroup.co.uk
01904 439192

Westwood Energy
High Warrendale Farm
Wester
York
YO42 1XG

Key

- Access / Protection
- Modules
- Inverters
- Optimisers / DC
- AC
- Mounting
- Building / Structure
- Ducting
- Containment

- Centreline
- Data
- LVAC
- LVDC
- HVAC

Module

Trina Vertex S 400W Blk
Height: 1754mm
Width: 1096mm
Depth: 30mm
N°: 532

Mounting

Van Der Valk Trap
Rail height: 50mm
Rail length: 320mm
Mid clamp: 10mm
Orientation: Portrait
Service gap: 400mm

Building

Morspan
Length: -
Width: -
Rafter: -
Rafter to vent: -
Eaves: -
Pitch: -
Trap c.t.c: -
Trap crown: -
Trap trough: -
Trap depth: -

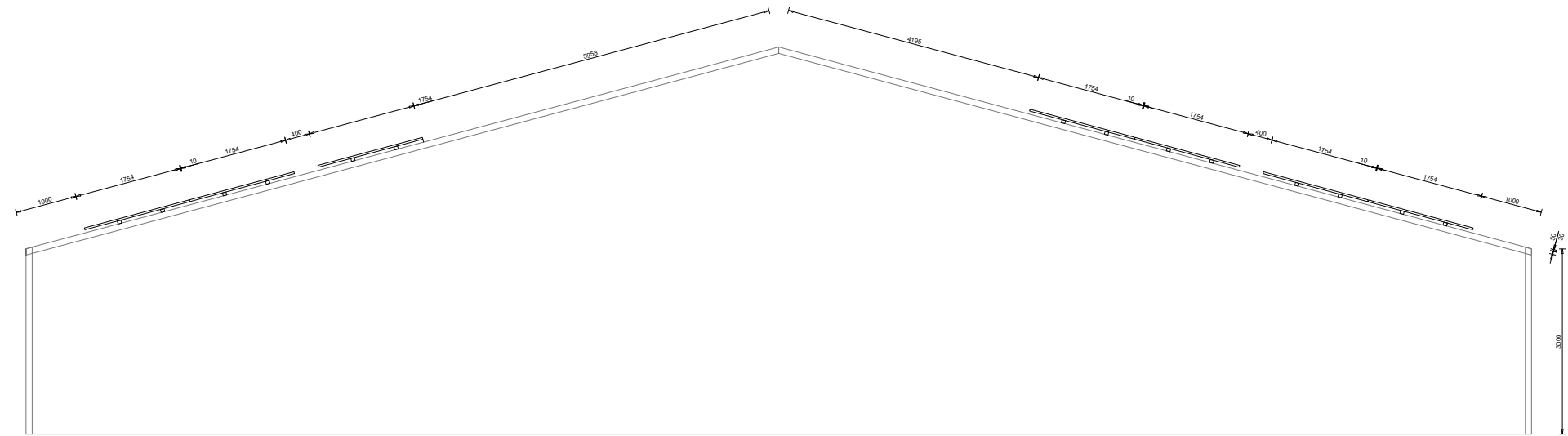

all dimensions shown are in mm

plan views of roof mounted installations show
rafter lengths not building widths

pending approval

scale	1:100	date	18/02/22
drawn	OW	checked	JO
project	405	reference	Layout
revision	1.0	number	212.80

site address
Lowfields Farm
Castle Lane
Boothby Graffoe
Lincoln
LN5 0LL

company address
Barn Farm
Lowfields
Navenby
Lincoln
LN5 0LN

drawing
we405-212.80-Cross_Section-1.0