



arbor **Clad**

21ST CENTURY CLADDING SOLUTIONS

A specialist range comprising the highest quality, sustainable cladding products. Perfect for any application, from domestic and commercial to refurbishment.

arborClad

THE 21ST CENTURY CLADDING SOLUTION

ArborClad is wholly committed to supplying the highest quality, sustainable cladding products. Working with industry leading manufacturers alongside their own specialist manufacturing facilities, ArborClad external cladding range is perfect for any application, from domestic and commercial to refurbishment.

At the heart of the ArborClad external cladding range is the environment. Chosen specifically for their environmental qualities, Chain of Custody is commonplace across the entire range.

Image shown is ArborClad Thermo-D Platowood Hardwood after natural weathering has taken place achieving a uniform colour and appearance.

THE TOTAL CLADDING SOLUTION

A quick overview of the ArborClad cladding range.

06 TRADITIONAL CLADDING

arborClad
TRADITIONAL

- Cost-effective range of durable, resilient traditional claddings
- Environmentally focused
- Suitable for a range of applications
- Treated Redwood, Larch & Western Red Cedar species
- Bespoke profiles and other species also available
- Can be fire treated and/or finished with a stain or paint if required.

08 THERMALLY TREATED CLADDING

arborClad
THERMO-D

- Softwood & hardwood options
- Improved stability, durability & performance
- Increased weather & rot resistance
- Environmentally focused
- Uniformity of product colour in its natural state
- More even weathering over time than traditional timber claddings
- Can be fire treated and/or finished with a stain or paint if required.

12 FULLY FINISHED CLADDING

arborClad
PRE-FINISHED

- Available in rustic, traditional and metal effect finishes
- No on-site finishing required
- Range of paint finishes available
- Can save time & money
- Environmentally focused
- End matched profiles
- Suitable for a range of applications
- Increased speed of installation
- Manufacturers paint warranty

Committed to the environment

ArborClad has achieved Chain of Custody* certification covering all of the Company's divisions, providing compliance with government specifications for timber from legal and well-managed sources as well as meeting the requirements of the construction industry's independent third party audit organisations.



*Should achieving Chain of Custody certification be a condition of supply of product please contact ArborClad to confirm prior to purchase.
Note. All information is accurate at time of going to press. Photography and colours are reproduced as accurately as the print process will allow.

arborClad

WHAT MAKES ARBORCLAD DIFFERENT?

The total cladding solution

Timber cladding is being specified today more and more by local authorities, architects and developers for its environmental credentials and for its ease of working, natural beauty, performance and competitive price.

Timber is one building material that has an unrivalled pedigree for use in construction, which is why timber is an ideal choice for use as an external cladding.

Working with some of Europe's leading manufacturers ArborClad has selected a range of products at the forefront of design and technology to meet today's challenging cladding requirements.

Standard profiles

Traditional cladding styles and patterns are always going to be in Vogue. For this reason our standard stock range is based on the popular shiplap and offset cladding profiles. It is also why the more traditional Redwood, Larch and Western Red Cedar species are included.

These are timber species with a proven performance and appearance and, alongside the other products in the range, ensure the perfect solution for any installation is available.

Domestic, commercial and refurbishment projects

Ideal for commercial, domestic and refurbishment projects, ArborClad cladding range offers a perfect starting point from where you can select the materials most suited to each individual project. The longer a building product lasts the better it is for the environment, especially a critical external envelope component such as cladding.

Bespoke profiles*

We deal with timber on a daily basis, so we know its limitations. We also know that you occasionally want to be different and stand out from the crowd!

At ArborClad we employ skilled woodworking machinists who are able to produce a full range of bespoke profiles to suit even the most demanding of specifications. These bespoke items can be produced, in addition to the timbers featured in the standard cladding range, from a wide variety of other timber species - Green Oak, Sweet Chestnut, Douglas Fir, Cumaru to name a few.

For further details, or to discuss your exact requirements please get in touch and our dedicated team will do their utmost to assist.

*Please note that minimum order quantities may apply.

Choosing external cladding

When choosing any form of board cladding, consider:

- Choice of species
- Size & length of boards available
- The degree of weatherprotection
- Ease of installation & fixing
- Finish required
- Robustness



MAKING THE CORRECT CLADDING CHOICE

Wood cladding is becoming increasingly popular once more as a facing material, replacing brick or rendered finishes with warm and practical facades that are seen as a more sustainable option. It is used for internal or external applications, although you must consider the durability of the timber when selecting material for external use. Wood cladding is generally easy to fix, but do consider final detailing, especially on corner joints and at ground level on external applications.

Sustainable timber

Timber is the most sustainable building product available. It is naturally renewable - over 97% of softwood timber used in the UK comes from Europe, where the forest area is increasing by the equivalent of 100 football pitches an hour.

For reassurance for softwoods and hardwoods look for certification labels like FSC® (Forest Stewardship Council) or PEFC (Programme for the Endorsement of Forest Certification). All the suppliers and materials chosen for inclusion in this range have been selected because they can provide full chain of custody certification.

Softwood continues to be the most popular external cladding for most buildings. Western Red Cedar and European Larch are naturally durable, but thanks to modern preservative methods, less durable species are also widely used. Heat treatment of wood has led to the introduction of a new range of softwood and hardwood products that achieve greater durability without the use of chemicals.

Durable temperate hardwoods, such as European Oak and Sweet Chestnut are increasingly used. With the exception of their sapwood, they can be used without treatment. They can be installed kiln dried or 'green', but 'green' timber requires special detailing to allow for shrinkage and movement. Tropical hardwoods are generally stronger, more robust and durable than softwoods for cladding.

Choosing materials for the right finish

The species, grade, and quality of materials you choose have an important bearing on the service life, appearance and maintenance of the cladding.

Take into account the number and size of knots (ensuring there are no dead knots) and other defects, such as splits and shakes, when deciding on the final visual appearance of the cladding.

Think about the final surface finish you want to achieve when choosing a preservative treatment. For example, using a pressurised treatment process may give the timber a green appearance. Some species can be left unfinished and will turn silvery-grey as sunlight bleaches the surface. For a decorated surface, use good quality microporous paint systems, or consider using pre-finished timber cladding.

Always follow the manufacturer's instructions to ensure good coverage and service life.

Direction of boarding

Timber cladding can be applied in any one of three directions. Take this into consideration at the time of selection. Your decision will have an impact on the methods of fixing as well as on the overall look of the facade.

Horizontal boarding

Available with overlapped or profiled sections. The board profile and spacing can provide a variety of design effects, as well as protection for the building. If using horizontal boarding, consider how the boards will be fixed and jointed to provide good detailing for the building.

Vertical boarding

Board on board is a popular and versatile arrangement, although shiplap and tongued and grooved profiles are also used. The tongues need to be long enough to allow for slight movement of the timber so that open gaps do not develop with natural shrinkage and expansion.

Other methods of vertical cladding can also be employed by staggering overlaps with boards on top of boards.

Diagonal boarding

Provides an alternative appearance. Overlapping boards are not suitable.

Tongued and grooved boards should be installed tongue upwards. Ensure counterbattening is done to provide ventilation.



ArborClad wish to thank **wood for good** and **TRADA** for their invaluable assistance in compiling this brochure.

arborClad

TRADITIONAL

A RANGE OF TRADITIONAL CLADDING PRODUCTS SUITABLE FOR VARIOUS APPLICATIONS.

The traditional cladding range is a selection of the most popular timber species currently used today in the UK market for exterior cladding. Selected to meet a wide range of budgets the timbers are machined by experts into a wide selection of standard sizes and profiles.

We are also able to provide a fully comprehensive selection of timber species in profiles specific to your exact requirements.

Whatever your project requirements, you can be sure of ArborClad's renowned reliability and customer service.

arborClad

TRADITIONAL
REDWOOD



European Redwood shiplap and offset cladding with square end detail. For use where economy is the priority.

CONTACT US FOR FURTHER SPECIFICATION DETAILS

Profiles available:

Shiplap / Offset / Tongue & Groove

Sizes available (finished sizes shown):

- 15mm x 119mm in random lengths
- 19mm x 117mm in random lengths
- 19mm x 140mm in random lengths

Areas of use:

Refurbishment / Domestic / Commercial

Use class:

Class 3

Finish options available:

To prevent the natural weathering of materials a paint, stain or oil finish featuring UV filter is recommended

Bespoke options:

The range can be machined to any required profile, including splayed and TG&V. A wide range of additional sections are also available at competitive rates and short lead times

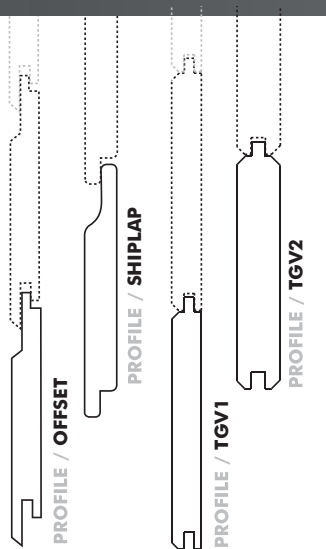

Can be protected by Protim Clearchoice Preservative technology. Price on application



**NEED A SAMPLE?
CONTACT US FOR DETAILS**



TIMBER CLADDING, WHEN LEFT IN ITS NATURAL STATE, WILL OXIDISE AND TURN A SILVER GREY COLOUR OVER TIME, DUE TO THE EFFECTS OF EXPOSURE TO SUNLIGHT. THERMALLY TREATED TIMBER (PAGE 08) TENDS TO DO THIS IN A MORE UNIFORM AND EVEN MANNER DUE TO THE REDUCED LEVELS OF MOISTURE IN THE TIMBER.

arborClad

TRADITIONAL
LARCH



Larch shiplap and offset cladding with square end detail. A highly durable and resilient solution.

CONTACT US FOR FURTHER SPECIFICATION DETAILS

Profiles available:
Shiplap / Offset

Sizes available (finished sizes shown):
19mm x 140mm in random lengths

Areas of use:
Refurbishment / Domestic / Commercial

Use class:
Class 3

Finish options available:
To prevent the natural weathering of materials a paint, stain or oil finish featuring UV filter is recommended

Bespoke options:
The range can be machined to any required profile, including splayed and TG&V. A wide range of additional sections are also available at competitive rates and short lead times

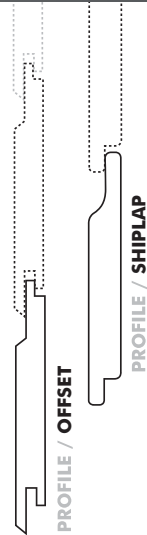

Sizes are nominal. Subject to stock availability at the time of order.

arborClad

TRADITIONAL
CEDAR



Supplied under the PEFC recognised CSA standard

Western Red Cedar shiplap and offset cladding with square end detail. A highly durable and resilient solution.

CONTACT US FOR FURTHER SPECIFICATION DETAILS

Profiles available:
Shiplap / Offset

Sizes available (finished sizes shown):
19mm x 140mm in random lengths

Areas of use:
Refurbishment / Domestic / Commercial

Use class:
Class 3

Finish options available:
To prevent the natural weathering of materials a paint, stain or oil finish featuring UV filter is recommended

Bespoke options:
The range can be machined to any required profile, including splayed and TG&V. A wide range of additional sections are also available at competitive rates and short lead times

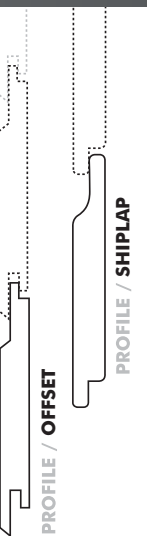

ADDITIONAL SPECIES AVAILABLE CONTACT US FOR DETAILS



FIRE RESISTANCE TREATMENT? DETAILS ON REQUEST

WITH IMPROVED STABILITY AND DURABILITY QUALITIES, THERMALLY TREATED CLADDING PROVIDES ADDED LONG TERM BENEFITS AND FLEXIBILITY.

Heat treatment (within a range of 160°C to 215°C) has the effect of modifying the properties of wood. The thermal treatment process consists of heating wood to temperatures exceeding its spontaneous combustion temperature with the water vapour present having a protective function. A natural process, the varying temperatures, varying treatment duration and varying drying techniques require no chemical additives and impart new properties to the treated wood.

Through the treatment applied, the timber is less prone to absorb or lose moisture, helping to restrict the potential for swelling, shrinkage or distortion.

During the thermal treatment process, the wood also acquires a beautiful brown colour and its velvet-like surface is pleasant to the touch. At its best, the wood possesses nuances of antique and fine wood shades that bring warmth to any project, be this for an internal or external application.

ArborClad has chosen to work with the world's leading suppliers of thermally treated timbers. ArborClad Thermo-D Redwood undergoes the traditional heat treatment cycle which the Finnish Thermowood Association has developed, approved and promoted since their formation in 1985.

A Thermo-S cycle of heat treatment is available, but this is only for products which are to be used in internal applications and it looks as though this process will gradually be phased out over the coming years.

Additionally, we are happy to offer to our customers ArborClad Thermo-D Platowood Spruce and Hardwood. Platowood, of Holland, are one of the world's innovators in heat treatment of wood and have a unique pedigree of supply into today's cladding market. The Platowood heat treatment process is a longer treatment which, in the case of the spruce, actually enhances the timber durability.

The ArborClad cladding range has been selected using timbers sourced only from well managed and sustainable forests to ensure that a full Chain of Custody certification can be achieved. As one of the founder members of the Forests Forever initiative and supporters of wood for good, we feel it is our responsibility to provide environmental solutions for the timber cladding market today.

FLEXIBLE PERFORMANCE

With high performance qualities, thermally treated wood can be used for a wide variety of applications and even the most demanding of situations

- **Cost effective alternative to traditional materials**
- **Treatment applied through the full section**
- **Service life of up to 30 years**
- **No additional treatment or finishing required**
- **Moisture content reduced**
- **Improved rot resistance**
- **Weather resistance increased**
- **Removal of resin**
- **Deformation reduced**
- **Increased stability & durability**
- **Resistant to beetle and insect attack**

TIMBER CLADDING, WHEN LEFT IN ITS NATURAL STATE, WILL OXIDISE AND TURN A SILVER GREY COLOUR OVER TIME, DUE TO THE EFFECTS OF EXPOSURE TO SUNLIGHT. THERMALLY TREATED TIMBER TENDS TO DO THIS IN A MORE UNIFORM AND EVEN MANNER DUE TO THE REDUCED LEVELS OF MOISTURE IN THE TIMBER.



arborClad

THERMO-D

REDWOOD

ArborClad Thermo-D Redwood is supplied by some of the world's leading and largest producers of thermally modified timber. By working with members of Finland's Thermo-wood Association (FTWA), a leading world authority on the thermal treatment of wood, you can feel confident that all products supplied undergo a rigorous quality assurance process.

ArborClad Thermo-D Redwood's quality and stability lies in the first rate management of the thermo-processing, which the members of the FTWA provide. Having this quality assurance allows us to provide to you a unique top quality product with one of the widest selection of ethically sourced products on the market today.

In taking care of the environment, as well as achieving a Durability Class 2 without the need for chemical treatment, ArborClad Thermo-D Redwood is fully PEFC certified with full Chain of Custody certification, as a result all timber is sourced from well managed and re-planted forests.

ArborClad Thermo-D Redwood is suitable for a wide range of applications including:
Terraces • balconies • patios • pergolas
docks • outdoor cladding • cladding shingles
interior walls • ceilings • beam encasings
saunas • structures

- **Maintains size & shape**
- **Wide range of applications, including water contact***
- **External & internal use**
- **Increased stability & durability**
- **Improved thermal & hygiene qualities**
- **Improved wood preservation & weather resistance**
- **Colour darkens throughout**
- **Wood is lighter**
- **Possesses the desired strength**
- **Decreased risk of mould**
- **Pitch dries & disappears**



REDWOOD CLADDING

Thermally treated European Redwood cladding for long term internal and external use.



CONTACT US FOR FURTHER SPECIFICATION DETAILS

Profiles available:
Shiplap / Offset

Sizes available (finished sizes shown):
19mm x 117mm in random lengths
19mm x 140mm in random lengths

Areas of use:
Refurbishment / Domestic / Commercial

Use class:
Class 3

Finish options available:
Can be painted, stained and fire treated to class 0

Bespoke options:
Supplied as Class D treatment cycle for external use. Also available as Class S suitable for internal use only

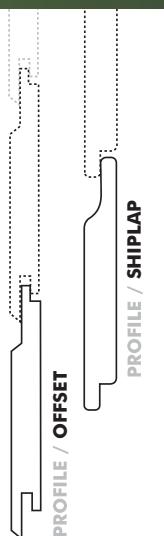

**NEED A SAMPLE?
CONTACT US FOR DETAILS**



**PRE-FINISHED & BESPOKE
PROFILES AVAILABLE**



**FIRE RESISTANCE TREATMENT?
DETAILS ON REQUEST**

**QUALITY SPRUCE CLADDING,
ALSO SUITABLE FOR GROUND
AND FRESH WATER
APPLICATIONS.**



ArborClad Thermo-D Platowood Spruce is produced using an advanced thermo treatment process. The Platowood Process is a slower longer cycle of heat treatment than that used in conventional thermally modified timber processing, such as that used by the FTWA. As a result the process dramatically improves the stability and durability of the timber. The process is completely natural and does not involve the use of any chemicals.

forests, enjoys a rustic knotty appearance and is suitable for a broad range of applications such as cladding, decking, fencing and even civil construction with direct ground and water contact.

An ever increasing number of developers, specifiers and contractors are being inspired by the unique properties and wide variety of available species of Platowood. With many beautiful and sustainable projects being developed around Europe and the UK.

ArborClad Thermo-D Platowood Spruce is sustainably sourced from well-managed Norway

- Superior durability and stability
- Meets both Class S & Class D
- No chemicals used
- Woods sourced from certified sustainable forests
- Reduced need for maintenance or surface treatment
- Fixed long lengths for quick delivery
- Improved thermal & hygienic qualities
- Sections up to 100mm x 190mm
- Suitable for a wide range of applications including cladding, decking, fencing and even civil construction

THERMALLY TREATED CLADDING RANGE

**SPRUCE
CLADDING**

European Spruce selected grade for claddings.
Suitable for direct ground and fresh water contact.



The mark of responsible forest management

CONTACT US FOR FURTHER SPECIFICATION DETAILS

Profiles available:
Shiplap / Offset

Sizes available (finished sizes shown):
19mm x 117mm in random lengths
19mm x 140mm in random lengths

Areas of use:
Refurbishment / Domestic / Commercial

Use class:
Class 3 (Class 4 for ground contact)

Finish options available:
Can be painted, stained and fire treated to class 0

Bespoke options:
Available in any required profile

Additional features:
Suitable for direct ground and fresh water contact. Suitable for structural applications

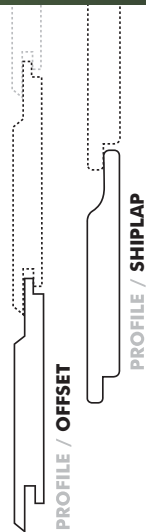

**NEED A SAMPLE?
CONTACT US FOR DETAILS**



**BESPOKE PROFILES AVAILABLE
SEE PAGE 24**



**FIRE RESISTANCE TREATMENT?
DETAILS ON REQUEST**

PREMIUM HEAT MODIFIED EXOTIC AFRICAN HARDWOOD TIMBER FOR EXTERIOR AND INTERIOR CLADDING APPLICATIONS.

ArborClad Platowood Hardwood comes from the Idigbo family and is more commonly known in the UK and Europe as Fraké. In its natural state it has little or no commercial value. It is after the Platowood process that the Fraké's durability and performance increases making the timber ideal for use as claddings and other decorative uses, whilst also a fantastic environmental success story.

By choosing the ArborClad product the full appeal of Fraké's striking natural finish and unmatched exterior performance can be utilised.

With all of the benefits of the Platowood thermal treatment process, ArborClad Platowood Hardwood is ideal for cladding projects where a highly attractive clean finish appearance is required.

- Perfect for cladding projects
- Hardwood durability & stability
- 200mm wide boards achievable
- FSC® certified
- Free of chemicals
- Reduced need for maintenance or surface treatment
- Can be painted, stained & fire treated
- Long lengths readily available



THERMALLY TREATED CLADDING RANGE

HARDWOOD CLADDING

Perfect for exterior and interior cladding, Fraké is a premium heat modified timber species



CONTACT US FOR FURTHER SPECIFICATION DETAILS

Profiles available:
Shiplap / Offset

Sizes available (finished sizes shown):
19mm x 140mm in random lengths
19mm x 190mm in random lengths
100/125mm nominal widths also available, ask for details

Areas of use:
Refurbishment / Domestic / Commercial

Use class:
Class 3

Finish options available:
Can be painted, stained and fire treated to class 0

Bespoke options:
Available in any required profile

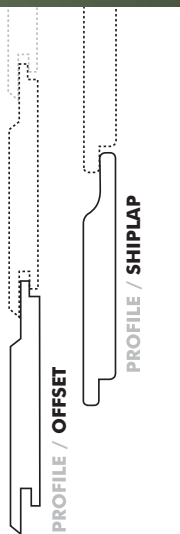

NEED A SAMPLE? CONTACT US FOR DETAILS



PRE-FINISHED & BESPOKE PROFILES AVAILABLE



FIRE RESISTANCE TREATMENT? DETAILS ON REQUEST

arborClad

PRE-FINISHED

FULLY FINISHED CLADDING OFFERS A QUICK AND STRAIGHTFORWARD SOLUTION.

With a generous range of standard* and to order colours and finishes available, it's simple to specify the exact cladding solution for your needs.

The benefits of a ready to install product, protected against stain and mould formation and the harmful effects of UV radiation are clear to see.

The quality controlled factory environment for painting and drying ensures a high quality finish, that would be near impossible to replicate with a traditional 'on-site' application.

The products selected for the range are provided by manufacturers who have built a reputation on innovation, flexibility and a customer friendly approach to their business partnerships.

At ArborClad we realise that it is not only quality and value that are important, but product performance and availability are also major factors in customer service and satisfaction. For this reason all the selected product ranges are only provided by well established European companies who have vast stocks readily available to meet demand and requirements.

All of the ArborClad pre-finished range comes complete with manufacturers paint/stain warranties. These warranties are given on the understanding that installations have an agreed cleaning and maintenance program cycle in place. This is done to ensure your timber cladding looks and performs to your expectations and, to maintain your warranty cover, need to be in accordance with the manufacturers recommendations.

Further details regarding warranties are available from your local ArborClad stockist.



*Standard colours may vary; please confirm prior to ordering.

arborClad

PRE-FINISHED
RUSTIC

TOP COATED CLADDING, PERFECT FOR DEMANDING USE.

ArborClad Pre-finished Rustic is produced in central Finland by one of the largest manufacturers of specialist painted timber products in Scandinavia, producing annually in excess of 40,000 cubic metres of high quality painted claddings and mouldings in a wide variety of colours and finishes.

This revolutionary cladding product enables you to have a beautiful wooden surface without any visible sign of nails. ArborClad Rustic is carefully primed on all four sides to achieve a seamless join. Quality and durability of cladding is ensured through the application of two coats of top quality finish.

The range consists of exterior cladding, fascias, starter, weather drip and corner pieces. Low-maintenance, ArborClad Rustic cladding carries a manufacturers 10 year warranty against flaking, blistering and peeling and requires no on-site finishing, helping you save time and money.

As you'd expect, the care of the environment is all important and all products have full PEFC Chain of Custody certification ensuring their wood is sourced from well managed and re-planted forest.

- **Low-maintenance wood cladding with a 10 year warranty**
- **100% recyclable**
- **No on-site finishing required**
- **ArborClad Rustic cladding is 4-sides grooved and tongued, enabling invisible joints**

- **Saves time and money**
- **Hides the signs of nails and improves resistance to weathering**
- **Two coats of UV water-based acrylic paint plus preservative base primer**



TOP COATED SPRUCE CLADDING

Fully finished, low maintenance cladding in 8 standard colours with fine sawn surface



CONTACT US FOR FURTHER
SPECIFICATION DETAILS

Profiles available:
Offset

Sizes available (finished sizes shown):
23mm x 145mm in various lengths

Areas of use:
Refurbishment / Domestic / Commercial

Use class:
Class 3

Finish options available:
8 standard paint finishes†

Bespoke options:
Complete range of RAL/B.S. colours available, details on application

Additional features:
Comprehensive range of matching accessories available

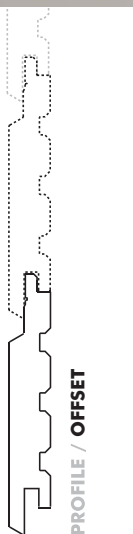

White

Cream

Light Grey

Black

Brown Red

Light Ivory

Pastel Blue

Beige

Black shown.



NEED A SAMPLE?
CONTACT US FOR DETAILS



PRE-FINISHED & BESPOKE
PROFILES AVAILABLE

SIX EXCLUSIVE STAINED MATT FINISH TIMBER TONES, FOR A NATURAL PRODUCT EFFECT



The ArborClad Pre-finished Traditional range includes stunning matt stained and eye-catching painted options, and is produced by one of Europe's leading manufacturers of stained and painted timber cladding. Highly specified by architects and contractors, the range is ideal for a wide spectrum of projects.

By selecting an ArborClad Pre-Finished product, employing a factory applied high quality surface finish, you are eliminating the inherent problems normally associated with on-site finishing. The paint or stain is applied to timber at a pre-determined moisture content, in a clean dirt/dust free environment, thereby ensuring consistency and quality of appearance and performance.

- **6 exclusive stained matt finish timber tones, for a natural effect**
- **New ArborClad 2 secret fix profile for an updated modern look and an easier more cost-effective installation**
- **10 year maintenance free guarantee against timber decay**
- **Up to 10 year comprehensive maintenance free guarantee of the factory applied finish (cracking, peeling, blistering and colour)**
- **Norway Spruce treated to Use Class 3, durable up to 50 years as a result of the combined timber treatment and the factory applied paint finish**
- **Cladding certified CTB B+ (guarantees the compliance to EU and French standards) and CE marked**
- **FSC® certified stocks upon request, subject to availability**

FULLY FINISHED CLADDING RANGE

MATT STAINED CLADDING

A wide selection of attractive, coloured exterior cladding panels suitable for exterior use



CONTACT US FOR FURTHER SPECIFICATION DETAILS

Profiles available:
Offset

Sizes available (finished sizes shown):
19mm x 147mm in random lengths

Areas of use:
Refurbishment / Domestic / Commercial

Use class:
Class 3

Finish options available:
6 matt finish timber tones

Bespoke options:
Complete range of RAL/B.S. colours available, details on application.

Additional features:
Comprehensive range of matching accessories available

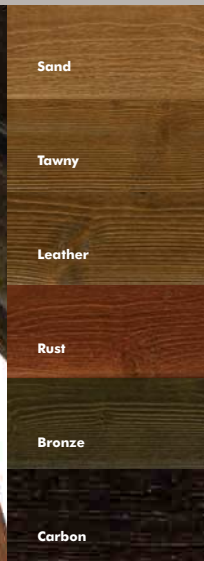

NEED A SAMPLE?
CONTACT US FOR DETAILS



BESPOKE PROFILES AVAILABLE
CONTACT US FOR DETAILS

**SEVEN VIVID PAINT COLOURS,
FOR AN EYE-CATCHING EFFECT**

The ArborClad Pre-finished Traditional range includes stunning matt stained and eye-catching painted options, and is produced by one of Europe's leading manufacturers of stained and painted timber cladding. Highly specified by architects and contractors, the range is ideal for a wide spectrum of projects.

By selecting an ArborClad Pre-Finished product, employing a factory applied high quality surface finish, you are eliminating the inherent problems normally associated with on-site finishing. The paint or stain is applied to timber at a pre-determined moisture content, in a clean dirt/dust free environment, thereby ensuring consistency and quality of appearance and performance.

- **7 core factory applied colours on our technically advanced profile**
- **New ArborClad 2 secret fix profile for an updated modern look and an easier more cost-effective installation**
- **10 year maintenance free guarantee against timber decay**
- **Up to 10 year comprehensive maintenance free guarantee of the factory applied finish (cracking, peeling, blistering and colour)**
- **Norway Spruce treated to Use Class 3, durable up to 50 years as a result of the combined timber treatment and the factory applied paint finish**
- **Cladding certified CTB B+ (guarantees the compliance to EU and French standards) and CE marked**
- **FSC® certified stocks upon request, subject to availability**



FULLY FINISHED CLADDING RANGE

**VIVID PAINTED
CLADDING**

A wide selection of attractive, coloured exterior cladding panels suitable for exterior use



The mark of responsible forest management

CONTACT US FOR FURTHER SPECIFICATION DETAILS

**Profiles available:
Offset**

**Sizes available (finished sizes shown):
19mm x 147mm in random lengths**

**Areas of use:
Refurbishment / Domestic / Commercial**

**Use class:
Class 3**

**Finish options available:
7 painted tones**

**Bespoke options:
Complete range of RAL/B.S. colours available,
details on application.**

**Additional features:
Comprehensive range of matching accessories
available**



White

Pearl White

Luminous Grey

Clay

Grey Beige

Storm Blue

Oak Blood Red



**NEED A SAMPLE?
CONTACT US FOR DETAILS**



**PRE-FINISHED & BESPOKE
PROFILES AVAILABLE**

**EXCLUSIVE MATT COLOURS
TO ANTICIPATE EXTERNAL
DECORATION TRENDS**

The ArborClad Pre-finished Prime range covers innovative matt and metallic painted options and is produced by one of Europe's leading manufacturers of stained and painted timber cladding and as such is highly specified by architects and contractors.

By selecting an ArborClad Pre-Finished product, employing a factory applied high quality surface finish, you are eliminating the inherent problems normally associated with on-site finishing. The paint or stain is applied to timber at a pre-determined moisture content, in a clean dirt/dust free environment, thereby ensuring consistency and quality of appearance and performance.

- **6 exclusive matt colours, for a unique signature finish to your facade**
- **New ArborClad 2 secret fix profile for an updated modern look and an easier more cost-effective installation**
- **10 year maintenance free guarantee against timber decay**
- **Up to 10 year comprehensive maintenance free guarantee of the factory applied finish (cracking, peeling, blistering and colour)**
- **Norway Spruce treated to Use Class 3, durable up to 50 years as a result of the combined timber treatment and the factory applied paint finish**
- **Cladding certified CTB B+ (guarantees the compliance to EU and French standards) and CE marked**
- **FSC® certified stocks upon request, subject to availability**



FULLY FINISHED CLADDING RANGE

MATT PAINTED MINERAL CLADDING

A wide selection of attractive, coloured exterior cladding panels suitable for exterior use



The mark of responsible forest management

CONTACT US FOR FURTHER SPECIFICATION DETAILS

**Profiles available:
Offset**

**Sizes available (finished sizes shown):
19mm x 147mm in random lengths**

**Areas of use:
Refurbishment / Domestic / Commercial**

**Use class:
Class 3**

**Finish options available:
6 innovative tints**

**Bespoke options:
Complete range of RAL/B.S. colours available, details on application.**

**Additional features:
Comprehensive range of matching accessories available**



Onyx Black

Anthracite Grey

Earth Brown

Mercury Brown

Fossil Grey

Jade Green



**NEED A SAMPLE?
CONTACT US FOR DETAILS**



**PRE-FINISHED & BESPOKE
PROFILES AVAILABLE**

Sizes shown are finished unless otherwise stated. Subject to stock availability at the time of order. Lead times may differ between colours. All colours are as accurate as the print process will allow, please request a sample prior to specifying.

**INNOVATIVE TINTS FOR A
UNIQUE SIGNATURE FINISH
TO YOUR FACADE**

The ArborClad Pre-finished Prime range covers innovative matt and metallic painted options and is produced by one of Europe's leading manufacturers of stained and painted timber cladding and as such is highly specified by architects and contractors.

By selecting an ArborClad Pre-Finished product, employing a factory applied high quality surface finish, you are eliminating the inherent problems normally associated with on-site finishing. The paint or stain is applied to timber at a pre-determined moisture content, in a clean dirt/dust free environment, thereby ensuring consistency and quality of appearance and performance.

- **4 very innovative tints for a unique signature finish to your facade**
- **New ArborClad 2 secret fix profile for an updated modern look and an easier more cost-effective installation**
- **10 year maintenance free guarantee against timber decay**
- **Up to 10 year comprehensive maintenance free guarantee of the factory applied finish (cracking, peeling, blistering and colour)**
- **Norway Spruce treated to Use Class 3, durable up to 50 years as a result of the combined timber treatment and the factory applied paint finish**
- **Cladding certified CTB B+ (guarantees the compliance to EU and French standards) and CE marked**
- **FSC® certified stocks upon request, subject to availability**



FULLY FINISHED CLADDING RANGE

**METAL EFFECT
PAINTED CLADDING**

A wide selection of attractive, coloured exterior cladding panels suitable for exterior use



The mark of responsible forest management

CONTACT US FOR FURTHER SPECIFICATION DETAILS

**Profiles available:
Offset**

**Sizes available (finished sizes shown):
19mm x 147mm in random lengths**

**Areas of use:
Refurbishment / Domestic / Commercial**

**Use class:
Class 3**

**Finish options available:
4 innovative tints**

**Bespoke options:
Complete range of RAL/B.S. colours available, details on application.**

**Additional features:
Comprehensive range of matching accessories available**



Iron Black

Cannon Blue

Metal Grey

Platinum



**NEED A SAMPLE?
CONTACT US FOR DETAILS**



**PRE-FINISHED & BESPOKE
PROFILES AVAILABLE**

ARBORCLAD TRADITIONAL CLADDING RANGE

SPECIES	ENVIRONMENTAL	PROFILE/S	FINISHED BOARD SIZE (THICKNESS X WIDTH)	LENGTHS AVAILABLE	No PER PACK	FINISHES	DURABILITY (USE CLASS)
Redwood	FSC® legal & sustainable	Shiplap Offset	ex 19mm x 125mm (finished size 15mm x 119mm) ex 25mm x 125mm (finished size 19mm x 117mm) ex 25mm x 150mm (finished size 19mm x 140mm)	Random	By project	Supplied unfinished	Slightly durable (Use class 3) If a finish is applied moderately durable
Larch	FSC® legal & sustainable	Shiplap Offset	ex 25mm x 150mm (finished size 19mm x 140mm)	Random	By project	Supplied unfinished	Moderately durable (Use class 3)
Cedar	Supplied under the PEFC recognised Canadian Standards Association	Shiplap Offset	ex 25mm x 150mm (finished size 19mm x 140mm)	Random	By project	Supplied unfinished	Durable (Use class 3)

ARBORCLAD THERMALLY TREATED CLADDING RANGE (IT IS ADVISABLE TO PRE-DRILL THERMAL BOARDS)

Thermo-D Redwood	PEFC legal & sustainable	Shiplap Offset	ex 25mm x 125mm (finished size 19mm x 117mm) ex 25mm x 150mm (finished size 19mm x 140mm)	Random	By project	Supplied unfinished	Durable (Use class 3)
Thermo-D Platowood Spruce	FSC® legal & sustainable	Shiplap Offset	ex 23mm x 125mm (finished size 19mm x 117mm) ex 23mm x 150mm (finished size 19mm x 140mm)	Random	By project	Supplied unfinished	Very durable (Use class 3) Durable (Use class 4)
Thermo-D Platowood Hardwood	FSC® legal & sustainable	Shiplap Offset	ex 23mm x 150mm (finished size 19mm x 140mm) ex 23mm x 200mm (finished size 19mm x 190mm)	Random	By project	Supplied unfinished	Durable (Use class 3)

ARBORCLAD FULLY FINISHED CLADDING RANGE

Pre-finished Rustic	PEFC legal & sustainable	Offset	ex 25mm x 150mm (finished size 23mm x 145mm)	3.75m 4.35m 4.95m	Shrink wrapped. 4pcs/pack 56pk/pallet	8 standard paint finishes. 10 year manufacturer guarantee	Durable (Use class 3)
Pre-finished Traditional	FSC® or PEFC legal & sustainable	Shiplap	ex 25mm x 150mm (finished size 19mm x 147mm)	3.25m - 4.75m (0.3m intervals. Lengths as provided)	Shrink wrapped. 5pcs/pack 21pk/pallet 1.9825m ² - 2.8975m ² per pack	10 year manufacturers Guarantee (underwritten by AXA insurance)	Durable (Use class 3)
Pre-finished Prime	FSC® or PEFC legal & sustainable	Shiplap	ex 25mm x 150mm (finished size 19mm x 147mm)	3.25m - 4.75m (0.3m intervals. Lengths as provided)	Shrink wrapped. 5pcs/pack 21pk/pallet 1.9825m ² - 2.8975m ² per pack	10 year manufacturers Guarantee (underwritten by AXA insurance)	Durable (Use class 3)

INSTALLATION NOTES:

All fixings to be a minimum of 40mm in from board ends or half the board width, whichever is the greater. Minimum of two fixings per board width. See page 20 for more information on installation.

DURABILITY

Durability, or resistance to decay is important when woods are selected for certain uses where the conditions are favourable for decay to develop. The various grades of durability mentioned below are resultant from exposure tests carried out in the UK and, accordingly, are approximate values applicable to areas with similar climate. Tests refer to all-heartwood stakes of 50mm x 50mm driven into the ground as posts and the five durability grades are defined as follows.

Class 1. Very durable

25 years plus when in direct ground contact

Class 2. Durable

15 - 25 years when in direct ground contact

Class 3. Moderately durable

10 - 15 years when in direct ground contact

Class 4. Slightly durable

5 - 10 years when in direct ground contact

Class 5. Perishable

Less than 5 years when in direct ground contact

Important information:

Additionally density figures given are only approximate values due to the fact that timber is a natural product and no two trees are alike. Life expectancy for on-site finished materials is solely dependent on how the materials are finished and maintained. With an adequate maintenance program most claddings will last far beyond the original paint manufacturers guarantee.

Please note Redwood, Larch, Western Red Cedar and all thermally treated products can also be treated for fire resistance. Fully factory finished items can be fire treated prior to finishing if required but this will increase delivery timescales substantially.

MATERIAL DENSITY (DRY)	RECOMMENDED METHOD OF FIXING	EXPANSION (GENERAL GUIDELINES)	BESPOKE OPTIONS
470-510kg/m ³	200mm from ground on treated timber battens min size 38x50mm. Maximum of 600mm centres. Min 2.1 x 50mm stainless steel annular ring shanknails or stainless steel screws	8-10mm from edge on a corner. 2mm between board ends. 3mm from the edge of skylights/windows	Can be machined to any required profile. Wide range of additional sections are also available at competitive rates and completed to meet set deadlines
560-590kg/m ³	200mm from ground on treated timber battens min size 38x50mm. Maximum of 600mm centres. Min 2.1 x 50mm stainless steel annular ring shanknails or stainless steel screws	8-10mm from edge on a corner. 2mm between board ends. 3mm from the edge of skylights/windows	Can be machined to any required profile. Wide range of additional sections are also available at competitive rates and completed to meet set deadlines
370-390kg/m ³	200mm from ground on treated timber battens min size 38x50mm. Maximum of 600mm centres. Min 2.1 x 50mm stainless steel annular ring shanknails or stainless steel screws	8-10mm from edge on a corner. 2mm between board ends. 3mm from the edge of skylights/windows	Can be machined to any required profile. Wide range of additional sections are also available at competitive rates and completed to meet set deadlines

RIOR TO FITTING) A light coloured, knot free hardwood timber alternative. Contact your local branch for details ALSO AVAILABLE TO ORDER **PLATO POPLAR**

450kg/m ³	200mm from ground on treated timber battens min size 38x50mm. Maximum of 600mm centres. Min 2.1 x 50mm stainless steel annular ring shanknails or stainless steel screws	8-10mm from edge on a corner. 3mm from the edge of skylights/windows	Supplied as class D treatment cycle for external use. Can supply materials as class 5 internal use only. Can be painted, stained and fire treated to class 0
420kg/m ³	150mm from ground on treated timber battens min size 38x50mm. Suitable for direct ground contact provided adequate ventilation is achieved, along with access for ongoing maintenance. Maximum of 600mm centres. Min 2.1 x 50mm stainless steel annular ring shanknails or stainless steel screws	8-10mm from edge on a corner. 3mm from the edge of skylights/windows	Can be painted, stained and fire treated to class 0. Also available in large section sizes for other structural applications. Less brittle than normal thermo treated woods. Can be machined to any required profile. Wide range of additional sections are also available at competitive rates and completed to meet set deadlines
450kg/m ³	200mm from ground on treated timber battens min size 38x50mm. Maximum of 600mm centres. Min 2.1 x 50mm stainless steel annular ring shanknails or stainless steel screws	8-10mm from edge on a corner. 3mm from the edge of skylights/windows	

9.45kg/m ²	Minimum 300mm from ground on treated battens 38x100mm. Use ring shank and round head HDG/stainless steel 2.5x50mm nails to fasten. Claddings at maximum 600mm centres with two nails spaced 50mm apart. Follow manufacturer's fitting instructions	8-10mm from edge on a corner. Cladding is 4-sides tongued and grooved. Follow manufacturer's fitting instructions	Additional colours are available to any BS/RAL number but only to minimum quantities. Further details on application
460kg/m ³ @12% humidity	Minimum 200mm from ground on treated timber battens 38x50mm min. Use min 2.1x50mm stainless steel coil/ring shank nails or screws to fasten. Claddings at maximum 600mm centres with two nails spaced 50mm apart. Follow manufacturer's fitting instructions	4-5mm from edge on a corner. Cladding is 4-sides tongued and grooved. Follow manufacturer's fitting instructions	Additional colours are available to any RAL number but only to minimum quantities (400m ²). Further details on application
460kg/m ³ @12% humidity	Minimum 200mm from ground on treated timber battens 38x50mm min. Use min 2.1x50mm stainless steel coil/ring shank nails or screws to fasten. Claddings at maximum 600mm centres with two nails spaced 50mm apart. Follow manufacturer's fitting instructions	4-5mm from edge on a corner. Cladding is 4-sides tongued and grooved. Follow manufacturer's fitting instructions	Additional colours are available to any RAL number but only to minimum quantities (400m ²). Further details on application

IMPORTANT: Please allow an additional 5-10% of materials to cover joints and any waste incurred through such as cutting internal/external corners.

USE CLASS

As with any natural material, service life is dependant on maintenance and the environment it is situated in. The following Use class ratings offer approximate guidance. Before specifying we would recommend contacting ArborClad to confirm your requirements.

Use class 1

Under cover, fully protected from the weather and not exposed to wetting

Use class 2

Under cover, fully protected from the weather but where high environmental humidity can lead to occasional but not persistent wetting

Use class 3

Not covered, not in contact with the ground. Continually exposed to the weather or protected from the weather but subject to frequent wetting

Use class 4

In contact with the ground or fresh water and thus permanently exposed to wetting.

Use class 5

Permanently exposed to salt water



ArborClad would always recommend that to prevent the potential natural weathering and greying of materials, an appropriate UV filter paint, stain or oil treatment is applied and a suitable maintenance program is adhered to.

INSTALLATION GUIDELINES

Timber is a natural product and providing it is treated in accordance with the manufacturers recommendations it will remain looking good and will last a lifetime. The following installation guidelines are additional areas you may wish to consider when selecting and fitting your external cladding. For further information please refer to the manufacturers recommendations.

Part 1. The basic rules for installing cladding

Fixing external cladding

Softwood

Stainless steel annular ring shank/round head nails are appropriate for fixing softwood cladding:

- The nail length is generally minimum 50mm or 2.5 times the thickness of the board being fixed whichever is the greater and should be punched slightly below the wood's surface.
- Boards over 100mm wide should have double fixings.
- Make sure that butt joints always meet on sufficient batten support width.

- It's preferable to use stainless steel nails for all species but especially those with a high tannin content, and they are essential for timbers installed 'green'. By using Stainless Steel this avoids permanent staining due to the reaction of the tannin on mild steel or galvanised nails.

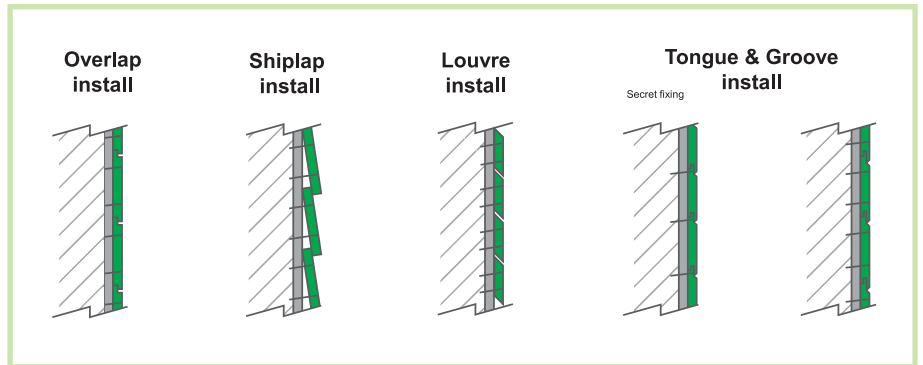

Hardwood

Stainless steel screws/annular ring shank nails are the preferred method of fixing for hardwood boards. Stainless steel screws are preferable, and essential for timbers installed 'green':

- Slight over-drilling of the screw holes will allow for any movement in the wood and prevent splits. Countersinking screws is also recommended.

- Where 'green' wood is used, it may be necessary to fit washers to the screws to maintain the fixing security. This can become a design feature.
- Metal clips, which also provide a 'secret fix' effect, may also be considered. Screw fixings should be minimum 40mm or half the width of the board, whichever is the great, from the end of the boards to avoid splitting.

Timber cladding must be able to fulfil several roles:

- **An aesthetic role:** It is the finishing touch to a new build or an advantageous solution to renovation project
- **A mechanical role:** Resistance to knocks & to eventual abrasion: the choice of species, the profile, the finish & style of installation are determining factors
- **A functional role:** Waterproofing in conjunction with the waterproof membrane, thermal insulating as a result of the natural timber & the air gap

Battens: Secondary frame

Timber battens generally need to allow for a fixing length which is minimum 50mm or 2.5 times the thickness of the board being fixed.

We recommend minimum batten size of 38mm thickness and for these to be pressure treated with suitable preservative.

- Fixing of battens:
- Stainless steel wood screws
 - Stainless steel nails
 - Anchors (Concrete walls)

Treatment:

- Minimum Class II – Class 3 in the case of a louvre type installation

* If fixing of battens is on a continuous support (Board)

** Distance between 2 battens & 2 fixings of the same batten

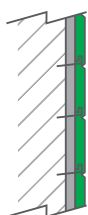

Fixing of cladding

- Stainless steel
 - Annular ring shank nails
 - Small round headed
 - Stainless steel screws
- 2 fixings over the height of the board except
 - Board cover width < 100mm (1 secret fixing 25mm from lower edge of the board)
 - ArborClad pre-finished traditional and prime 1 secret fixing at the top

Joints

ArborClad pre-finished products are assembled by means of tongue and groove on the edges. In such cases, a joint can be located between battens without any problems. All other ArborClad products are square-edge.

* Except bevel sidings, Channel cladding, cladding planks made of Norway spruce: The joints must be positioned on the battens

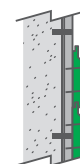
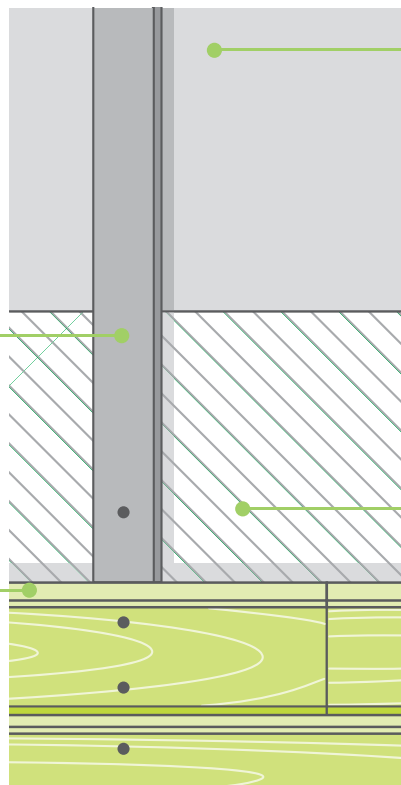

Its the waterproof membrane which assures the façade is waterproof.

- Wall
- Brick & block
 - Timber frame
 - Concrete

Air Gap

- Minimum thickness: 1cm
- Ventilation (1 opening for ever 2 floors minimum)
- Non-restricted air entry & exit, minimum section 50cm² per metre of cladding
- The timber battens must not restrict the circulation of air

See part two on opposite page

Waterproof membrane

- Compulsory (Except on poured concrete walls or walls already waterproof)
- Minimum permeability: 0.5g/m².h.mm Hg
 - Fixing by means of timber battens
 - Minimum overlap: 5cm horizontal joints 10cm vertical joints
 - Foresee a UV resistant waterproof membrane in case of a louvre type installation.

NB: Waterproofing is not the primary function of cladding

Part 2. Types of cladding installation

Board sizes

Horizontal boards:

- Shiplap or feather edge type boards should have a minimum of 10mm overlap, but allow 2mm gaps between the upstands for movement in the timber.
- Tongued and grooved boards should have a maximum face width of 150mm, with a 2mm clearance above the tongue for expansion. Most commercially produced profiles will include these tolerances. Install with the tongue upwards.
- Open joint boards should have an 8-15mm gap at the 'water face'. Chamfered edges allow the boards to overlap slightly, reducing any exposure of the cavity.

Vertical boards:

- The face width of vertical boards should not exceed 150mm. The most versatile fixing method is board on board. Any overlap should be a minimum of 20mm.

Diagonal boards:

- Should be fixed on battens, as for vertical boards, taking into consideration the comments above for overlaps or tongue and groove styles.

Using battens

Use battens that are preservative treated and structurally graded to ensure they are able to carry the weight of the board material. Fix horizontal boards to vertical battens, taking care where boards are joined to ensure they sit securely on sufficient batten width. Conversely, fix vertical boards to horizontal battens, with vertical 'counter' battens to facilitate drainage and ventilation. Support battens should be fixed at spacings of no more than 600mm, whether vertical or horizontal. And at no more than 400mm for diagonal boards.

These spacings will maintain the overall stability of the cladding.

Remember the cavity

The timber cladding you are fixing to the building is effectively an outer layer of protection against the elements. However, a cavity should be formed behind the cladding to allow any water or moisture that might penetrate the cladding to escape.

This ensures internal and external surfaces of the wood maintain a similar moisture content, reducing the potential for movement and distortion, allowing ventilation between the inner and outer surfaces.

The cavity should be at least 19mm wide, but may be wider, depending on the thickness of fixing battens. A weatherproof membrane is usually required to protect the structure, although this may not be needed on masonry. Additionally, if not sealed a fly screen membrane should also be used to prevent insect infiltration.

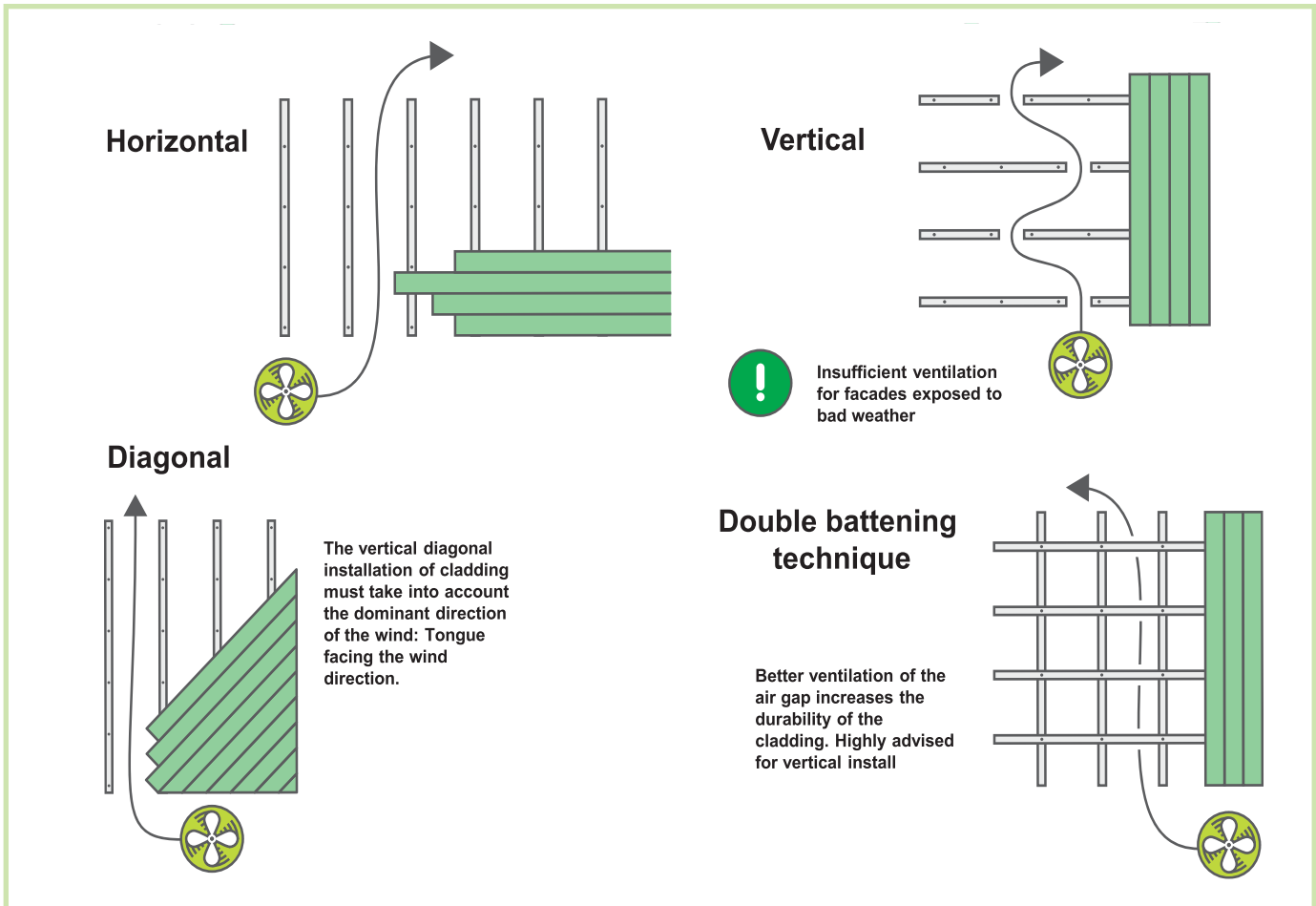

Part 3. Precautions for bottom fixing

Vertical install

Horizontal install

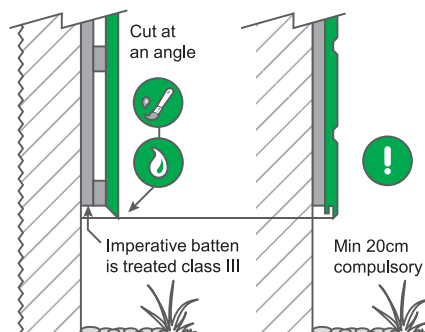

Treat cut ends with timber preservative

The spray of water risks keeping the lower boards constantly humid. It is advised to leave the ground uncovered (at the foot of the wall) or to cover with stones/gravel

Aeration grill "Anti-rodent"

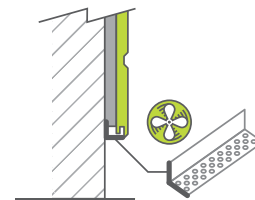

Regardless of the system used to finish off the lower cladding board, it is necessary to have at least 50 cm² of air inlet per metre on a façade covered in cladding

Part 4. Cladding details

Window and door openings

Openings within a wall require special attention to avoid the need to notch or split the boards. These openings need to be dimensionally compatible with the cladding to provide a good appearance as well as allowing for fixings. Thought also needs to be given to the 3-dimensional relationship of any flashings, sills etc. to allow for adequate drainage of water from the cladding surface and board ends.

Corner details

This is an important area of fixing detail, not just aesthetically but functionally, to ensure adequate protection against water.

Mitring boards at corners is not recommended for pre-finished products, as natural movement of the timber will allow the joint to open, causing failure of the surface coating and water ingress.

Mitring the ends of boards can be considered, but it is advisable to provide a gap between any adjoining surfaces and pre-finishing/treating all exposed ends.

Internal and external corners are more easily detailed on vertical boarding. These can be jointed by 'tonguing and grooving' to give added stability and protection.

Solutions for internal cladding angles

Timber allows for a wide variety of design options for finishing. These can be simple solutions or bespoke profile manufacture. Below are just a few commonly used solutions for forming internal angles.

Solution for an internal angle

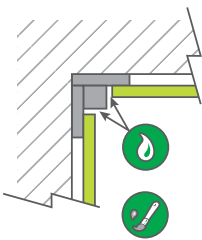

Possibility to highlight the corner by changing colour

Timber frame with a column corner

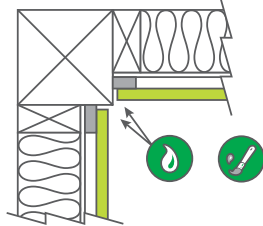

The most discrete: Mitre joint

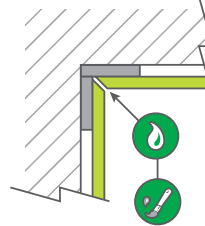

It is imperative to align the cladding from one wall to another

Cladding / render joint

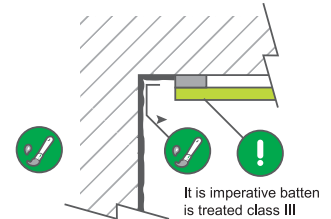

It is imperative batten is treated class III

Re-paint all cuts
Retreat the cuts (Insecticide & fungicide product) in the event of using a Norway spruce cladding

Solutions for external cladding angles

Timber allows for a wide variety of design options for finishing. These can be simple solutions or bespoke profile manufacture. Below are just a few commonly used solutions for forming external angles.

The most used, the least discrete

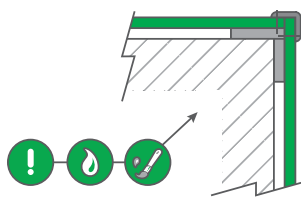

Remember the cladding cuts behind the corner

Suggestion for highlighting a corner

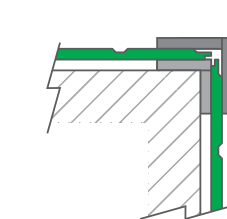

Possibility to change colour

The most discrete: Mitre joint

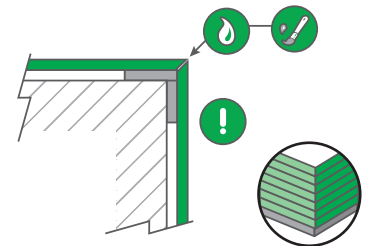

Risk of water retention

Cuts must definitely be retreated or repainted
It is via the cuts when they are not protected that the cladding deteriorates (Humidity retention & rotting)

Part 5. Profile lay and coverage per sqm (finished sizes)

	Cover size	lmt /m2		Cover size	lmt /m2
15 x 119mm shiplap	109mm	9.10	19 x 147mm secret-fix	122mm	8.19
15 x 119mm T&G	112mm	8.90			
19 x 117mm shiplap	100mm	10.0	19 x 190mm shiplap	175mm	5.70
19 x 117mm offset	95mm	10.5	19 x 190mm offset	170mm	5.88
19 x 117mm T&G	112mm	8.90	23 x 145mm offset	120mm	8.30
19 x 140mm shiplap	125mm	8.00			
19 x 140mm offset	120mm	8.30			
19 x 140mm T&G	135mm	7.40			

Please note: All offset profiles allow for installation by secret-fixing or secret-fix offset. For further information or advice please contact us.

**Part 6.
Accessories**

A comprehensive selection of accessories are available to make completing your individual project straightforward.

Timber battening for structure

Basic external corner



Internal corner

Opening surround profile

Board for inside window openings

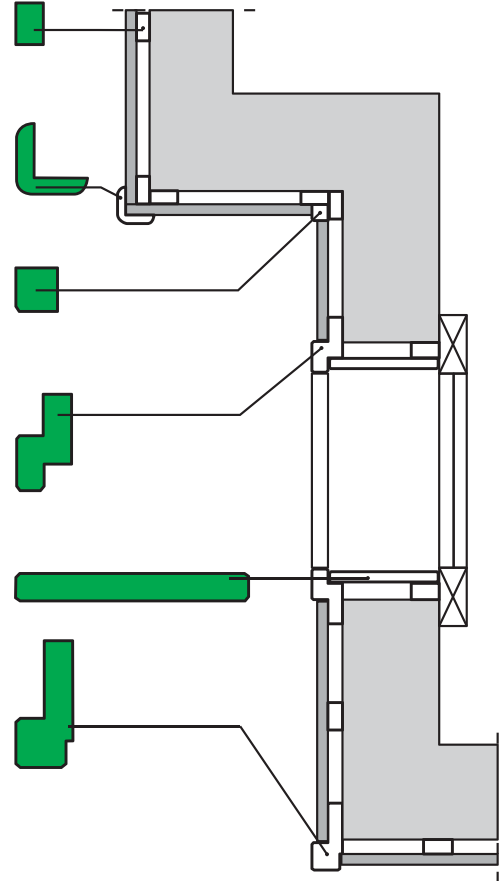
Discreet external corner

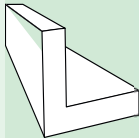
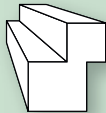
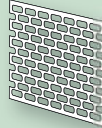
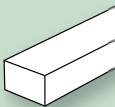
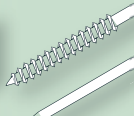

							
		EXTERNAL CORNER (TIMBER)	INTERNAL CORNER (TIMBER)	FLY MESH (SUPPLIED IN ROLLS)	TREATED TIMBER BATTENS	STAINLESS STEEL SCREWS/NAILS	TOUCH UP PAINT
arborClad TRADITIONAL	REDWOOD	✓	✓	✓	✓	✓	-
	LARCH	✓	✓	✓	✓	✓	-
	CEDAR	✓	✓	✓	✓	✓	-
arborClad THERMO-D	REDWOOD	✓	✓	✓	✓	✓	-
	SPRUCE	✓	✓	✓	✓	✓	-
	HARDWOOD	✓	✓	✓	✓	✓	-
arborClad PRE-FINISHED	RUSTIC	✓	✓	✓	✓	✓	✓
	TRADITIONAL	✓	✓	✓	✓	✓	✓
	PRIME	✓	✓	✓	✓	✓	✓

*These accessories are just a few provided by manufacturers to make installation of your cladding as simple and straightforward as possible. Accessories may vary in size and availability per cladding range. ArborClad is able to manufacture bespoke cladding profiles and accessories to your exact requirements. For clarification and further details please contact us.

YOUR CLADDING... EXACTLY HOW YOU NEED IT



ArborClad is one of the most comprehensive ranges of timber cladding available on the UK market today. Timber is a natural product. Its hygroscopic properties mean that, through changes in moisture and humidity, timber cladding may move and, regardless of type or species, over time turn a silver grey colour through natural oxidation.

It can, unless naturally durable or pre-treated, be subject to mould or insect attack. For this reason it is important, when choosing your cladding, that consideration be given to the location, species, treatment and surface finish you require. ArborClad work with leading manufacturers who provide a comprehensive range of timber preservatives, fire and finishing systems to ensure that your cladding will look good for longer.

Based on years of experience, ArborClad specialises in creating traditional and bespoke timber cladding solutions to exacting specifications. Computer-controlled cutting machines allow precision profiling in manufacture, providing a truly bespoke service. Traditional designs through to more elaborate requirements are catered for by our team, who provide a timber cladding solution that not only meets your needs but those of your building.

From concept to completion, we work regularly with architects and their clients to ensure that the product specified is the right product for the right situation and at the right price.

With customers ranging from local builders and renovators to major contractors and national house builders, ArborClad is uniquely placed to meet all your timber cladding requirements.

**Comprehensive timber treatments* available: timber preservatives
fire protection • priming
staining. Ask for details.**

*Dependent on specification, ask for details.



Protection, ingrained

Fire protection is a crucial consideration for modern buildings of today along with development and refurbishment of existing structures. Where Building Regulations require fire performance in accordance with British Standards (Typically Class 0 or Class 1) or Euroclass B or C, ArborClad recommends, and can provide, pre-treatment with a quality assured flame retardant applied by a processor approved by the product manufacturer. Available for both internal or external use and, if required, complete with a wide range of supplier finishing applications (paints/stains etc) ArborClad can provide the complete solution for today's high demands.



NB - Designers should satisfy themselves that the description of the performance achieved in fire test 'classification reports' corresponds with the species and size of cladding that they plan to specify.

LIMITLESS OPTIONS

Bespoke profiles are available to meet your particular specifications, the only limit is your imagination.



CALL US TO DISCUSS YOUR INDIVIDUAL REQUIREMENTS
BESPOKE SECTIONS, PROFILES, FINISHES AND SIZES AVAILABLE



Commercial cladding

ArborClad Traditional Larch

The ArborClad timber cladding range is an ideal solution where cost and longevity are key drivers to specification.

Building designers, timber frame manufacturers and specifiers are choosing timber cladding for its inherent qualities and its suitability for use in panel sections and off-site modular construction.

Utilising off-site manufacturing techniques and the latest design technology, panels are able to be transported to site ready for erection, saving both time and associated construction costs. The advantage of producing panels in a controlled environment mean that additional quality control checks can be made and accuracy and quality of installation enhanced before the product has left the factory gate.

Timber cladding, in particular when used with timber frame construction, provides a durable and lightweight finishing option. The result being that the building exterior appears warm, fresh and clean in appearance whilst also benefiting from additional thermal and acoustic performance.

The commercial cladding projects shown on this page, sited in both Wales and Doncaster, utilised over 500m² of ArborClad Traditional Larch cladding, creating a highly durable and resilient exterior.





University of Sheffield

ArborClad Thermo-D Redwood

Some 40,000 running metres of thermally treated timber cladding, conditioned for exposed external application, was installed extensively on The University of Sheffield's latest accommodation blocks at the new Endcliffe Student Village in the city.

With a service life of up to 30 years, thermally treated cladding is ideal for use where an attractive, durable and ecological solution is required.

The treatment process ensures enhanced weather performance through the removal of moisture content and naturally occurring resin. The treated cladding is fully stable, meaning that no additional processes or finishing is required on site.

Thermally treated cladding is one of several cladding solutions offered by ArborClad. The range has been selected using timbers sourced only from well managed and sustainable forests to ensure that a full Chain of Custody certification can be achieved.



Marks and Spencer's Bradford, West Yorkshire

ArborClad Thermo-D Platowood Spruce

Marks and Spencer's new multi-million pound northern distribution centre in Bradford, West Yorkshire, has been completed with a facade of high performance thermally treated Platowood cladding.

The high-technology centre, close to the motorway network, is part of Marks & Spencer's programme to consolidate its existing logistics network. The new low carbon facility has been designed to meet the demands of M&S's environmental initiative.



Cumbria Partnership NHS Foundation Trust

ArborClad Thermo-D Platowood Hardwood

The UK's first specification of thermally treated Platowood Fraké timber cladding forms the exterior facade of Cumbria Partnership NHS Foundation Trust's newly refurbished ten-bed psychiatric intensive care unit.

The facility, known as Rowanwood Ward, is part of the Carleton Clinic on Cumwhinton Road in the city. It has been extensively developed and finished with 150 m² of this highly durable and attractive cladding solution.



Cambourne Primary School

ArborClad Pre-Finished Rustic

Finished in ArborClad Pre-Finished Rustic cladding, the new temporary buildings that house Cambourne's Third Primary School make a visually dramatic yet environmentally sustainable statement to both school users and the community of which the school is a part.

In less than six weeks from receipt of order, the cladding was supplied and delivered to site in a bespoke RAL colour, along with a broad range of specially manufactured joints, corners and finishes to ensure a perfect fit and so that the product retains its weather resistant properties.



A specialist range comprising the highest quality, sustainable cladding products. Perfect for any application, from domestic and commercial to refurbishment.

Available from your nearest branch of Howarth Timber, the UK's largest privately owned and operated timber group with branches located nationwide

HOWARTH TIMBER & BUILDING SUPPLIES

NORTH WEST

Accrington	01254 380 500	sales.accrington@howarth-timber.co.uk	BB5 0DN
Ashton	0161 330 1634	sales.ashton@howarth-timber.co.uk	OL7 0AG
Blackburn	01254 699 696	sales.blackburn@howarth-timber.co.uk	BB1 3EE
Burnley	01282 426 241	sales.burnley@howarth-timber.co.uk	BB10 1RZ
Bury	0161 761 6416	sales.bury@howarth-timber.co.uk	BL9 6AQ
Darwen	01254 873 552	sales.darwen@howarth-timber.co.uk	BB3 2ES
Manchester	0161 834 8505	sales.manchester@howarth-timber.co.uk	M4 5HD
Oldham	0161 620 2128	sales.oldham@howarth-timber.co.uk	OL1 3LJ
Rochdale	01706 710 962	sales.rochdale@howarth-timber.co.uk	OL16 2AA
Sale	0161 973 9578	sales.sale@howarth-timber.co.uk	M33 6LB

YORKS & Lincs

Barnsley	01226 289 494	sales.barnsley@howarth-timber.co.uk	S75 2BL
Bradford	01274 871 411	sales.bradford@howarth-timber.co.uk	WF15 8ER
Dewsbury	01924 462 186	sales.dewsbury@howarth-timber.co.uk	WF13 2AF
Grimsby	01472 361 621	sales.grimsby@howarth-timber.co.uk	DN32 9BA
Leeds	0113 2000 100	sales.leeds@howarth-timber.co.uk	LS9 0RA
Malton	01653 697 776	sales.malton@howarth-timber.co.uk	YO17 6BT
Richmond	01748 850 600	sales.richmond@howarth-timber.co.uk	DL10 4SX
Scunthorpe	01724 860 325	sales.scunthorpe@howarth-timber.co.uk	DN15 6XH
Thorne	01405 813 515	sales.thorne@howarth-timber.co.uk	DN8 5DY
Wakefield	01924 372 291	sales.wakefield@howarth-timber.co.uk	WF1 5DW
York	01904 629 931	sales.york@howarth-timber.co.uk	YO26 4ZH

MIDLANDS

Corby	01536 407 079	sales.corby@howarth-timber.co.uk	NN18 8ET
Derby	01332 360 233	sales.derby@howarth-timber.co.uk	DE1 3QT
Mansfield	01623 624 455	sales.mansfield@howarth-timber.co.uk	NG19 7JG
Newcastle	01782 715 900	sales.newcastle@howarth-timber.co.uk	ST5 1AW

LONDON & SOUTH EAST

Dartford	01322 286 844	sales.dartford@howarth-timber.co.uk	DA1 1BN
London	020 8691 6237	sales.london@howarth-timber.co.uk	SE4 2LY
Tottenham	020 8808 4337	sales.tottenham@howarth-timber.co.uk	N17 6RA

HOWARTH TIMBER ENGINEERING

Ashton	0161 339 4581	ashton@howarth-te.com	OL7 0AG
Brighton	01757 288 300	brighton@howarth-te.com	YO8 6LY
Bury St. Edmunds	01284 772 700	bury@howarth-te.com	IP32 7QW
Huddersfield	01484 513 377	huddersfield@howarth-te.com	HD1 3UN

HOWARTH WINDOWS & DOORS

New Holland	01469 530 577	windows&doors@howarth-timber.co.uk	DN19 7RT
-------------	---------------	------------------------------------	----------