

3 Typical section of Quarry Access Road
1 : 25

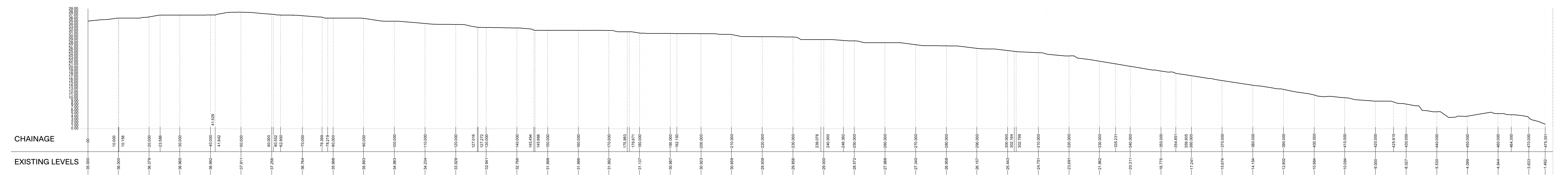

1 PL_Quarry Access Road Section_Existing
1 : 500

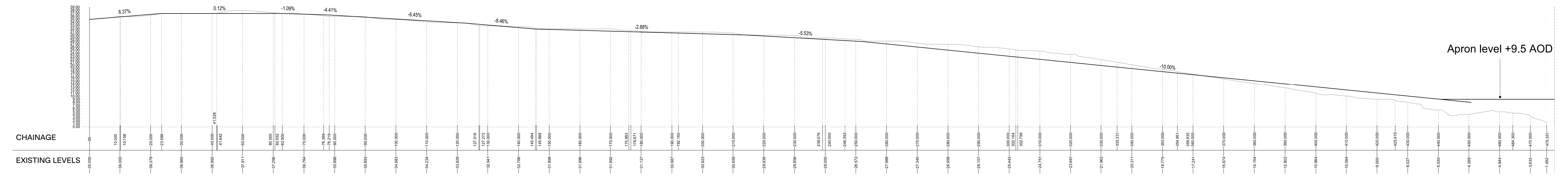

2 PL_Quarry Access Road Section_Proposed
1 : 500

<p>Notes</p> <p>Disclaimer: The user shall verify the accuracy of the information provided in this drawing. The user shall be responsible for the accuracy of the information provided in this drawing. The user shall be responsible for the accuracy of the information provided in this drawing.</p>	<p>Consultants</p> <p>Project Manager: Redcliffe Planning Consultant: Giffie Quantity Surveyors: G&T Structural Engineers: AKT11</p>	<table border="1"> <tr> <th>Rev</th> <th>Reason for Issue</th> <th>Date</th> <th>Drawn</th> <th>Checked</th> </tr> <tr> <td>00</td> <td>Issued for Planning</td> <td>14.04.2022</td> <td>Apt</td> <td></td> </tr> </table>	Rev	Reason for Issue	Date	Drawn	Checked	00	Issued for Planning	14.04.2022	Apt				<p>Client: Dayhouse Holdings Ltd Project: Dayhouse Quarry Drawing Title: Quarry Haul Road - Proposed Sections As indicated @ A0</p>
			Rev	Reason for Issue	Date	Drawn	Checked								
00	Issued for Planning	14.04.2022	Apt												
<p>235 St John Street London EC1V 4NG www.aplondon</p>	<p>Project No: 21018 Drawing No: PL_P_220</p>	<p>Revision: 00</p>													