

- All trees to remain on site to be adequately protected during construction and other operations in accordance with BS 5837: 2012 "Trees in relation to Design, Demolition and Construction." Protection fencing shall be erected prior to any operations on site, and shall be considered sacrosanct, see details A and B.
- Debris to be removed from the furthest point from the retained surface back away from the tree. At no time shall vehicles be driven on exposed soil in the RPA.
- A banksman will be employed to act as a spotter to prevent bucket of the debris removal machine to extend below the broken material into the soils below.
- Only consolidated material to be broken and removed, loose hardcore under any such surface may be left in situ and covered with good quality topsoil.
- Large areas of removal to be carried out in phases with top-soil being spread prior to the next area being broken and removed. This will allow for the passage of machines to deliver and spread the soil.
- No area is to be left exposed for more than half a day before top soil is added to prevent desiccation of any roots under or within the unconsolidated material.
- As large an area around each tree as possible shall be protected. The minimum distance for the erection of protective fencing around each tree is below the outermost limit of the branch spread or at a distance equal to half the height of the tree, whichever is the further from the tree trunk.

- Condition 4,
 A: See Attached Drawing 106_11
 B: See Attached Drawing 106_11
 C: See Attached Drawing 106_11, Water, electricity and waste water drains to come from Orchard house in through a gap in the hedge.
 D: No special engineering required.
 E: Driveway to detail C and D with CORE Tree Root Protection (TRP) System across the RPA of T1 and T2.
 F: The scaffolding erected over the tree PA around the garage will be erected to avoid down posts in the RPA, see detail A.
 G: Root protection measures to be in place before commencement of development and no dig driveway completed after.

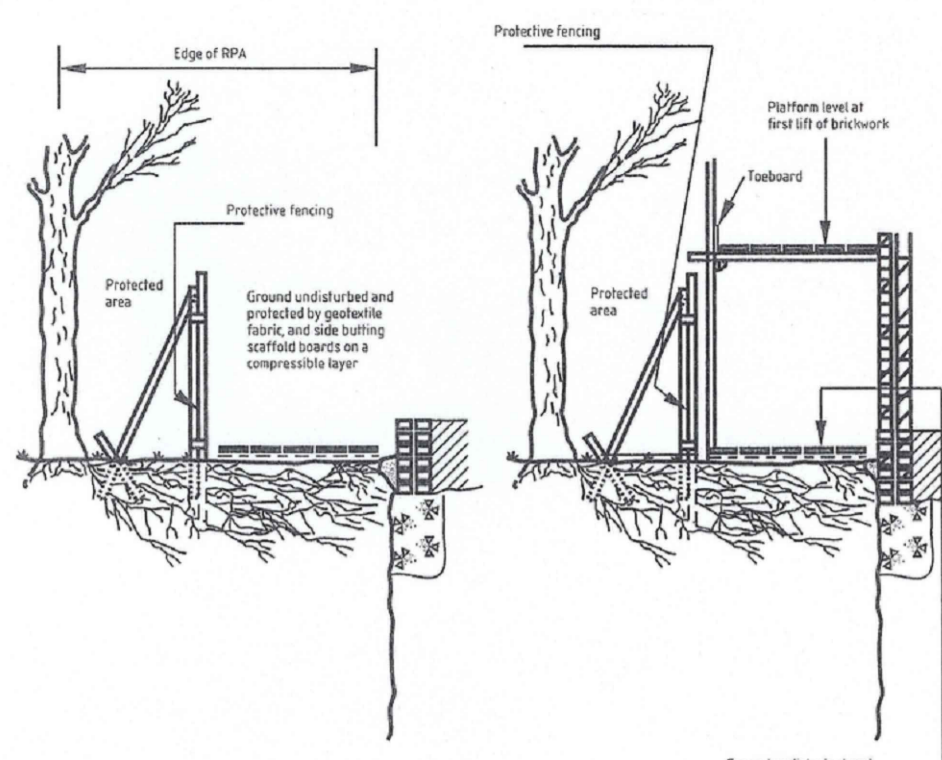
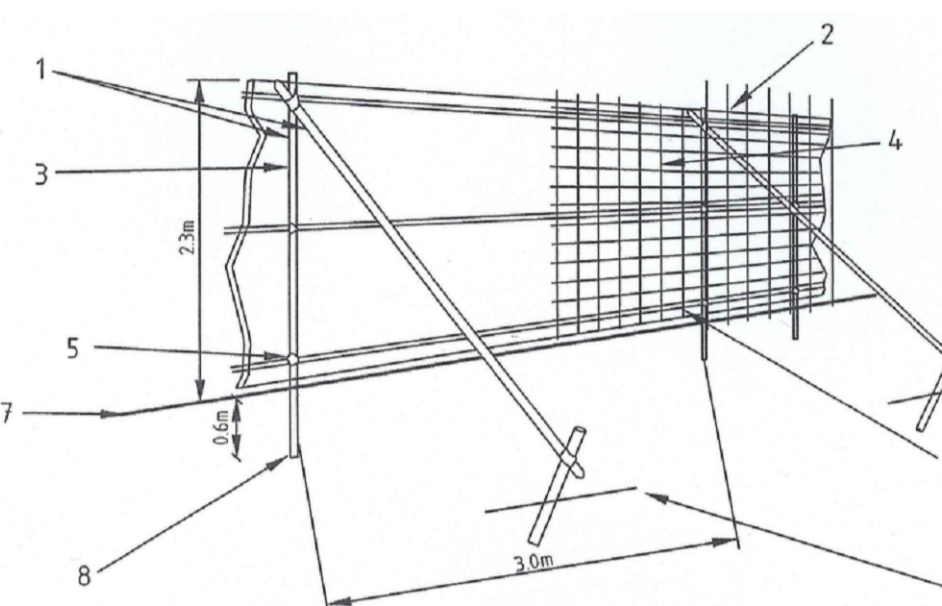

Figure 3. - Scaffolding within the RPA

DETAIL A



DETAIL B



DETAIL C

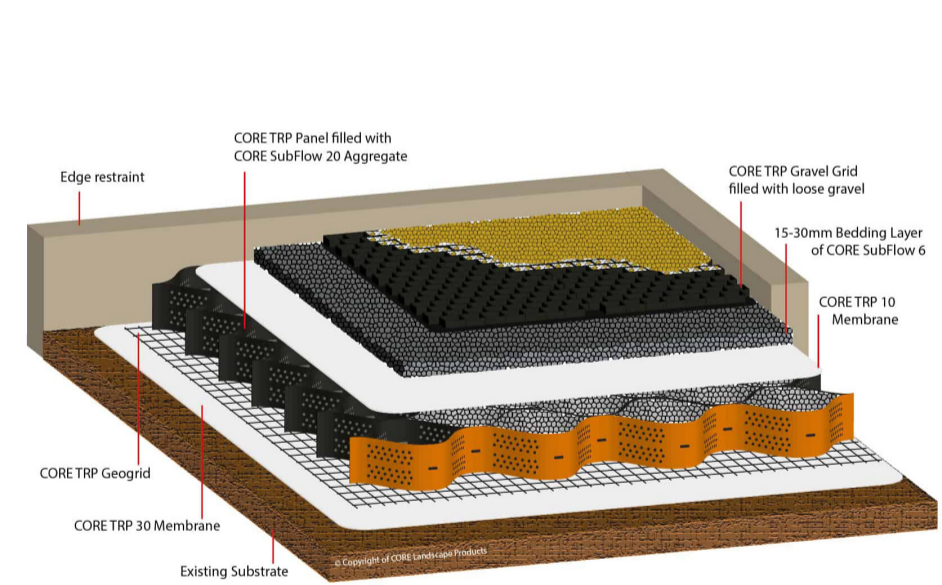

DETAIL D



PROTECTIVE FENCE
 To satisfy BS5837:2012 defining the "construction exclusion zone" there should be no access to this area and the area should remain for the duration of the construction period.

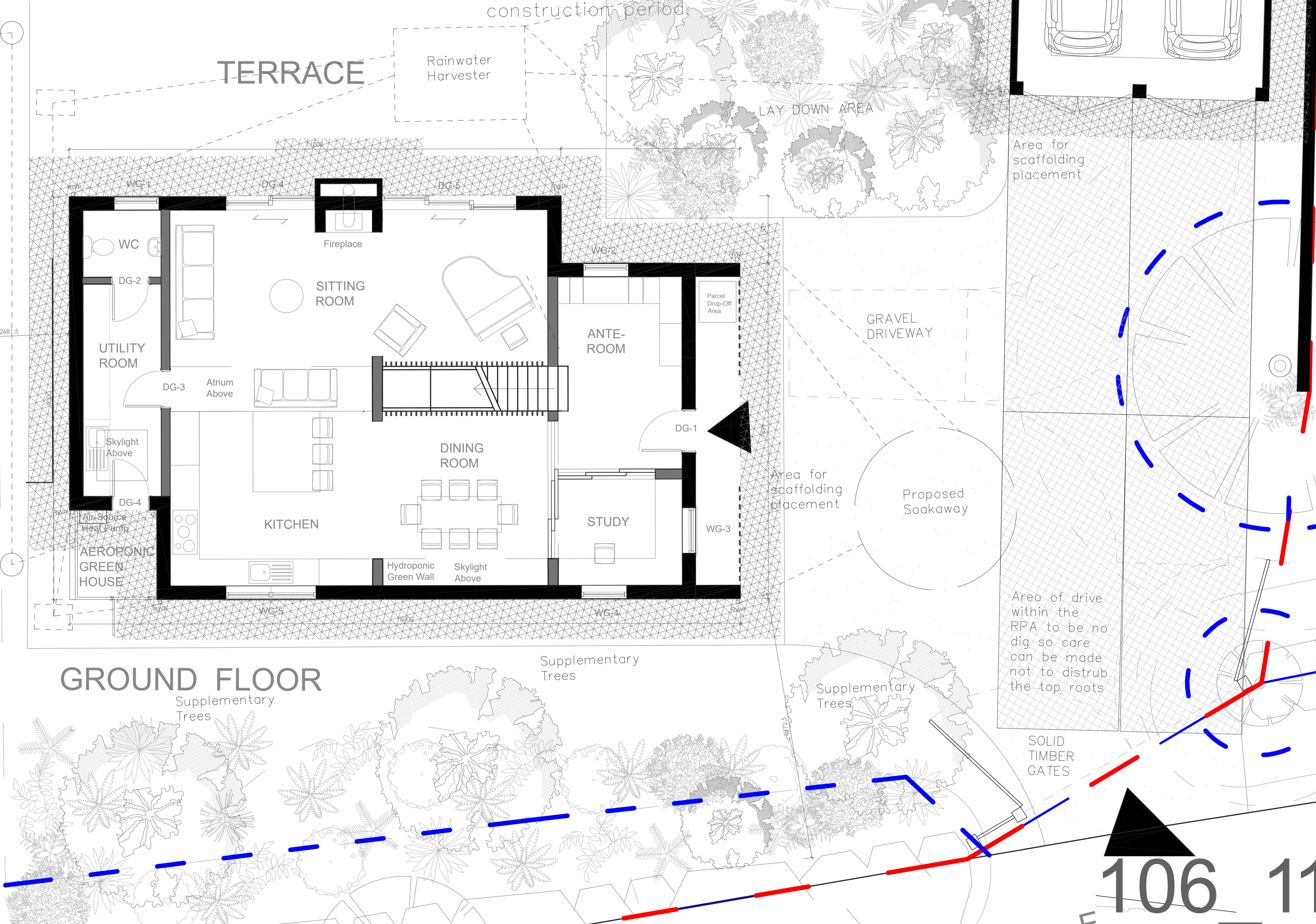

Revisions

Project
Hidden House

Client
Mr W. Campion

Drawing
11-Proposed Root Protection Plan
1:100 @ A1

Date
14.07.2021

www.campiondesign.co.uk
WILL CAMPION
 Architectural Designer
 will@campiondesign.co.uk