

- Application Boundary:**
- Proposed Site Finishes:**
- Tarmacadam - Car park and footpaths as indicated.
 - Marskals 200 x 100mm Charcoal Hardish paving - Patio
 - Charcoal imprinted concrete - Drive thru lane.
 - Charcoal brushed concrete - delivery route.
 - Brushed concrete - Corral.
 - Soft landscaping - see drawing number - PD07 for further details.
 - Salver floor: Min. 50mm thick self pour bounded rubber - to be confirmed by Project Manager.
 - Tactile blister paving.
- External Furniture & Fixings:**
- Substruc - Range Furniture 3 May 2015
 - Electrogalvanised steel structure, PPC RAL 7022. Table legs made of extruded aluminium, PPC RAL 7022. Table seats & plate in 12mm HPL panel with 12mm beech plywood HPL veneer.
 - Coffee table, single chair, bench, 2 seat table and round table must be fixed to the ground.
 - One Amrest Bench (left or right)
 - Coffee Table
 - Single Chair
 - 4 seats - Round Table
 - 4 seats - Rectangular Table
 - Umbrella - 4 x 4m Force 10 umbrella - colour Black with 29m Golden arch loop apex.
 - Dust Bin with 'Tidy Man' Sticker
 - Ash Bin
 - Pedestrian Guarding - 1500mm or 600mm long x 1100mm high. Timber effect galvanised steel.
 - Target Trash Bin - Corbio Delta Large Aperture Litter Bin by Gledson - 530mm x 470mm high x 1550mm high. Bin body & door: Black.
 - Cycle Stand - Stainless steel Sheffield cycle stands @ 800mm centres.
- General Site Proposal Notes:**
- Golden arch road markings to be yellow thermoplastic.
 - Drive thru related road markings to be yellow thermoplastic.
 - Accessible parking bays to be lined in yellow thermoplastic - to current T.M standards.
 - Parked order bays and numbers to be lined in yellow thermoplastic.
 - All other road markings to be white thermoplastic material unless otherwise stated.
 - Drop kerb - Adjacent to accessible parking, pedestrian crossings and along delivery routes.
 - 5m indicative lighting columns - position to be confirmed by M&E consultant.
 - Cranked Bollard - McDonald's standard cranked bollard, painted white.
 - Electricity Kiosk - Green Electricity Meter Housing, 2000m x 1000m x 2200mm High. Industrial location only. Position to be agreed with M&E. Consult after service entry positions have been established.
 - Play Frame (E09-004) - Tubular aluminium climbing frame with colored (red, white & green) laminate side panels, clear acrylic windows and fabric roof canopy. 3.5m x 3.5m x 4.5m high. See manufacturers information for further details.
 - Height Restrictor - PPC black 150mm dia circular hollow section steel 'Coal' Post height restrictor with warning bar suspended on chains. With panel above to read 'Maximum Height 2.7m @ 10°' White text on green background. DIA size = 4500mm wide x 3200mm high.
 - COO - PPC Aluminium Speaker Post (RAL 7022 Grey) 520m x 200m x 1700mm high with white acrylic canopy over 2300m x 2000m high.
 - Shelter 3400mm x 2400mm x 2200mm high. Steel frame with panels to 3 sides and profile metal roof. Complete with 29m benches and waste bin. See detail drawing 8076-SA-8738-P130.
 - Bollard - Brassy 115mm OD SS bollard - as door guard - 1000mm high or similar approved.
 - Existing elements to be removed/demolished.

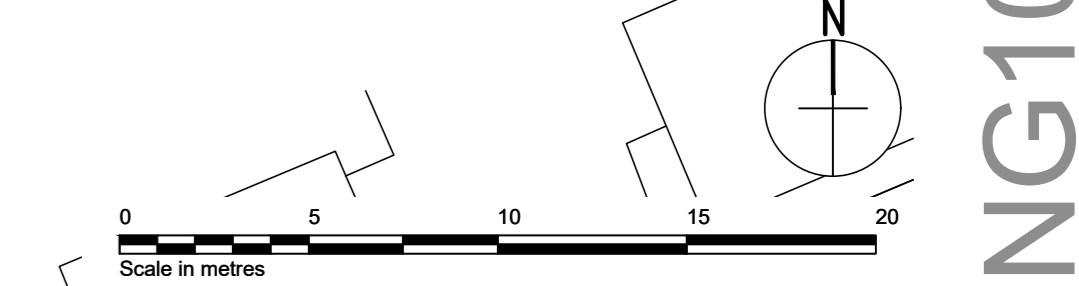
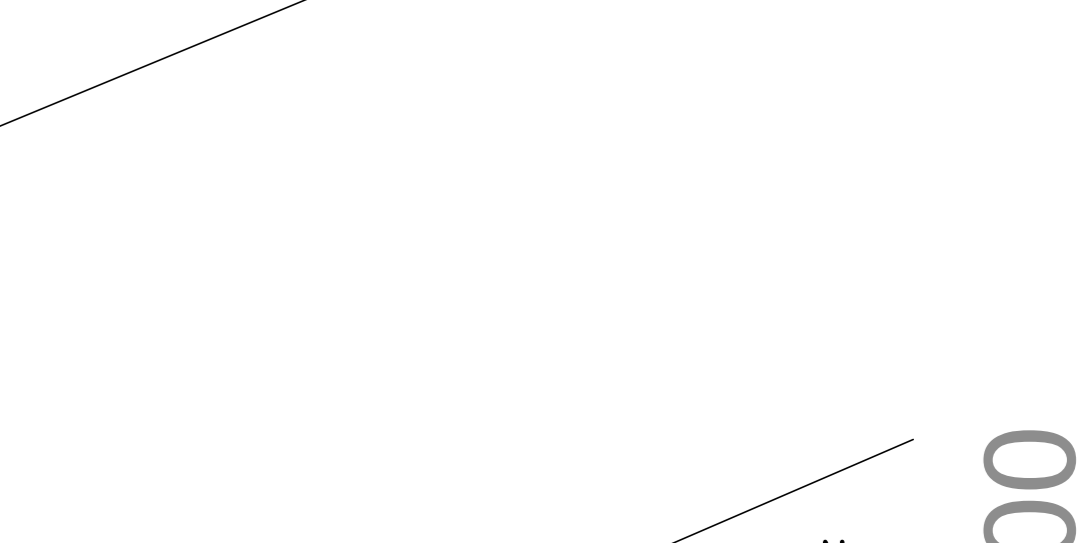
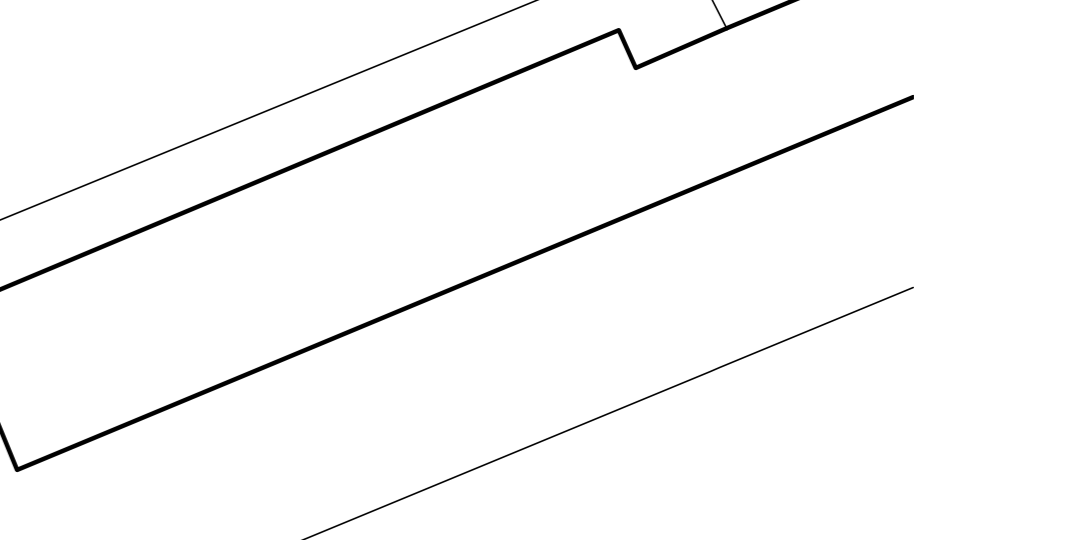
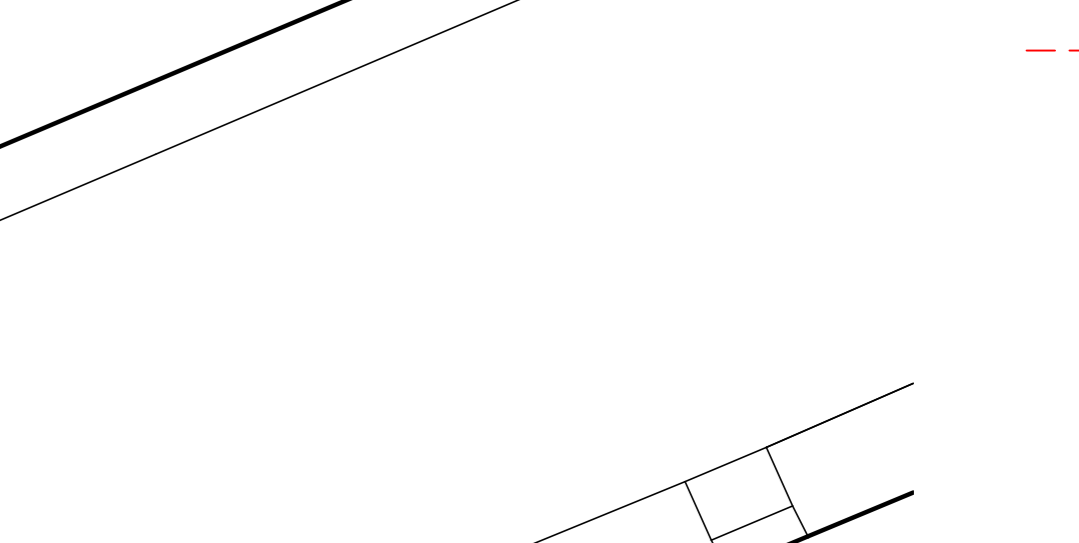
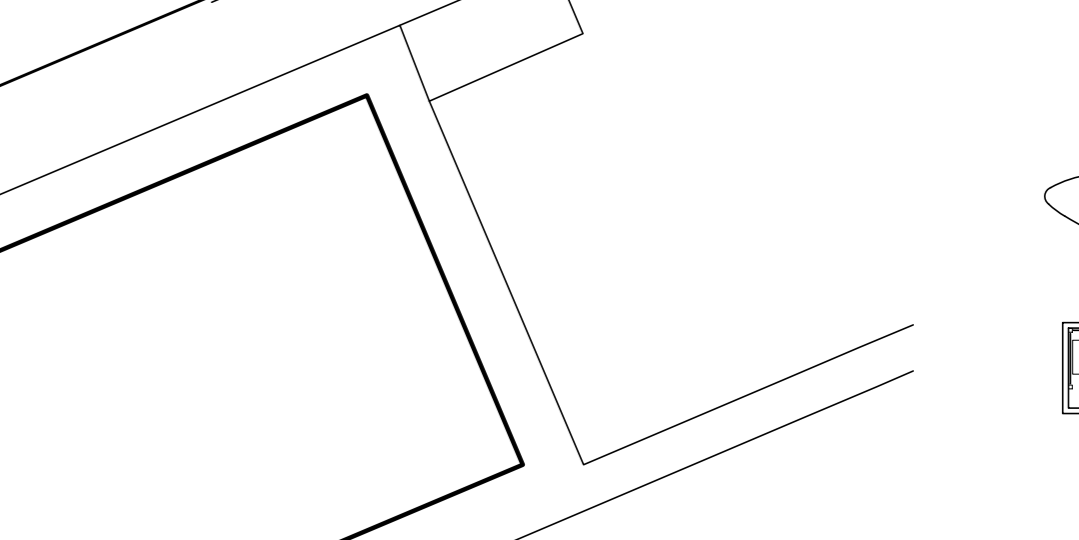
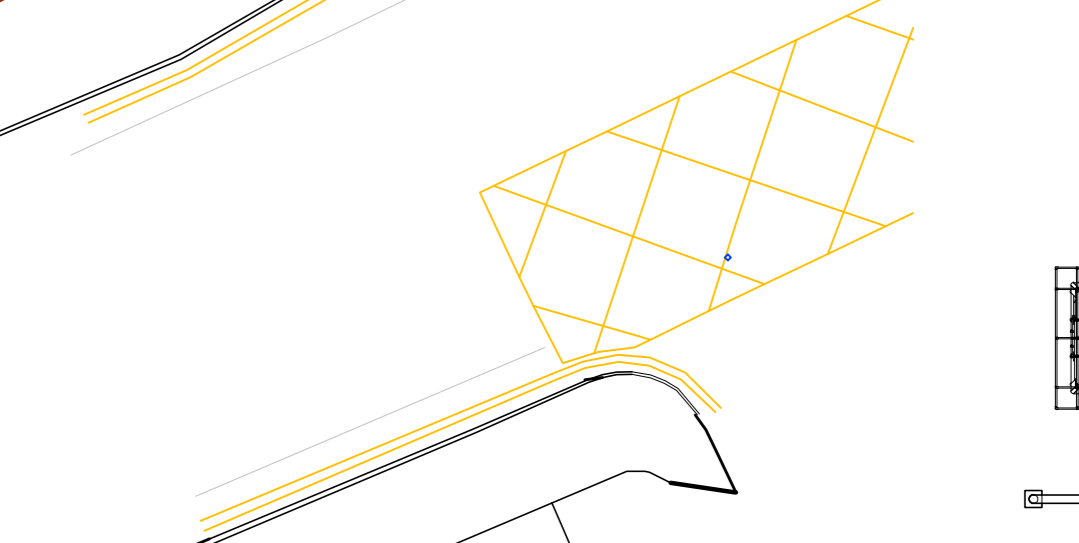
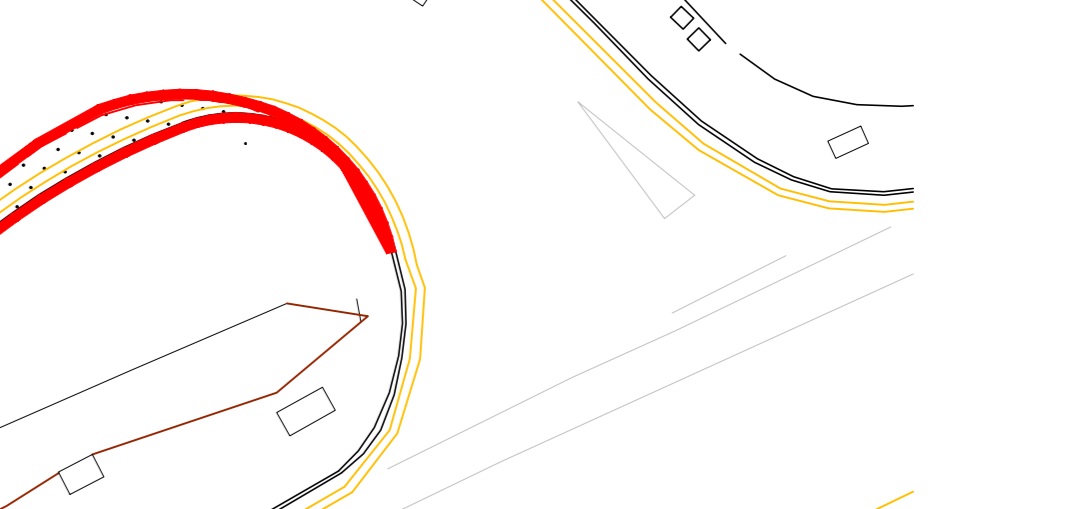
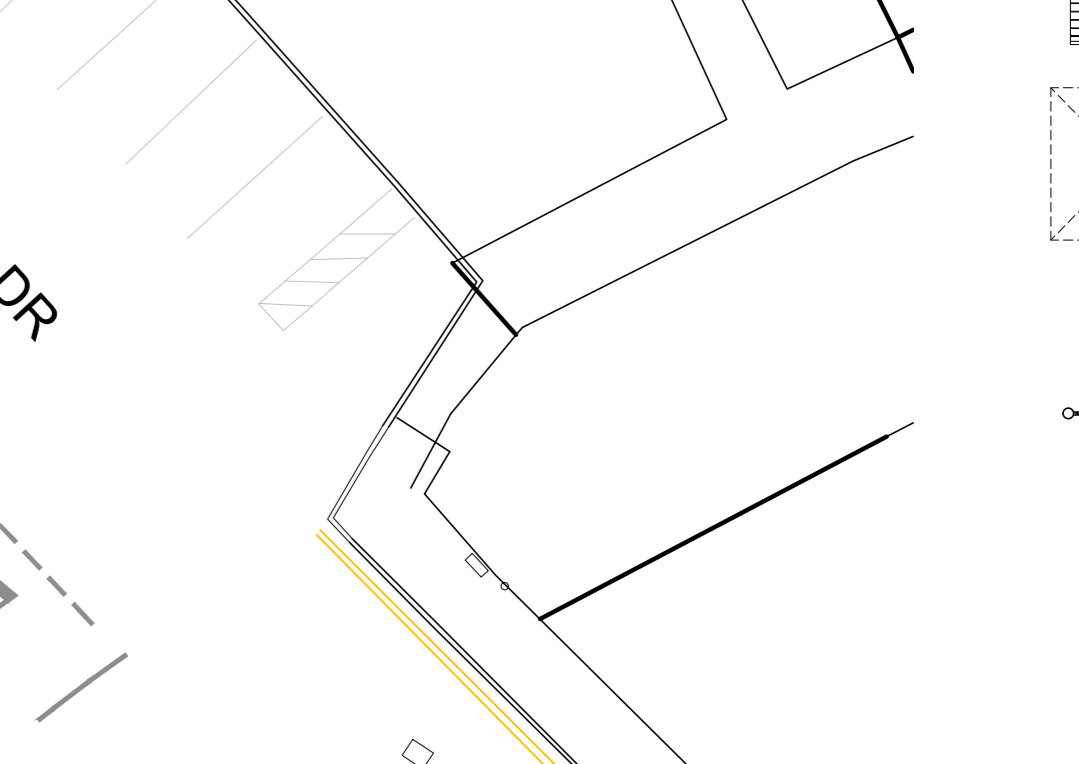

Rev	Date	Description	By	Check
1	10.03.2022	As per site plan	JL	JL
2	10.03.2022	As per site plan	JL	JL
3	10.03.2022	As per site plan	JL	JL
4	10.03.2022	As per site plan	JL	JL
5	10.03.2022	As per site plan	JL	JL
6	10.03.2022	As per site plan	JL	JL
7	10.03.2022	As per site plan	JL	JL
8	10.03.2022	As per site plan	JL	JL
9	10.03.2022	As per site plan	JL	JL
10	10.03.2022	As per site plan	JL	JL

REVISIONS NOTES:

All works to be carried out in accordance with the approved drawings and specifications. All materials to be used must be of the highest quality. All work to be carried out in accordance with the approved drawings and specifications. All work to be carried out in accordance with the approved drawings and specifications.

Project Information:

Project Name: Ashgrove Road West
 Project No: NB 8883
 Client: McDonald's Restaurants Ltd
 Design No: 8268-SA-8883-004 F
 Date: 10.03.2022

Scale: 1:50

Scale in meters: 0 5 10 15 20