

note 4 lead flashing in rafter
 see spec. for roof const.
 - u.p.v.c. gutters, fascia & soffits
 upvc window
 line of ex. flat roof
 being removed

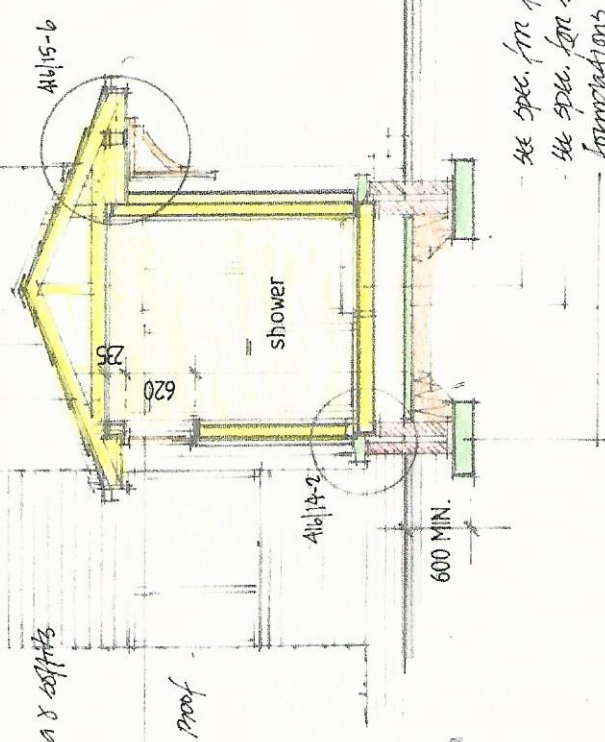

see spec. for floor const.
 see spec. for column treatment.
 foundations taken to level
 of existing formwork (600 mm min)

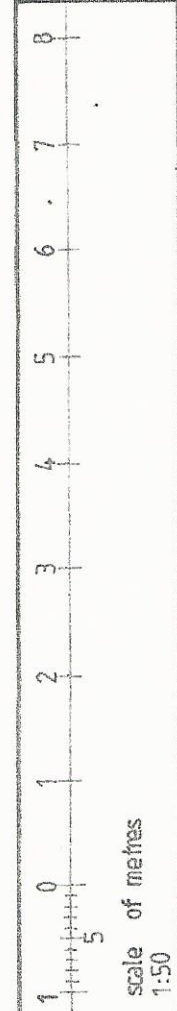

Project Proposed Alterations and New Extensions to Existing House at 8 Leighton Drive, Condurrat, G67 4EX, for Mr. & Mrs. Irvine Pringle		Drawing SECTIONS (as proposed)		Rev.
Date 04.22	Scale 1:50 @ A3	Job No. 416	Drawing No. 416/09	Rev.
Drawn By Dr				