

COPYRIGHT NOTICE:
 This drawing is the copyright of the Architects and may not be reproduced or used except by written permission.

© Crown copyright and database rights (2014) Ordnance Survey licence number 100047514

Notes:
 This drawing is to be used in conjunction with all relevant drawings and specifications. It is not valid from this drawing, the layout dimensions only. All levels and dimensions to be checked on site. All levels and dimensions are to be taken to the immediate attention of HSSP Architects Ltd. Responsibility cannot be accepted for alterations or variations from the design without prior agreement of HSSP Architects Ltd.
 Copyright reserved. This drawing may only be used for the client and location specified in the title block. It may not be copied or distributed to any other party without prior written consent from HSSP Architects Ltd.
 For any work commencing on site, the engineer is to be contacted regarding the current status, revision or regulatory approval of the drawings.
 All work is to be to the written satisfaction of the HMC or Local Authority with all relevant drawings shown or indicated on these drawings. All work must be completed to the level of the specification and level of detail required in the Building Regulations Code of Practice. All materials, methods and levels to be confirmed or checked and verified on the before specific areas of work are commenced.
 This drawing is to be used in conjunction with clients specifications, requirements and structural engineers design.

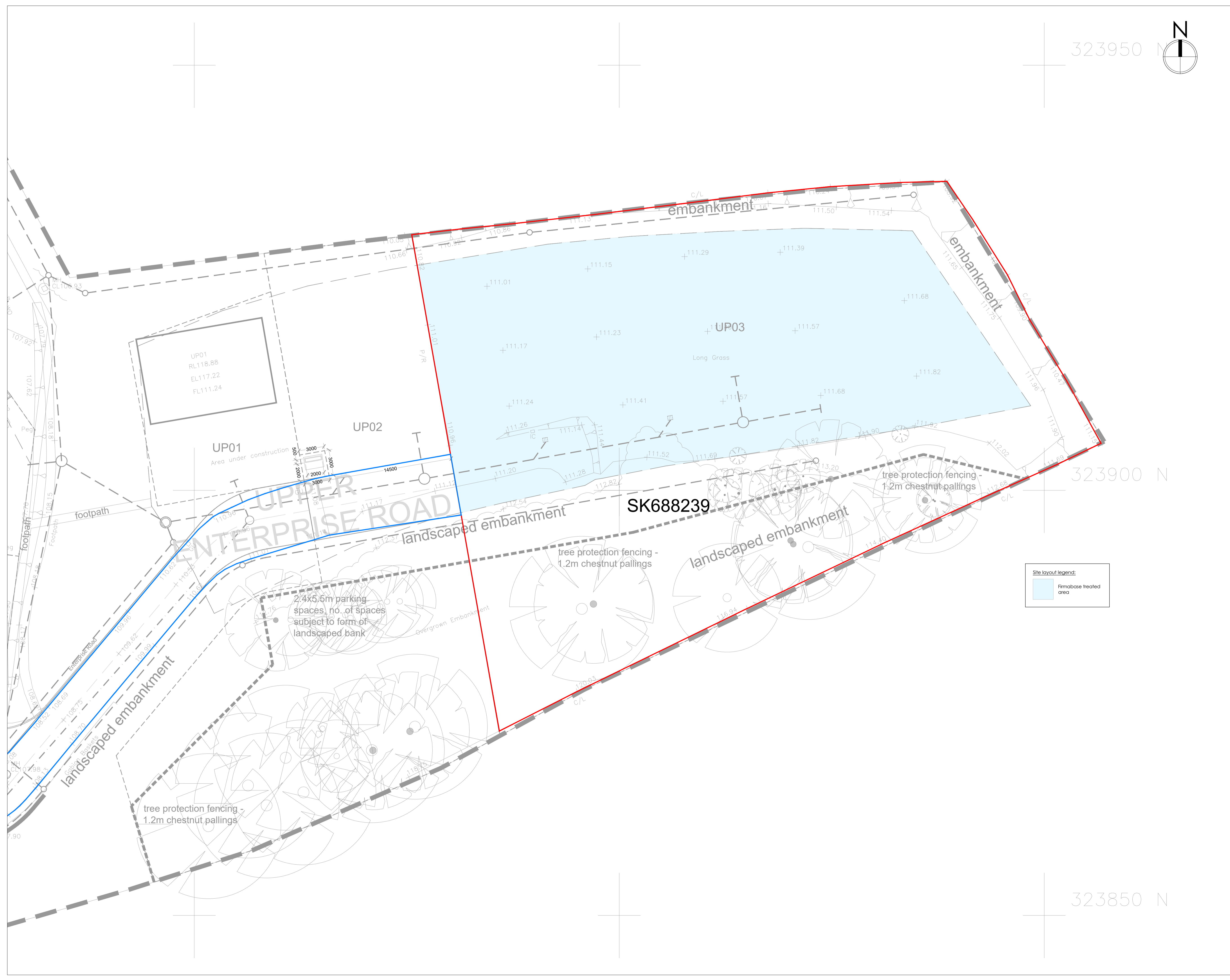

Revision Notes:
 Drawing Status:

PLANNING

hssp
 architects

Pera Business Park, Nottingham Road
 Melton Mowbray, LE13 0PB

Telephone: 01664 563 288 Fax: 01664 563 360
 E-Mail: info@hssparchitects.co.uk Web: www.hssparchitects.co.uk

Project:
 New Industrial Unit
 Dalby Land and Property
 Old Dalby Enterprise Village
 Leics

Title:
 Existing Site Plan

Scale: 1:200	Drawn: TDG	Checked: RJC	Date: Jan 2022
Drawing No: 8602-01-01	Revision:		

HSSP A1