

Revision Notes:

- A: Alterations to works in accordance with recommendations from Heritage Advisor. CAP 14.1.2022
- B: Client proposes raised access floor throughout and adjustment to door head heights as maybe required.
- C: Ais to doorways into new Therapy Rooms & Classroom 1 extending corridor, and adjust proposed partitions as Client's notes. CAP 2.3.2022

CAP 19.1.2022

CAP 2.3.2022

1. All dimensions must be checked on site by the contractor and NOT scaled from this drawing.
2. Site Boundary taken from Ordnance Survey information.
3. Prior to implementation the proposals shown should be assessed by a Structural Engineer, M & E Engineers and checked for compliance with latest Building Regulations.
4. For use in precise named location only.
5. Copyright reserved OC Projects Ltd.

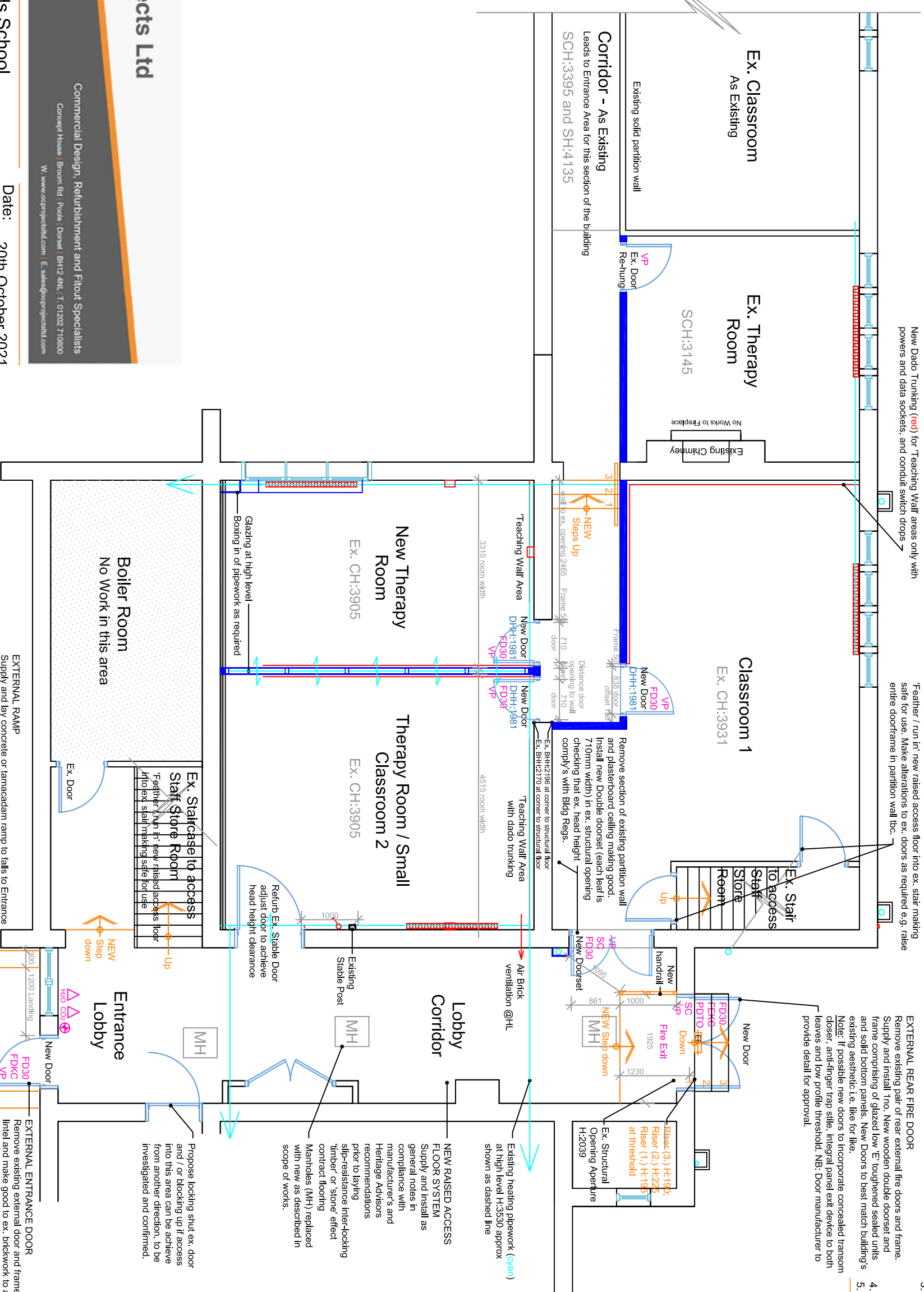

EXTERNAL REAR FIRE DOOR
Remove existing pair of rear external fire doors and frame. Supply and install 1no. New wooden double doorset and frame comprising of glazed low 'E' toughened sealed units and solid bottom panels. New Doors to best match building's existing aesthetic i.e. like for like.
Note: If possible new doors to incorporate concealed transom closer, anti-finger trap stile, integral panel exit device to both leaves and low profile threshold. NB: Door manufacturer to provide detail for approval.

Existing heating pipework (cyan) at high level H:3530 approx shown as dashed line

NEW RAISED ACCESS FLOOR SYSTEM
Supply and install as general notes in compliance with manufacturer's and Heritage Advisors recommendations prior to laying slip-resistance inter-locking 'timber' or 'stone' effect contract flooring
Manholes (MH) replaced with new as described in scope of works.

Propose locking shut ex. door and / or blocking up if access into this area can be achieved from another direction, to be investigated and confirmed.

EXTERNAL ENTRANCE DOOR
Remove existing external door and frame increase door head height, new lintel and make good to ex. brickwork to achieve required clearance. Supply and install 1no. New wooden doorset and frame comprising of glazed low 'E' toughened sealed units and solid bottom panels.
New Door to best match building's existing aesthetic i.e. like for like.
Note: If possible new doors to incorporate concealed transom closer, anti-finger trap stile, integral panel exit device to both leaves and low profile threshold. NB: Door manufacturer to provide detail for approval.



Client: St Edwards School	Date: 20th October 2021
Project: Stables Fit-out & Refurbishment Melchet Court, Sherfield English, Romsey SO51 6ZR	Scale: 1:75 Sheet Size: A3
Drawing: Proposed Plan: General Arrangement	Drawn By: CAP Checked By: NS
Drawing No: 2021.22-GF-103C	Rev: 2nd March 2022

Proposed Plan: General Arrangement