

Notes:  
 - Do not scale from this drawing  
 - All dimensions are to be checked on site prior to construction  
 - Dimensions marked with an asterisk thus \* are open site dimensions to be confirmed on site  
 - Should any discrepancy be found with this drawing please report to this office immediately.  
 - This plan and its content is copyright of Smith&Garratt  
 - © Smith&Garratt 2021. All rights reserved.  
 - Any redistribution or reproduction of part or all of the contents in any form is prohibited.

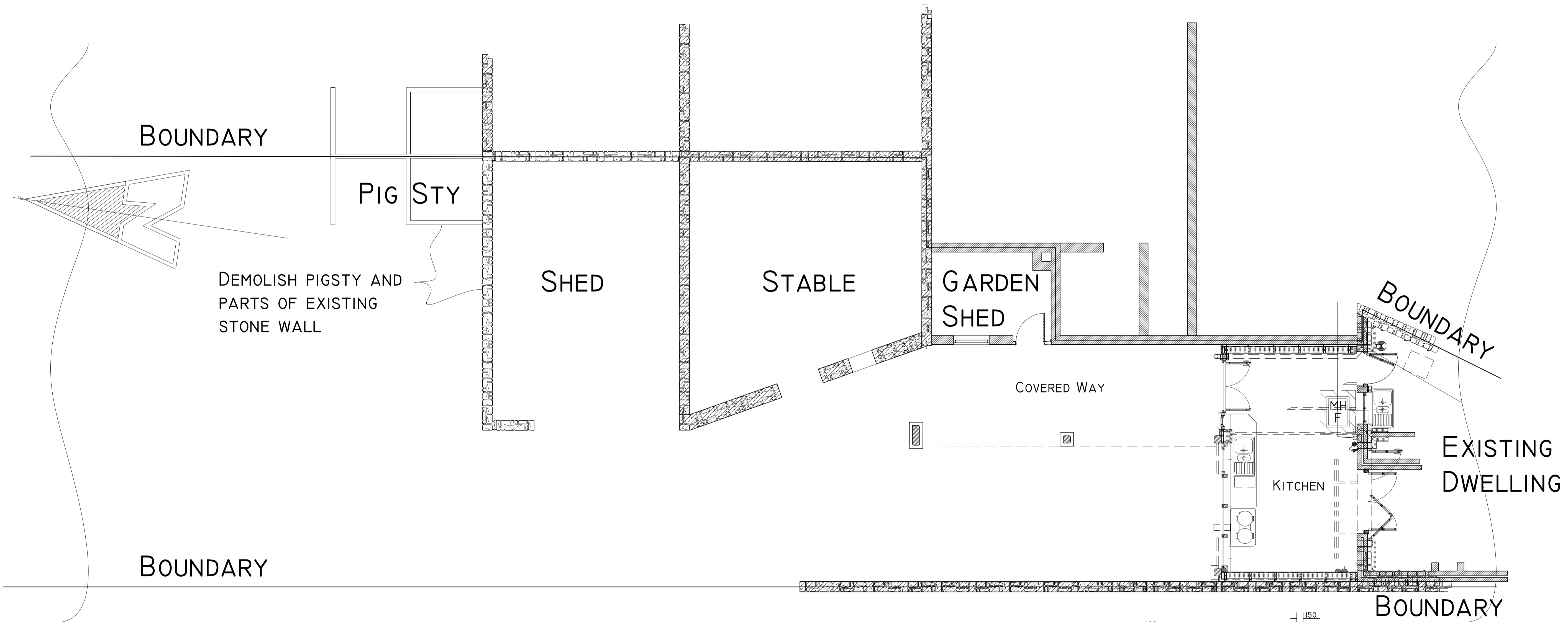

PLAN AS EXISTING

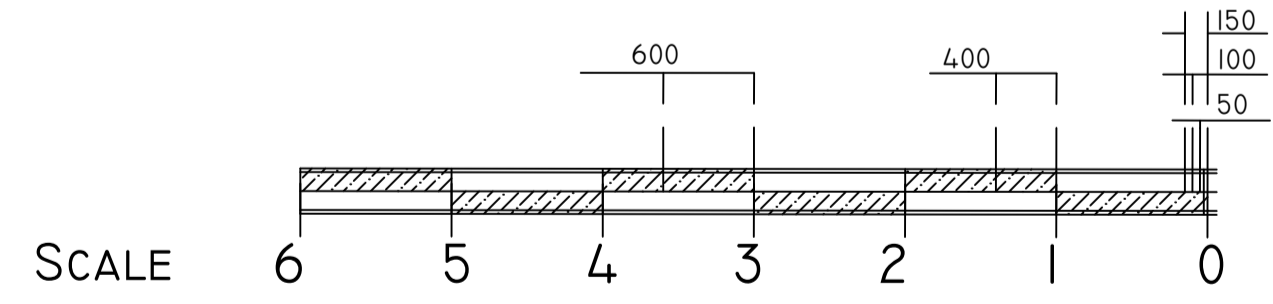

Rev | Date | Note | by | Ckx

Status

PLANNING

Project

Improvements to the Rear of No.1 Castle Street

Client

Watkinson

Drawing

Existing Ground Floor Plan

**SMITH & GARRATT**  
 HERITAGE · RURAL · PRIVATE CLIENT  
 The Guildhall, Ladykirk,  
 Berwick-upon-Tweed, TD15 1XL  
 Tel: 01289 382 209

Drawn by  
 Rachel Reeves

Scale  
 1:50 @A1

Date  
 09 May 2022

Drawing Number  
 WAT03.1

Rev  
 B