

SCALE: 1:200

PROPOSED GARAGE WALL 235MM THICK.

PROPOSED GARAGE WITH PLASTIC SHEET ROOF WALLS RENDERED TO MATCH EXISTING NEW BUILDINGS. FRONT WALL IN 1:1 BACK TO MATCH OLD BUILDINGS.

GARAGE FLOOR 300MM CONCRETE (REINFORCED WITH 10MM REBAR). GARAGE SIDE WALL CONSTRUCTION 7M CONCRETE BLOCK TWIN WALL.

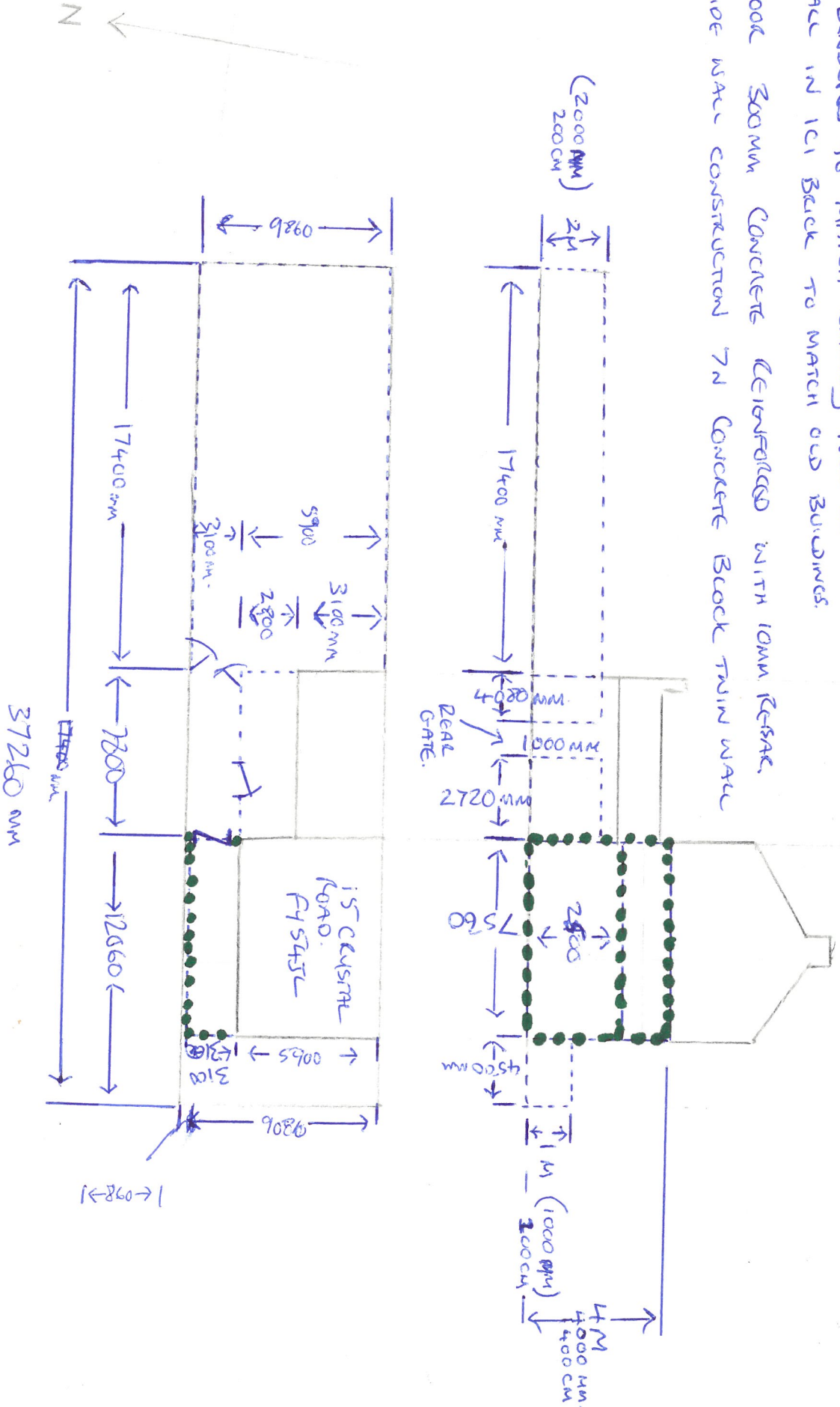

15- CRYSTAL ROAD
THORNTON
F45454

SCALE 1:200

