

Front
Side
 ALL WINDOWS AND DOORS TO BE CASEMENT PVCU DOUBLE GLAZED - COLOUR WHITE

Back
Side

Proposed Indicative Elevations - (scale 1:100)

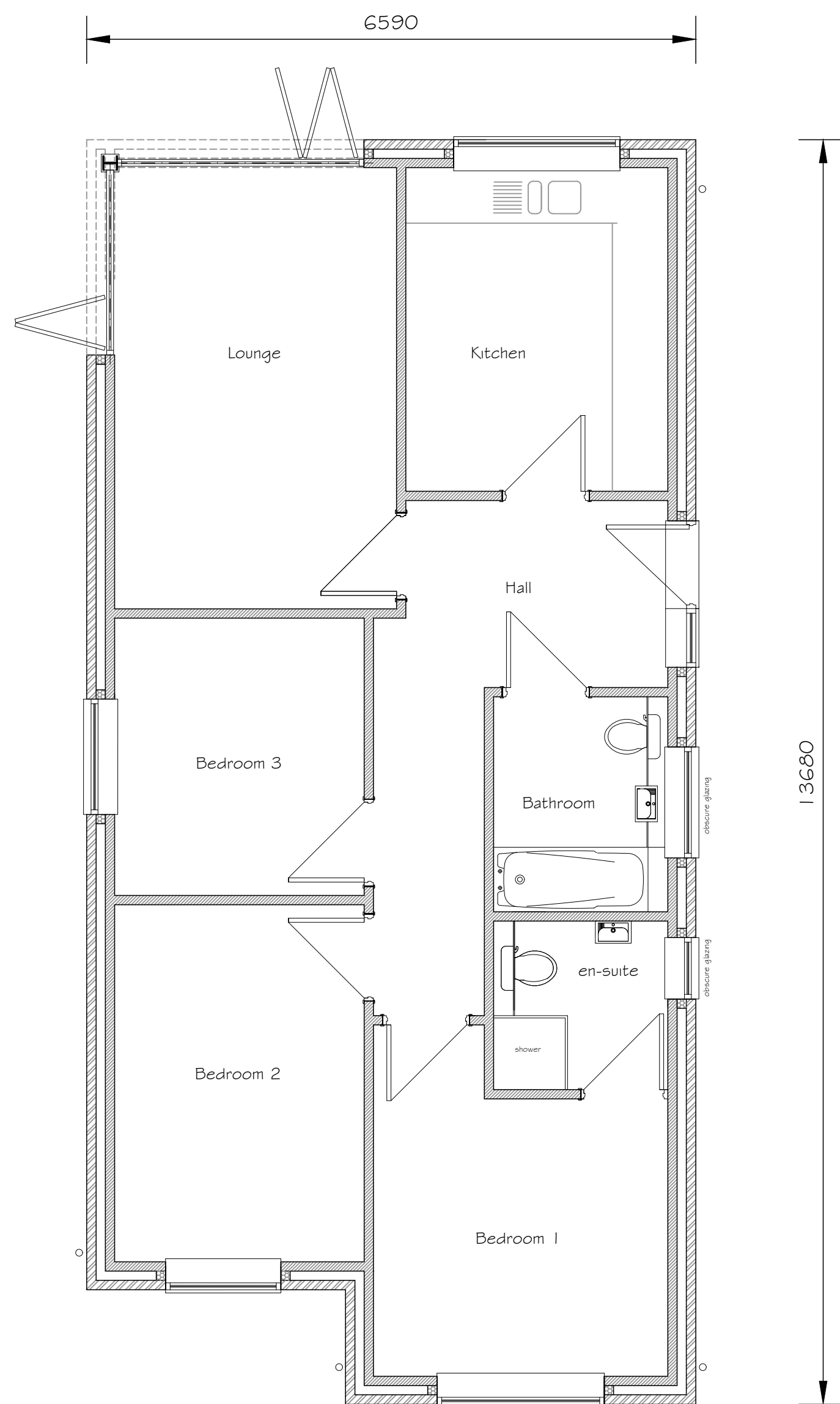

Proposed Indicative Floor Plan (scale 1:50)

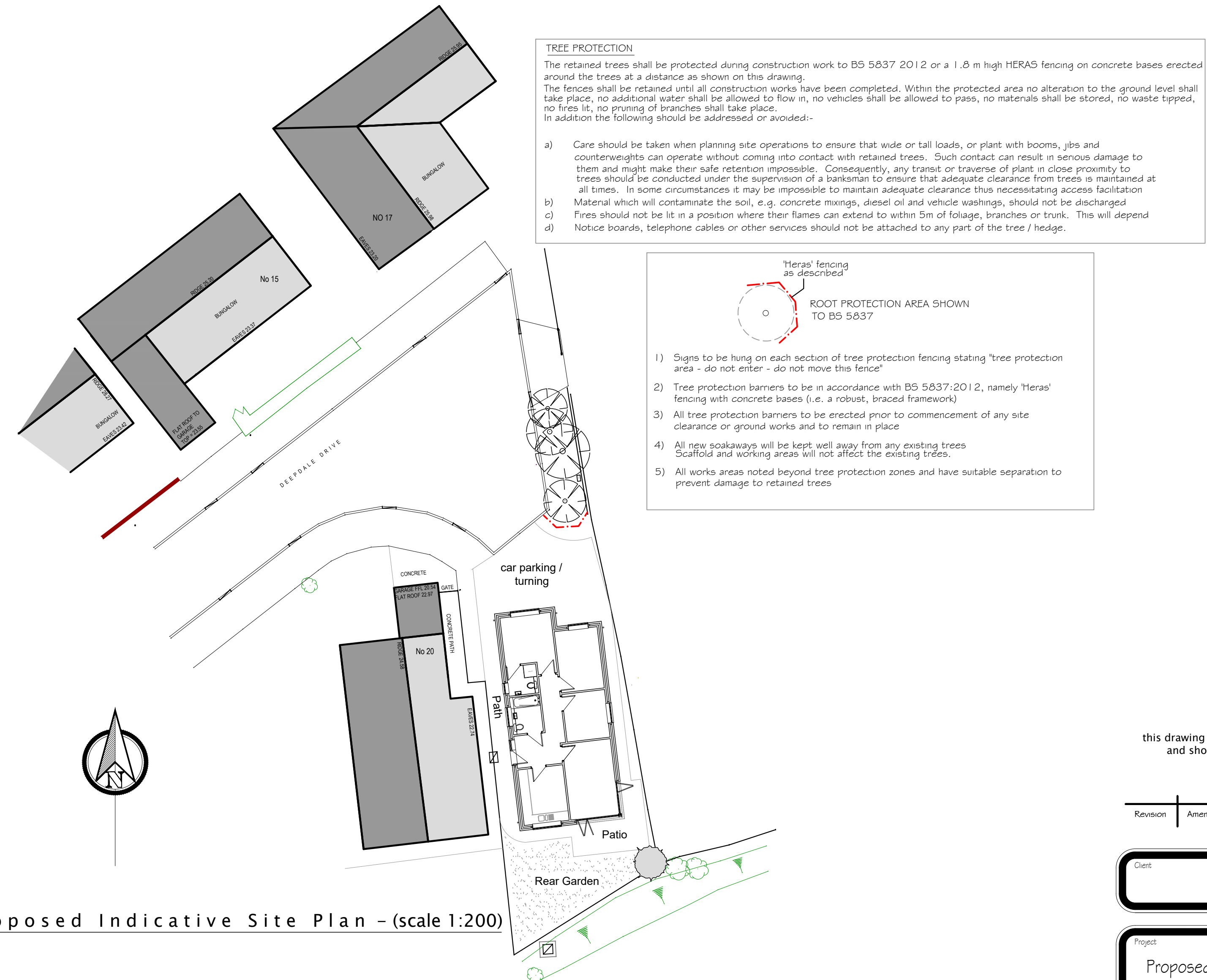

Proposed Indicative Site Plan - (scale 1:200)



Proposed Visuals (n.t.s)

TREE PROTECTION
 The retained trees shall be protected during construction work to BS 5837 2012 or a 1.8 m high HERAS fencing on concrete bases erected around the trees at a distance as shown on this drawing.
 The fences shall be retained until all construction works have been completed. Within the protected area no alteration to the ground level shall take place, no additional water shall be allowed to flow in, no vehicles shall be allowed to pass, no materials shall be stored, no waste tipped, no fires lit, no pruning of branches shall take place.
 In addition the following should be addressed or avoided:-

- Care should be taken when planning site operations to ensure that wide or tall loads, or plant with booms, jibs and counterweights can operate without coming into contact with retained trees. Such contact can result in serious damage to them and might make their safe retention impossible. Consequently, any transit or traverse of plant in close proximity to trees should be conducted under the supervision of a bankman to ensure that adequate clearance from trees is maintained at all times. In some circumstances it may be impossible to maintain adequate clearance thus necessitating access facilitation
- Material which will contaminate the soil, e.g. concrete mixings, diesel oil and vehicle washings, should not be discharged
- Fires should not be lit in a position where their flames can extend to within 5m of foliage, branches or trunk. This will depend
- Notice boards, telephone cables or other services should not be attached to any part of the tree / hedge.

- 'Herax' fencing as described**
ROOT PROTECTION AREA SHOWN TO BS 5837
- Signs to be hung on each section of tree protection fencing stating "tree protection area - do not enter - do not move this fence"
 - Tree protection barriers to be in accordance with BS 5837:2012, namely 'Herax' fencing with concrete bases (i.e. a robust, braced framework)
 - All tree protection barriers to be erected prior to commencement of any site clearance or ground works and to remain in place
 - All new soakaways will be kept well away from any existing trees. Scaffold and working areas will not affect the existing trees.
 - All works areas noted beyond tree protection zones and have suitable separation to prevent damage to retained trees

this drawing is for outline planning purposes and should only be used as a guide

Revision	Amendment	Date

Client:

Project: **Proposed Erection of Bungalow Land to East of No. 20 Deepdale Drive Leasingham Lincolnshire**

Dwg Title: **Proposed Details**

Dwg No. **222902-02** Scale: 1:50, 1:100, 1:200 Date: **04/22**

Rick Smith Design
 Architectural Design Consultancy
 Ardent House, 18 Eastgate
 Sleaford, Lincolnshire NG34 7DP
 Tel: 01529 414363 or 07786 838788
 e-mail: rick@ricksmithdesign.com