

Left Turn - Road 1 to Road 3

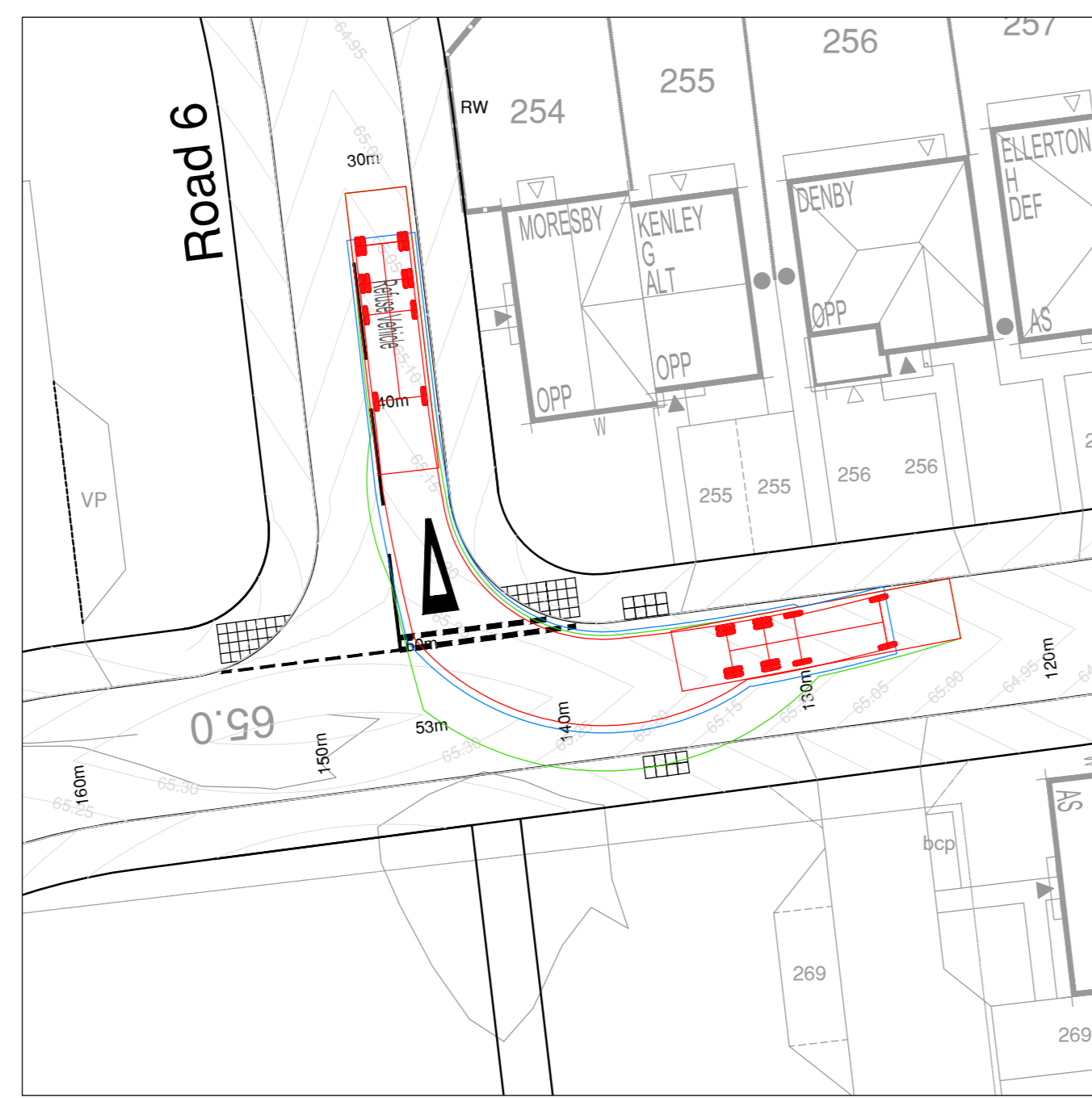

Left Turn - Road 6 to Road 7

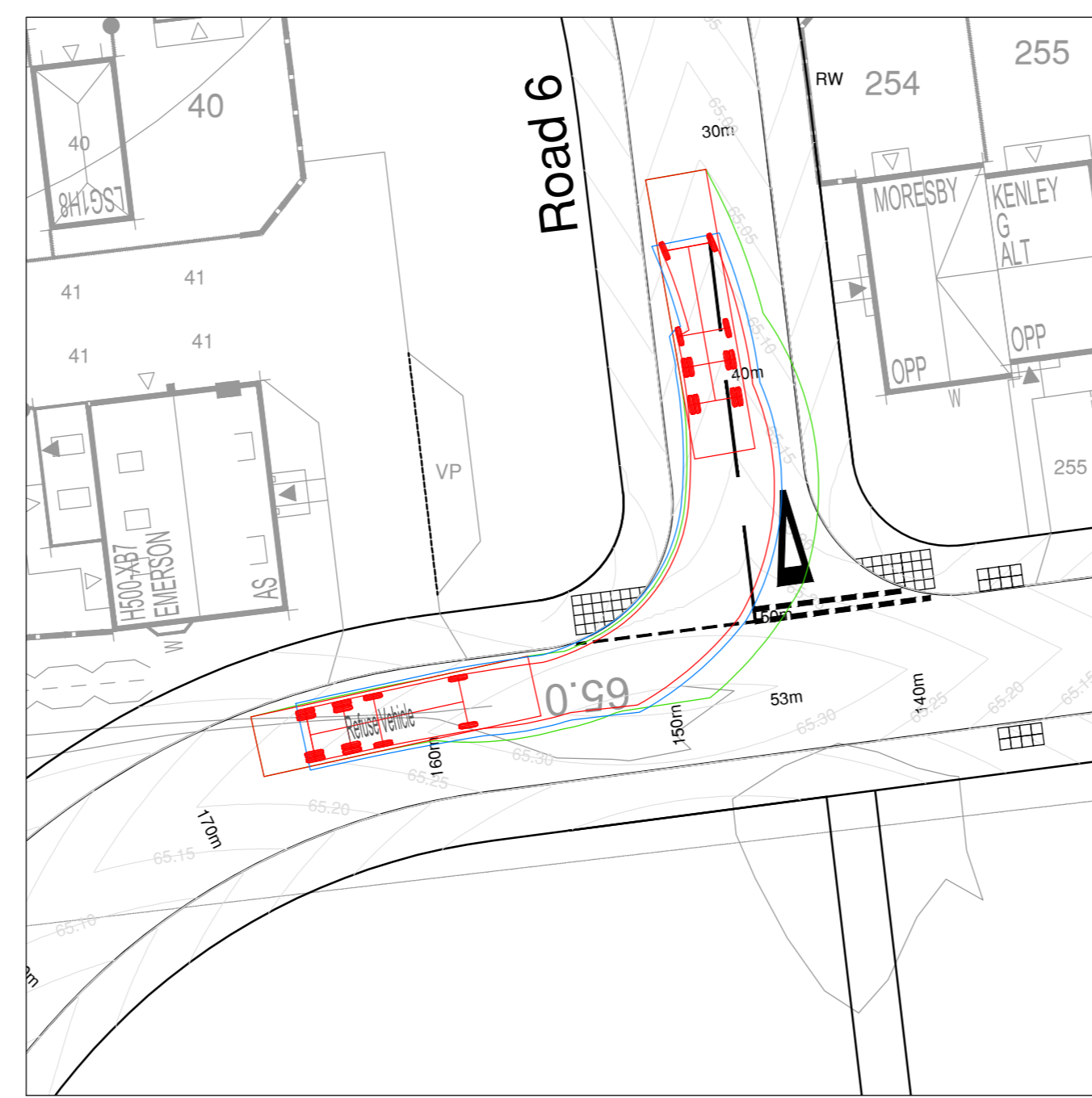

Left Turn - Road 7 to Road 6

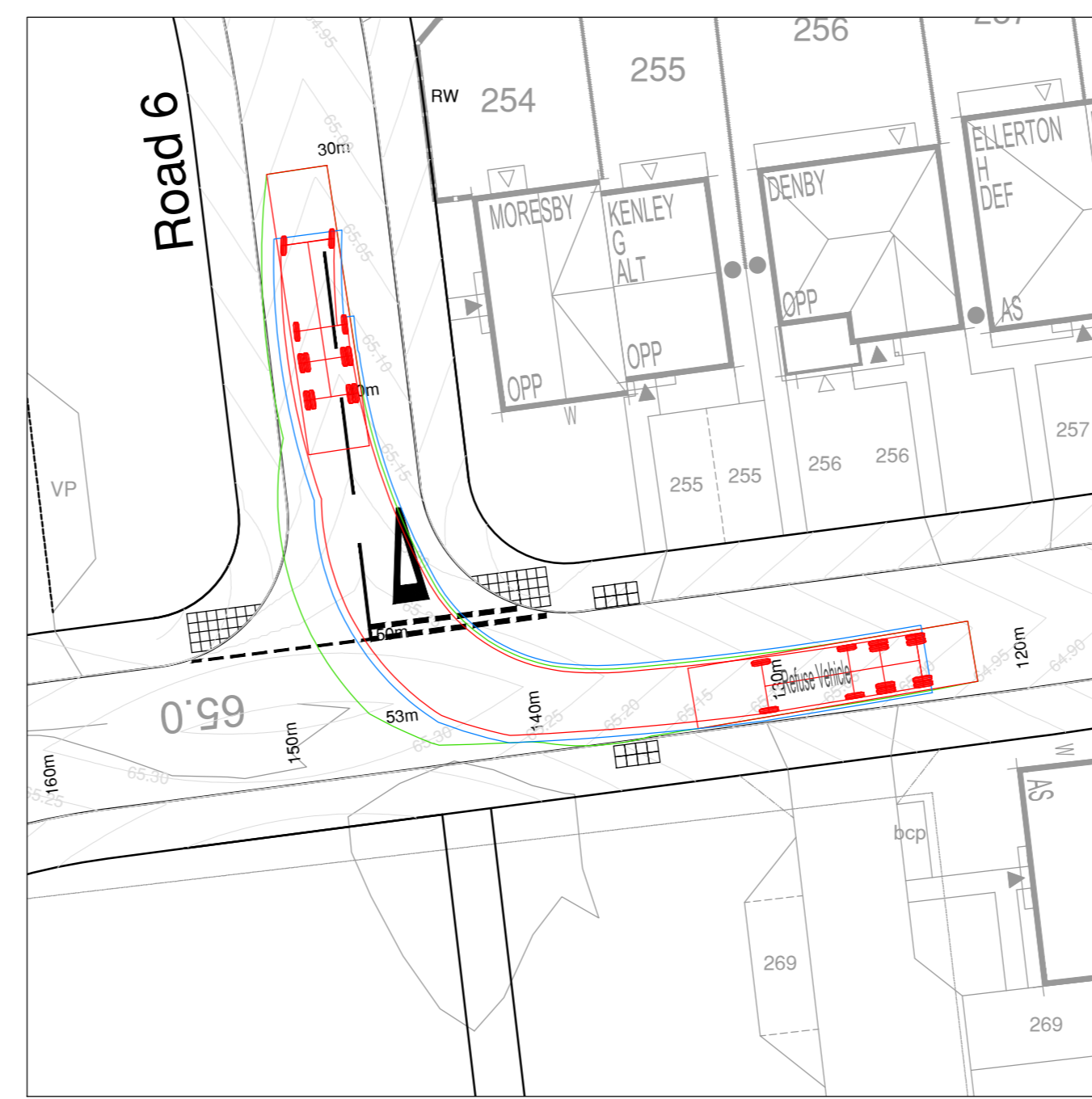

Right Turn - Road 2 to Road 1

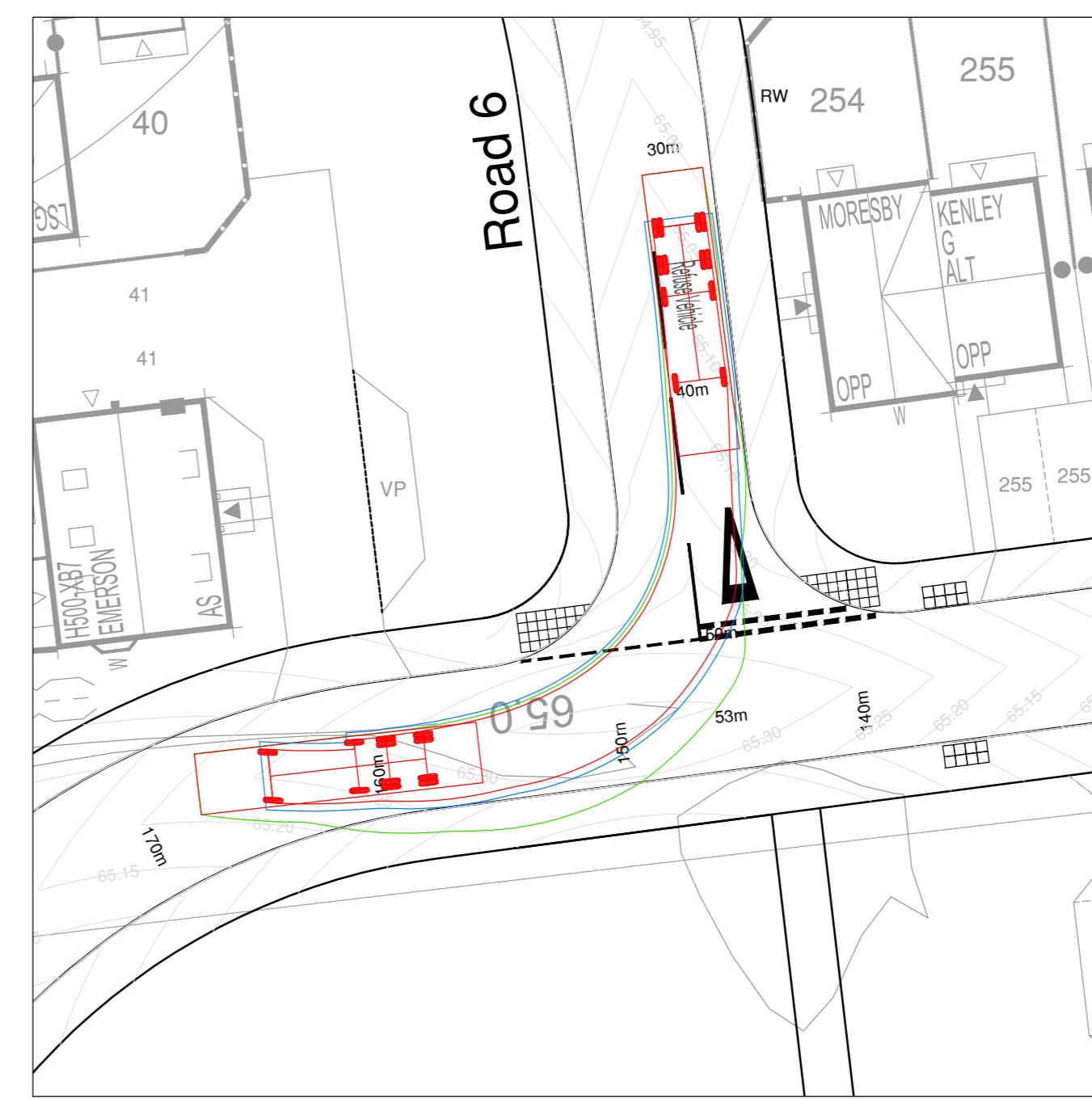

Right Turn - Road 6 to Road 7

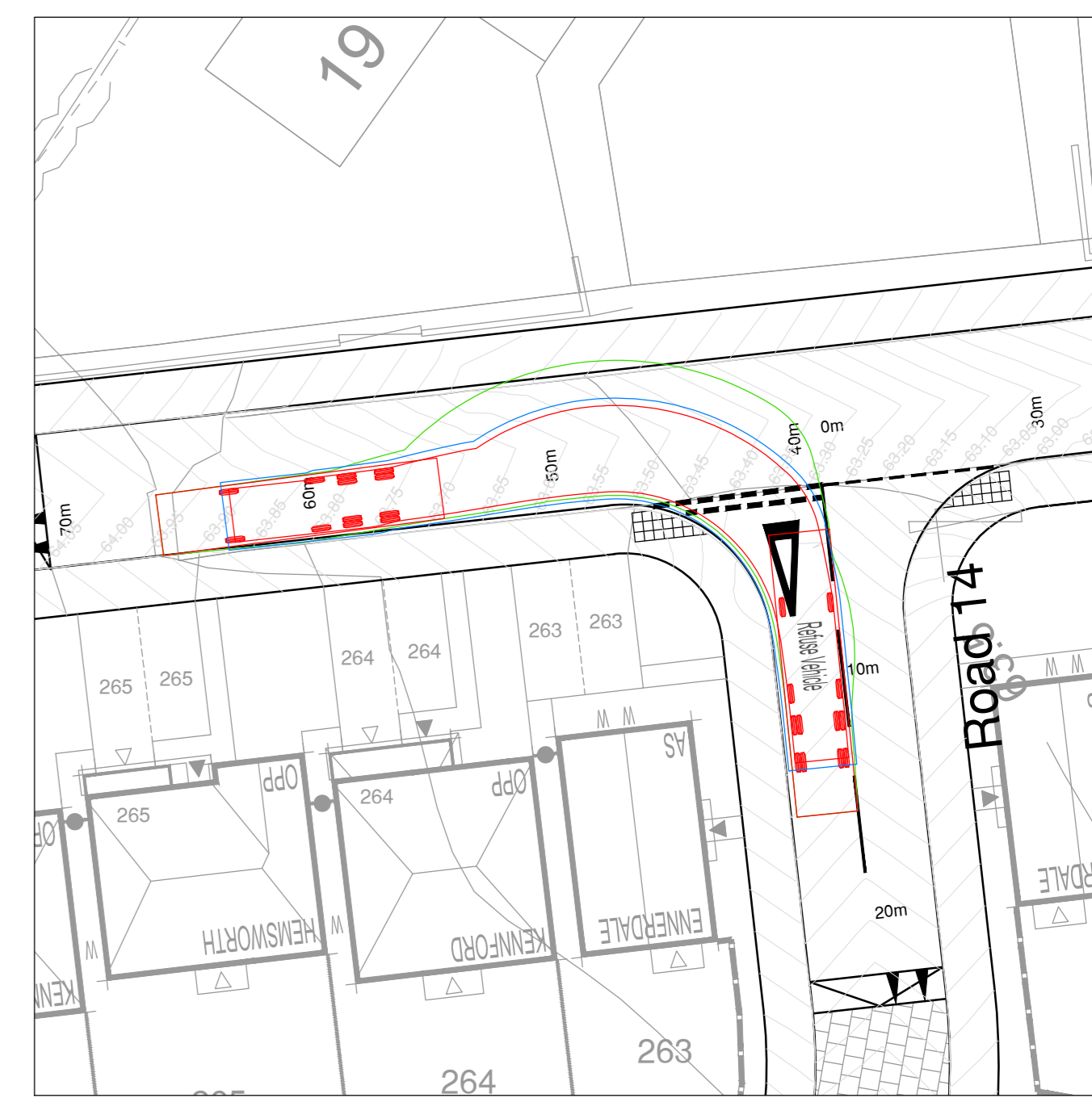

Left Turn - Road 14 to Road 7

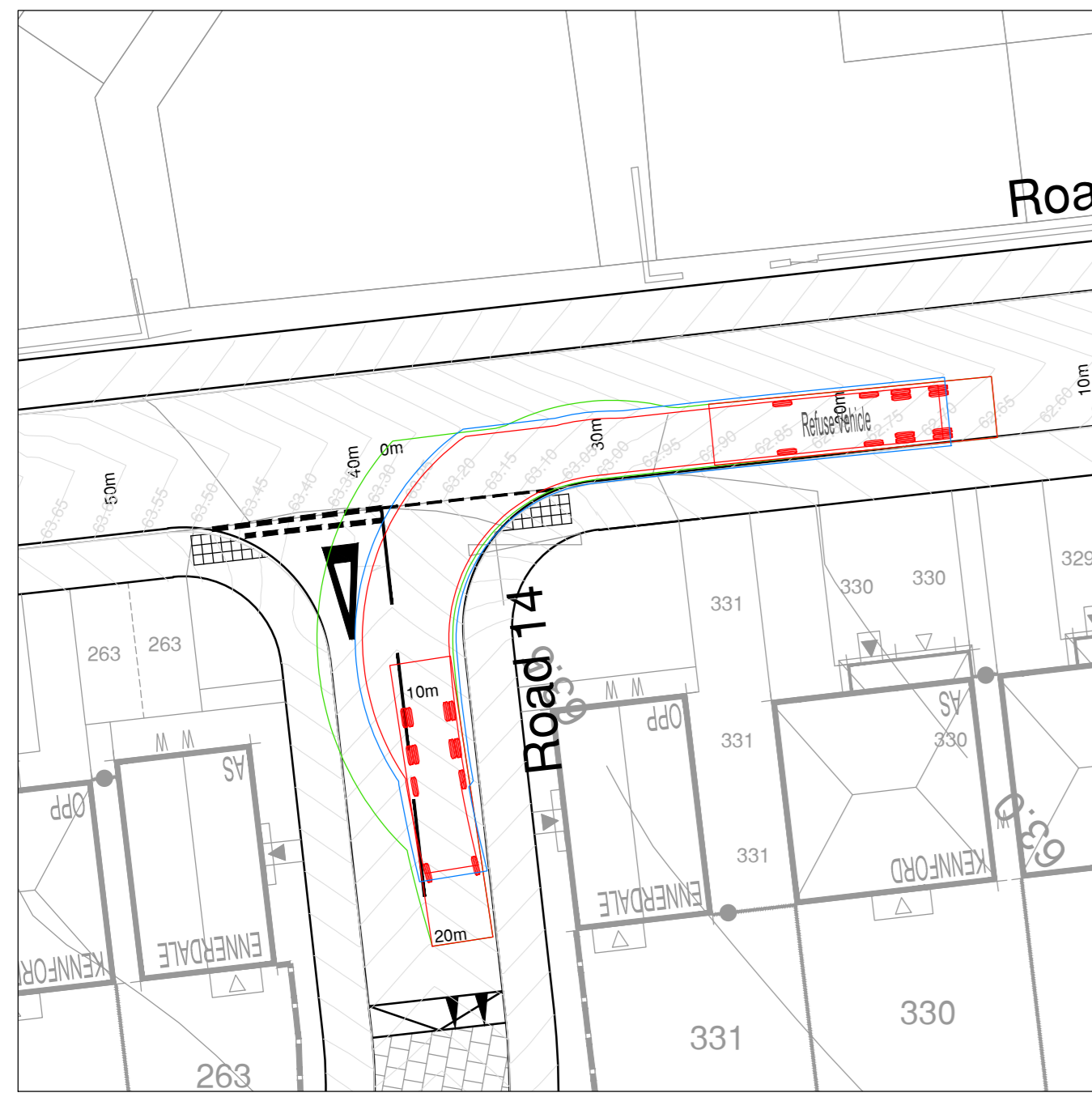

Left Turn - Road 7 to Road 14

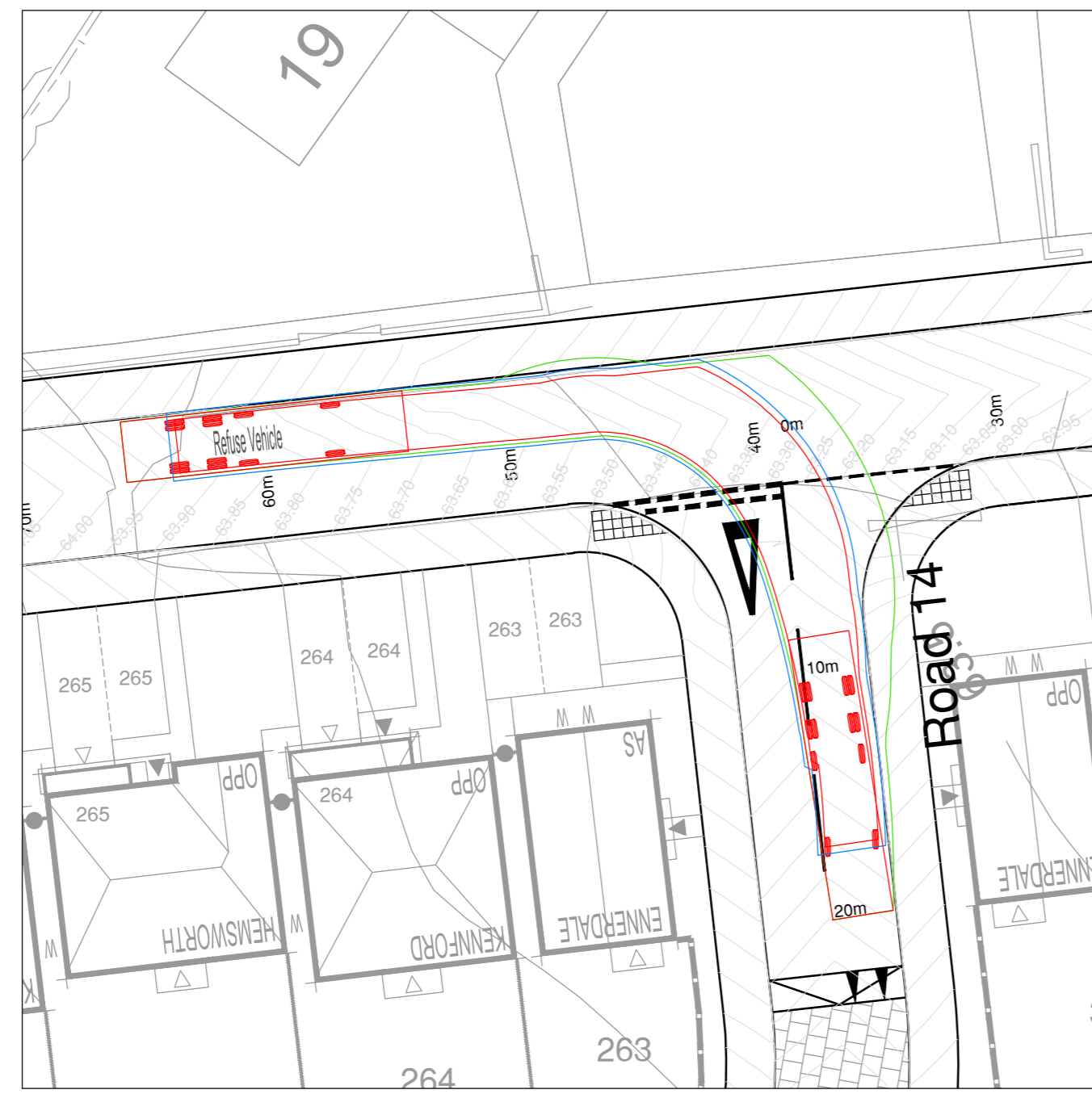

Right Turn - Road 7 to Road 14

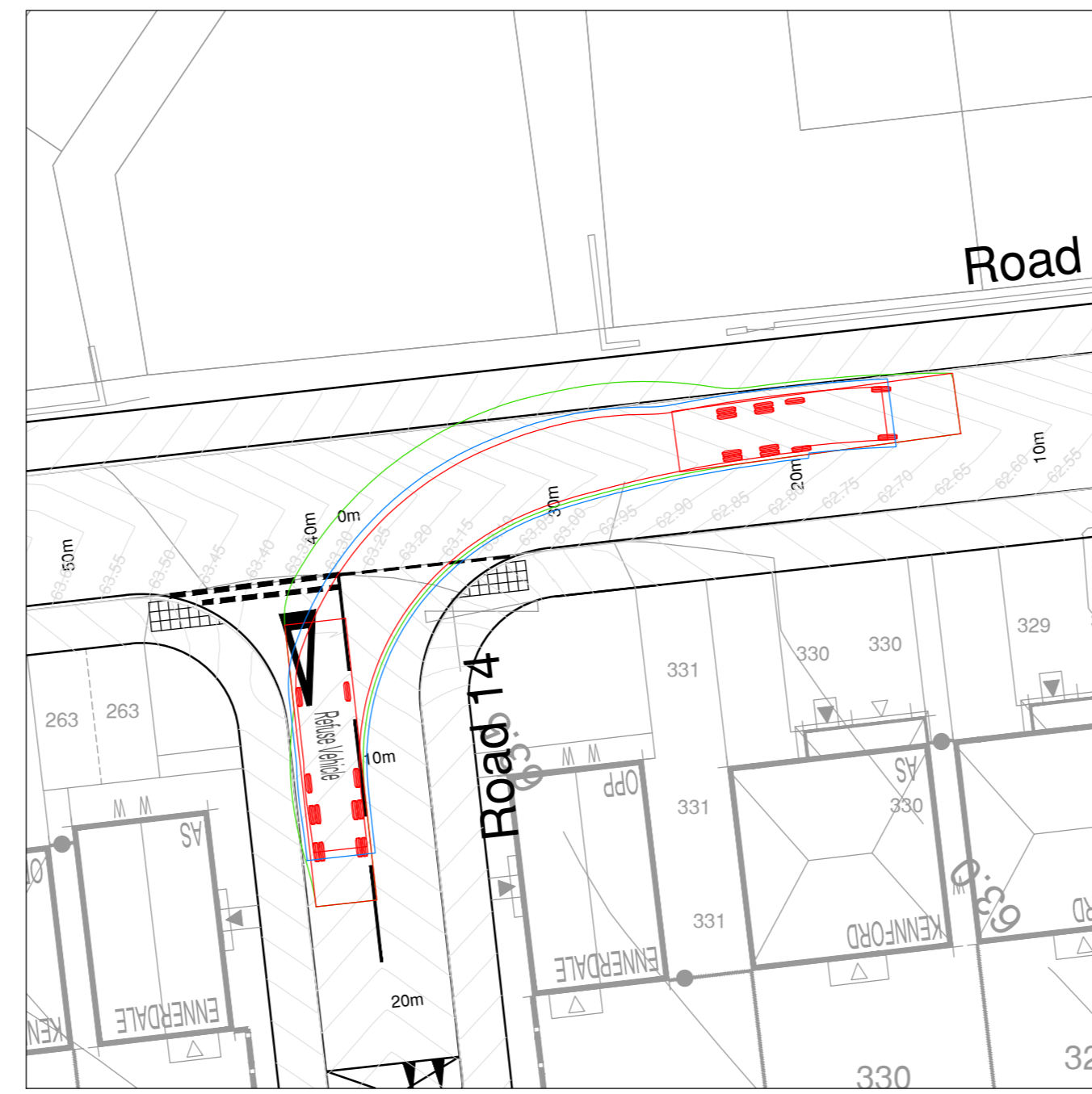

Right Turn - Road 14 to Road 7

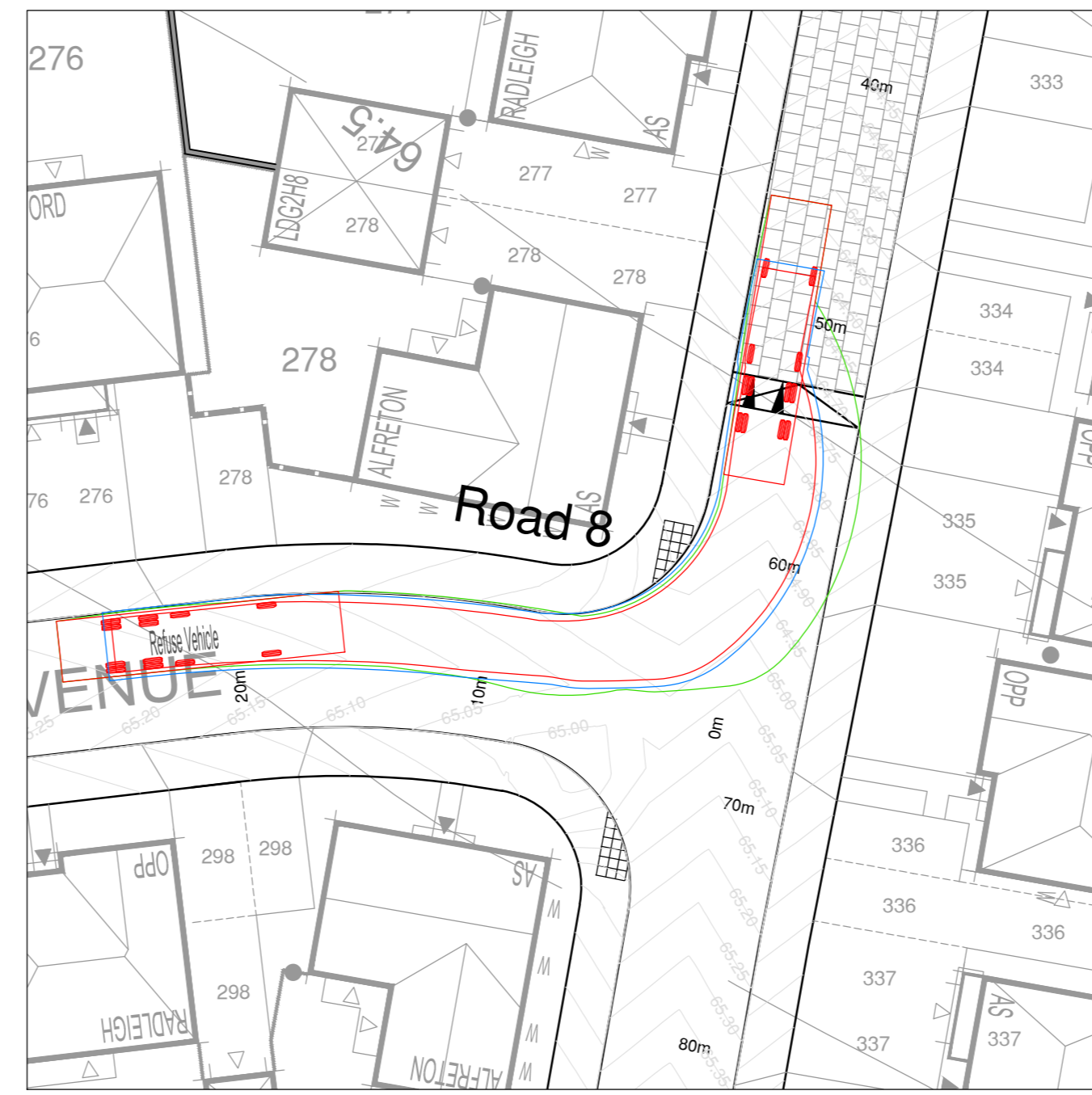

Left Turn - Road 6 to Road 14

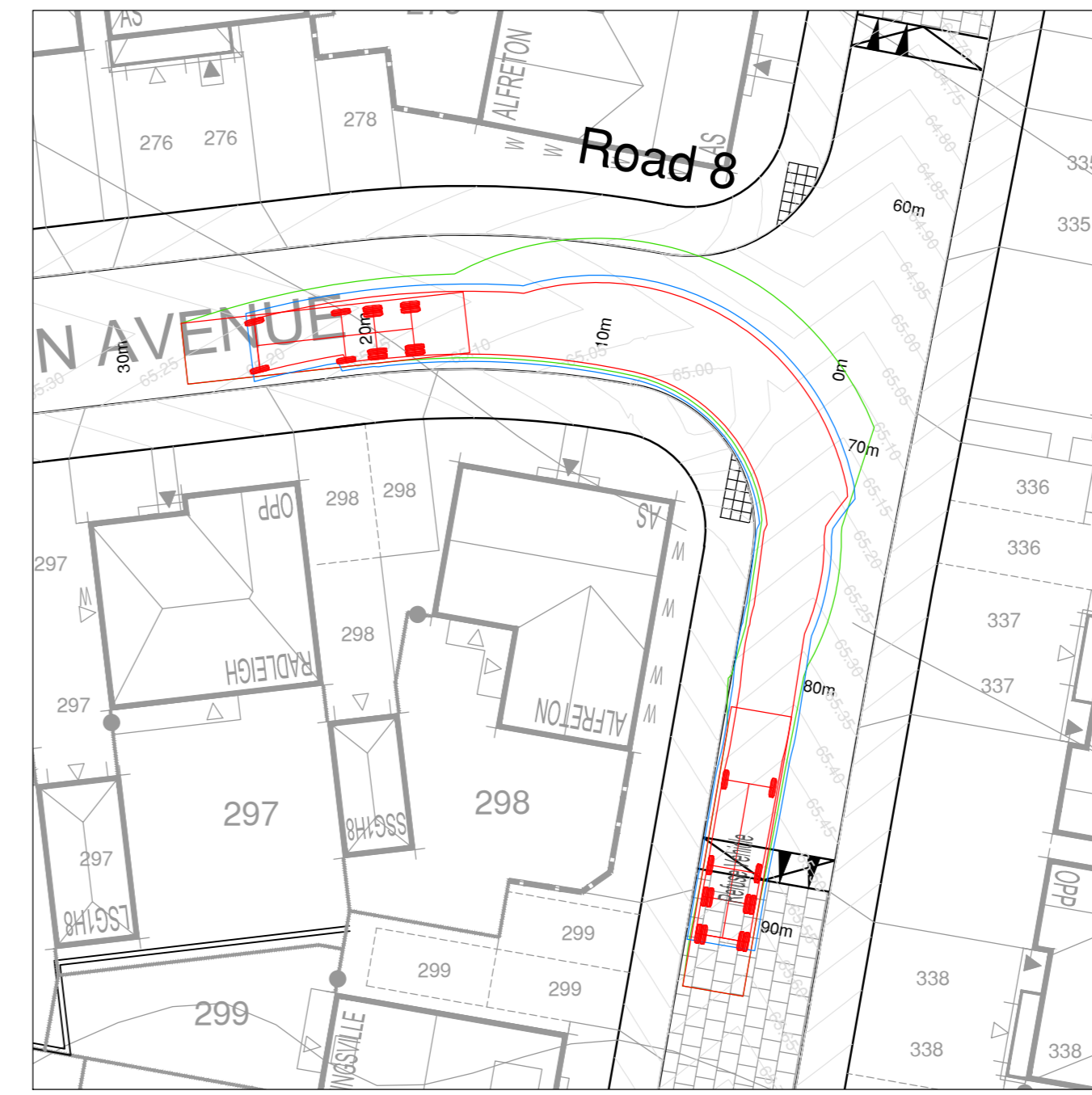

Left Turn - Road 14 to Road 6

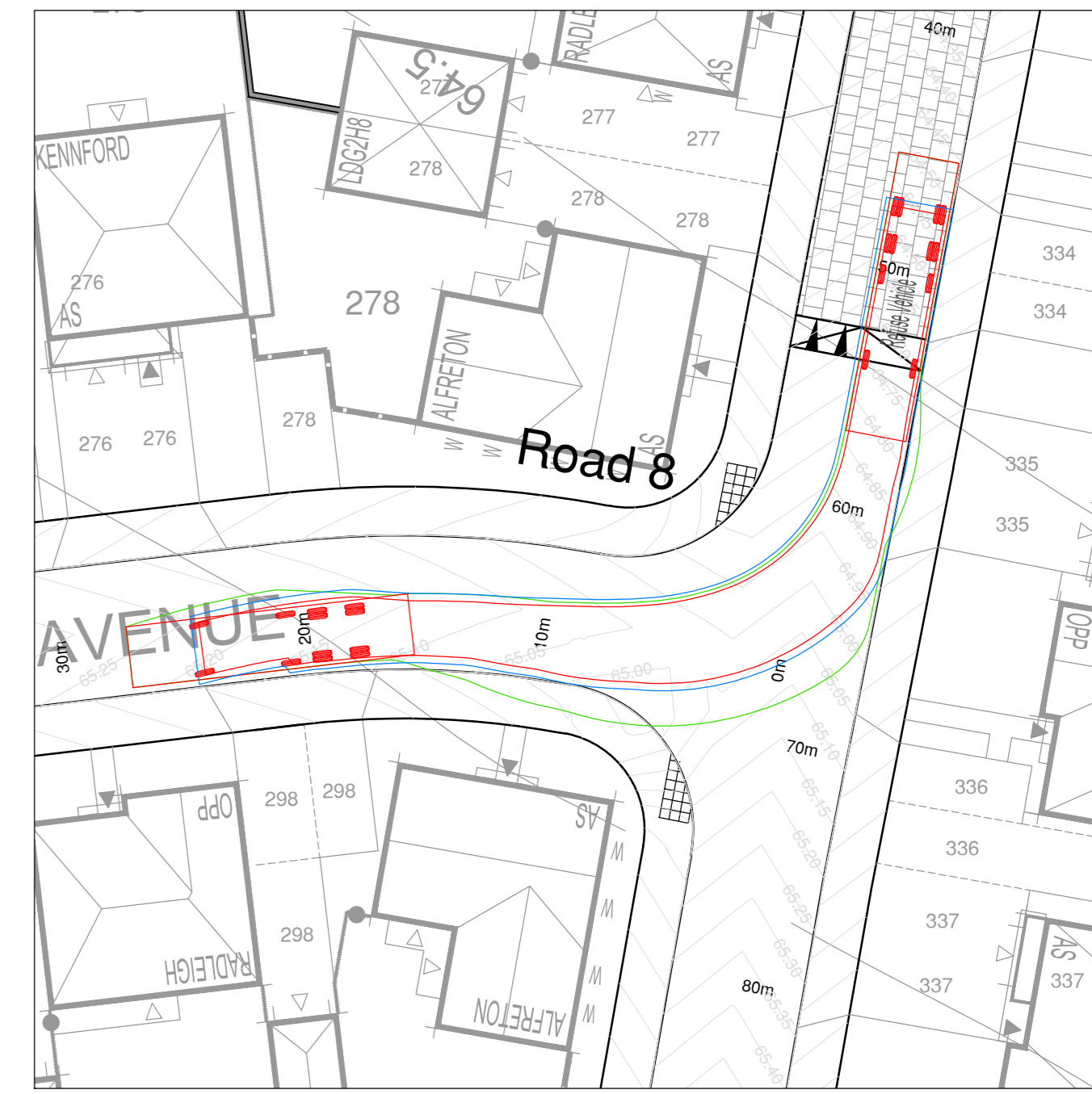

Right Turn - Road 14 to Road 6

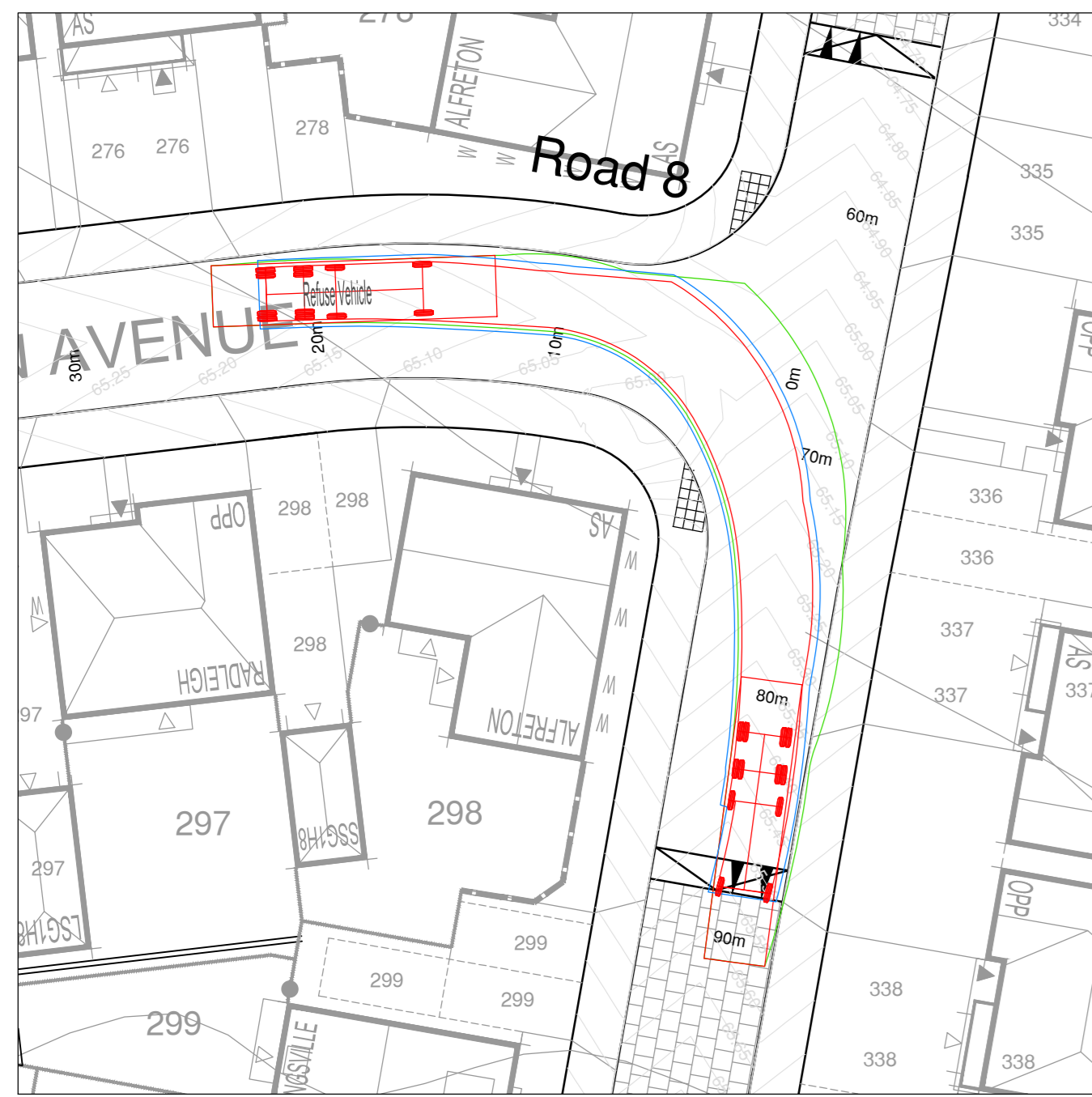

Right Turn - Road 6 to Road 14

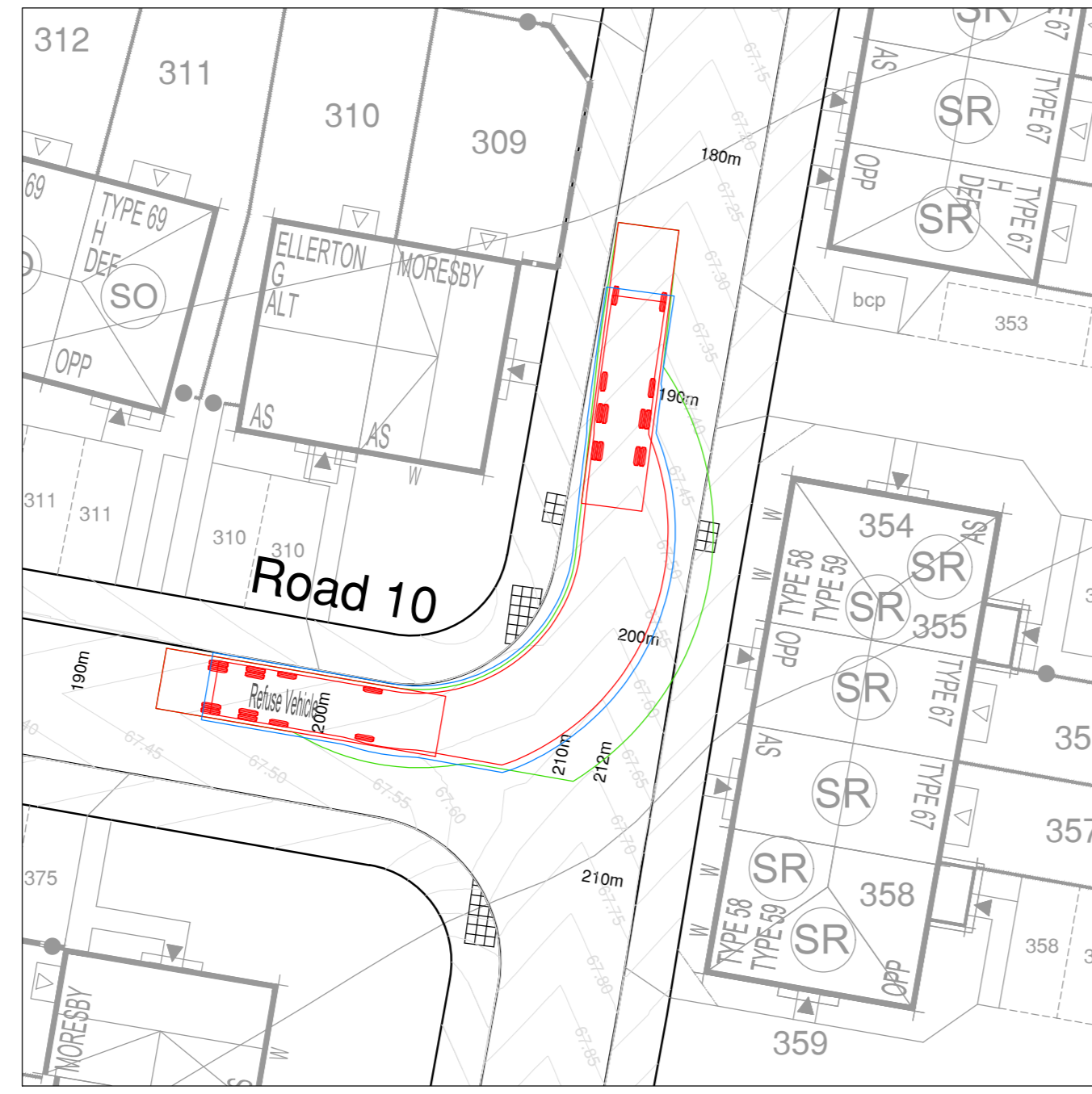

Left Turn - Road 10 to Road 14

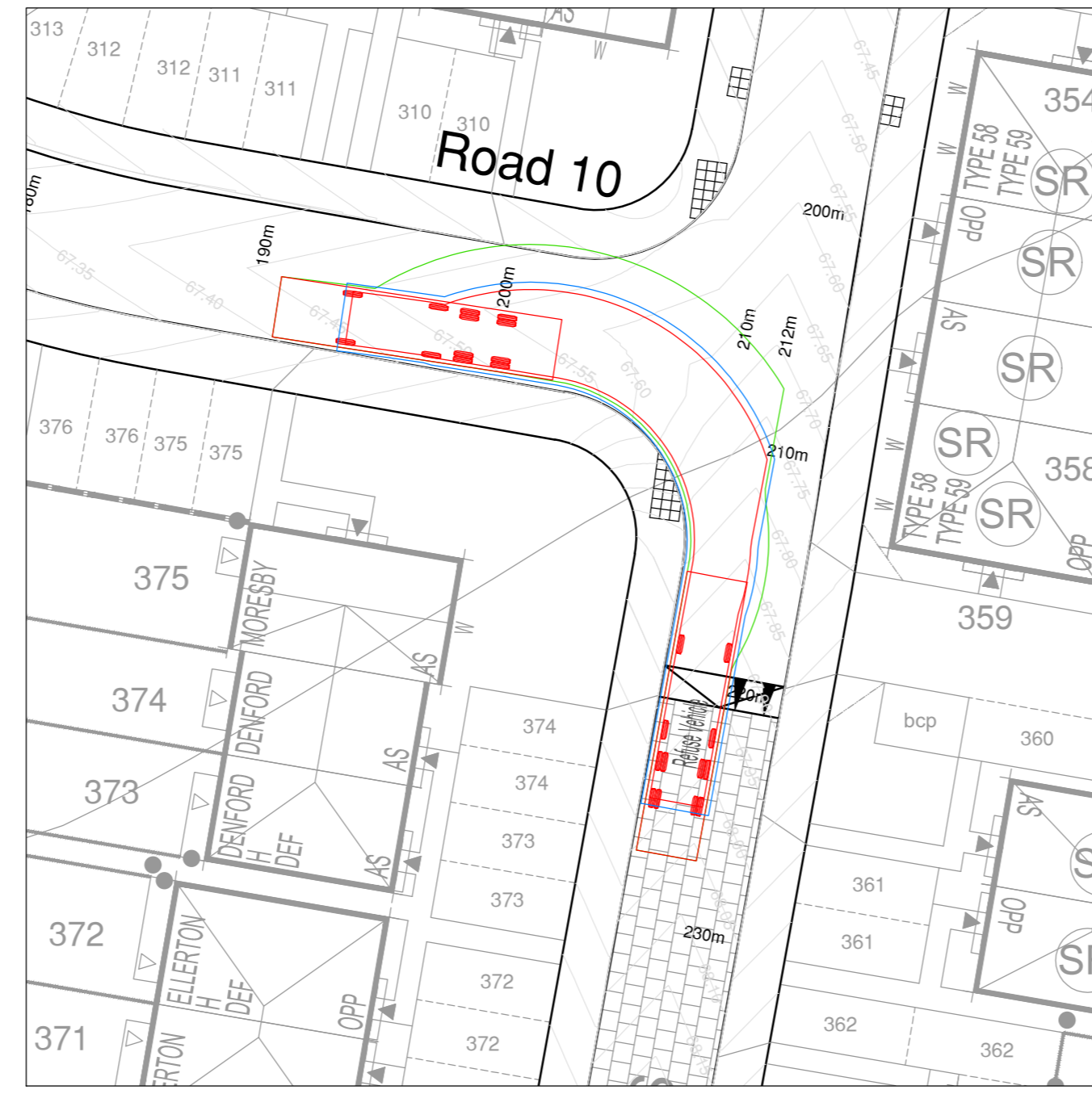

Left Turn - Road 14 to Road 10

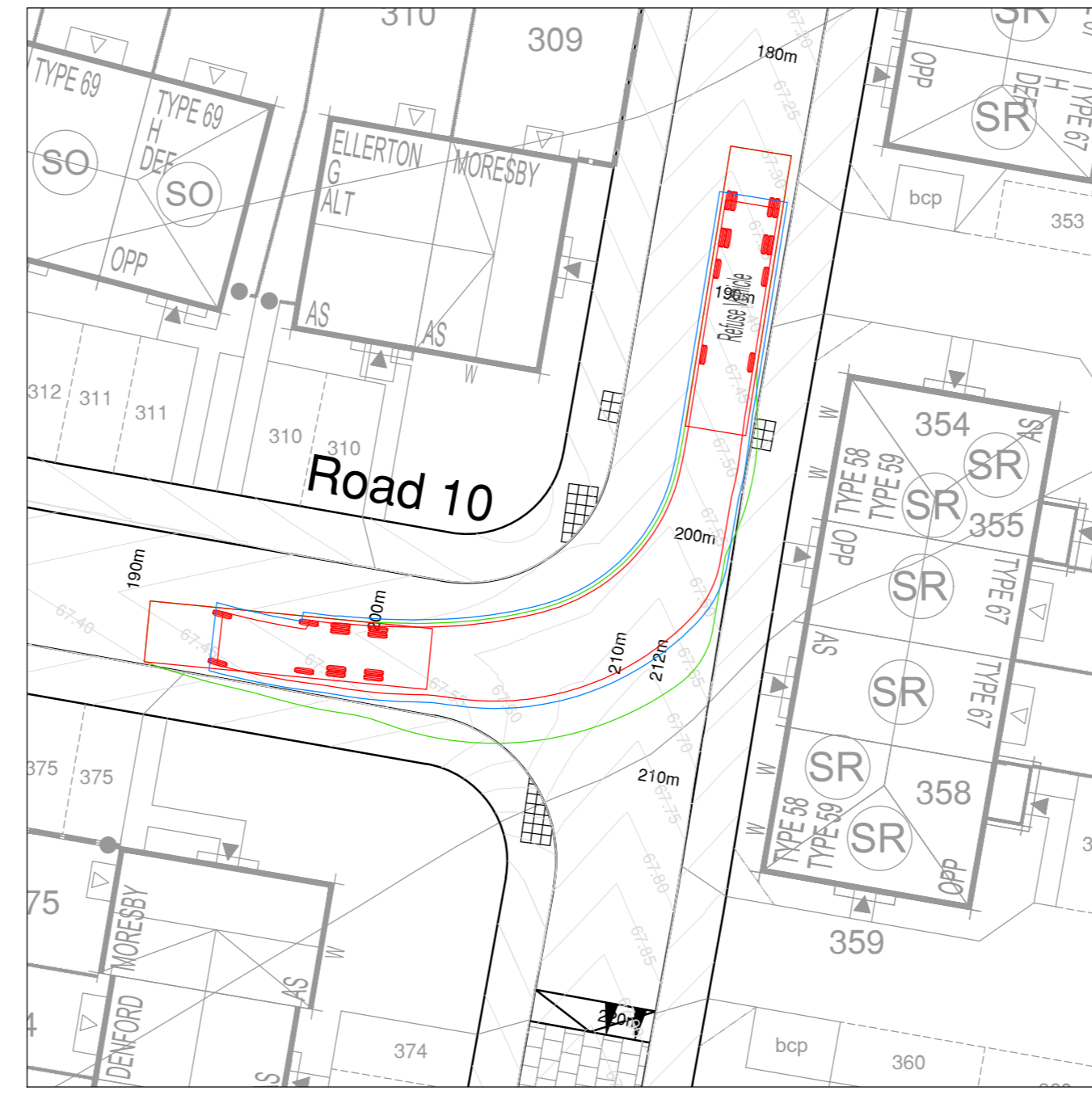

Right Turn - Road 14 to Road 10

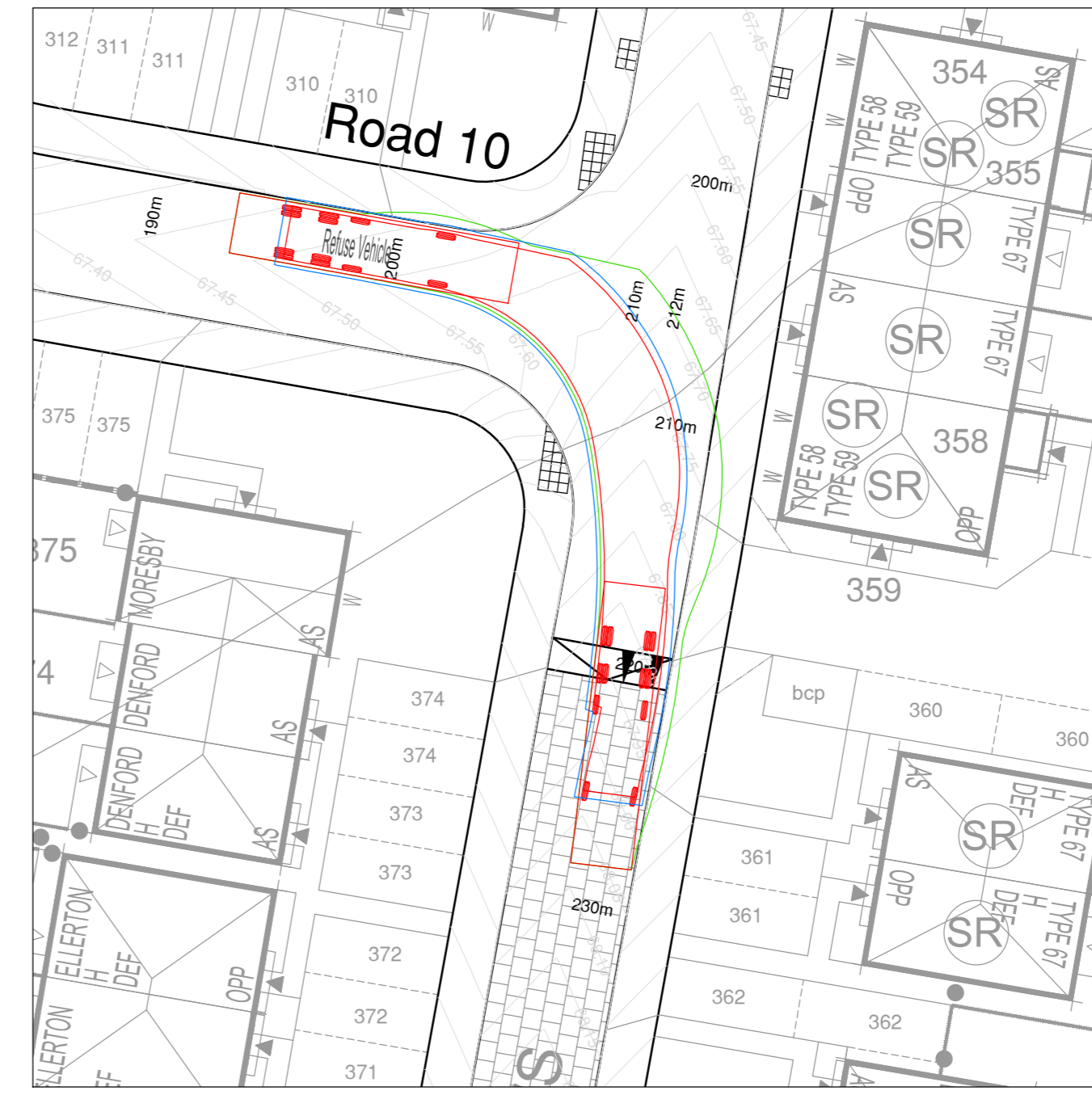

Right Turn - Road 10 to Road 14

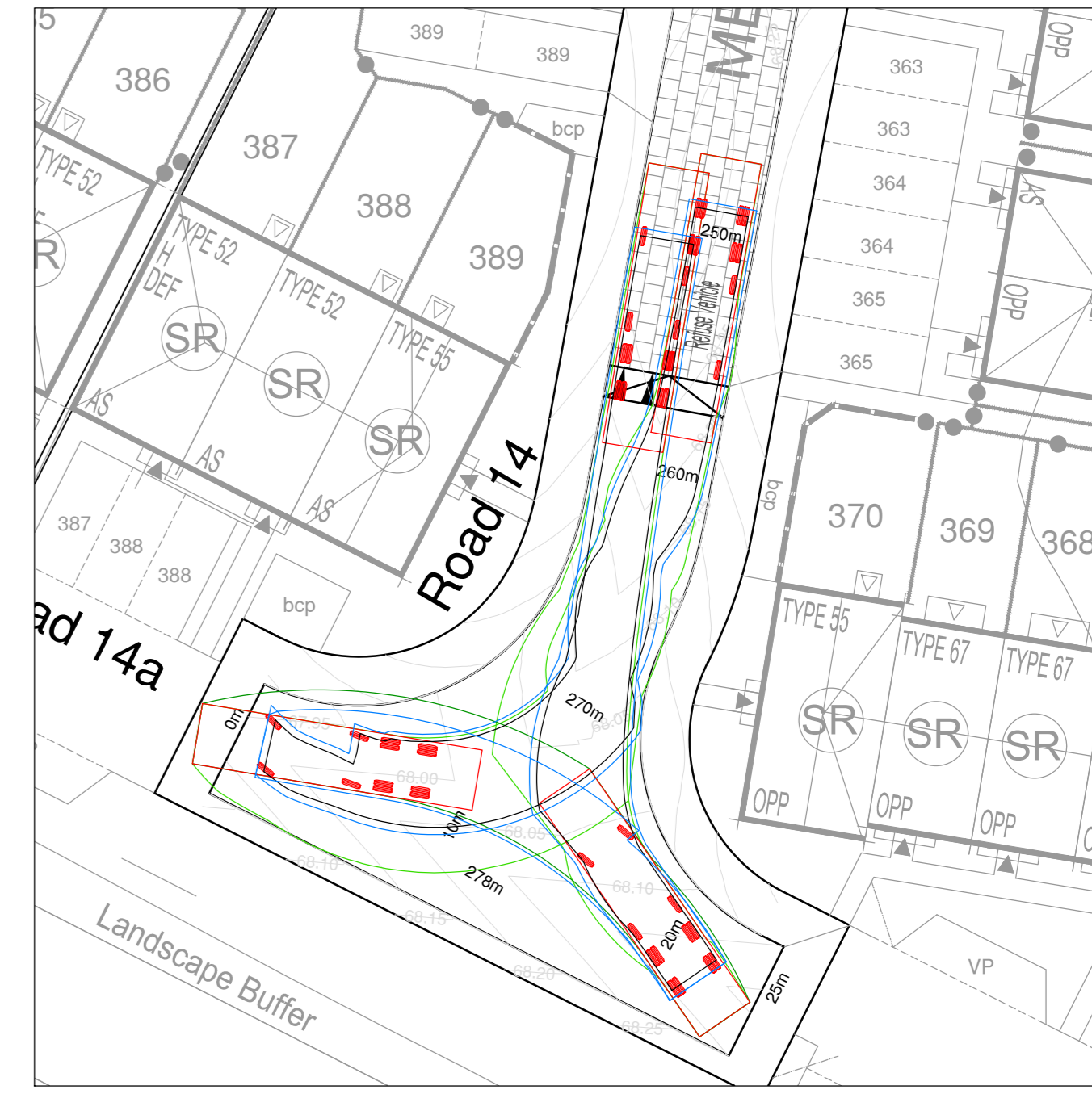

Turning Head - Road 14a

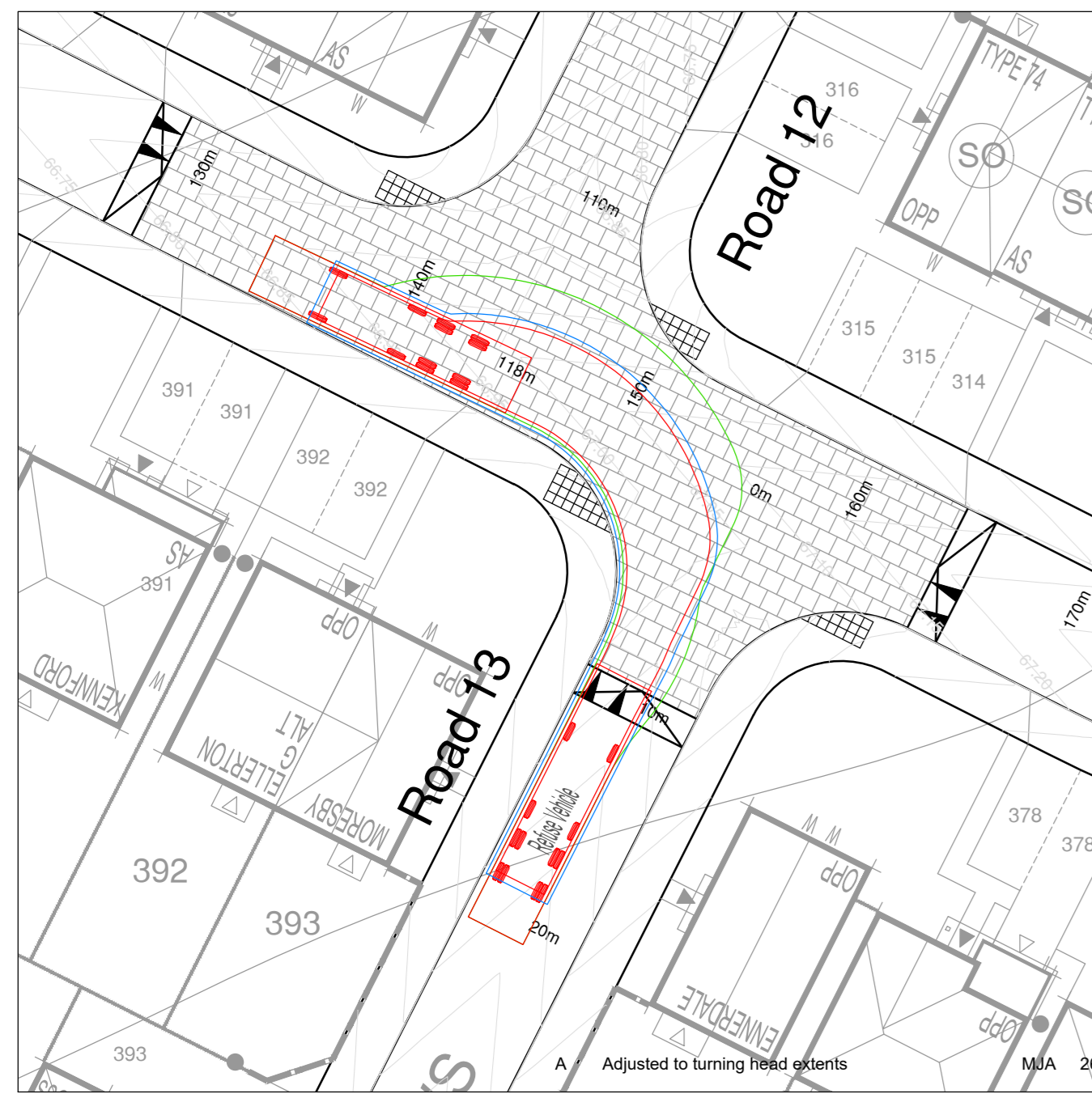

Left Turn - Road 13 to Road 10

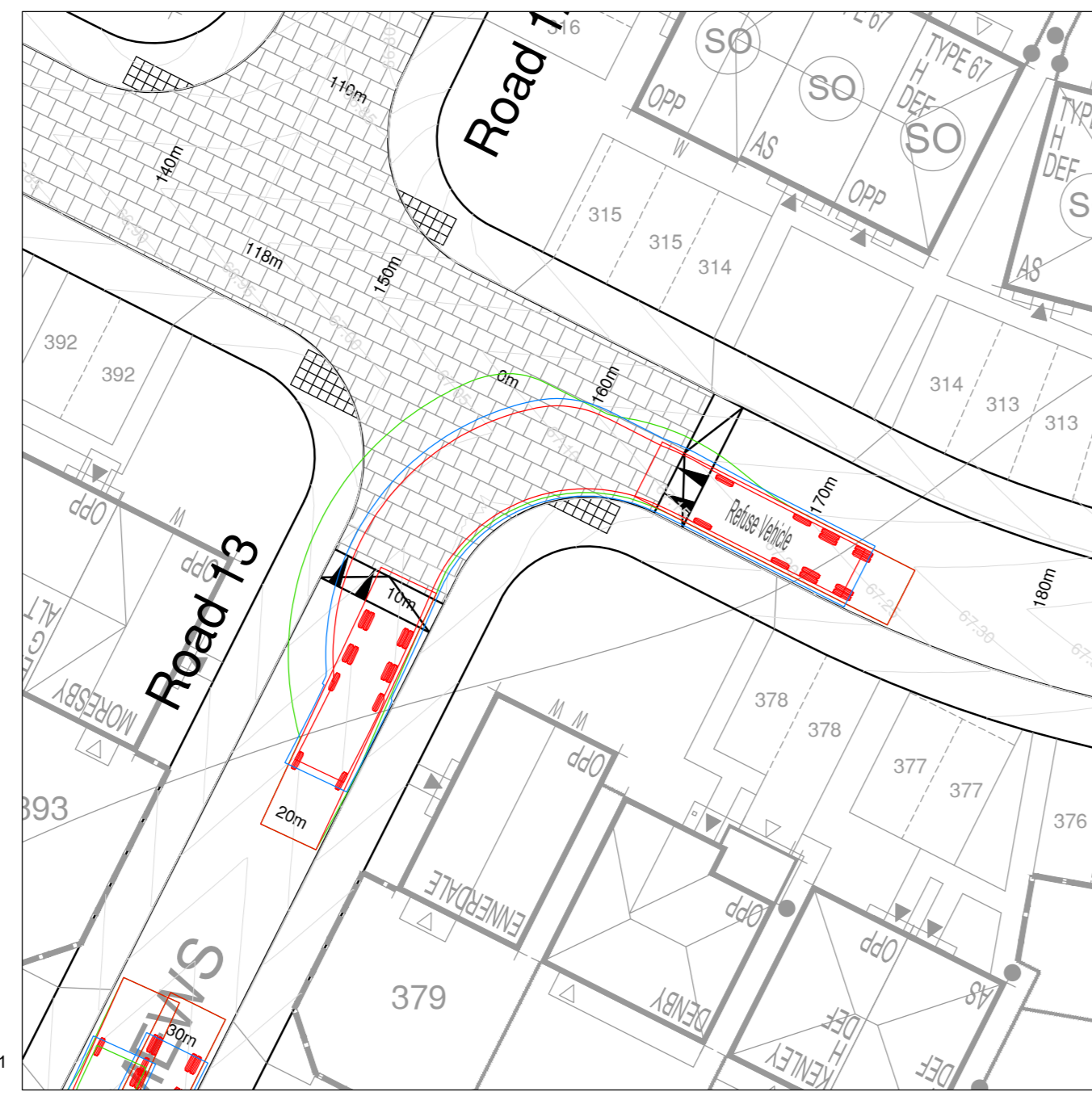

Left Turn - Road 10 to Road 13

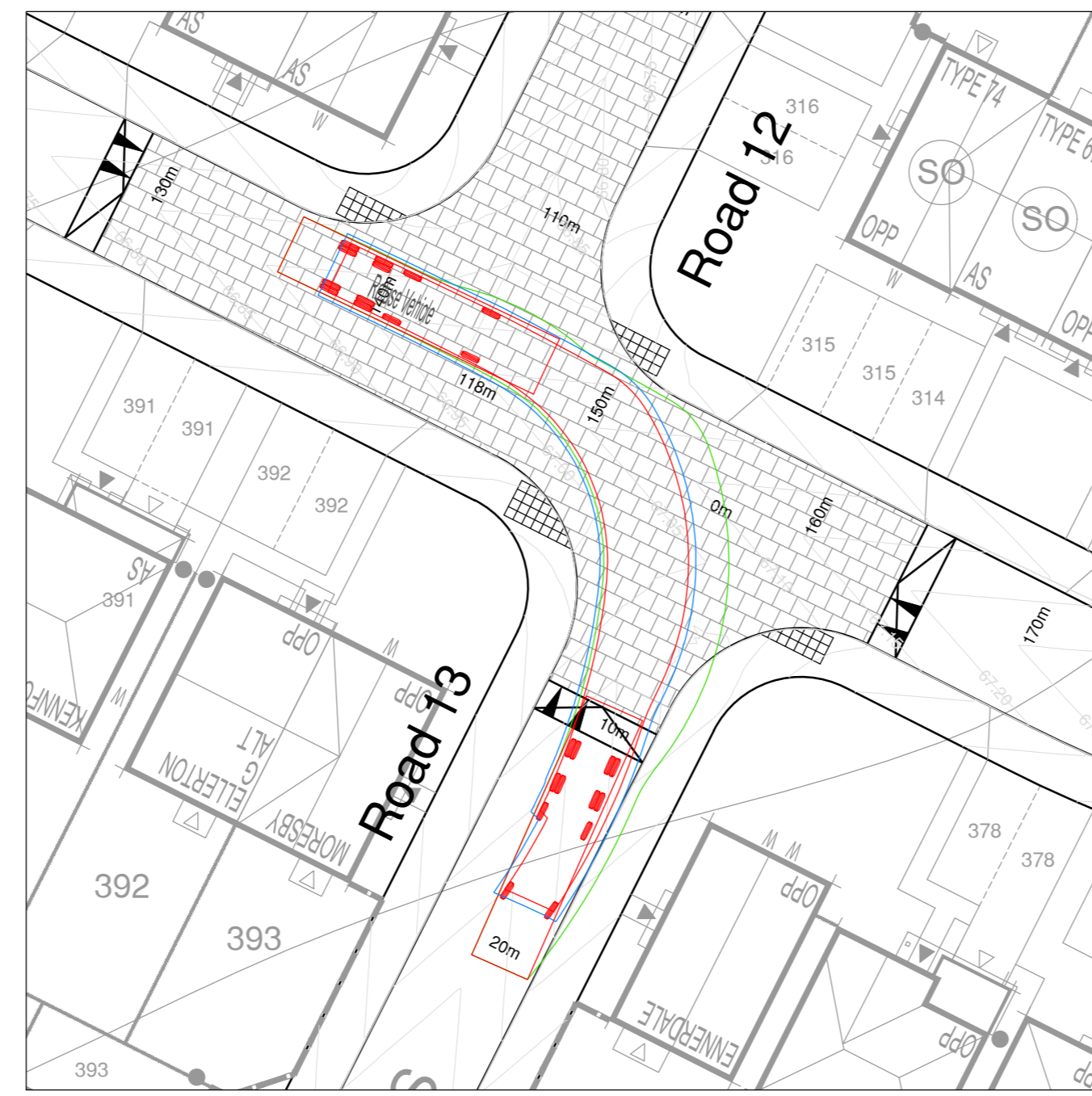

Right Turn - Road 10 to Road 13

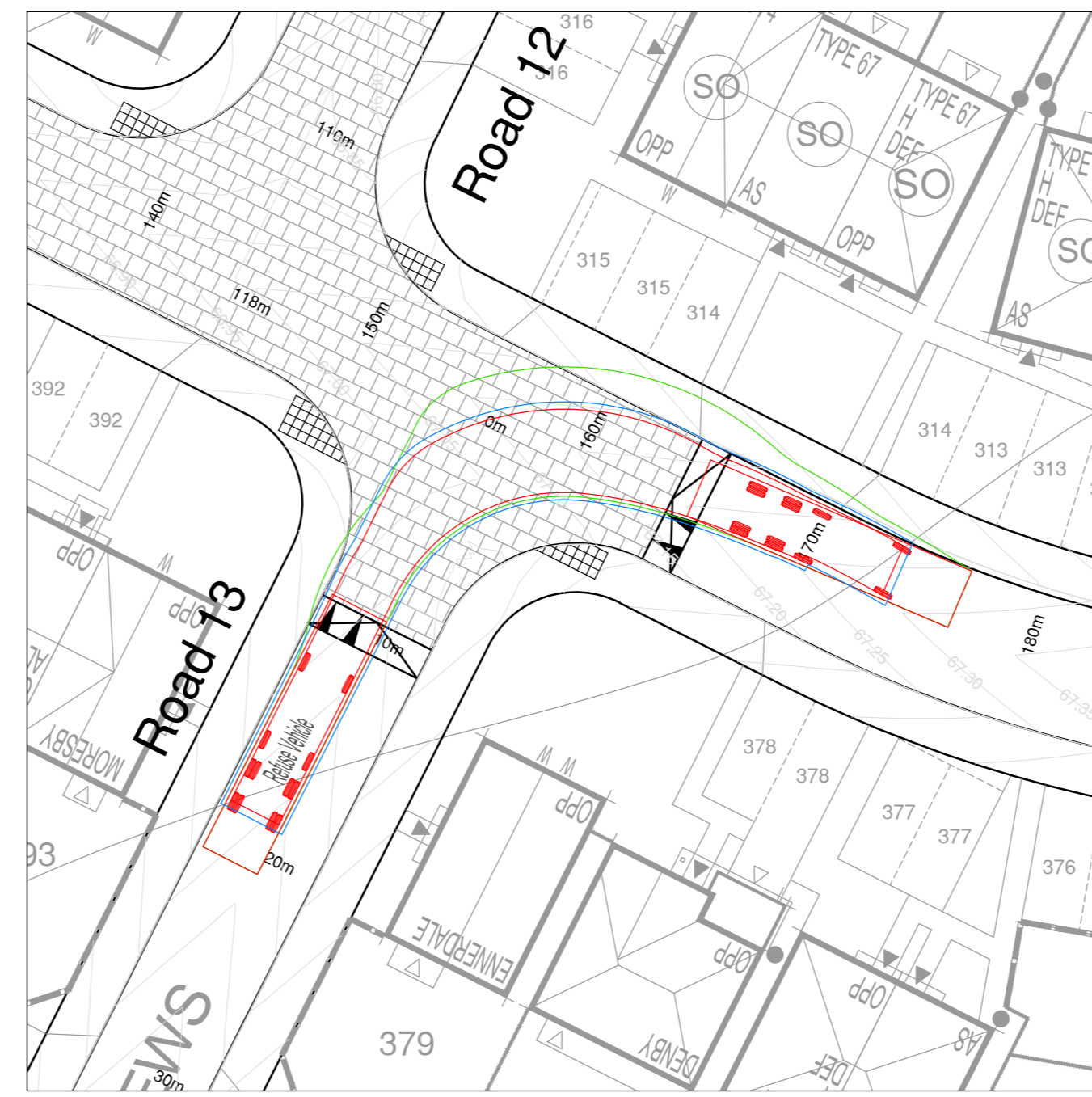

Right Turn - Road 13 to Road 10

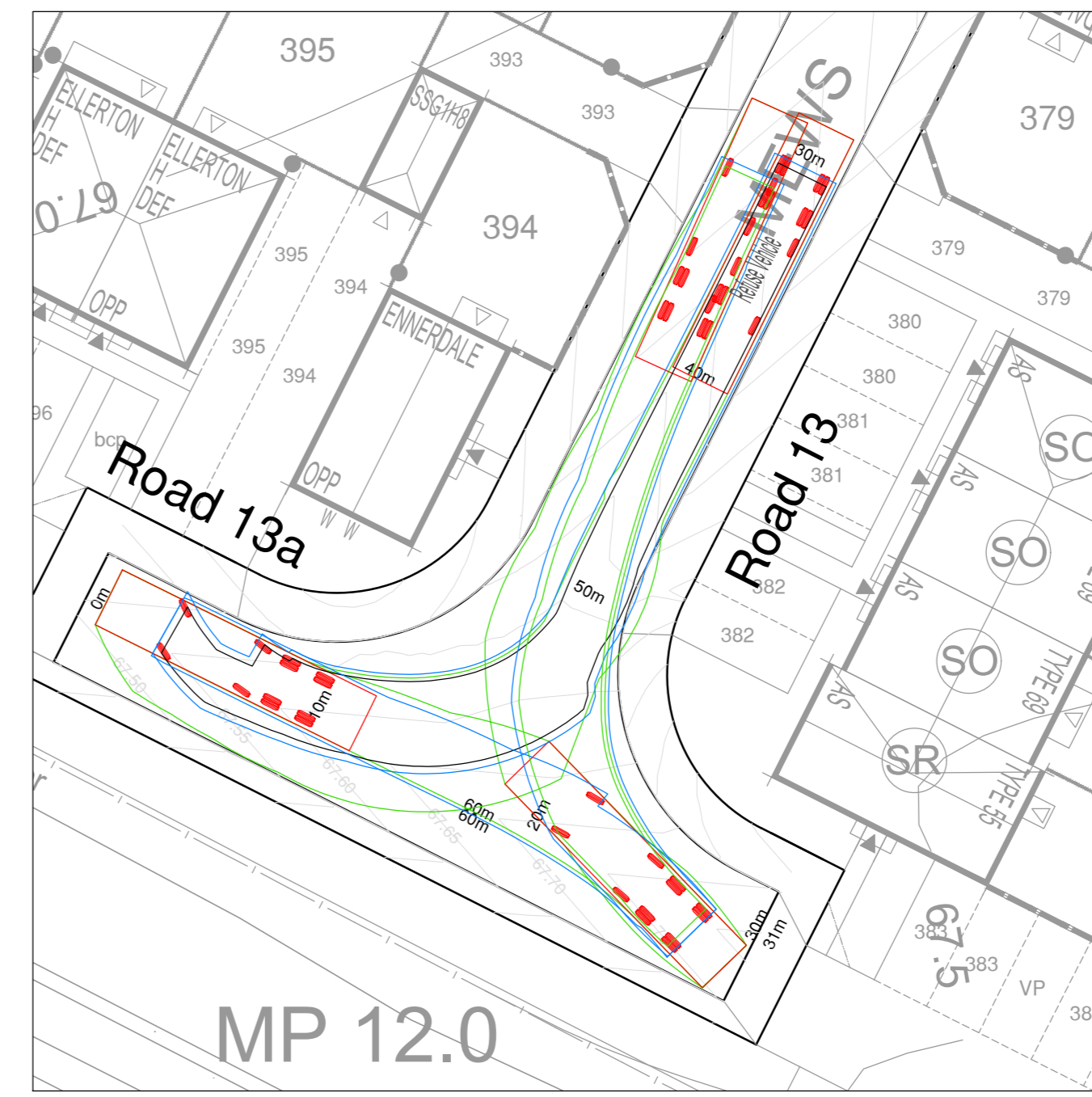

Turning Head - Road 13a

GENERAL NOTES

1. Do not scale this drawing. If in doubt, ask.
2. This drawing is to be used in conjunction with all other relevant Engineers, Architects and specialist design drawings and details.
3. All dimensions are in metres unless noted otherwise. All levels are in metres unless noted otherwise.
4. Any discrepancies noted on site are to be reported to the Engineer immediately.
5. All levels are subject to detailed design and may vary by +/-500mm.

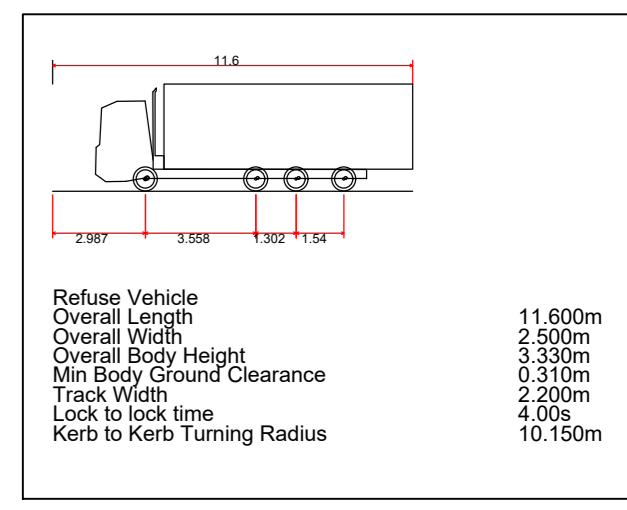

KEY

- Vehicle Wheel Track
- Vehicle Body Overhang
- 300mm Vehicle wheel offset

Rev	Description	Initial	Date
A	Adjusted to turning head extents	MJA	20.02.21
B	Additional tracking added	BL	02.09.21
C	Turning Head 13a updated to suit Highways comments	JZ	06.02.21
D	Updated to status approved for use AFU	JZ	07.01.22

