

to new Marsh Microbe mini Sewage treatment plant with sampling chamber thereafter to the brook with NRW's consent.

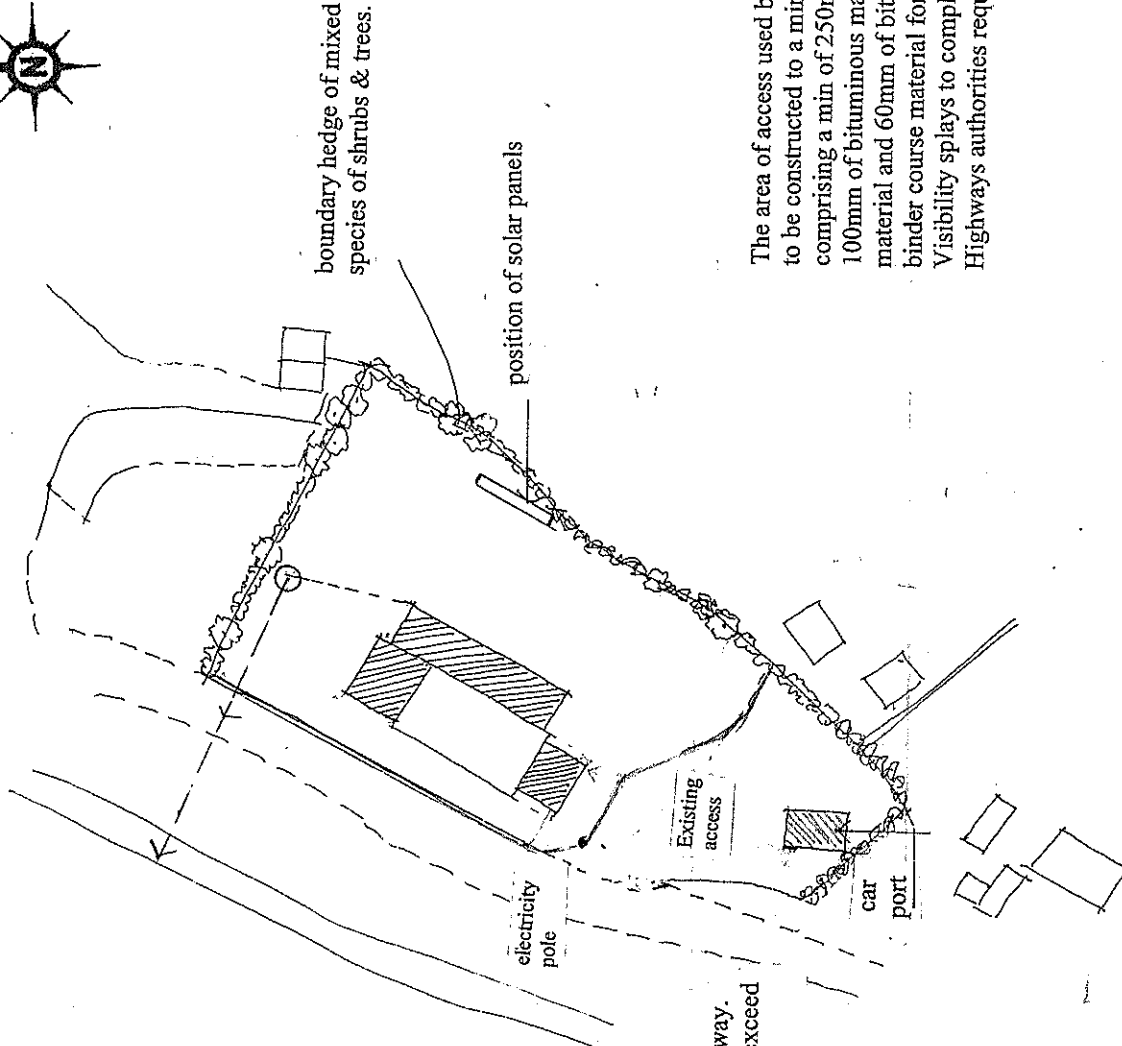

access to the dwelling by means of a ramped approach or level access to comply with Part M2 Section 6.

Any gates shall be set back at least 5-5 from the edge of the carriageway and shall be constructed so as to be incapable of opening towards the highway. The gradient of the access should not exceed 1 in 15 for the first 5-5metres.

The area of access used by vehicles to be constructed to a min of 410mm depth comprising a min of 250mm sub base material 100mm of bituminous macadam base course material and 60mm of bituminous macadam binder course material for a distance of 5.5. Visibility splays to comply with the Highways authorities requirements.

BLOCK PLAN & SITE PLAN

Drwg No SM 10
 Scale 1:500. 1:1250
 24th August 2015
 E M-J