

# Planning Design Statement

60 Albury Road, Aberdeen

For Mr and Mrs C Slane

May 2021 – Ver 1

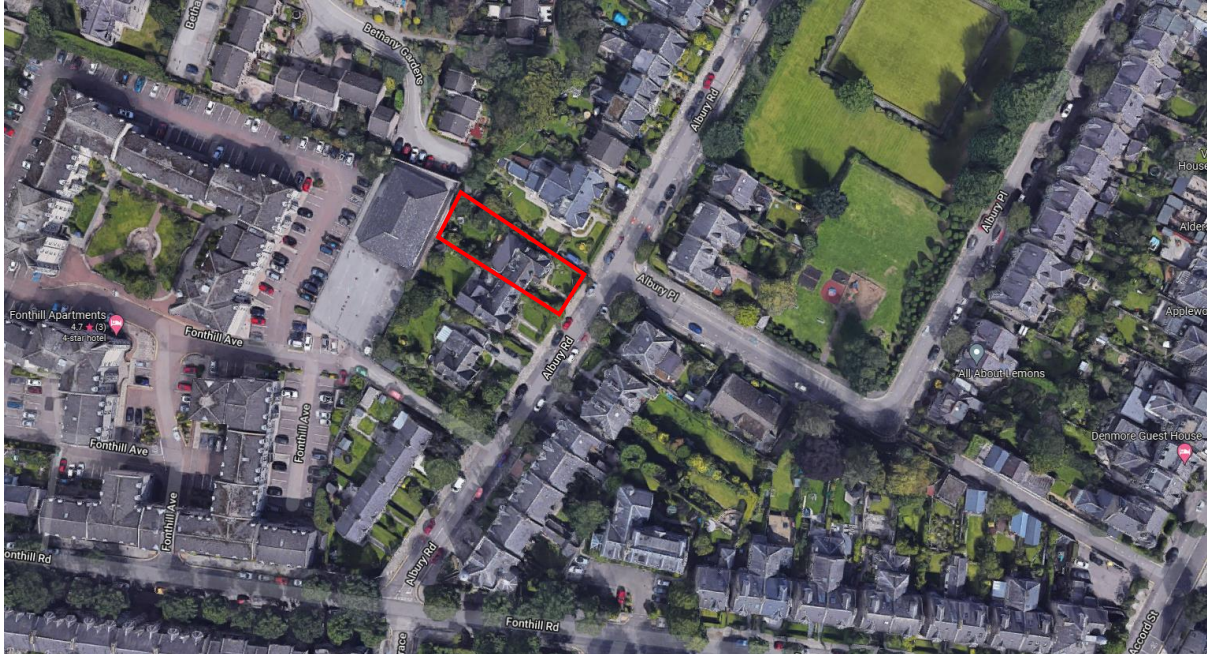

Location – 60 Albury Road, Aberdeen (bound red).

## History

Planning Application Approved November 2012 – 121358, *Carry out general pruning works for the health of the tree and to prevent touching the overhead telephone lines.*

*Planning Application Approved March 2022 - 211668/DPP | Formation of dormer; installation of roof lights; enlargement of door opening to install bio-fold doors; formation of window opening; formation of infill extension with roof replacement and installation of cladding to an existing rear extension*

The property is C Listed and is within Ferryhill Conservation Area.

The proposal is a retrospective extension to existing patio/decking at 60 Albury Place, Aberdeen.

## **Voigt Architects Limited**



**Post: 3-4 Harbour Visitor Centre  
Fishmarket Quay  
Arbroath. DD11 1PS**  
**Tel: 01241 879662**  
**Web: [www.voigtarchitects.ltd](http://www.voigtarchitects.ltd)**

## **Historic Listing**

Summary; -

Category **C**

Dated Added **29 02 2000**

Local Authority **Aberdeen**

Planning Authority **Aberdeen**

NGR **NJ 93476 5235**

Listing **LB46770**

Description; -

*Duncan McMillan, circa 1872. Single storey and attic mirrored pair of 3-bay cottages ornees. Harled and whitewashed, stone margins to No 62. Overhanging eaves; pierced decorative timber bargeboards.*

*SE (PRINCIPAL) ELEVATION: symmetrical; gabled granite doorways advanced to centre, with panelled timber doors and segmental-arched fanlights, gabled 2-pane dormers to centre of attic above; bipartite window flanking doorways to inner bays, bipartite gabled dormer with pierced trefoil to attic above; advanced gabled outer bays, canted windows to ground floor, Tudor-arched windows set in gableheads.*

*NE, NW AND SW ELEVATIONS: not seen 1999.*

*Predominantly 2-pane timber sash and case windows to No. 60; replacement PVCu glazing to No 62. Grey slate roof with lead ridge, surmounted by decorative ironwork to No 62. Coped granite gablehead and ridge stacks with octagonal and circular cans. Cast-iron rainwater goods.*

*INTERIOR: not seen 1999.*

*BOUNDARY WALLS: copied rubble walls to SE.*

Statement of Special Interest; -

*Duncan McMillan (1840-1928), whose son J Ross McMillan (1867-1959) took over his practice when he died, is perhaps best known for his work on Archibald Simpson's Marine Terrace (see separate listing). 60-62 Albury road are a pair of unusually detailed cottages.*

**Proposed**

The plan below illustrates the extent of the extended patio. The original timber decking is shown cross hatched, and the overall now stone patio is shown yellow. The height remains as existing.

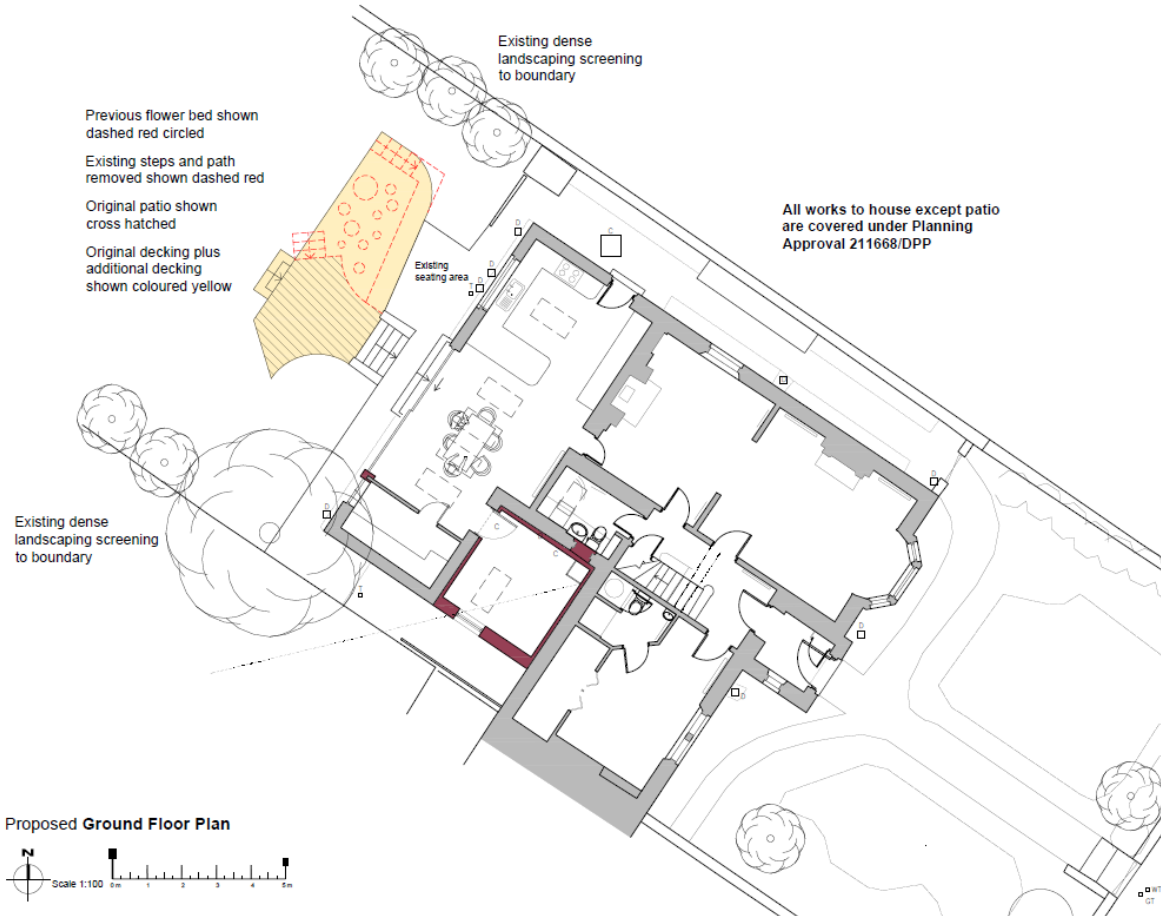



Existing photograph showing existing timber decking, flower bed to left and existing steps further to the left.



The replacement stone patio is the same distance out into the garden to the original but extends to the extend of the original steps to the left hand side of the photograph. The boundaires to either side of the extended patio are densely landscape screened to allow the applicant and both neighbours to retain privacy and amenity.