



DO NOT SCALE

All dimensions to be checked on site by the Contractor and any discrepancies reported to the Surveyor.

Site Location -

Northing - 393969
Easting - 646540

LEGEND

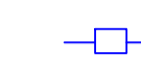
-  Area of Replacement Concrete
-  Area of newly installed concrete
-  Renewed rainwater system (rectangles identify gullies)

Site areas

- Z1 - 160m² - replacement concrete to address existing broken concrete surface. Concrete to be 150mm fibre reinforced insitu.
- Z2 - 100m² - replacement concrete to address existing broken concrete surface. Concrete to be 150mm fibre reinforced insitu.
- Z3 - 50m² - replacement concrete to address existing broken concrete surface. Concrete to be 150mm fibre reinforced insitu.
- Z4 - 100m² - replacement concrete to address existing broken concrete surface. Concrete to be 150mm fibre reinforced insitu.
- Z5 - 25m² - replacement concrete to address existing broken concrete surface. Concrete to be 150mm fibre reinforced insitu.
- Z6 - 36m² - replacement concrete to address existing broken concrete surface. Concrete to be 150mm fibre reinforced insitu.
- Z7 - 240m² - replacement concrete to address existing broken concrete surface. Concrete to be 150mm fibre reinforced insitu.
- NZ1 - 144m² - New concrete pad installed to be 150mm thick fibre reinforced and laid on a minimum of 150mm type 1 hardcore.

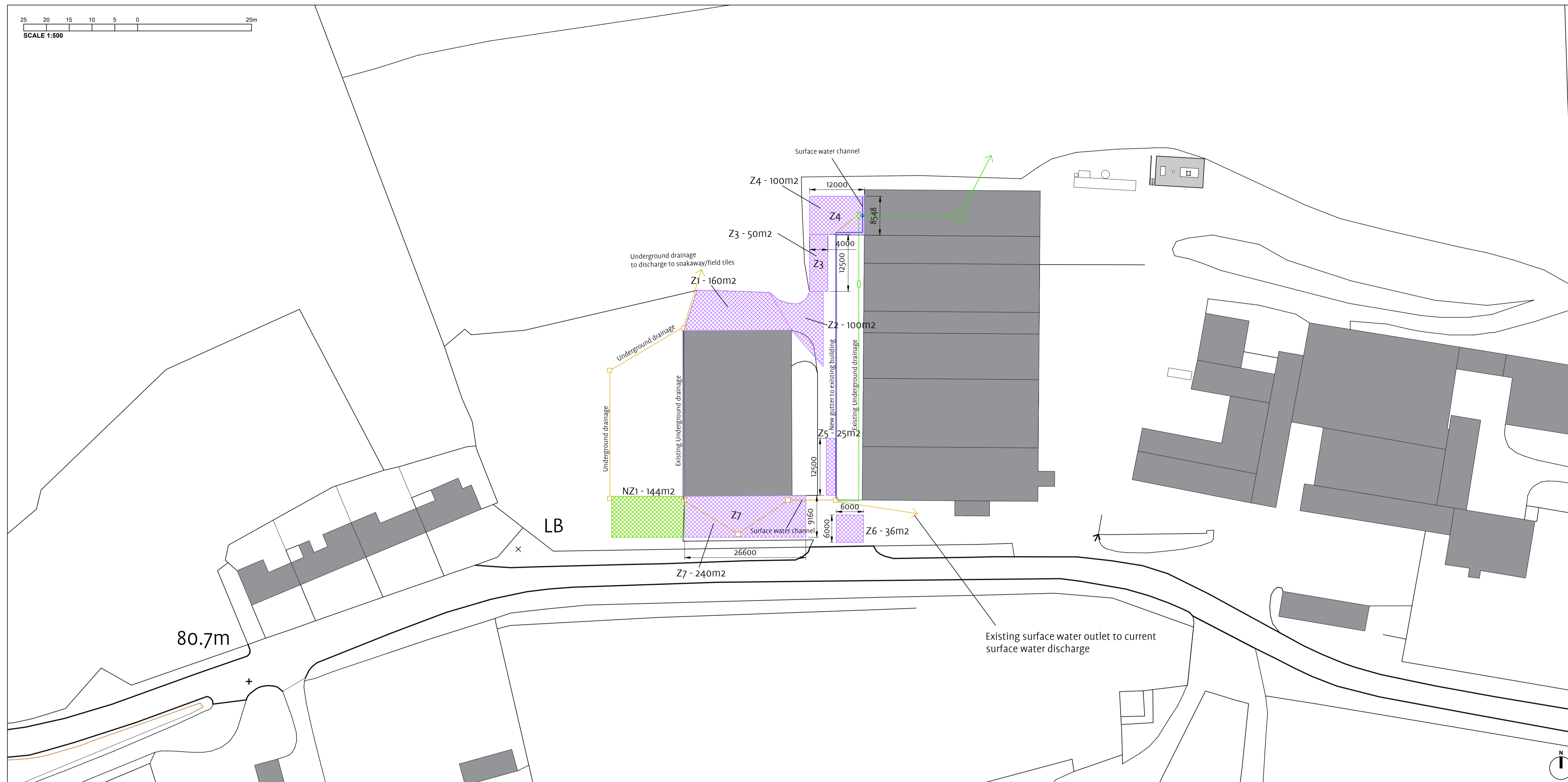

Proposed Concrete replacement areas and new concrete area (scale 1:500)

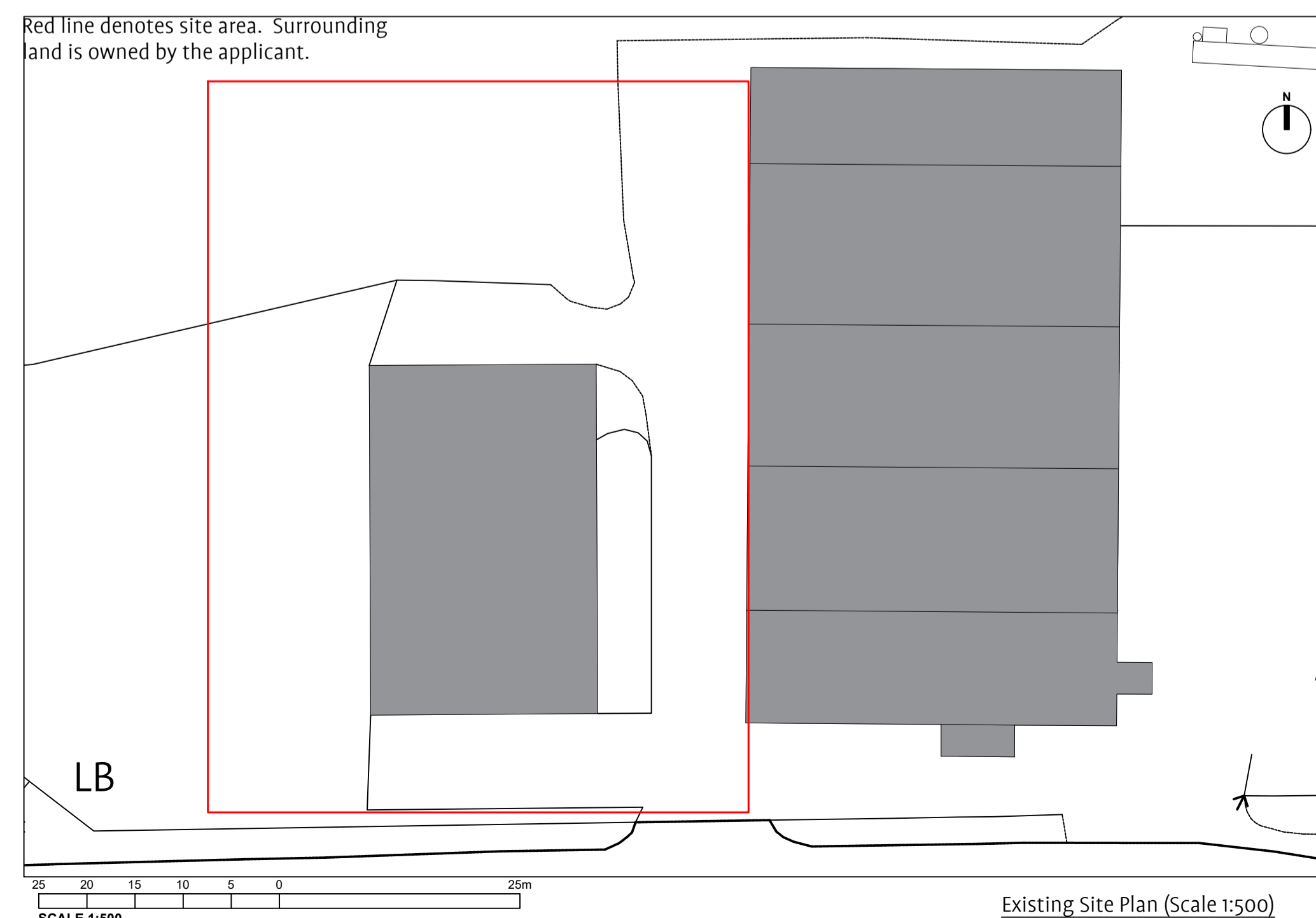

Existing Site Plan (Scale 1:500)

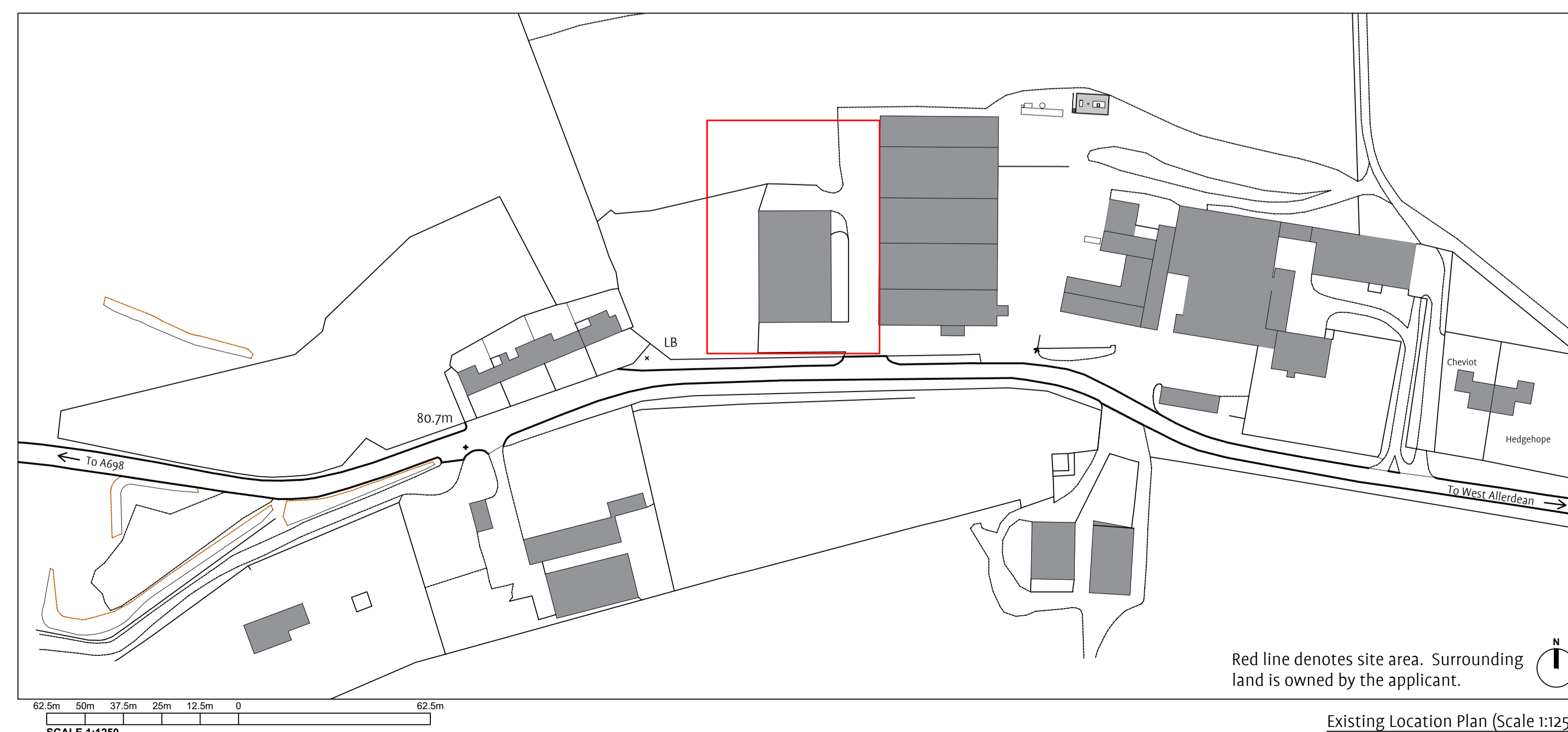

Red line denotes site area. Surrounding land is owned by the applicant.

Existing Location Plan (Scale 1:1250)

Rev A - Response to Invalid Letter - 11/05/22

Revisions



BERWICK-UPON-TWEED
44-48 Hide Hill
Berwick-upon-Tweed
Northumberland
TD15 1AB

T: 01289 304432
F: 01289 302027
E: berwick@edwin-thompson.co.uk
W: edwin-thompson.co.uk

also at CARLISLE, GALASHIELS, KESWICK, PRESTON & WINDERMERE

Project & Client.

Shoreswood Farm
Berwick upon Tweed
TD15

Concrete yard surface renewal
and addition

Date	Sheet size	Scale
APR 22	A1	1:100 & 500
Drawn By	Rev	Drawing No.
PV	A	BS5328(002)-100