

The use of this data by the recipient acts as an agreement of the following statements. Do not use this data if you do not agree with any of the following statements:-

All drawings are based upon site information supplied by third parties and as such their accuracy cannot be guaranteed. All features are approximate and subject to clarification by a detailed topographical survey, statutory service enquiries and confirmation of the legal boundaries.

Do not scale the drawing, except for planning purposes. Use figured dimensions in all cases. Check all dimensions on site.

Report any discrepancies in writing to Palmer Lunn Architects before proceeding.

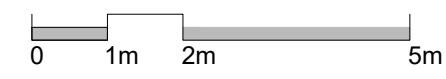

Section A-A as Proposed

Schedule of Proposed Works

1. New porch comprising lead roof, timber panelled door and glazed side screen. Timber panel configuration to match existing
2. New lightweight partition, reversible
3. Free-standing kitchen units. Joinery scribed around existing skirtings
4. New built-in wardrobe to replace existing, reversible
5. Timber framed and glazed bay window with new lead roof
6. New render finish to walls to match existing where Courtyard partially lowered

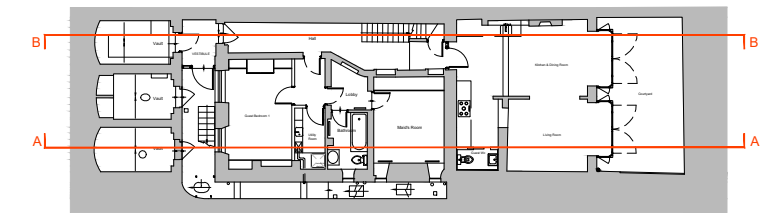

Key Plan

P02	Planning	06.05.2022	NBa	APa
P01	Planning	31.01.2022	NBa	APa
Rev	Description	Date	Drn	Chk

Status
PLANNING

Client
Mrs F Lanza

Project
16 Wilton Street
London, SW1X 7AX

Drawing
Section A-A
as Proposed

Project No.	Drawing No.	Revision
17007	WST-PL-12	P02
Scale @ A3	Drawn By	
1:100	NBa	