

Please note that this drawing is not prepared for construction purposes, no scaling should take place and this should NOT be relied upon for any construction purposes.

Revisions:

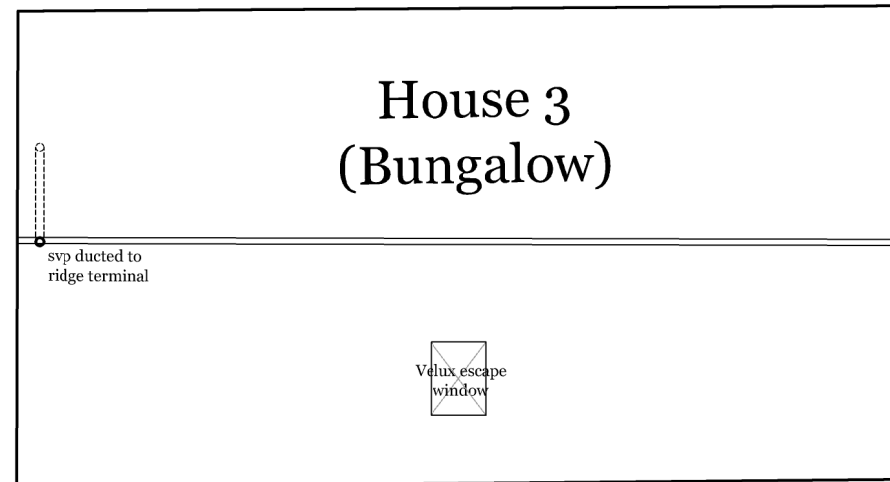
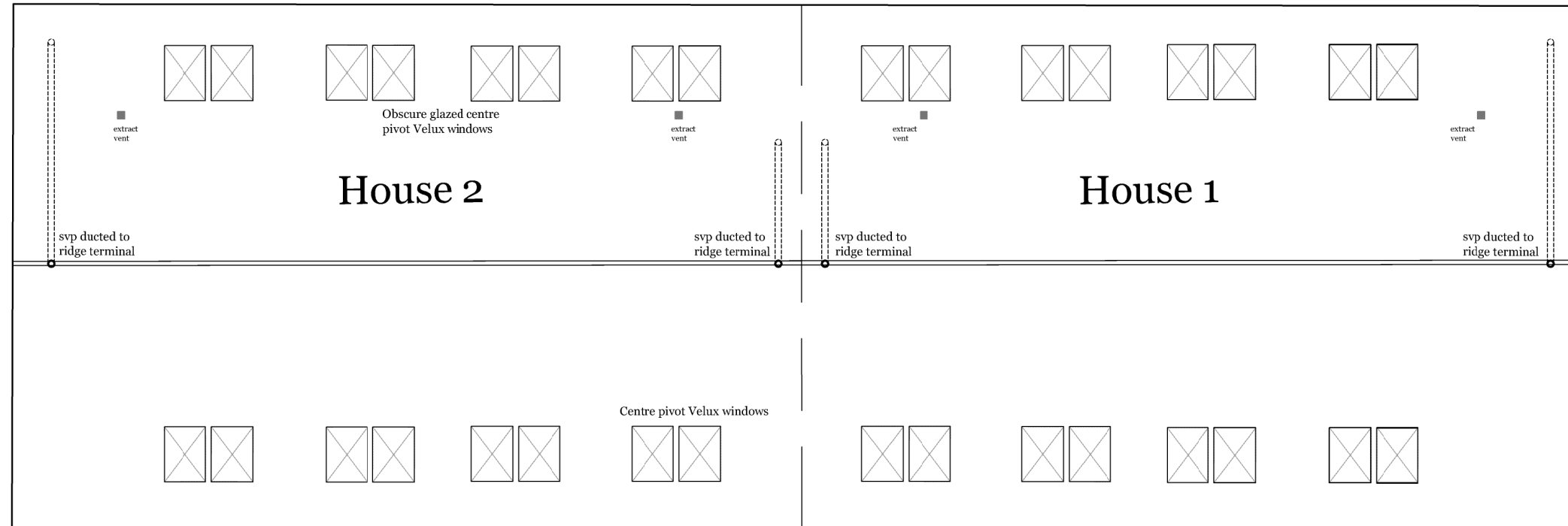

# Fenland Architectural Design

Located in Holsworthy, on the Devon/Cornwall border, and providing residential design consultancy throughout both Counties

Mobile: 07809 125531  
Email: fenlandad@gmail.com

**CLIENT:**  
Mr Robert Dempsey.

**PROJECT:**  
Conversion of existing barn to 2N0 dwellings and existing office (1 x 1 story) 3 bed, the demolition of an existing barn, with 2.4m high boundary fences; at Buildings South East Of 132 Cock Bank, Turves, Cambridgeshire

**DRAWING:**  
Roof Layouts.

**DRAWING NUMBER:** F1150 ~ 14.      **REV:**

**Date:** Nov 2021      **Scale:** 1:100@A3