

Please note that this drawing is not prepared for construction purposes, no scaling should take place and this should NOT be relied upon for any construction purposes.

Revisions:

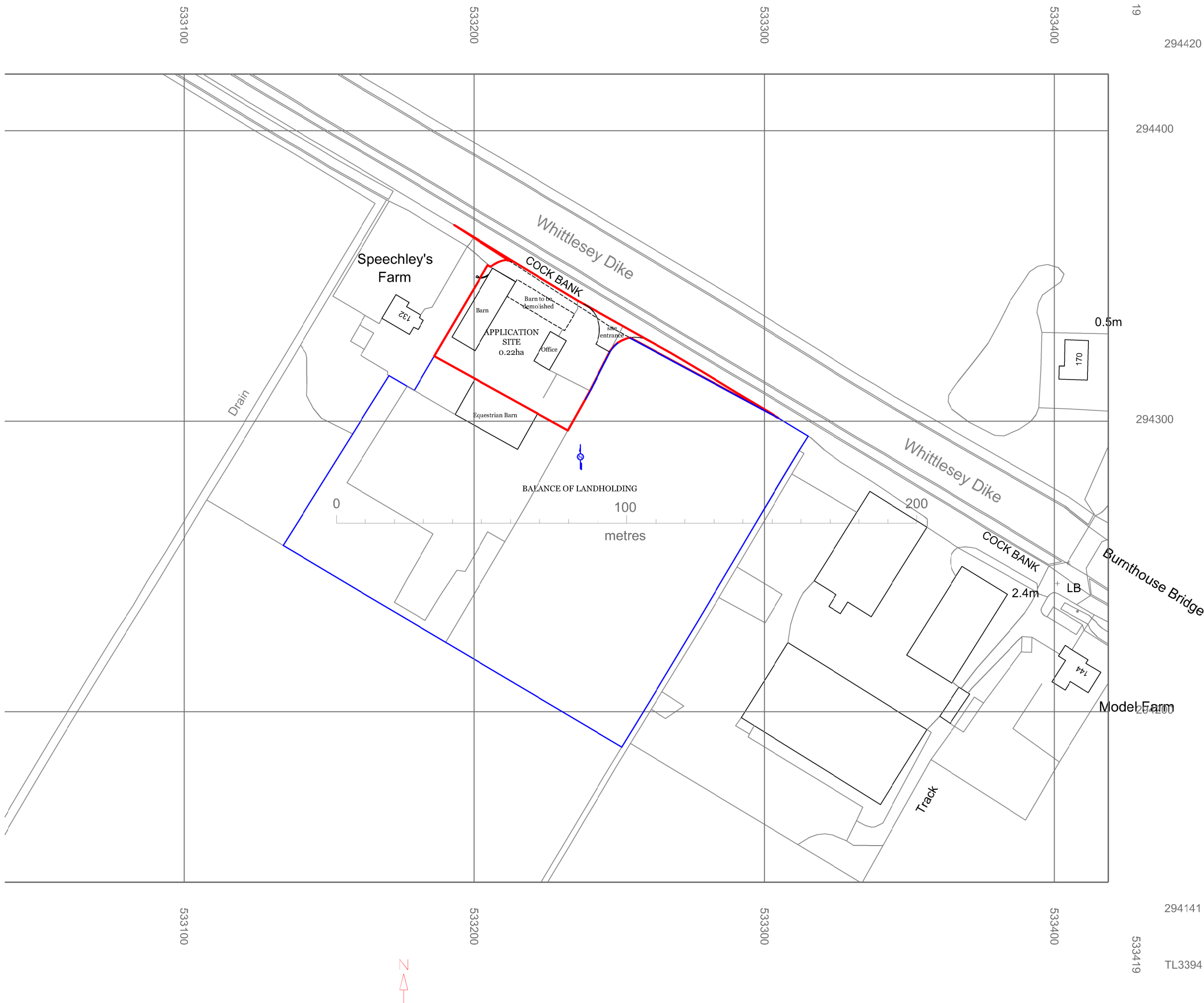

Fenland Architectural Design

Located in Holsworthy, on the Devon/Cornwall border, and providing residential design consultancy throughout both Counties

Mobile: 07809 125531
Email: fenlandad@gmail.com

CLIENT:
Mr Robert Dempsey.

PROJECT:
Conversion of existing barn to 2N0 dwellings and conversion of existing office to (1 x 1 story) single story 3 bed, the demolition of an existing barn, with 2.4m high boundary fences; at Buildings South East Of 132 Cock Bank, Turves, Cambridgeshire

DRAWING:
Location Plan.

DRAWING NUMBER: F1150 ~ 01. **REV:**

Date: Nov 2021 **Scale:** 1:1250A3