

NOTES

GENERAL NOTE

All works to be carried out in accordance with relevant BS/EN standards, relevant Codes of Practice and Building Regulations

Do not scale from this drawing. All dimensions are to be verified on site before proceeding with the work.

Existing features such as timber panelling decorative cornices are to be retained, and all works will be carried out with care to not damage the existing building.

Following pre-application consultations with the LPA, works to remove and replace recently added fittings and partitions where these do not impact the existing listed structure are not considered to require Listed Building Consent

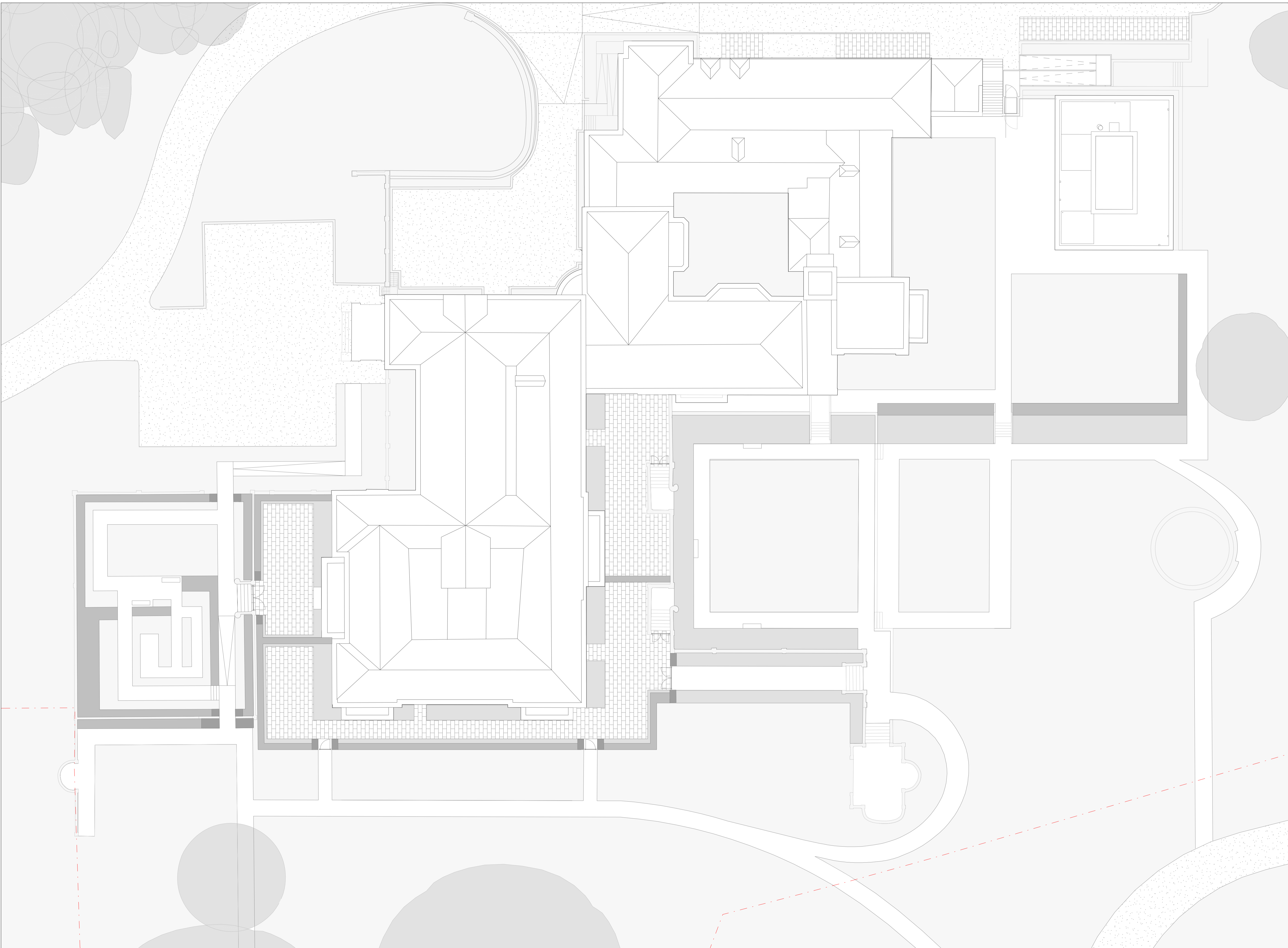

NOTES
 CONSULTANTS
 - Refer to highways consultant's drawings for details
 - Refer to landscape consultant's drawings for details
 - Landscaping layout is indicative only
 AREAS
 - Refer to area schedule
 © Copyright Reserved. ColladoCollins Architects Ltd

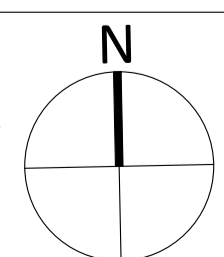

Rev	Notes	Date	By	Auth
P1	Listed Building Application 4 Issue	23-03-22	DH	CB

KEY
 - - - - - APPLICATION BOUNDARY
 - - - - - OWNERSHIP BOUNDARY

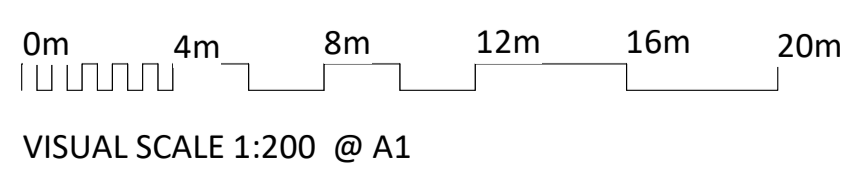

ColladoCollins Architects

17-19 Foley Street
 London W1W 6DW
 T 020 7580 3490
 F 020 7580 2917
 info@colladocollins.com
 www.colladocollins.com

Date: 12/08/21
 Drawn By: CB
 Checked by: DH
 Scale @ A1: 1 : 200
 Scale @ A3: 1 : 400
 Project No: 20032

Elysian Residences
 Wildernesse House, Sevenoaks
 Existing - Landscape Plan

PLANNING
 WDH-CCA-SW-RF-DR-A-E1.000