

# 1557: Cradlebridge Farm

## Foul Water Drainage Assessment

# Wessex Water Network Map

**Cradlebridge Farm  
Replacement Dwelling  
Ref.: 1557**

## Existing Mains Connections

As demonstrated on this Wessex Water Map, the site has no foul water mains connection. Therefore the new proposed dwelling cannot connect to a public sewer to be treated at a public sewage plant.

Reproduced from the Ordnance Survey map by permission on behalf of the Controller of Her Majesty's Stationery Office © Crown Copyright . Licence 100019539.

WATER MAINS	SEWERS	STRATEGIC	PUBLIC	PRIVATE	SECTION 104	OTHER WESSEX PIPES	NON-WESSEX / UNKNOWN
Distribution	Foul	Surface	Surface	Surface	Surface	Rising Mains	Private Rising Mains
Washout	Surface	Combined	Surface	Surface	Surface	EDM Effluent Disposal	Culverted Watercourse
Raw Water	Abandoned	Combined	Surface	Surface	Surface	Overflow	Highway Drain
Abandoned	Abandoned	Combined	Surface	Surface	Surface	Syphon	Use Unknown
Private	Abandoned	Combined	Surface	Surface	Surface	Syphon	Status Unknown
<b>FITTINGS</b>	<b>STRUCTURES</b>						
Hydrant	Manhole - Foul	Pumping Station - Surface					
Other	Manhole - Surface	Pumping Stn - Foul/Combined					
	Manhole - Combined	Gully					
	Inlet	Vent Column					
	Outfall	Rodding Eye					
	Lamphole	Catchpit					
	Bifurcation - Foul	Flushing Chamber					
	Bifurcation - Surface	Soakaway					
	Bifurcation - Combined	Non Return Valve					
	Combined Sewage Overflow	Air Valve					
		Hatch Box					
		Washout					
<p>Colours generally indicate the use of the sewer/drain (i.e Red - Foul, Dark Blue - Surface, Magenta - Combined/Dual Use, Light Green - Highway Drain, Mid Green - Overflow).</p> <p>Some styles of line and symbol are shown on the key in sample/typical colours.</p>						<p><b>OTHER STRUCTURES</b></p> <p> Attenuation Tank</p> <p> Storage Tank</p> <p> Chamber</p> <p> Tunnel</p> <p> Interceptor</p>	
<p>Information in this map is provided for identification purposes only. No warranty as to accuracy is given or implied. The precise route of pipe work may not exactly match that shown. Wessex Water does not accept liability for inaccuracies. Sewers and lateral drains adopted by Wessex Water under the Water Industry (Schemes for Adoption of Private Sewers) Regulations 2011 are to be plotted over time and may not yet be shown. In carrying out any works, you accept liability for the cost of any repairs to Wessex Water apparatus damaged as a result of your works. You are advised to commence excavations using hand tools only. Mechanical digging equipment should not be used until pipe work has been precisely located. If you are considering any form of building works and pipe work is shown within the boundary of your property or a property to be purchased (or very close by) a surveyor should plot its exact position prior to commencement of works. If you are proposing to build over or near Wessex Water's apparatus you should contact the Developer Services Team, tel: 01225 256333 or e-mail: developer.enquiries@wessexwater.co.uk to discuss your proposals. Details of assets within Wessex Water's land ownership are unavailable through this service.</p>						<p><b>Wessex Water</b> YTL GROUP</p> <p></p> <p><b>Date:</b> 26/08/2021</p> <p><b>Centre:</b> 347655, 138468</p> <p><b>Scale:</b> 1:625 (when printed at A4 size)</p> <p></p>	

Cradlebridge Farm  
Replacement Dwelling  
Ref:: 1557

Soil Type & Percolation

As shown on this Landis soil scape map, the site sits within raised bog peat soils and close to Loamy Clay soils with natural high groundwater.

Given that the location of the site is in the Somerset Levels, it would be unsuitable to discharge foul water drainage into the ground, and therefore incapable of accommodating a drainage field.

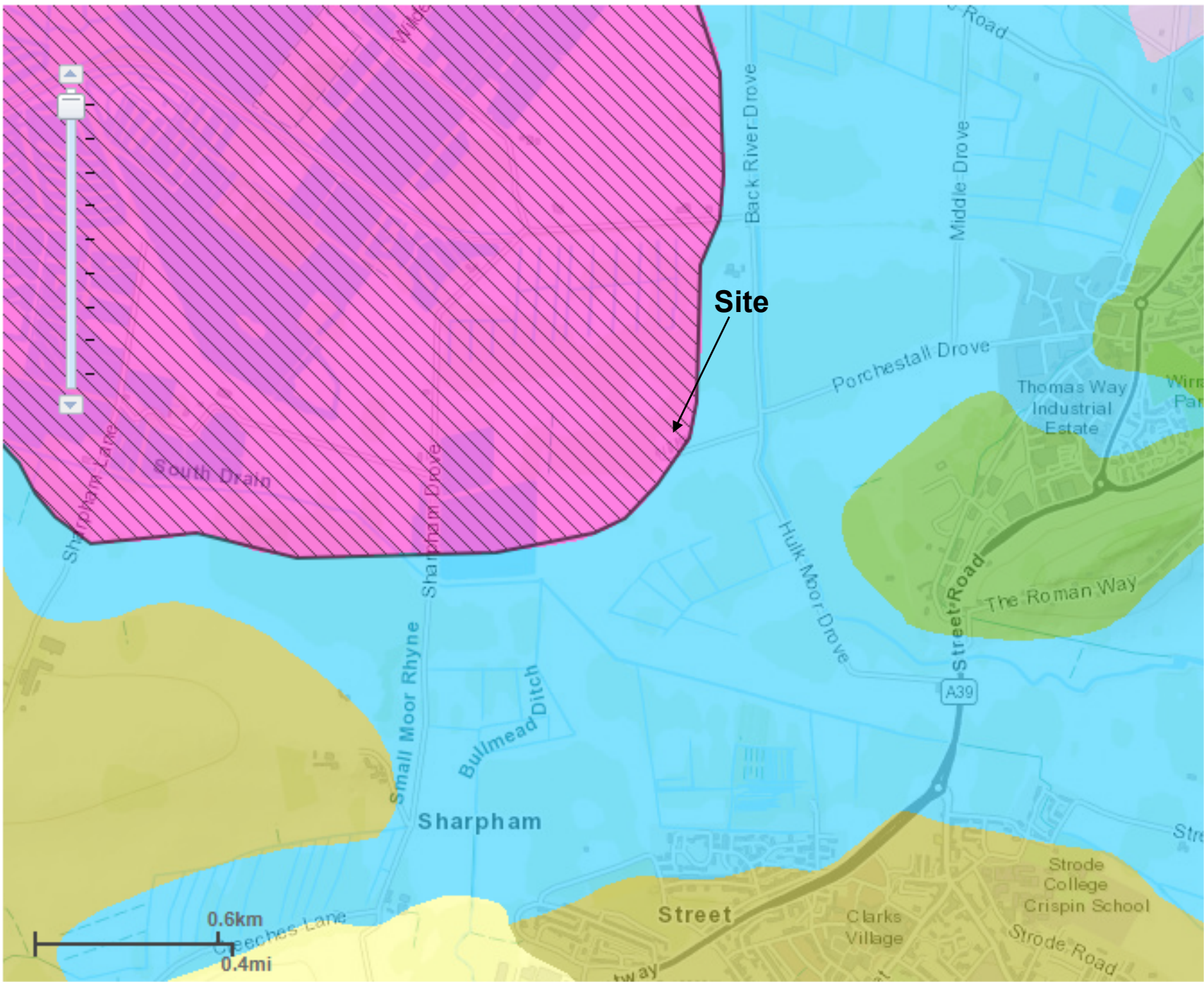

Legend	
Search	
Soil information	
<div></div> <b>Soilscape 26:</b> Raised bog peat soils	
<b>Texture:</b> Peaty	<a href="#">?</a>
<b>Coverage:</b> England: 0.3%   Wales: 0% England & Wales: 0.3%	
<b>Selected area:</b> 16.6km <sup>2</sup>	
<b>Drainage:</b> Naturally wet	<div><div></div><div>Water table</div></div> <a href="#">?</a>
<b>Fertility:</b> Very low	<div><div></div><div></div><div></div><div></div><div></div></div> <a href="#">?</a>
<b>Habitats:</b> Raised bog communities	<a href="#">?</a>
<b>Landcover:</b> Bog, grassland and some arable	<a href="#">?</a>
<b>Carbon:</b> High	
<b>Drains to:</b> Local groundwater and stream network	



**Cradlebridge Farm  
Replacement Dwelling  
Ref:: 1557**

**Foul Drainage Assessment**

As shown on the site plan we are proposing to replace the existing septic tank with a new package treatment plant, therefore upgrading the current system for the new dwelling.

The package treatment plant discharges into the ditch 25 meters from the proposed dwelling, which leads into a watercourse. The watercourse picks up Hulk Moor Rhyne and feeds into South Drain. This is demonstrated on the OS map on the next page.

In conclusion, the site is capable to accommodate the foul drainage demands of the proposed new dwelling, and we are upgrading the current system with a new package treatment plant.

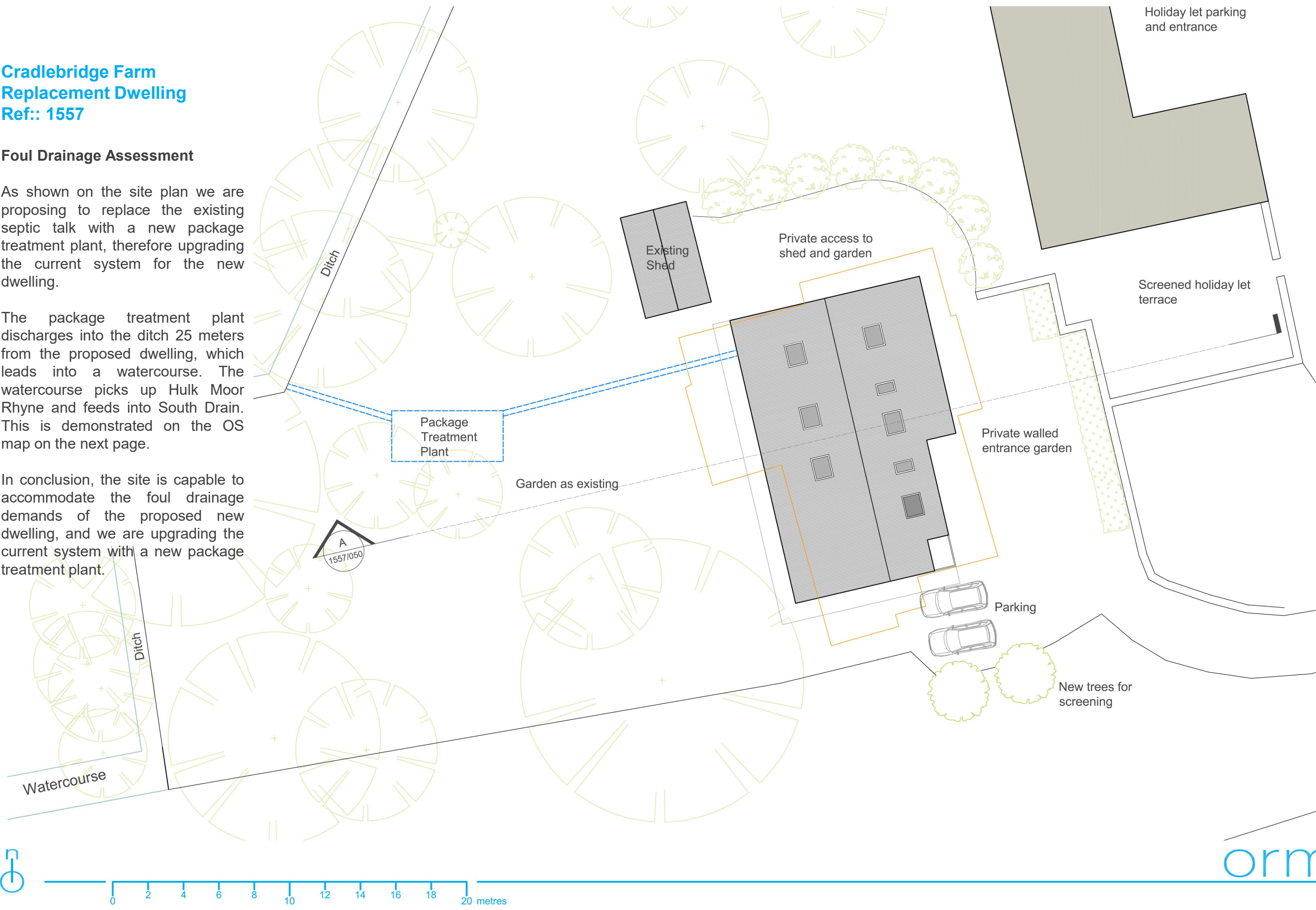

## Connection to water course

