

1557 :: Cradlebridge Farm

Planning Condition Discharge Information

09.05.2022

orme

architecture for the environment

Mill Farm Barns, Tuckers Lane, Baltonsborough, Glastonbury, BA6 8RH :: t 01458 445100 :: info@orme-architecture.com

1557 :: Cradlebridge Farm

Surface Water Drainage System (condition 4)

In relation to planning condition 4 – surface Water Drainage System, we confirm that surface water collected from the roof of the proposed dwelling will be

- i) Harvested in water butts for domestic irrigation purposes
- ii) Overflow will be directed into the watercourse adjacent to the site.

There is a large reduction in impermeable area as part of the proposals – hard standing tarmac track to the East and North of the dwelling is replaced with lawn.

The roof area of the proposed dwelling is also much reduced compared to existing.



Aerial photograph demonstrating area of lawn (green outline) proposed to replace tarmac track and concrete hardstanding.

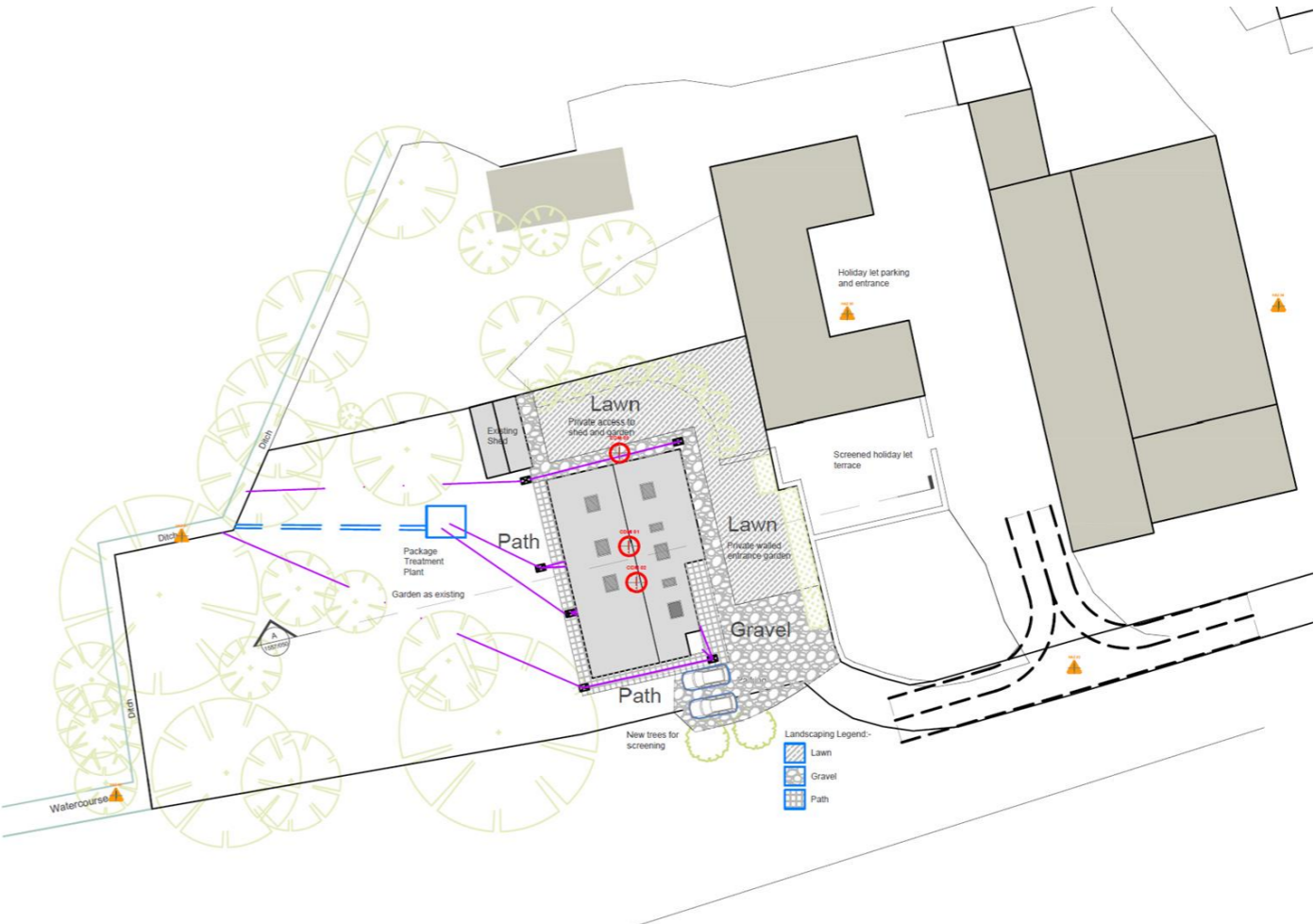

Drawing 1557/100 demonstrating landscape proposals and surface water drainage

Ecology Measures (conditions 7,9,11)

In relation to the planning permission 2021/1799/FUL for a replacement dwelling at Cradlebridge Farm, ecological protection measures have been installed on site in order to satisfy ecological planning conditions 7, 9 and 11 (part)

All works have been supervised by a suitably qualified ecologist who has put together the Construction Environmental Management Plan (condition 5) and the European Protected Species Mitigation Licence (condition 6)

Referring to the images and plan opposite, we confirm that bat roof access tiles have been installed to provide entry into the loft space constructed in accordance with the ecological requirements set out in the original planning application.

A Beaumaris Woodstone Bat Box has been installed on the gable end of the holiday let cottage adjacent to the site, and Vivaro Pro Woodstone bird boxes and a Schwegler 2F bat box have been installed on the surrounding trees (trees T12 & 22 for the bird boxes and tree T1 for the bat box).

Installed photographs are included opposite.

