

1:200 scale 1m 5m 20m

MATERIALS	
WALLS:	Concrete block
ROOF:	Metal roof sheeting
WINDOWS:	Roof skylight
DOORS:	N/A
GUTTERS:	Black UPVC
DOWN PIPES:	
BOUNDARIES:	Dry Stone wall

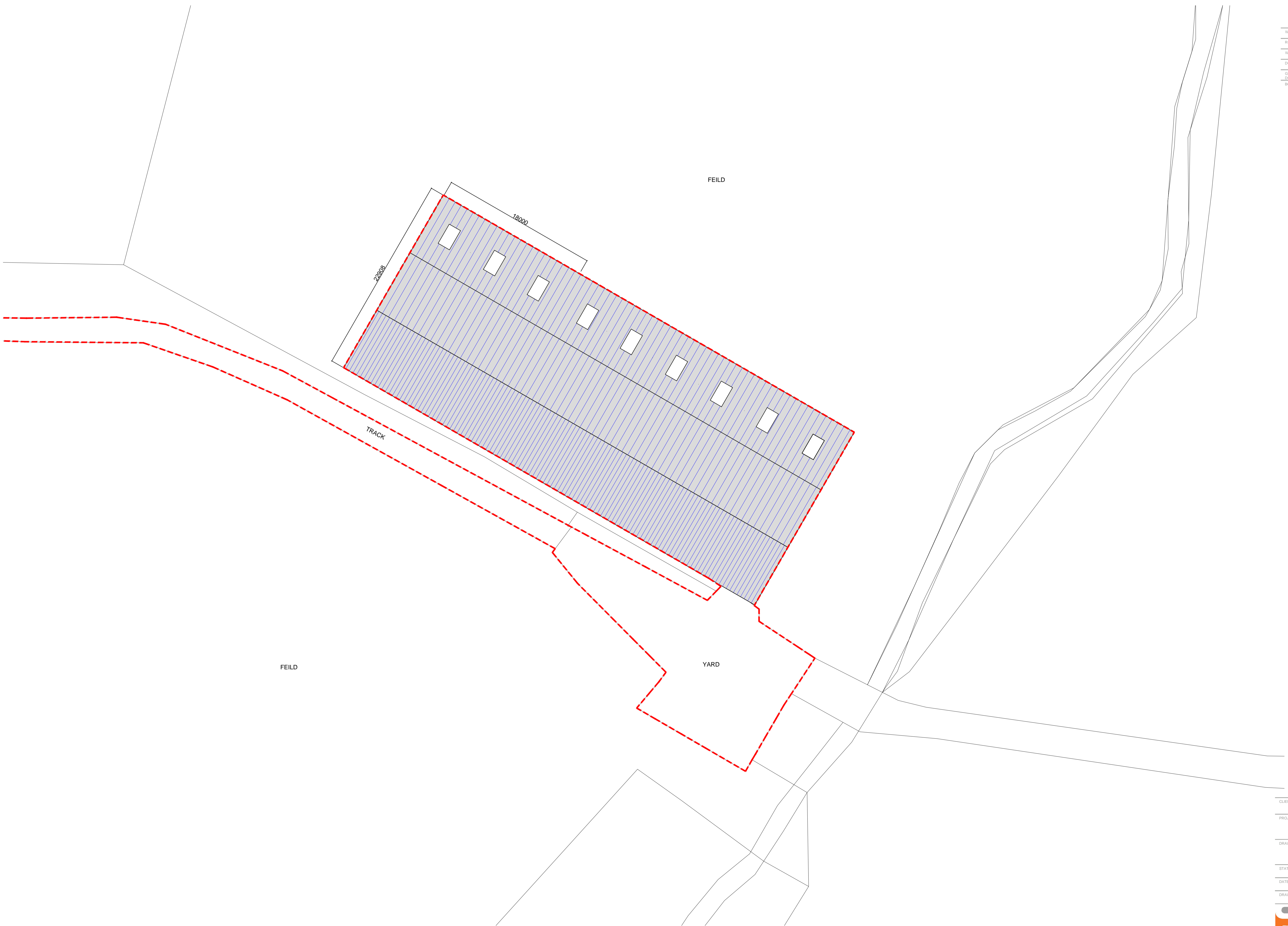

SITE / ROOF PLAN - PROPOSED

CLIENT:	John Howard		
PROJECT:	Proposed Extension to Agricultural Building at Newton Grange, Bank Newton, Nr Gargrave, Skipton BD23 3NT		
DRAWING:	Proposed Site / Roof Plan		
STATUS:	PLANNING		
DATE:	Mar 2022	SCALE @ A1:	1:200
DRAWN:	RS	REV:	
DRAWING NO:	0036.3	REV:	

