

EXISTING SITE PLAN

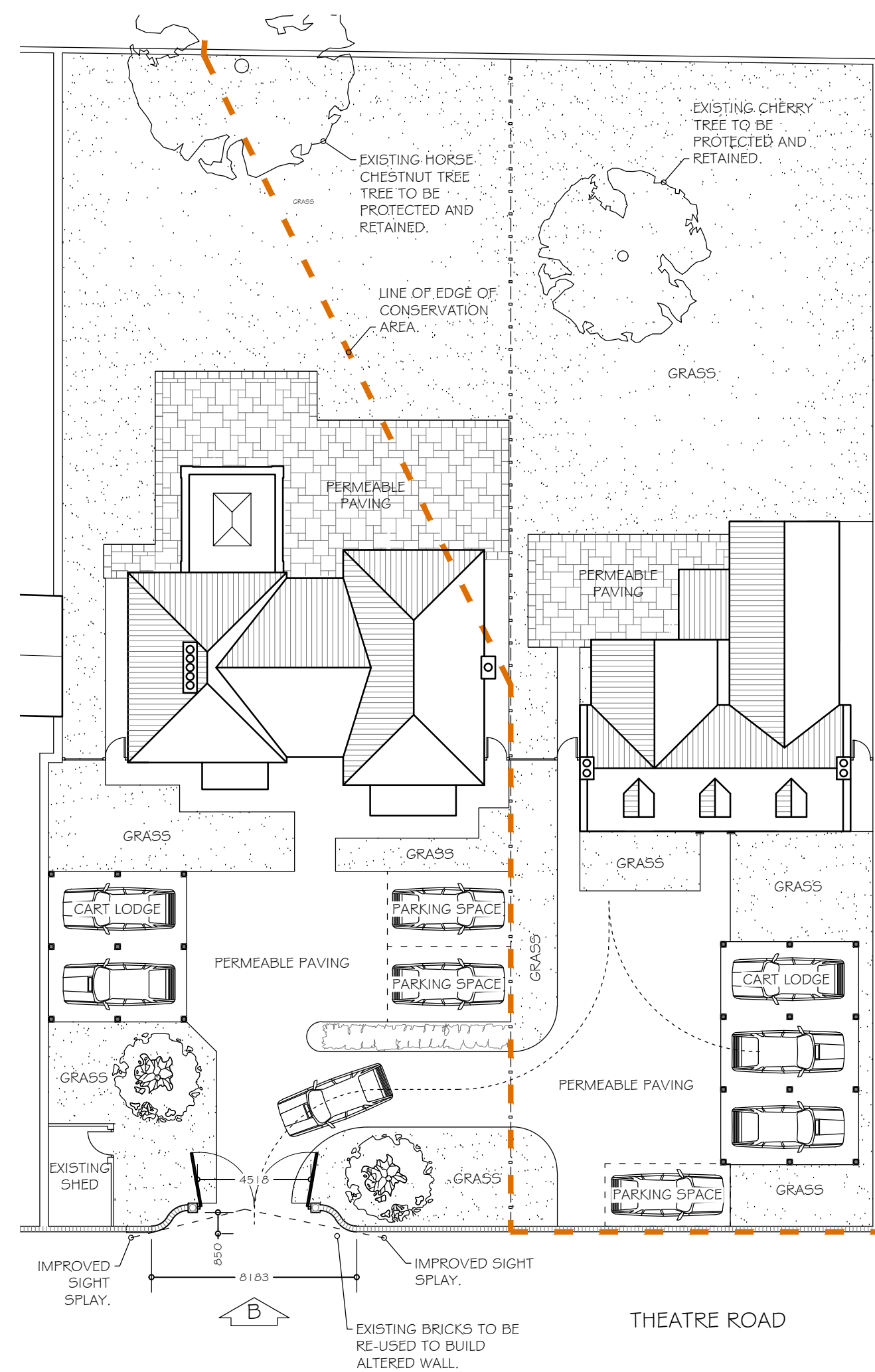

PROPOSED SITE PLAN

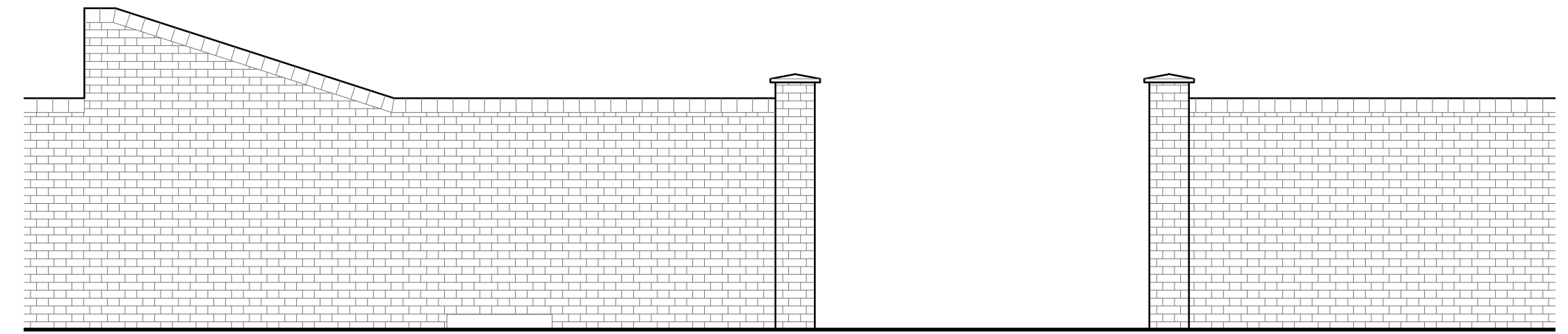

EXISTING ELEVATION (FROM A) OF OPENING IN FRONT BOUNDARY WALL

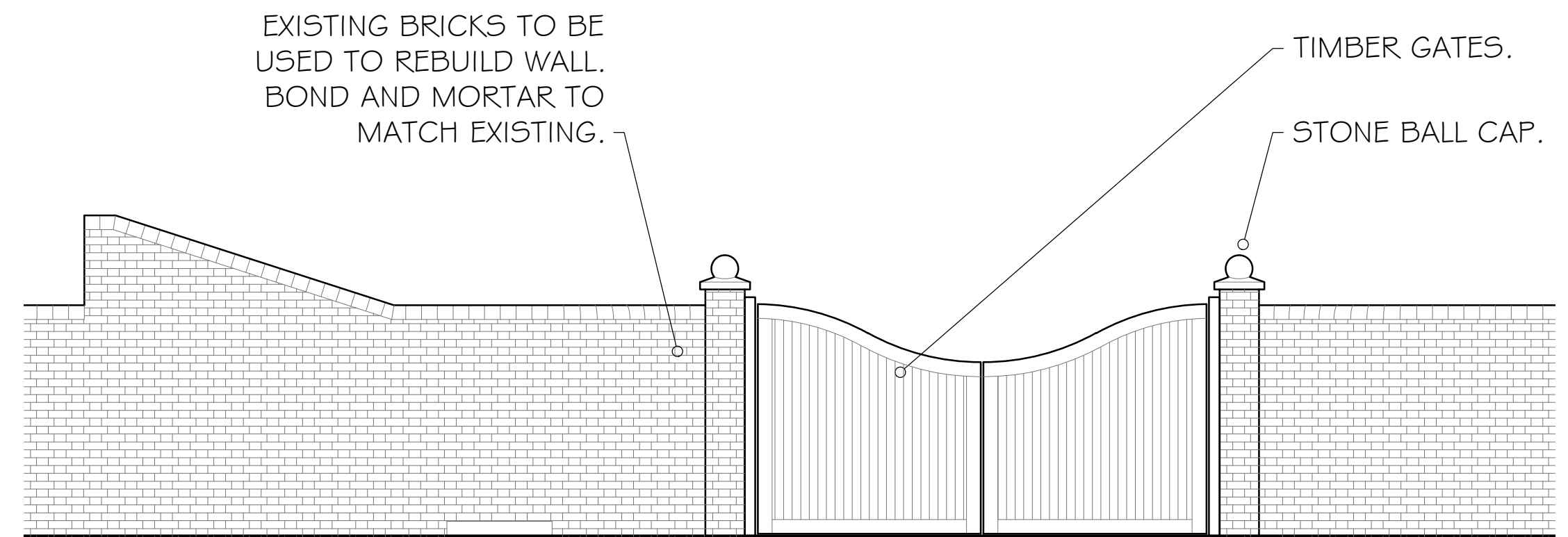

PROPOSED ELEVATION (FROM B) OF ALTERATION TO EXISTING OPENING IN FRONT BOUNDARY WALL

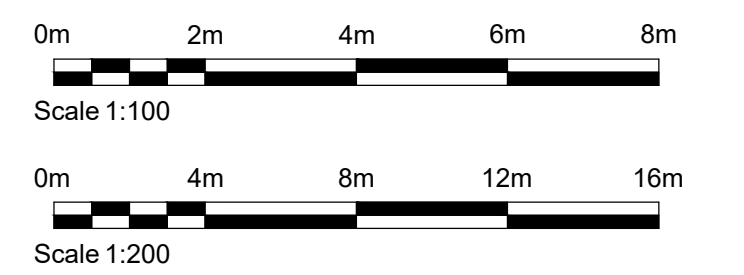
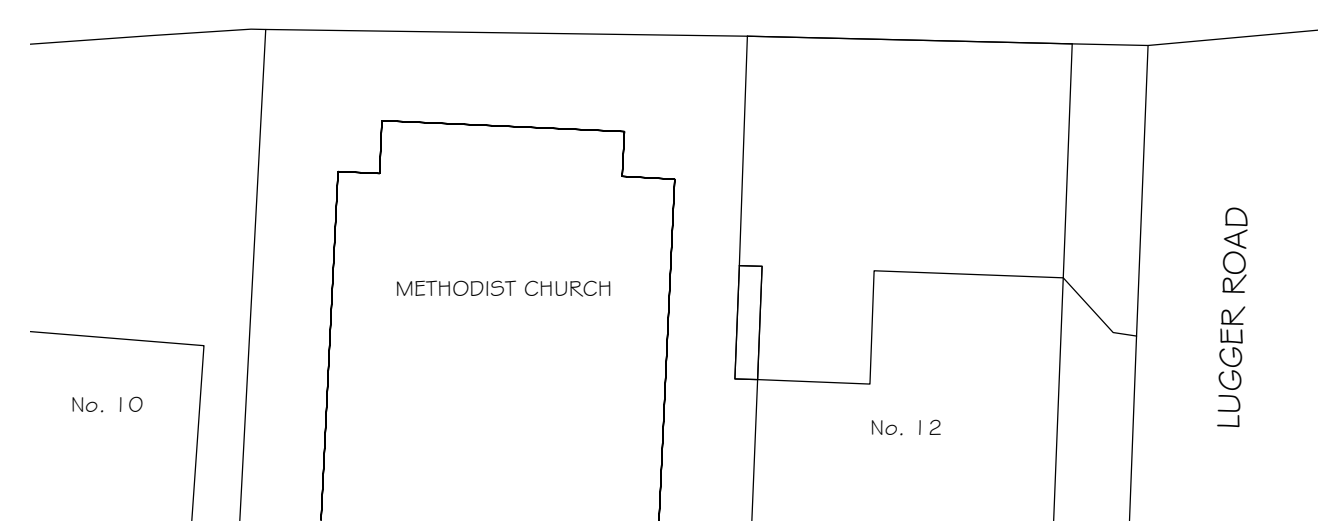
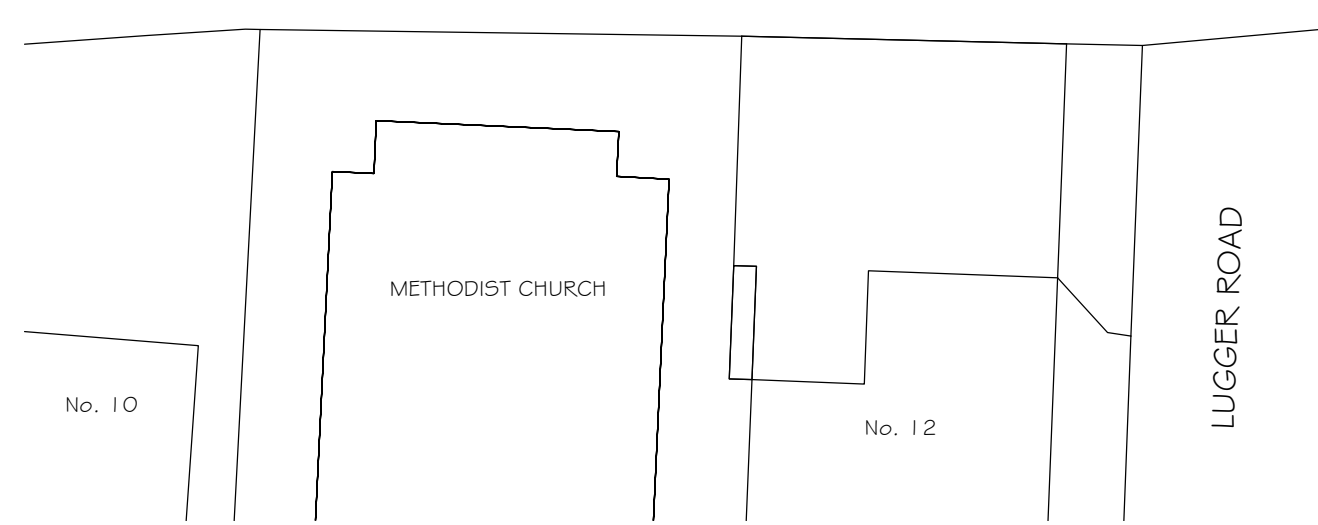

REV.	DATE	DESCRIPTION

DP Designs
 Romara, Norwich Road,
 Ludham, Norfolk NR29 5PB
 T: 01692 678537 M: 07846 681245
 E: allenplayfair@hotmail.co.uk

CLIENT
 MR. Perry Underwood

PROJECT ADDRESS
 The Nurseries
 Theatre Road
 Wells-Next-The-Sea
 Norfolk NR23 1DS

TITLE
 Proposed and Existing Elevations of
 Boundary Wall and Proposed and Existing
 Site Plans

DATE	SCALE AT A1	DRAWN BY
30/04/21	1:200	AMP
DRAWING NUMBER	PLANNING	REVISION
C348/PL/02	Planning	

Scale at 1:1