

EXISTING OS PLAN (1:1250)

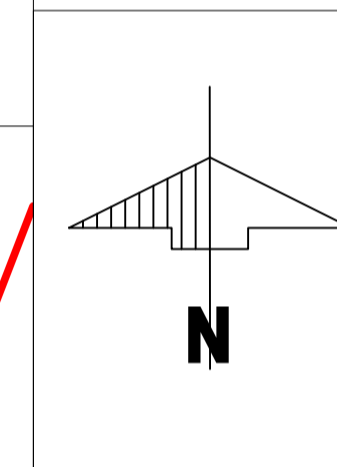

EXISTING SITE PLAN (1:200)

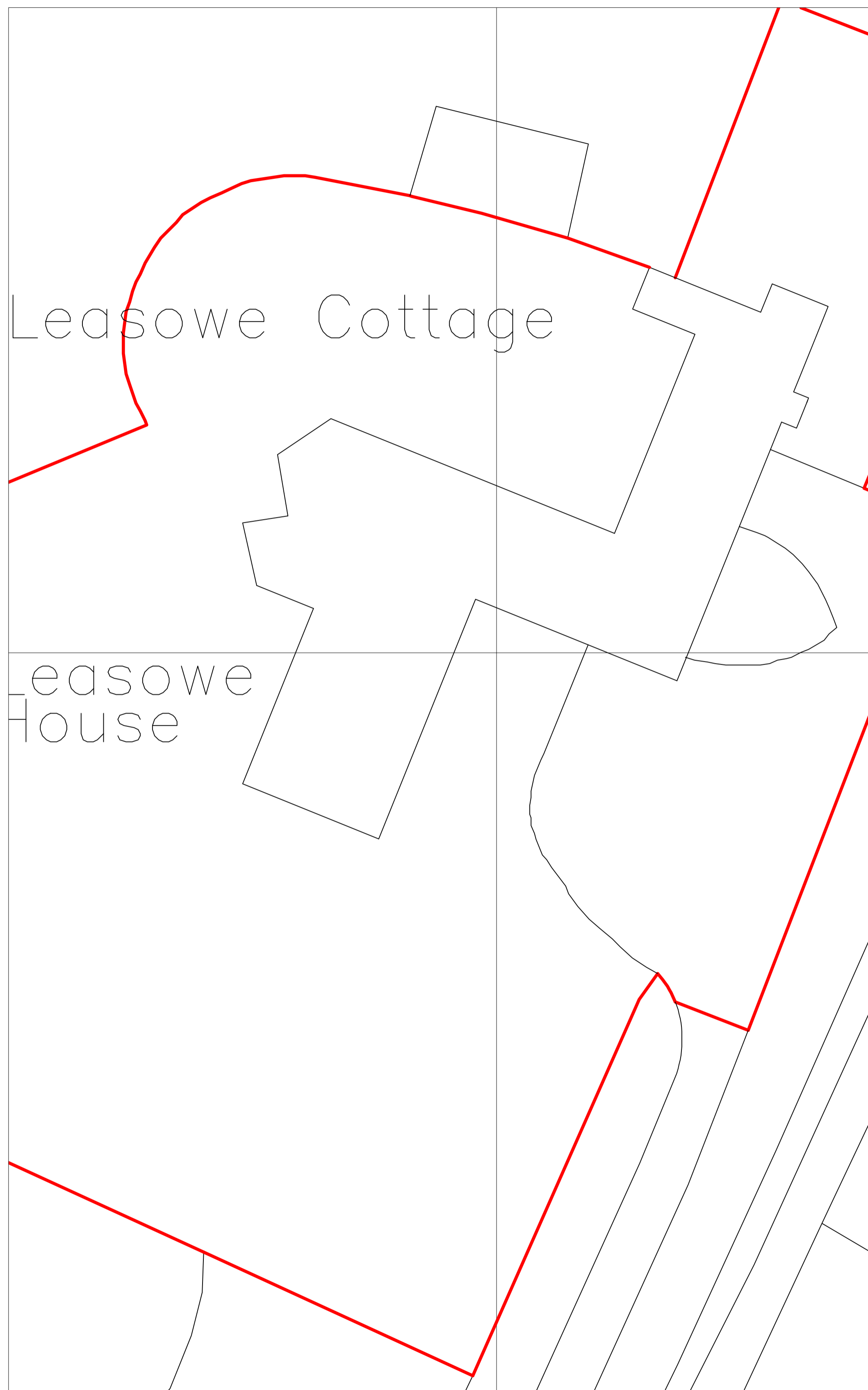
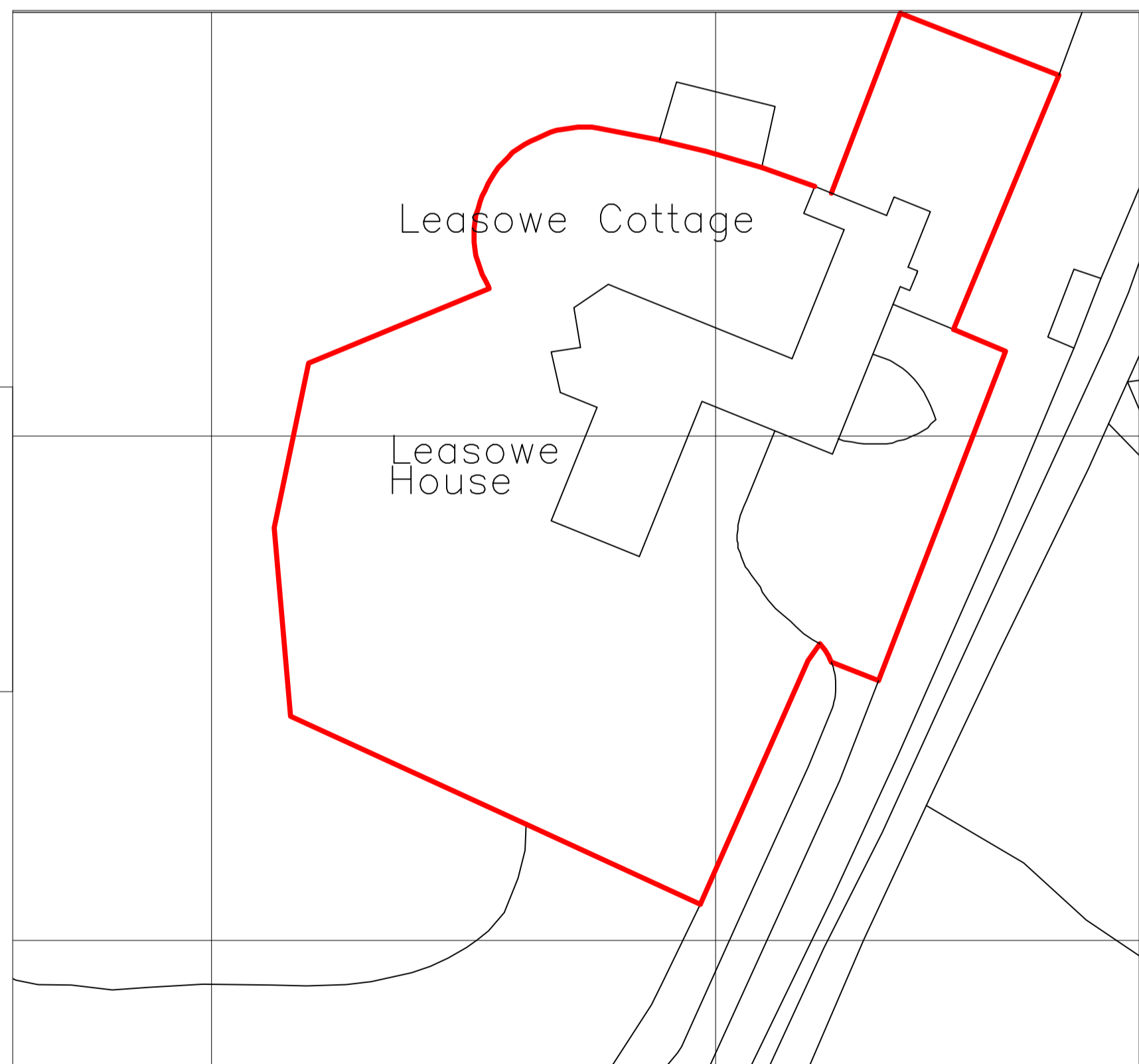
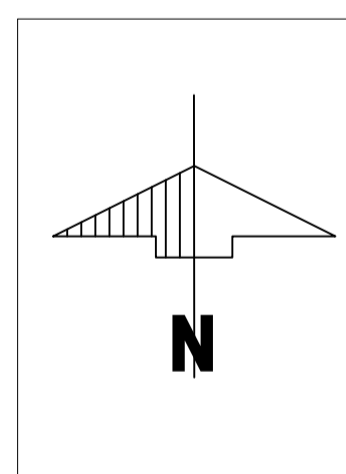

EXISTING BLOCK PLAN (1:500)

REV:	AMENDMENTS:	DRN:	CHK:	APP:	DATE:
STATUS: <b>FOR PLANNING</b>					
DRAWN BY:	CHECKED BY:	APPROVED BY:	SCALE:		
RGG			Varies @ A1		
DATE:	DATE:	DATE:			
10 Mar 22					



3 Thompson Close, Mickleover, Derby, DE3 0AU  
07999 748 532  
a.i.designs@outlook.com

CLIENT: **Mr & Mrs Bains**

PROJECT: **Leasowe House, Southam Road  
Radford Semele, Leamington Spa  
Warwickshire, CV31 1TZ**

DRAWING TITLE: **Existing OS,  
Site &  
Block Plans**

DRAWING NUMBER: **2212-5004**