

01 PROPOSED GROUND FLOOR PLAN
SCALE 1:50 @ A1

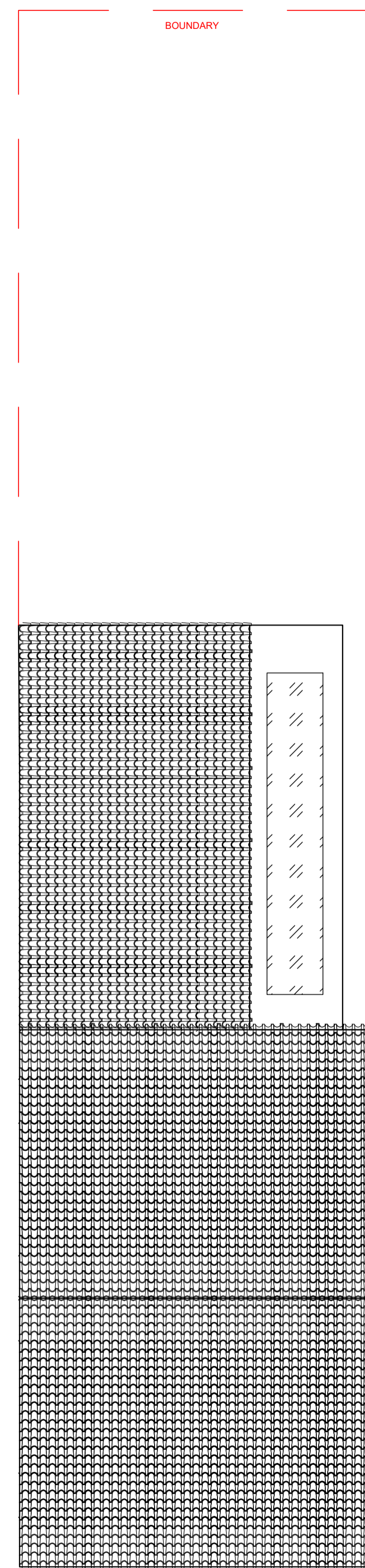

02 PROPOSED ROOF PLAN
SCALE 1:50 @ A1

Rev	Revision	Date	BY
-----	----------	------	----

NOTES

All setting out dimensions and points will be found on the construction issue drawings.

All dimensions to be checked on site prior to commencement of works. Do not scale this drawing.

Status

PLANNING

Project

70 WORDSWORTH ROAD

Detail

PROPOSED GROUND FLOOR EXTENSION PLAN

Scale

1:50 @ A1

Date

09.05.22

Drawing N°

WRDS_106

Revision

X

gravity design associates



Old Bank Court, Morocco Street, London SE1 3HB
+44(0)20 7089 9134 studio@gravitydesignuk.com