

Side Elevation
Scale 1:100

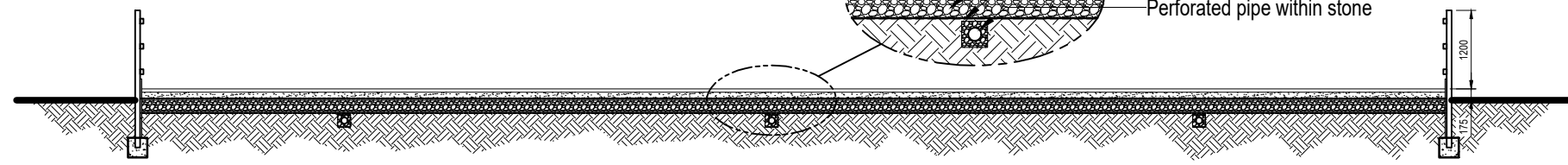

Section A-A
Scale 1:100

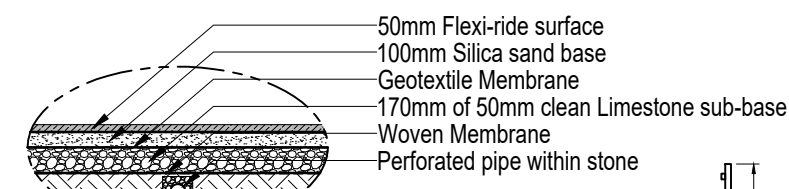
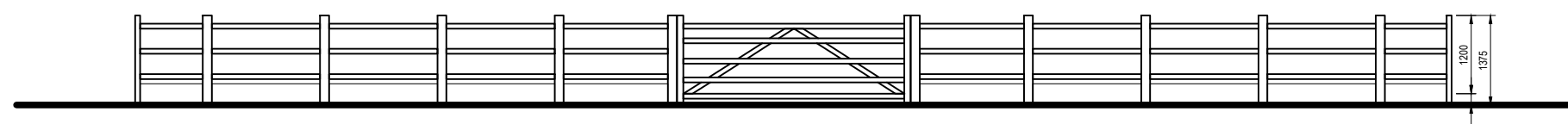

Gate Elevation
Scale 1:100

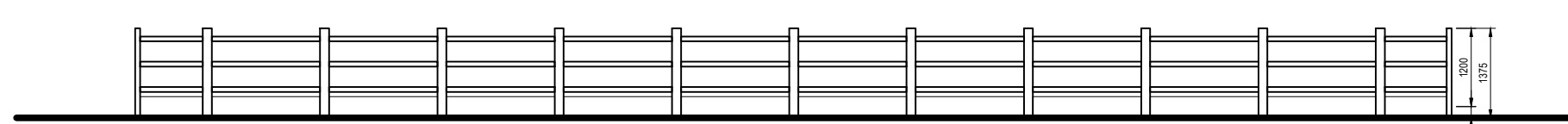

End Elevation
Scale 1:100

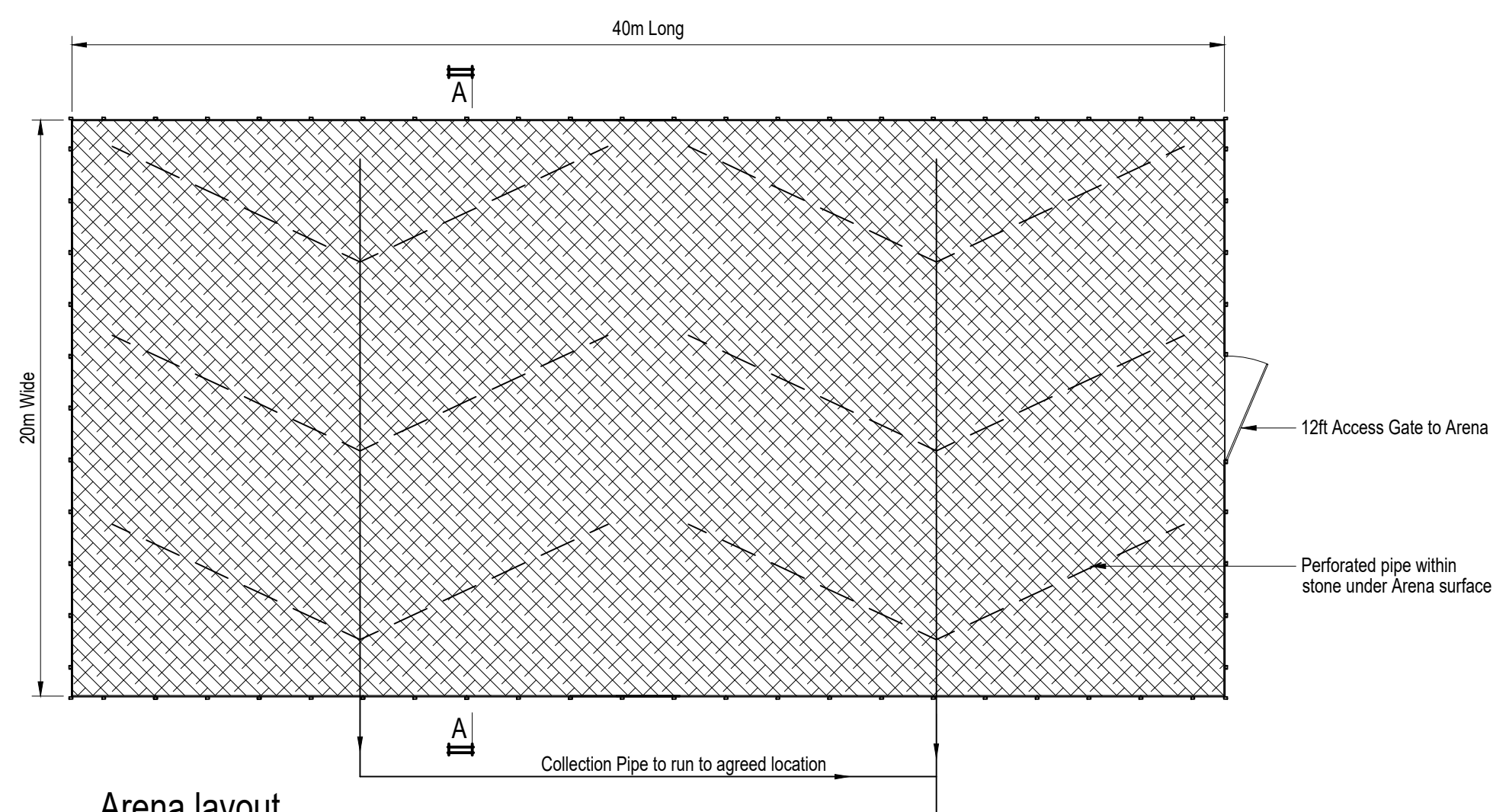

Arena layout
Scale 1:200

- Fencing Materials**
- Post - 125mm x 75mm x 2100mm pressure treated timber
 - Rail - 88mm x 58mm x 3000mm pressure treated timber
 - Gate Posts - 100mm x 100mm x 2400mm pressure treated timber. All gate posts to be galvanneal.
 - Gate - 3000mm 5-bar pressure treated timber gate.
- Note - Finish height of arena 1.2m above ground level.

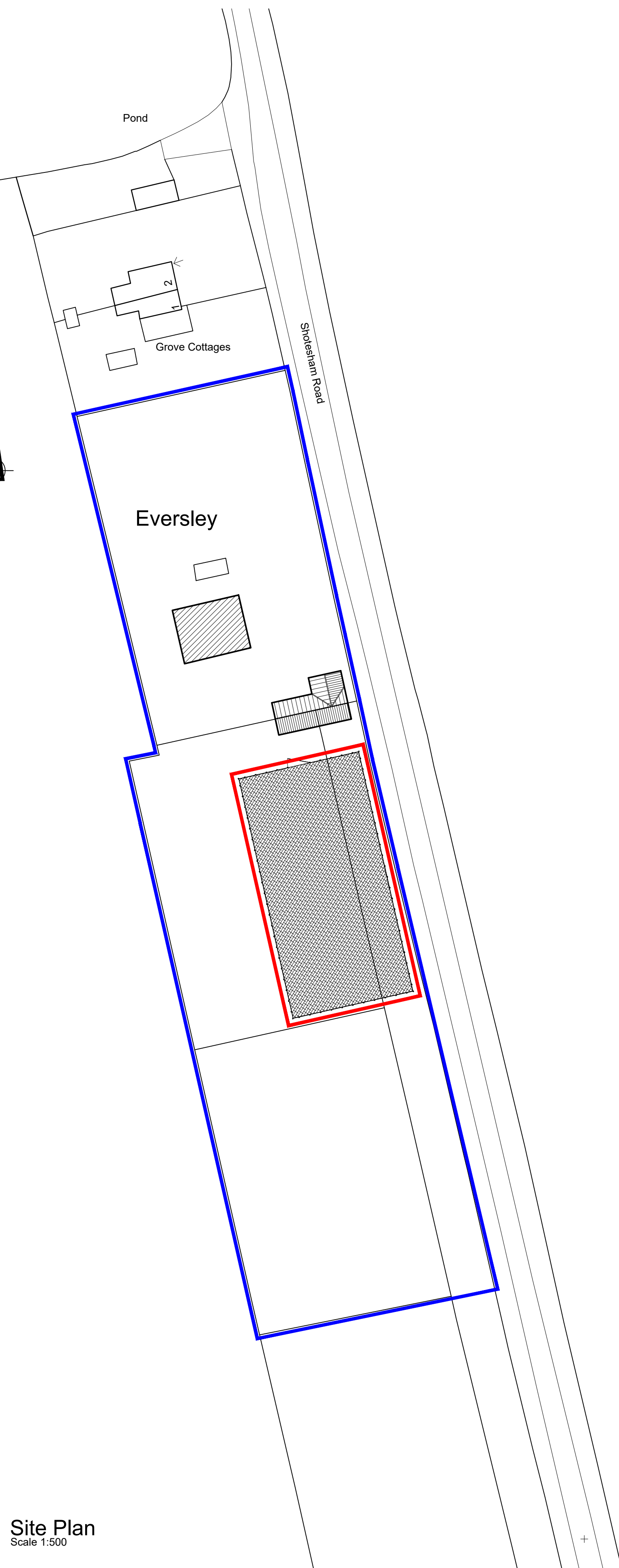

Site Plan
Scale 1:500

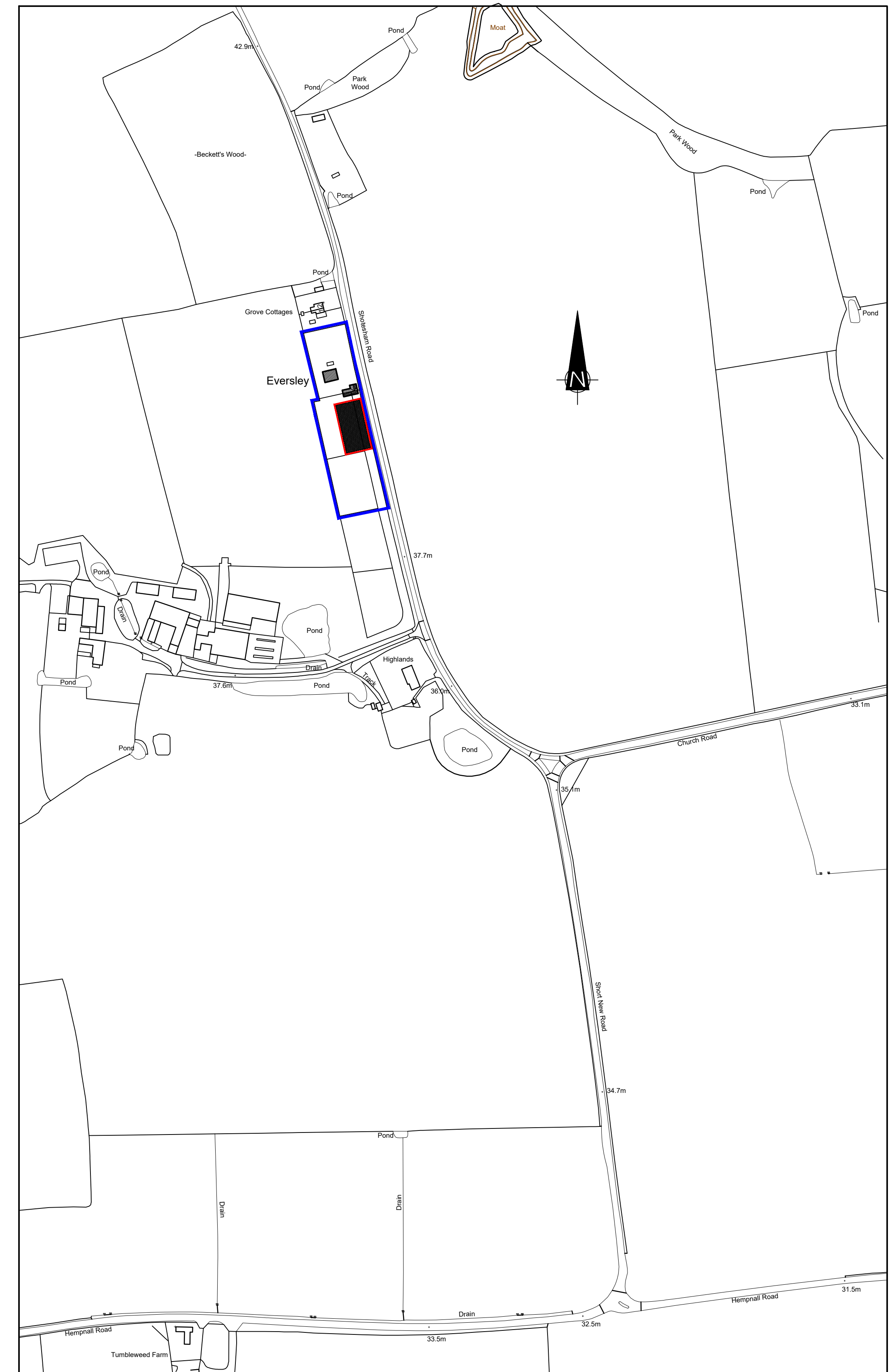

Ordnance Survey (c) Crown Copyright 2020. All rights reserved. Licence number 100022432

Site Location Plan
Scale 1:2500



General notes:

- The drawings and all information contained therein are the sole Copyright of East Anglian Stabling and any reproduction is forbidden unless permission is obtained in writing.
- All Dimensions are in millimetres unless noted otherwise.
- Dimensions marked * are subject to confirmation by site measurement before construction proceeds.
- All dimensions are given to structural surfaces unless noted otherwise.

address
Eversley, Shotesham Rd, Woodton, Norfolk,
NR35 2ND

client
Sarah Shipley

title
**Plans, Elevations, Site & Site
Location plans for Arena**

project reference 159	drawing number 01	revision P1
---------------------------------	-----------------------------	-----------------------



This drawing is copyright and is not to be reproduced without the permission of East Anglian Stabling.