

Public Realm

The public realm provides the interface between the public and private edges of the site.

The design will provide a hedge along the building frontage with integrated post and wire fence to reduce views from the adjacent footpath into bedrooms. A space will be maintained along the building frontage to allow for maintenance access.

A discreet exit will be located on this frontage, so the design ensures that a layby is incorporated with the potential for additional screening from the main entrance route.

Cafe Courtyard

This space offers an external spill-out for the internal building uses, as well as forming part of the external 'wander loop'.

The wedge shaped space will be designed to create a permeable edge to the existing building with integrated seating and tables. On the opposite side we have created a planted border to screen views into the proposed rooms and spaces. Seating is flexible and would be appropriate for older users, wheelchair access will also be incorporated.

Therapeutic Garden

This space, adjacent to the existing building will include growing spaces for service users for therapeutic purposes.

Planting and built elements will aim to provide a variety of experiences throughout the scheme, with planting providing familiar smells, sounds and textures.

Existing trees will be retained where possible.

Sensory Garden

The Sensory Garden provides the majority of the 'wander loop' through the external spaces of the site. This walkway will provide a defined loop which service users can easily follow.

This space will incorporate pergola structures to help screen views into adjacent bedrooms, while providing a vertical structure to grow plants on and create a defined walking route.

A feature tree in a container will create a visual focus on the intersection of the Sensory Garden, Cafe Courtyard and Therapeutic Garden.

Much like the Therapeutic Garden, the sensory garden will use planting textures, smells and sounds to create different experiences for service users.

Existing trees will be retained where possible.

Access

This area will provide access for maintenance and fire tender, allowing a 4m wide vehicular route to the east of the proposed building. The area will be surfaced in reinforced grass which will take the required vehicle loading while giving the appearance of a lawn.

A hedge will be provided to the proposed building edge to screen views in to the proposed bedrooms.

Central Courtyard

The Central Courtyard will provide much of the facilities year-round external useable space due to its sheltered nature.

A perimeter of raised planters will provide a soft enclosure to the space, a central raised planter will create a small 'wander loop'.

Integrated seating will provide a variety of opportunities to sit and relax individually or in small groups.

Terrace

The first floor Terrace will create a flexible external space for service users restricted to the first floor.

Similar to the ground level courtyard, a perimeter of raised planters will provide a soft edge and restrict access to windows. A variety of loose and fixed furniture can be included to allow a larger central space to be created, or more seating, depending on the required use.

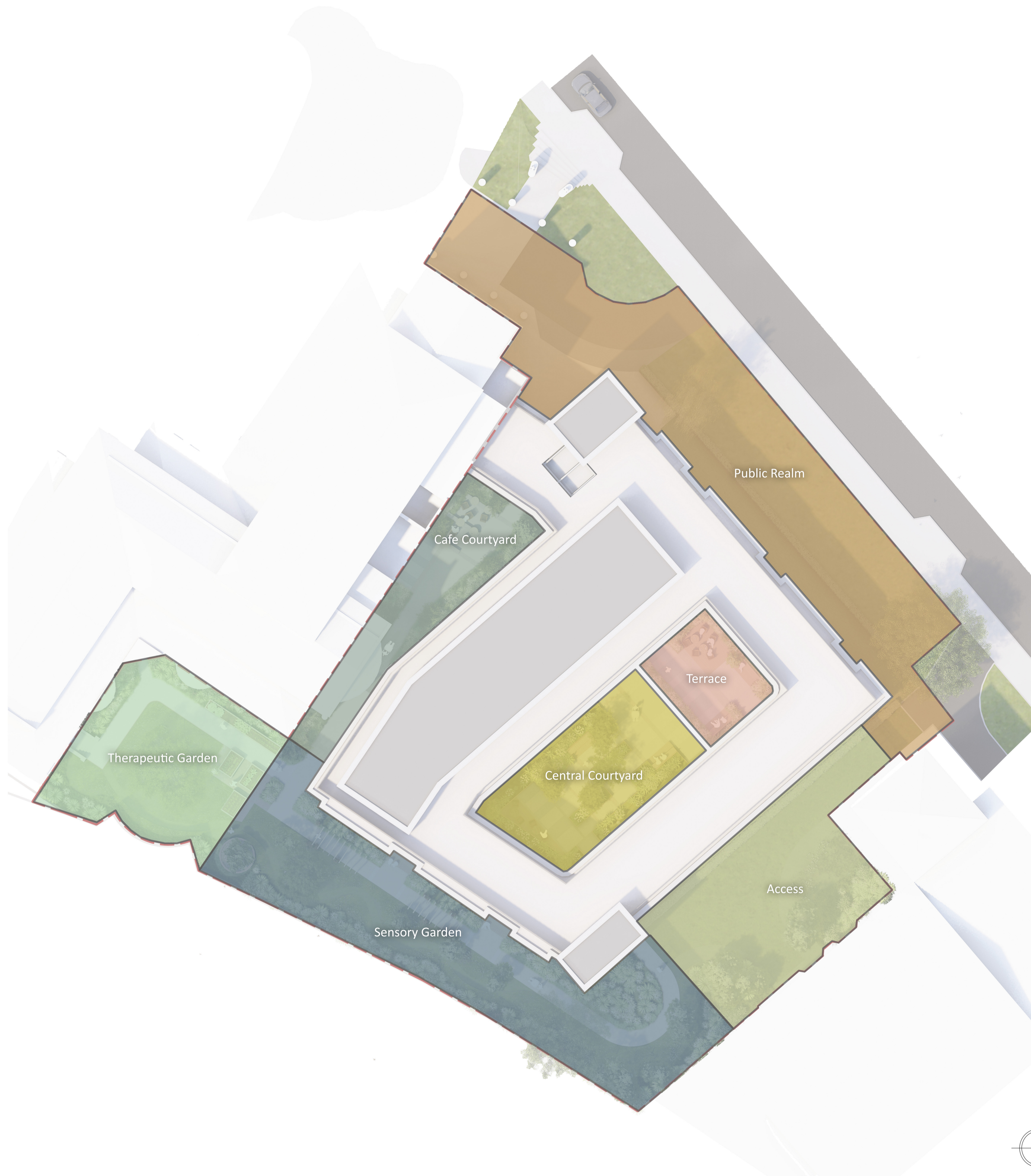

NOTES:

DO NOT SCALE. Use figured dimensions only. The contractor is requested to check all dimensions before the work is put in hand. Copyright of this drawing belongs solely to Iteriad Ltd ©. This drawing must only be used for the purpose for which it is supplied and its contents must not be reproduced for any purpose without written permission. Areas indicated, or areas calculated from this drawing should be used for valuation purposes or as the basis for development contracts. Iteriad Ltd is a limited liability company registered in England and Wales. Number 7966573

KEY PLAN

To be read in conjunction with:

RB0002-ITER-XX-00-DR-L-0001 - Landscape Masterplan

RB0002-ITER-XX-00-DR-L-0003 - External Security and Access Strategy Plan

RB0002-ITER-XX-00-DR-L-0101 - Landscape GA

RB0002-ITER-XX-00-M3-L-8001 - Landscape BIM Model

RB0002-ITER-00-XX-SP-L-2000 Outline Hard and Soft Landscape Materials Schedule

PO2	UPDATED FOLLOWING DEVELOPMENT OF SECURITY AND ACCESS STRATEGY	MS	KLH	14.03.22
PO1	FIRST ISSUE	MS	KH	28.02.22
REV	DETAILS	DRAWN BY	CHECKED BY	CHECKED DATE

DRAWING RECORD

STATUS
FOR REVIEW, COMMENT AND APPROVAL

CLIENT

NHS
Black Country Partnership
NHS Foundation Trust

MASTERPLANNERS/LANDSCAPE ARCHITECTS

(iteriad)
Studio
2 Cragwood Cottages,
Eggleston,
Widmore,
Cambridgeshire,
LU23 1LQ
T: (+44) 15394 43018
E: studio@iteriad.com
W: www.iteriad.com

PROJECT TITLE
Edward Street Hospital

DRAWING TITLE
LANDSCAPE STRATEGY PLAN

SCALE
1:200@A1

DRAWN BY
MS

DATE
FEB '22

JOB/DRAWING NUMBER
RB0002-ITER-XX-00-DR-L-0002

REVISION
P02